

MAXI

Wardrobe 4DR.

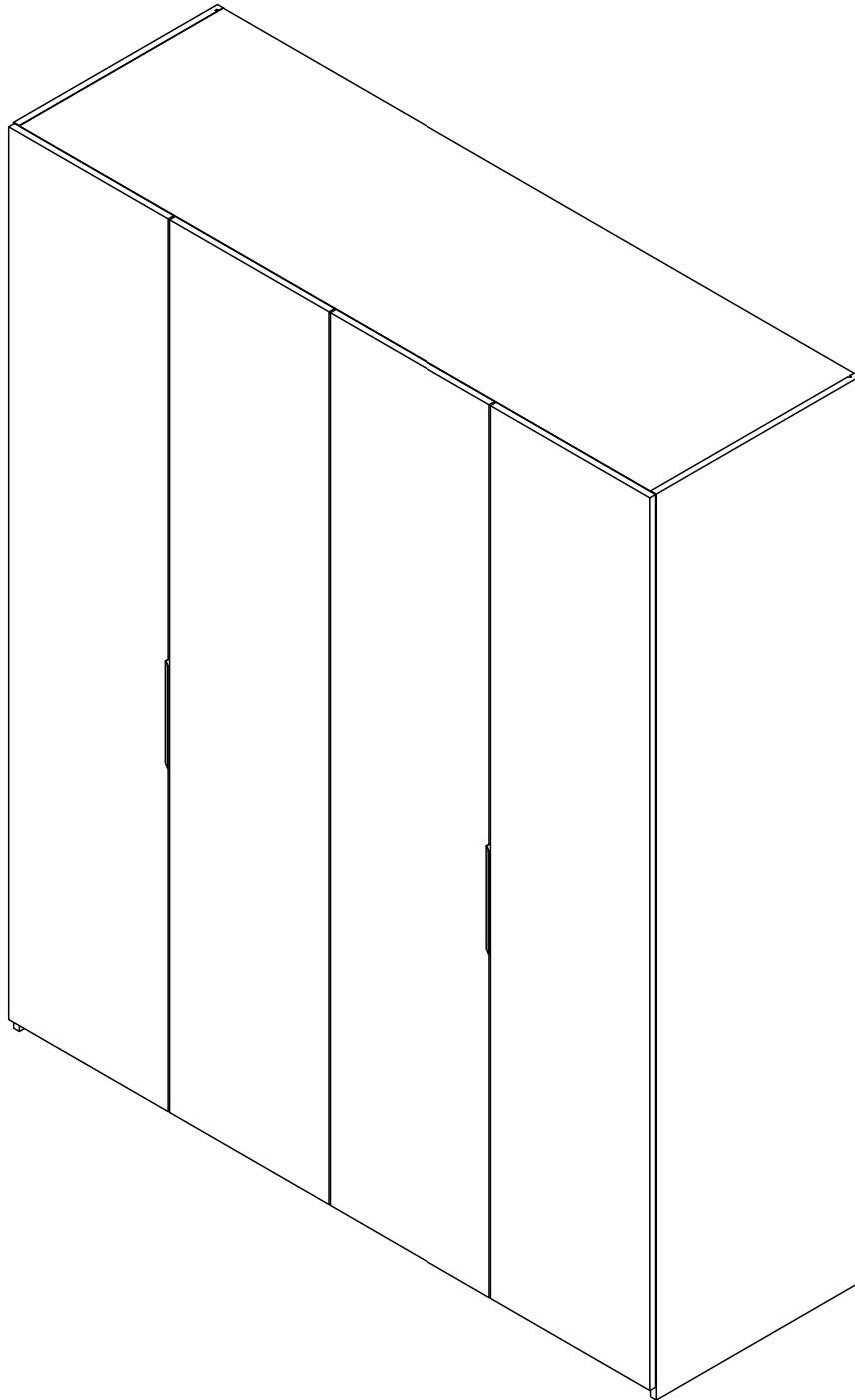

CONNECT SYSTEM

1

3

2

(Connecting bolts)

WHEN FITTING CAMS
 ENSURE STARTING POSITION IS CORRECT
 BEFORE YOU INSERT CONNECTING BOLT
 TURN CLOCKWISE UNTIL SECURE

✓				✗
	↑			
	CORRECT		WRONG	

M4x16mm.

i

40mm.

☹

✗

EQ

☺

✓

M4x16mm.



M4x16mm.

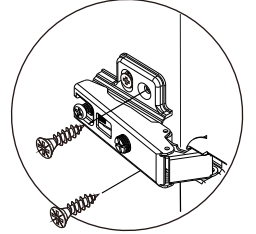
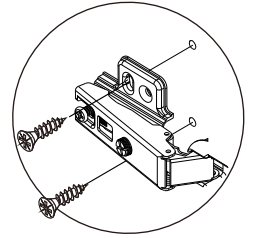
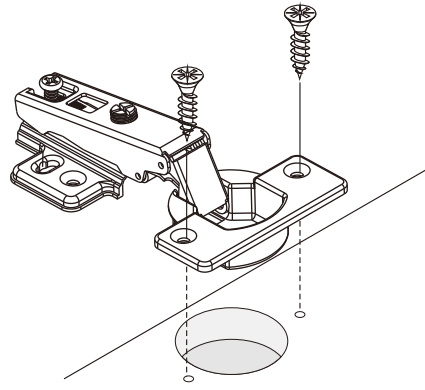
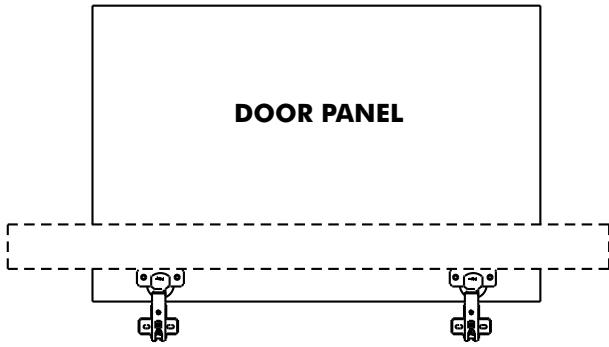

M4x16mm.

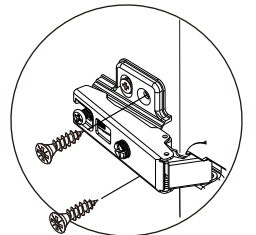
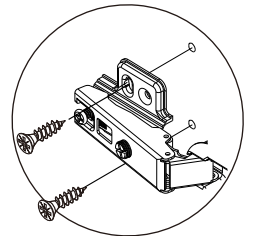
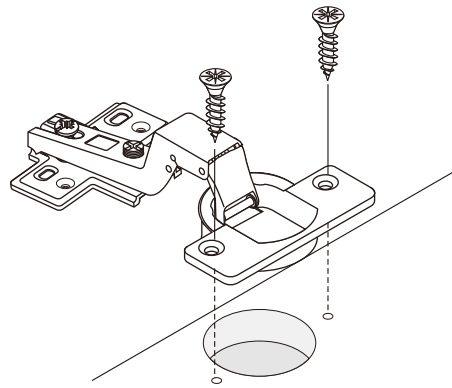
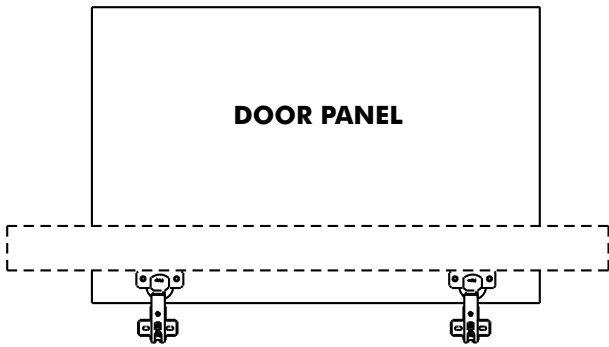

M3.5x20mm.

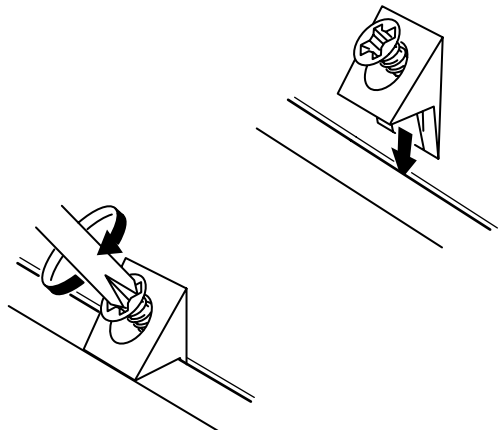
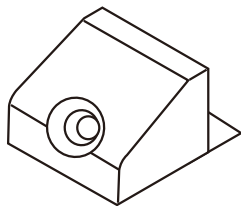



มาตรฐาน การระบุสินค้าที่ต้องยึด Fitting กันล้ม (Safety Fitting) ***หมายเหตุ เป็นชุดเด็ก ไม้ติดตั้ง Fitting กันล้มทุกตัว***

■ หมวด ตู้บานเปิด / ตู้บานปิด + ช่องใส่



■ ติดตั้งจากกันล้มกับตู้สูง (ตั้งแต่ 2 m. ขึ้นไป)

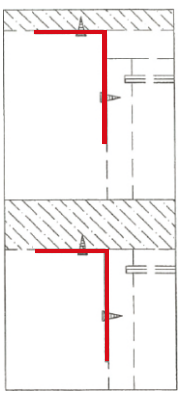

ติดตั้งบนผนัง

ติดตั้งลอยหลบมือ

■ หมวด ตู้ลิ้นชัก / ตู้ลิ้นชัก + ช่องใส่ / ตู้ลิ้นชัก + บานเปิด / ตู้ลิ้นชัก + บานสไลด์

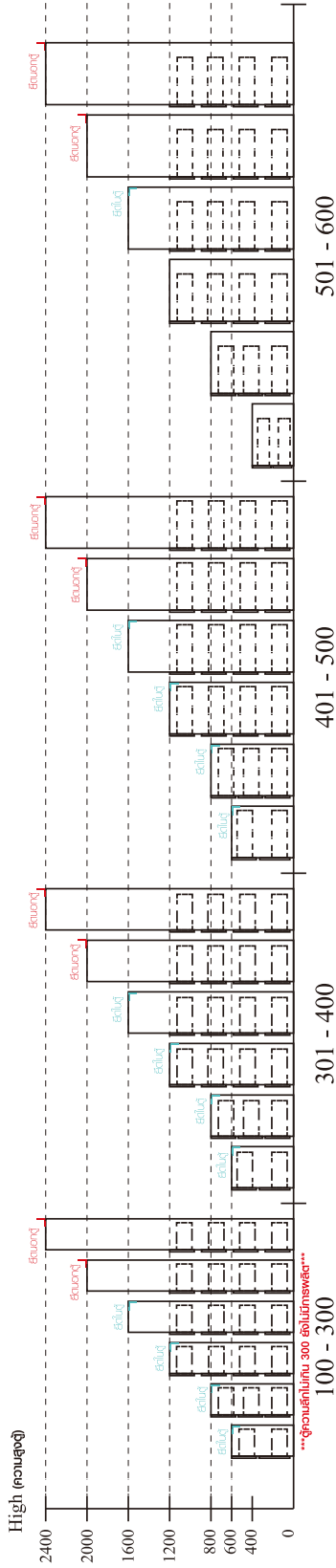

■ ติดตั้งจากกันล้มกับตู้เตี้ย (น้อยกว่า 2 m.)

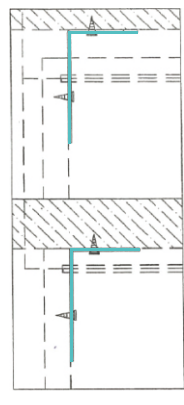

ติดตั้งบนผนัง

ติดตั้งลอยหลบมือ

■ หมวด ตู้บานสไลด์ / ตู้ใส่

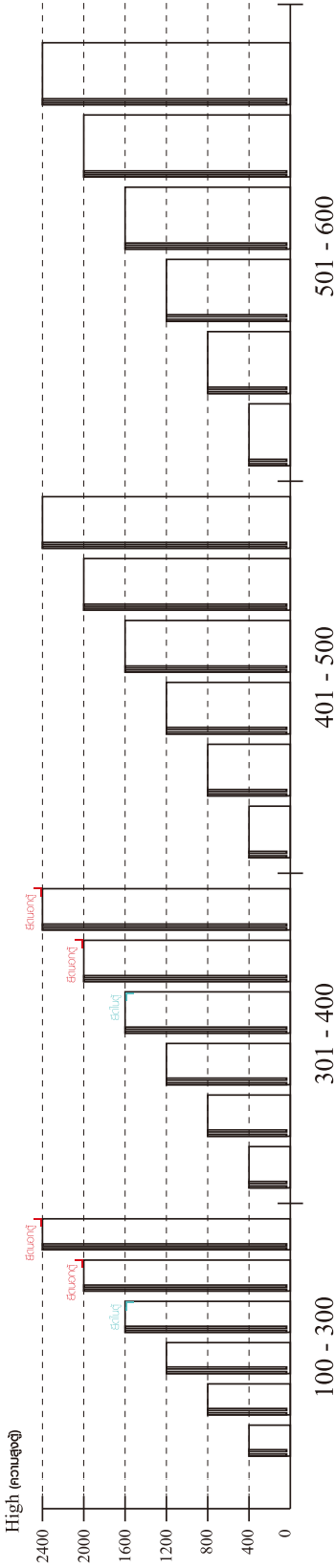

ความสูงตั้งแต่ 1600 ขึ้นไป สลักกัน 300 ความสูงตั้งแต่ 1600 ขึ้นไป สลักกัน 400

HARDWARE

-BODY SET

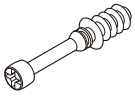

x 35



x 35

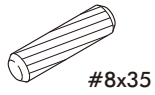

x 32

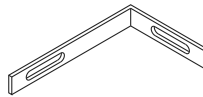

x 2

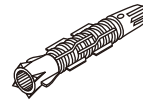

x 2

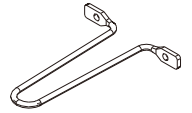

x 1



x 4

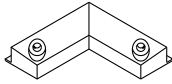

x 2



x 6

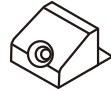

x 8

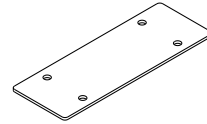

x 2

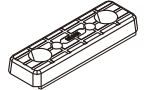

x 12



x 12



x 7

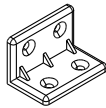

x 17

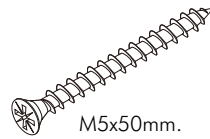

x 2



x 8

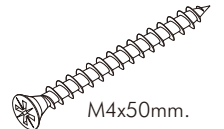

x 1



x 12



x 8



x 92



x 18



x 27



x 8



x 4

HARDWARE

-DOOR SET

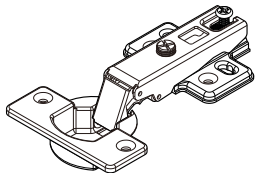

Full overla

x 8

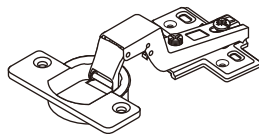

Half overlay

x 8



x 96



x 8



x 6

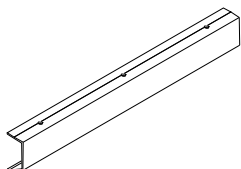

x 2

ASSEMBLY

-BODY SET

1.

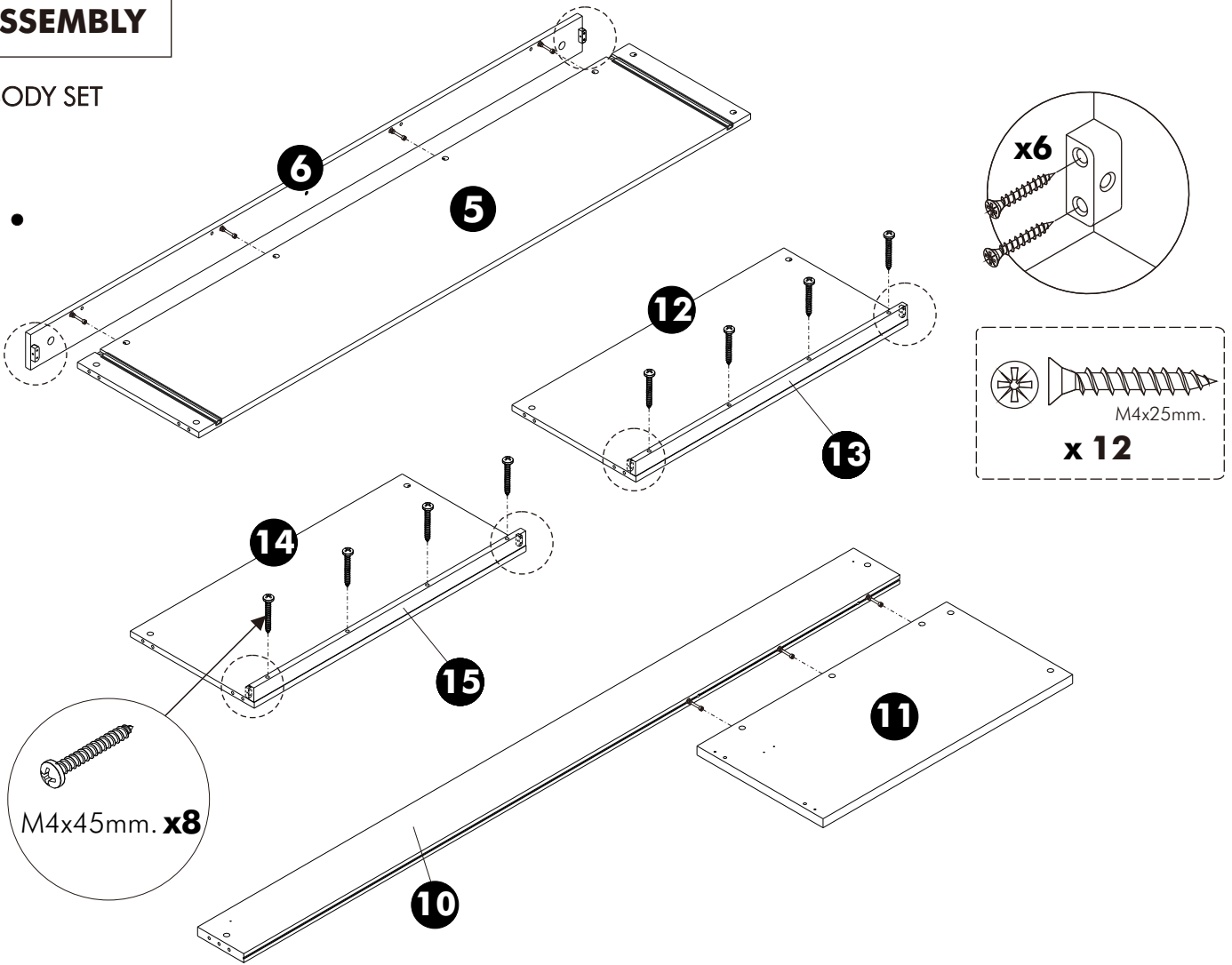

2.

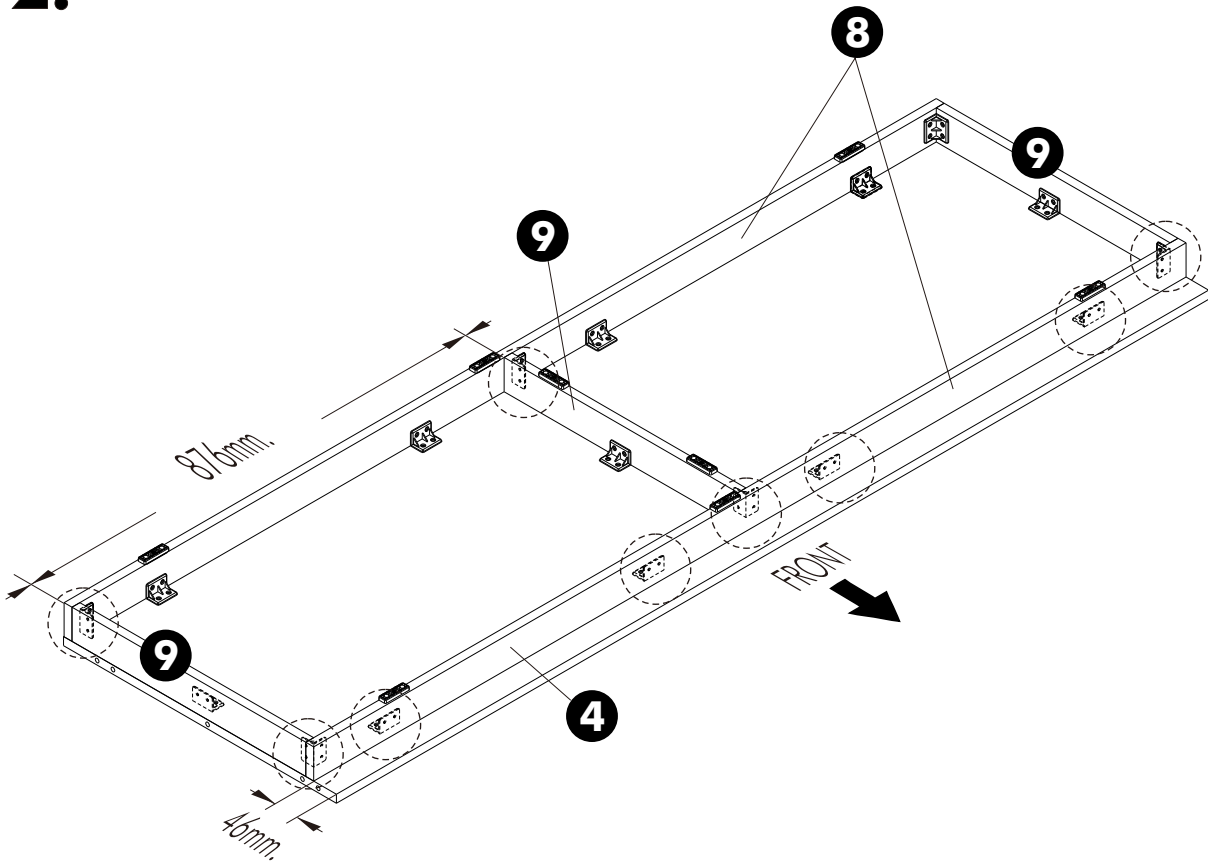

3.

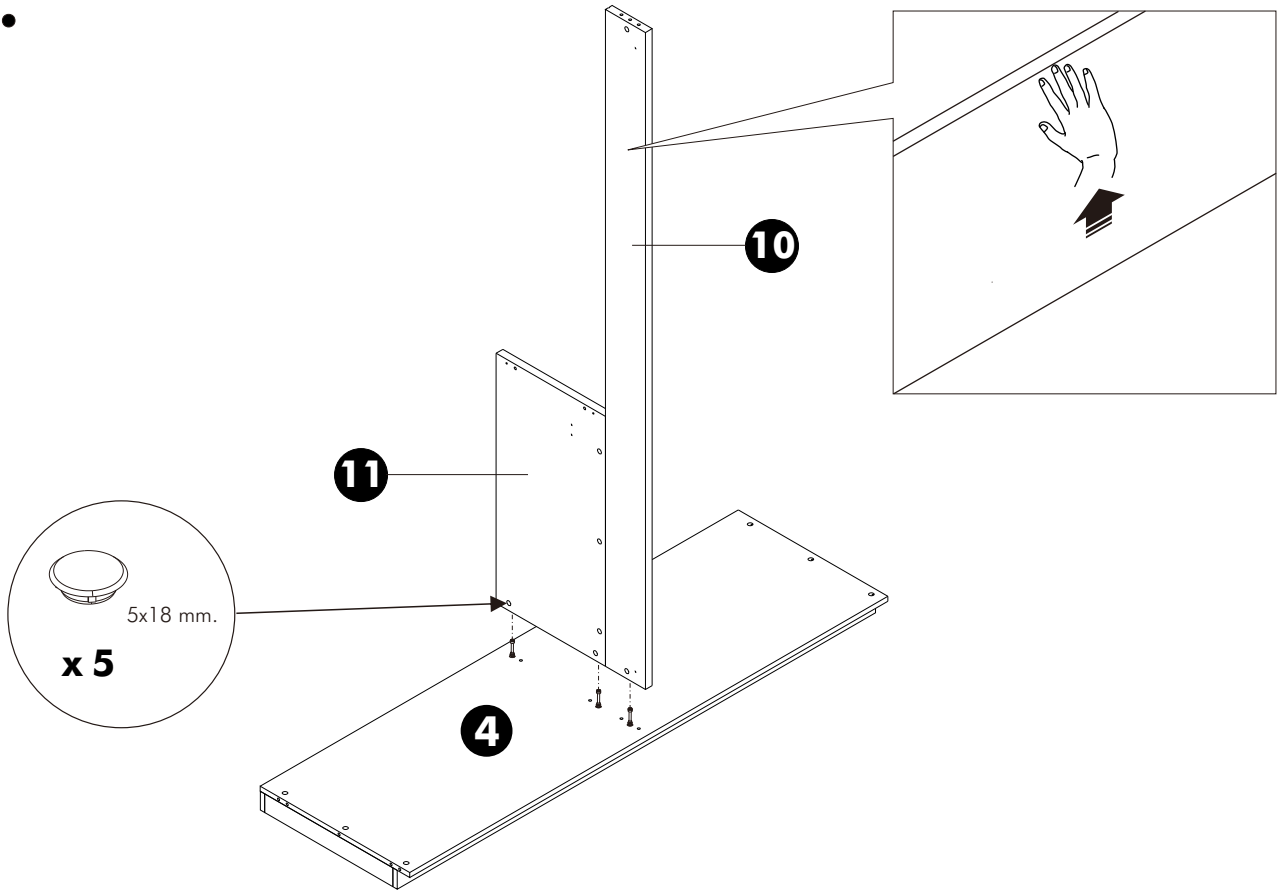

4.

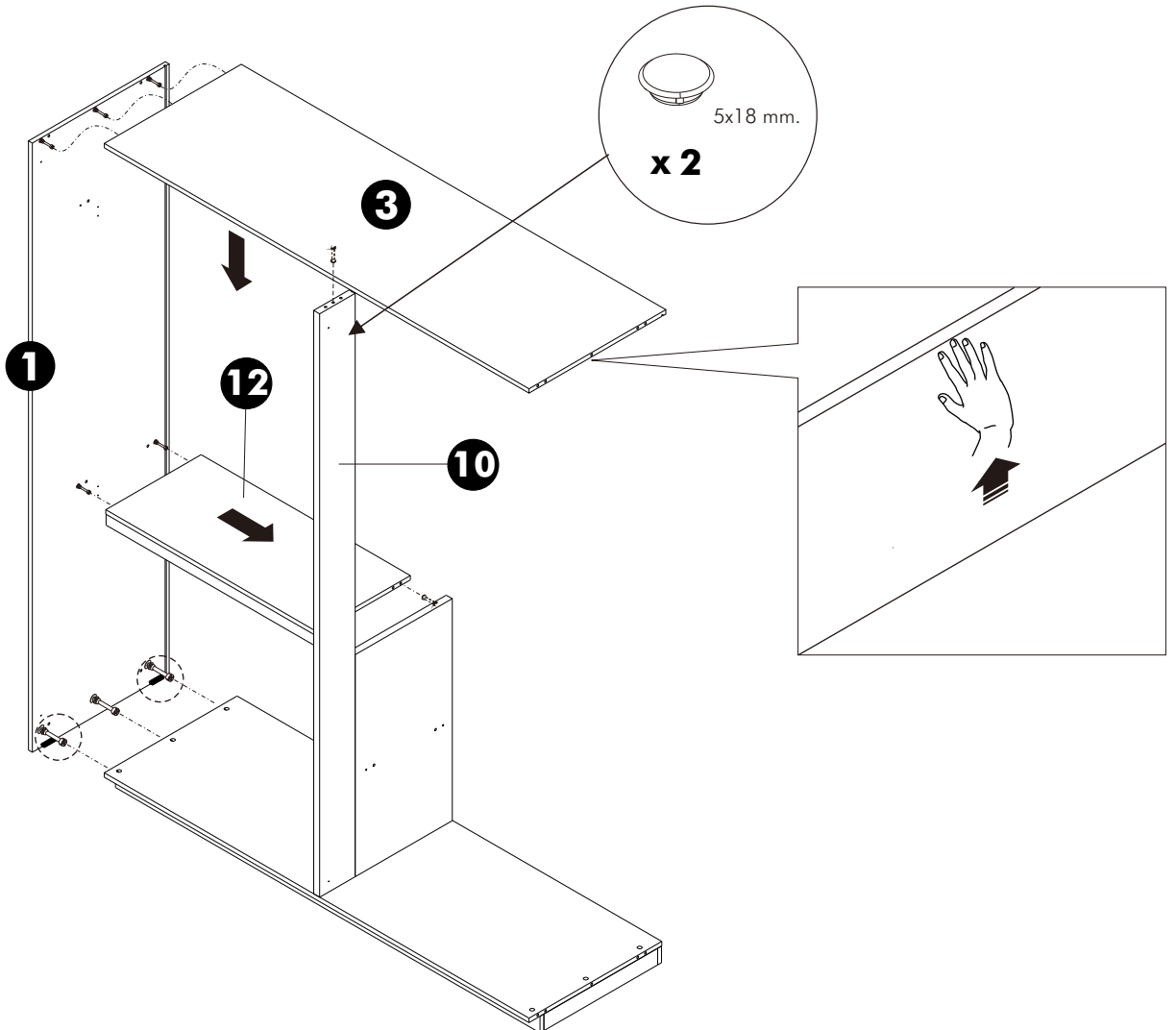

5.

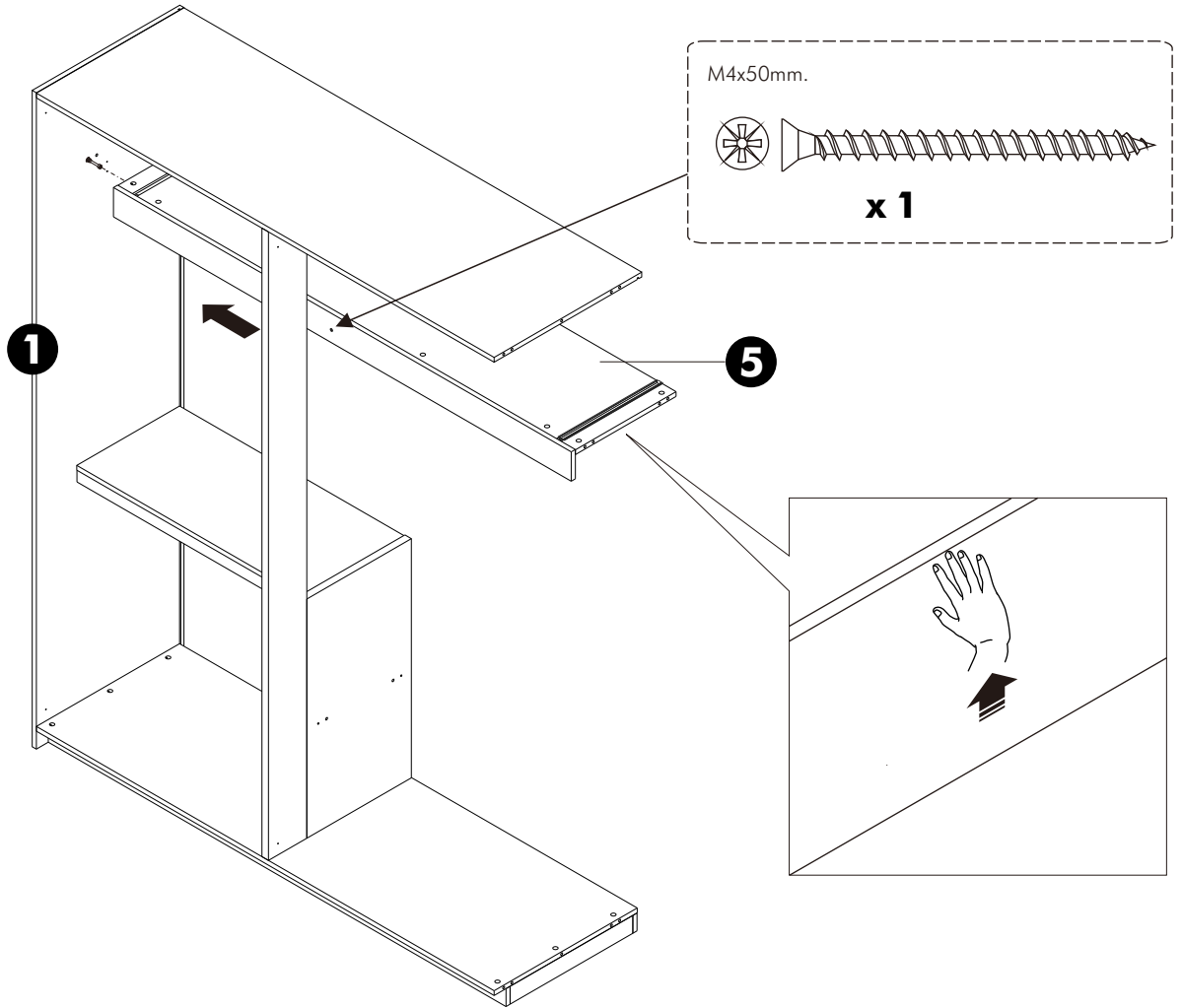

6.

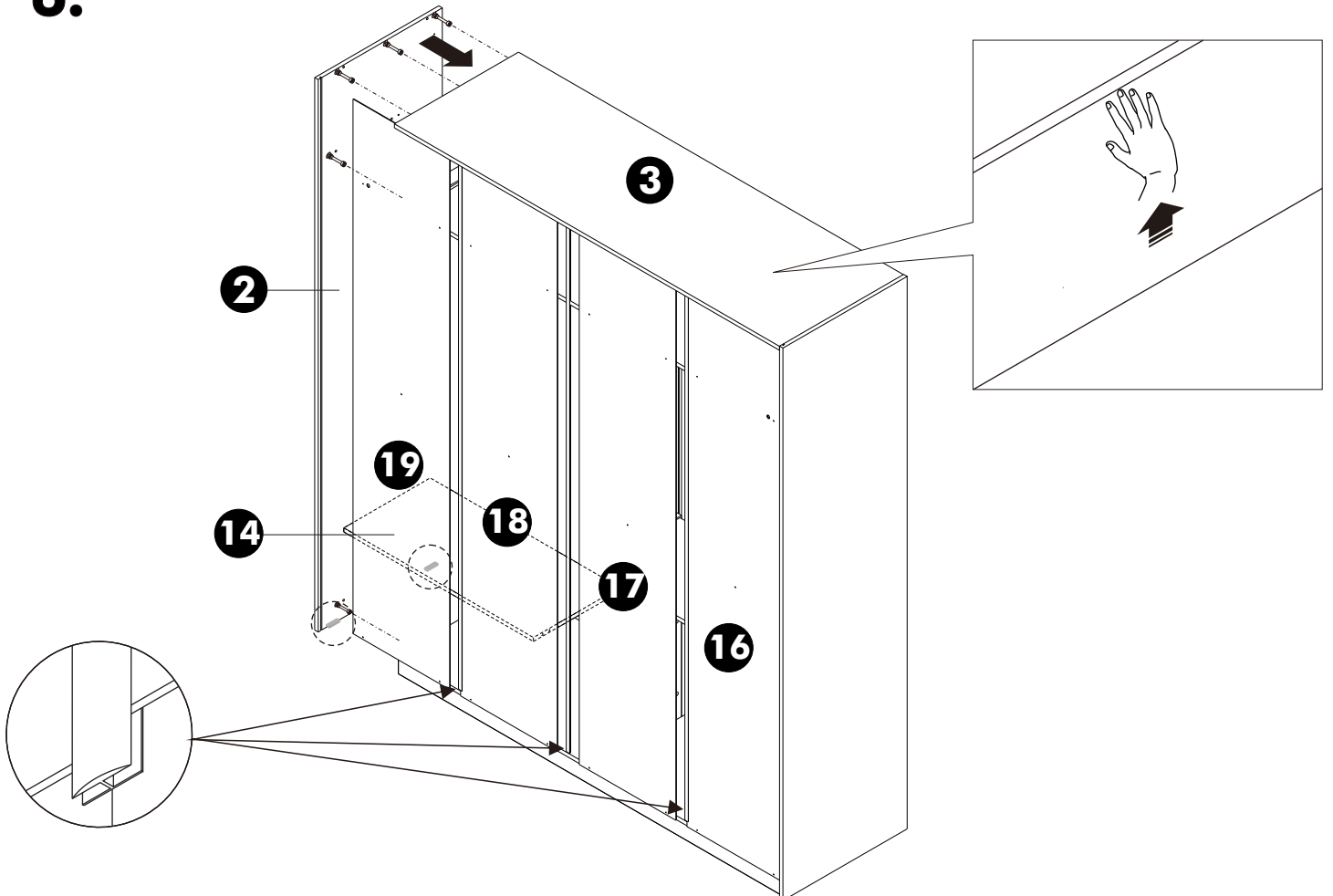

7.

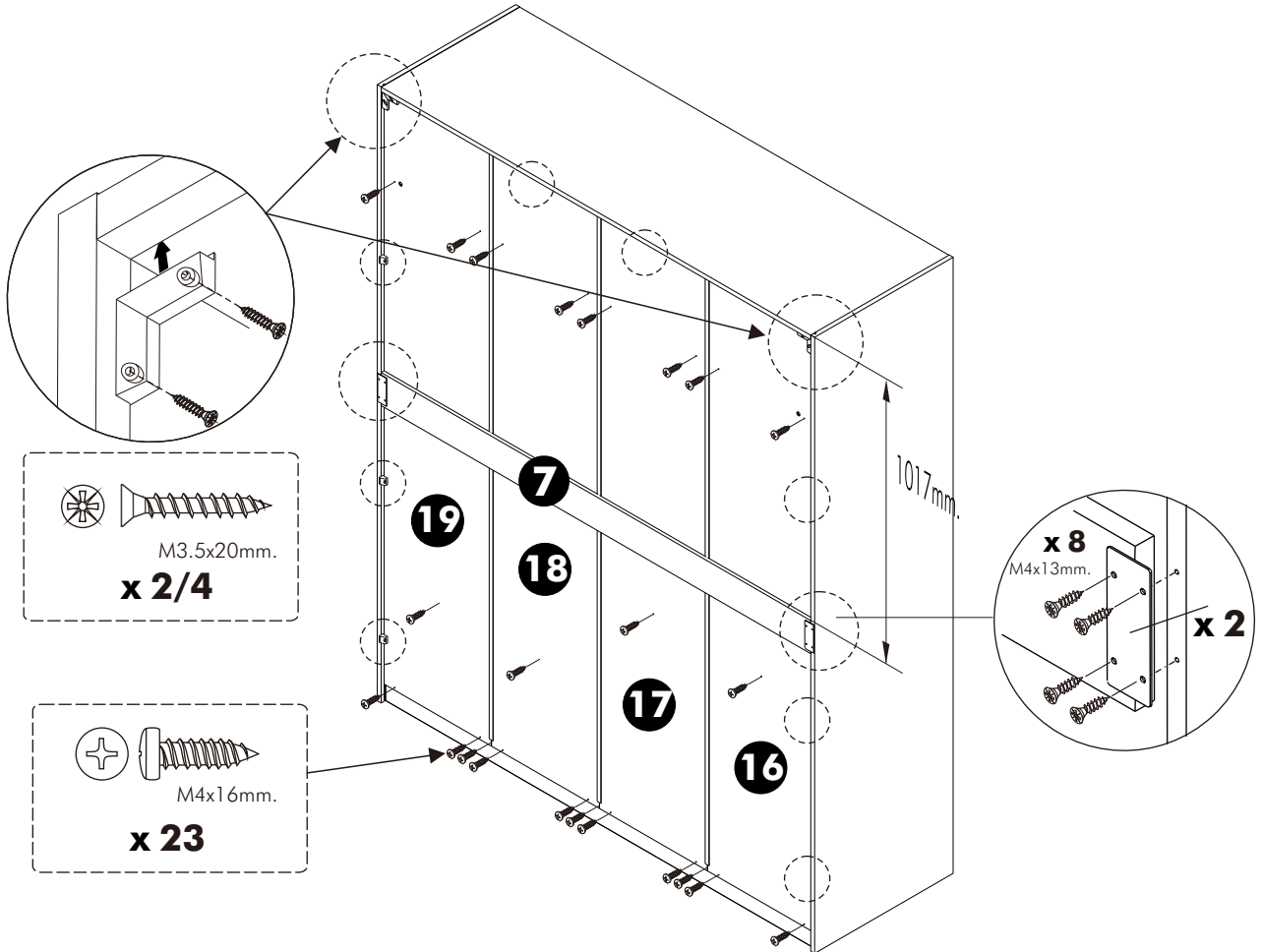

8.

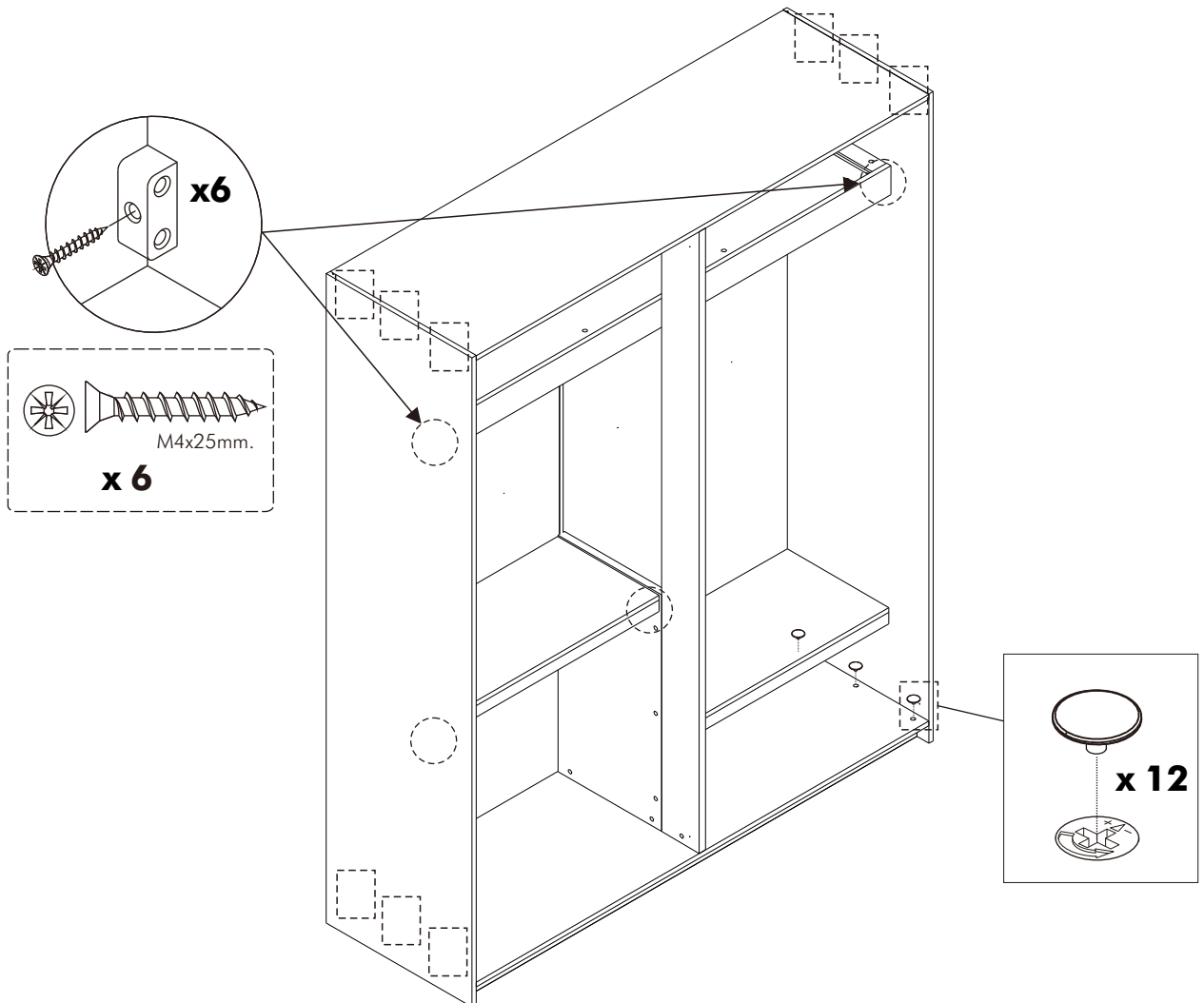

9.

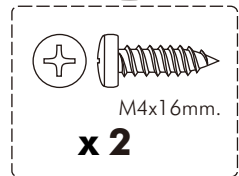
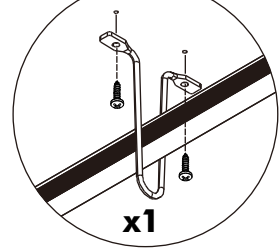
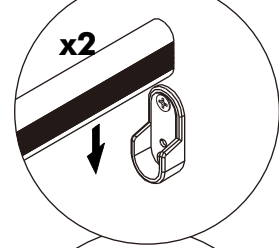
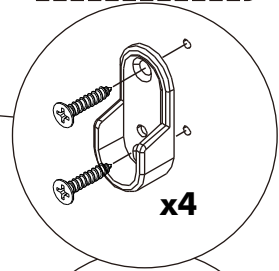
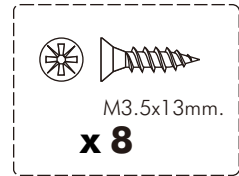
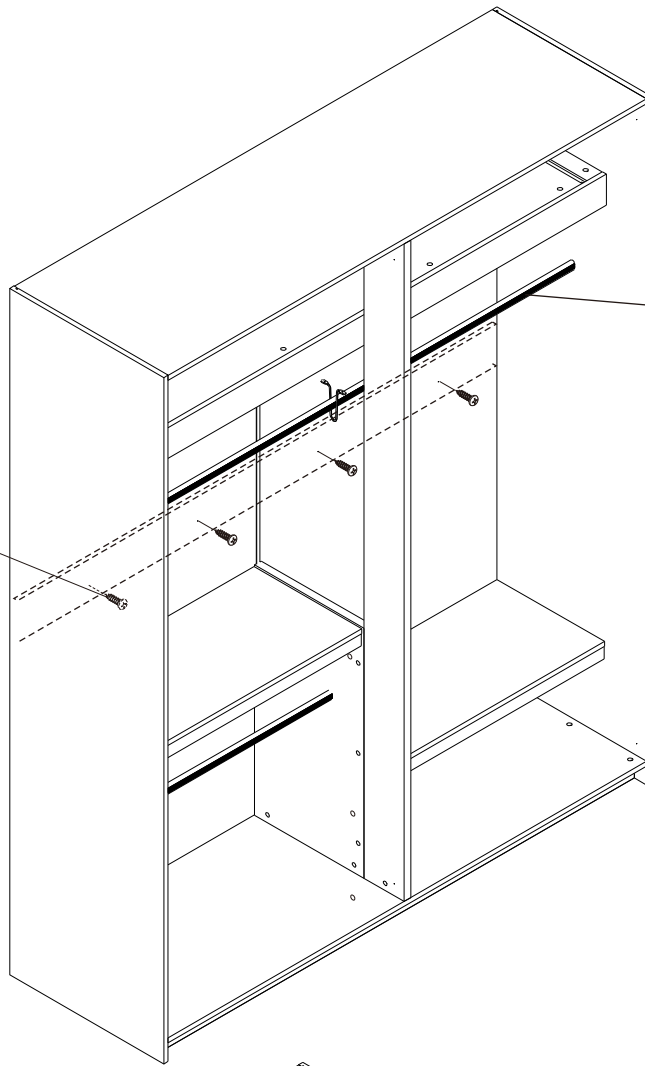
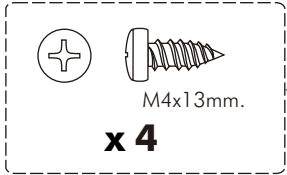

10.

