

SPECAIL

HIGH CABINET TYPE 1 L/R

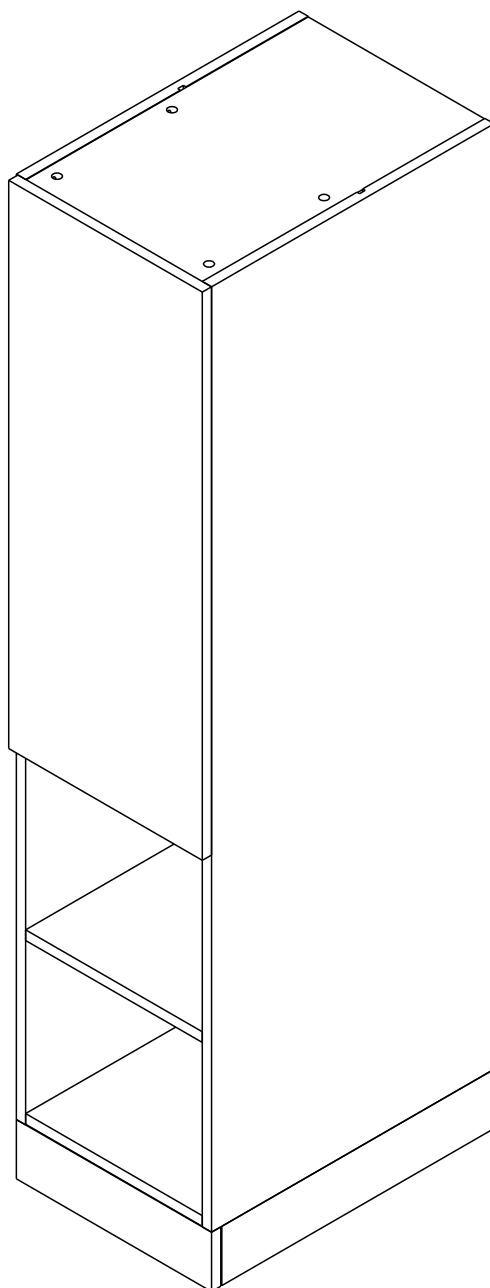



M4x16mm.

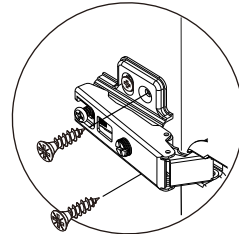
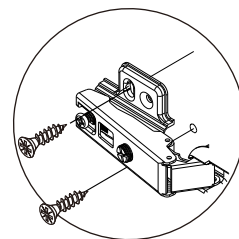
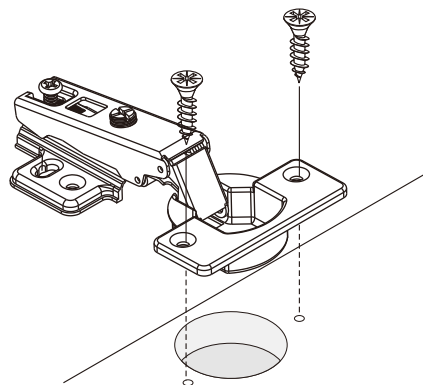
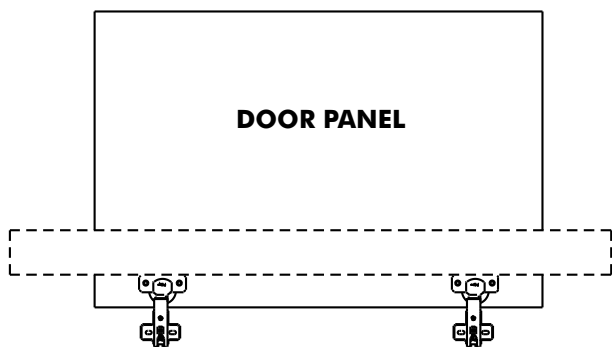



มาตรฐาน การระบุสินค้าที่ต้องยึด Fitting กันลื่น (Safety Fitting) ***หมายเหตุ สินค้าที่เป็นชุดเหล็ก ให้ติดตั้ง Fitting กันลื่นทุกตัว***

■ หมวด ตู้บานเปิด / ตู้บานปิด + ช่องใส่

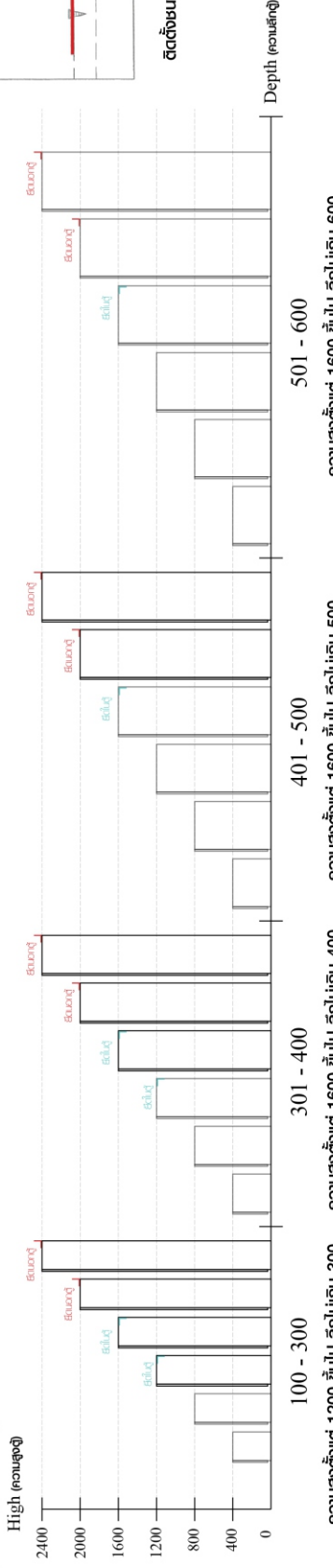

■ หมวด ตู้ลิ้นชัก / ตู้ลิ้นชัก + บานเปิด / ตู้ลิ้นชัก + บานปิด / ตู้ลิ้นชัก + บานสไลด์

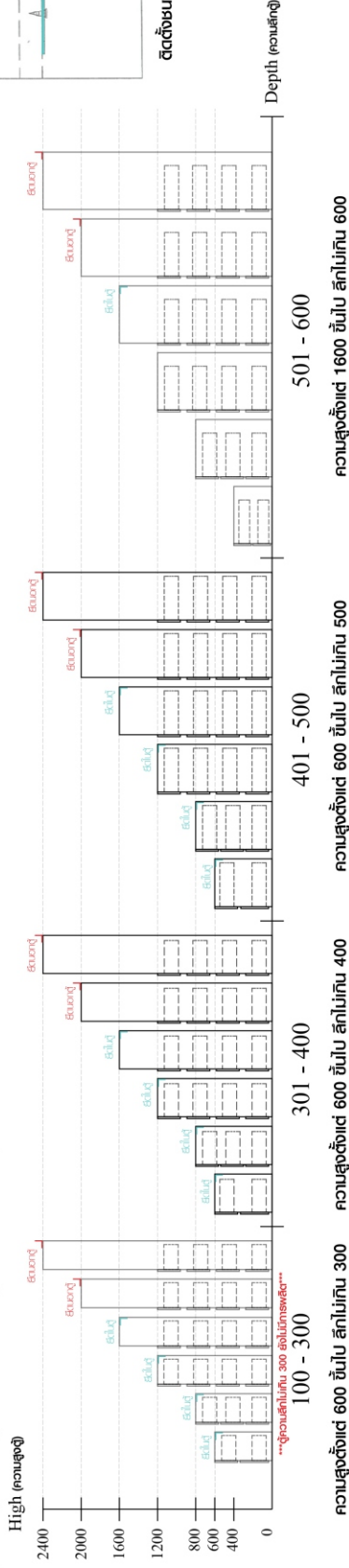

■ หมวด ตู้บานสไลด์ / ตู้ใส

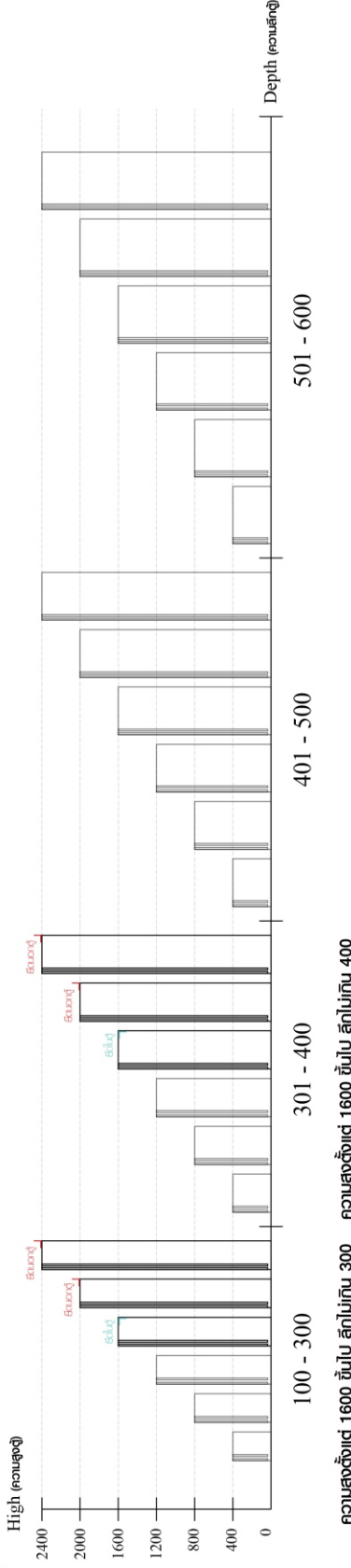

■ ติดตั้งฉากกันลื่นกับตู้สูง (ตั้งแต่ 2 ม.ขึ้นไป)

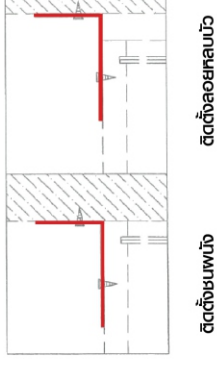

■ ติดตั้งฉากกันลื่นกับตู้เตี้ย (น้อยกว่า 2 ม.)

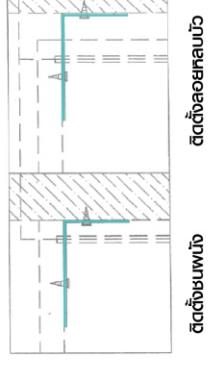

HARDWARE

-BODY SET

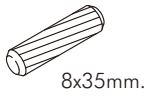

x 28



x 26

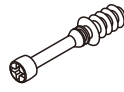

x 26

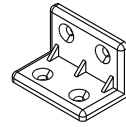

x 2

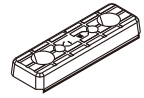

x 6

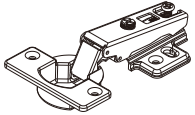

x 2



x 2

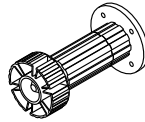

x 4

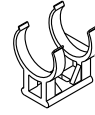

x 6



x 2



#UP-745

x 1

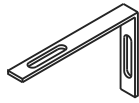

x 1



M4x13mm.

x 4



M4x16mm.

x 48

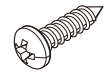

M4x16mm.

x 1



M5x50mm.

x 1

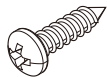

M4x20mm.

x 2

ASSEMBLY

-BODY SET

1.

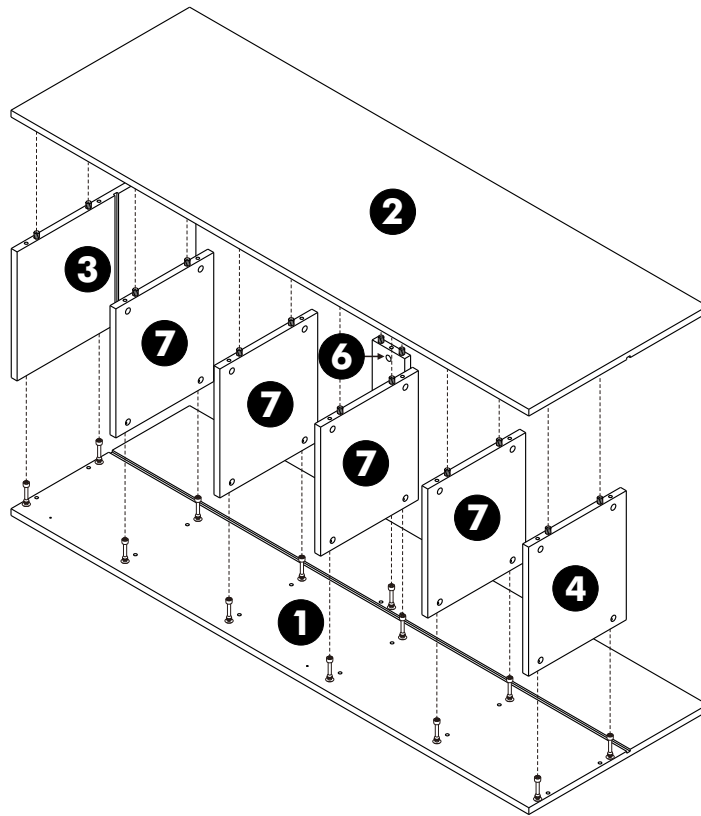

2.

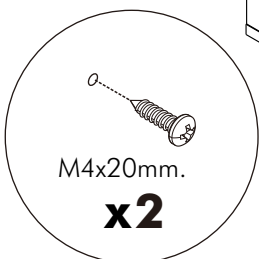
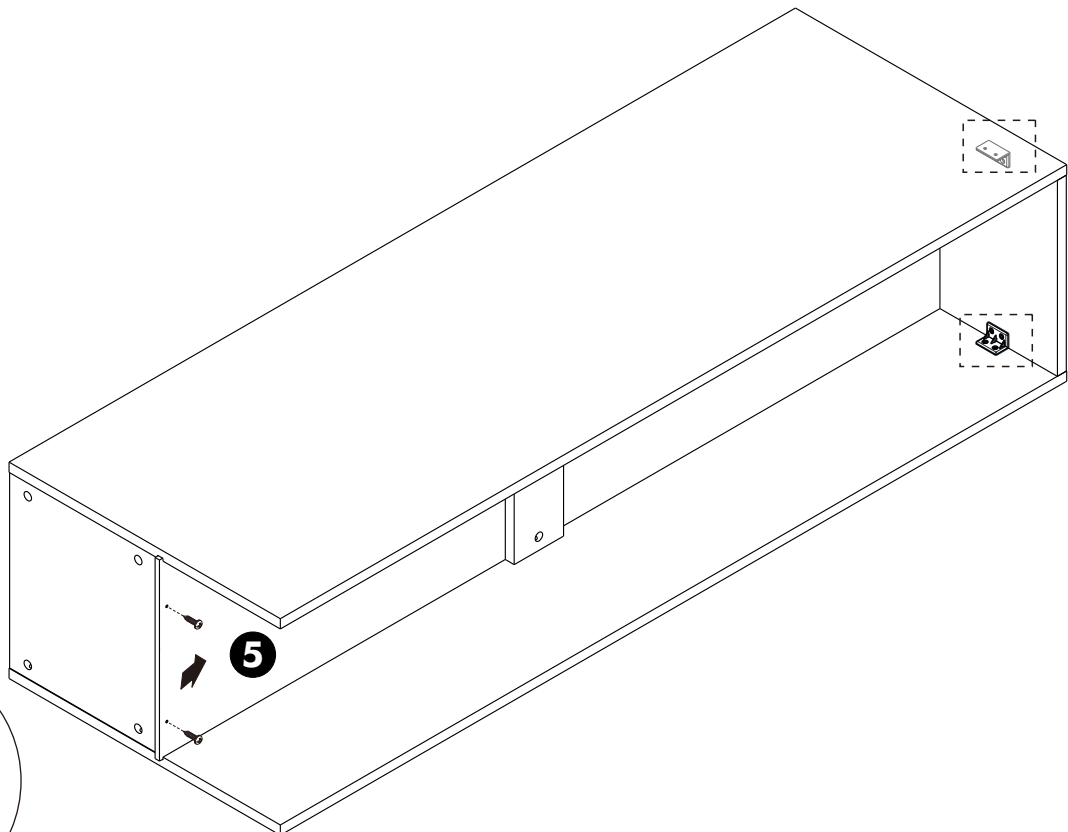

3.

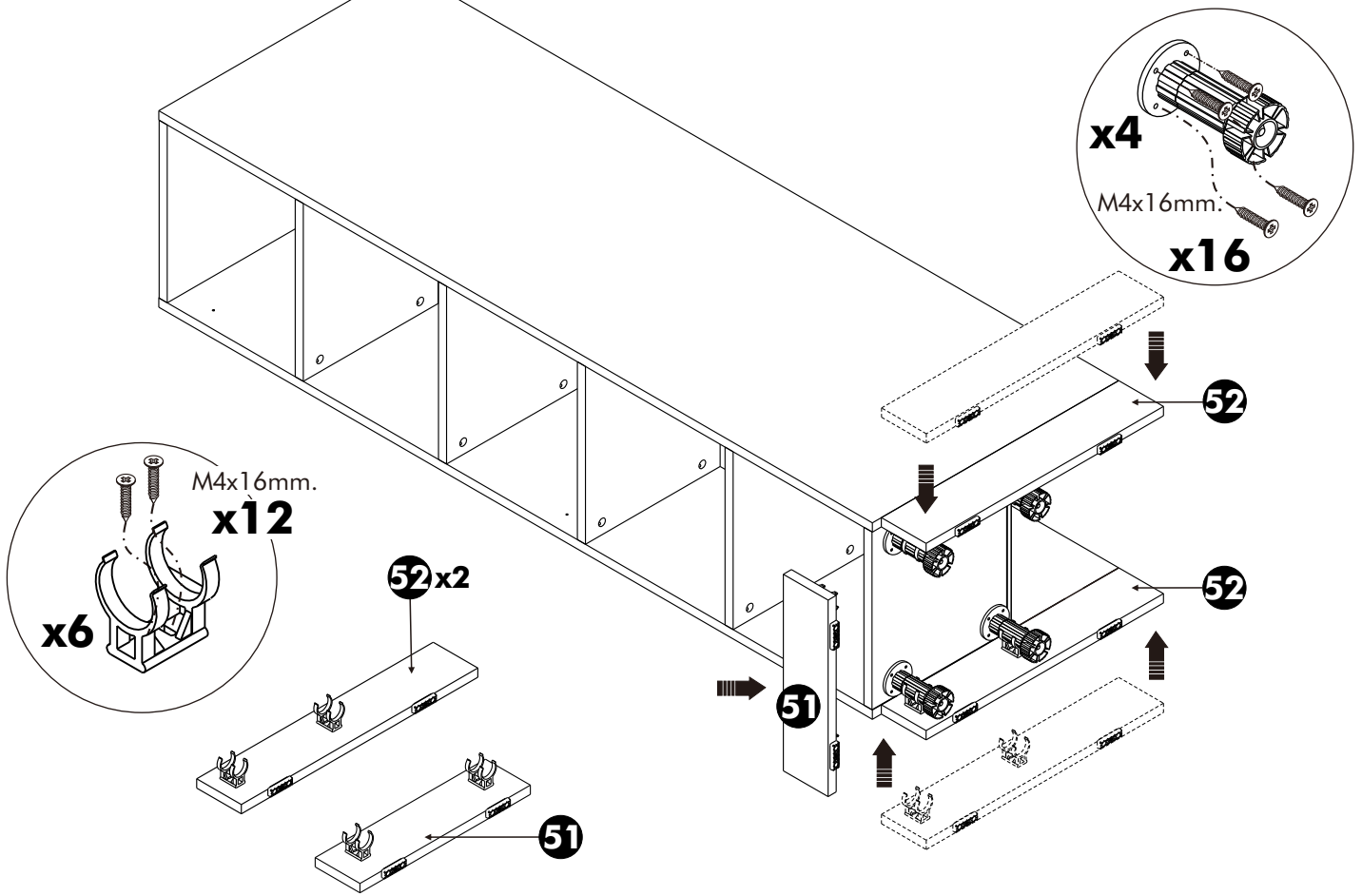

4.

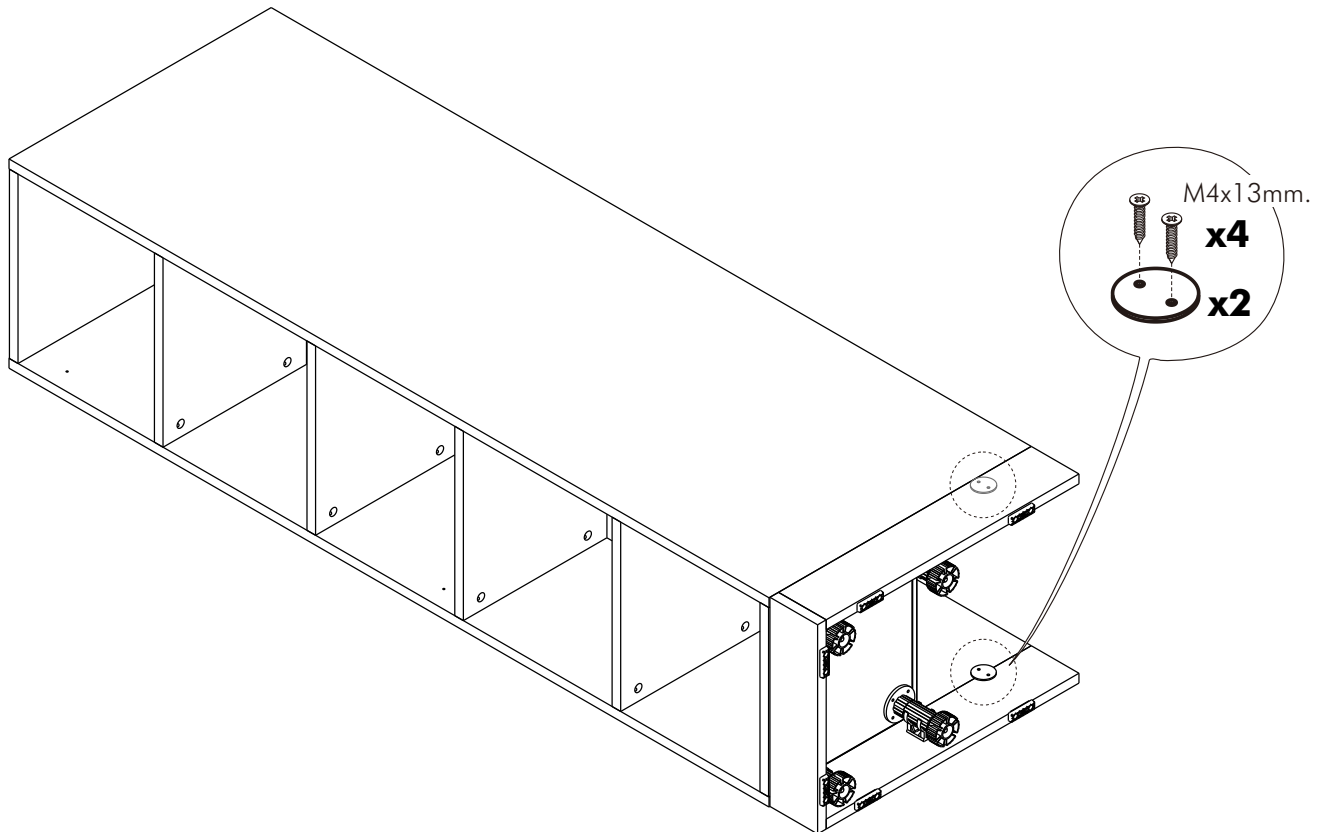

5.

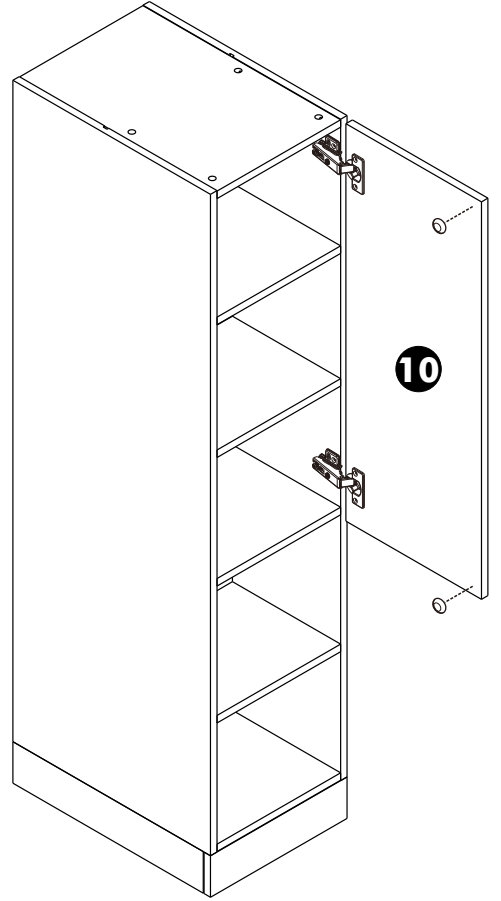
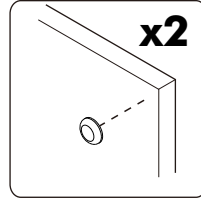
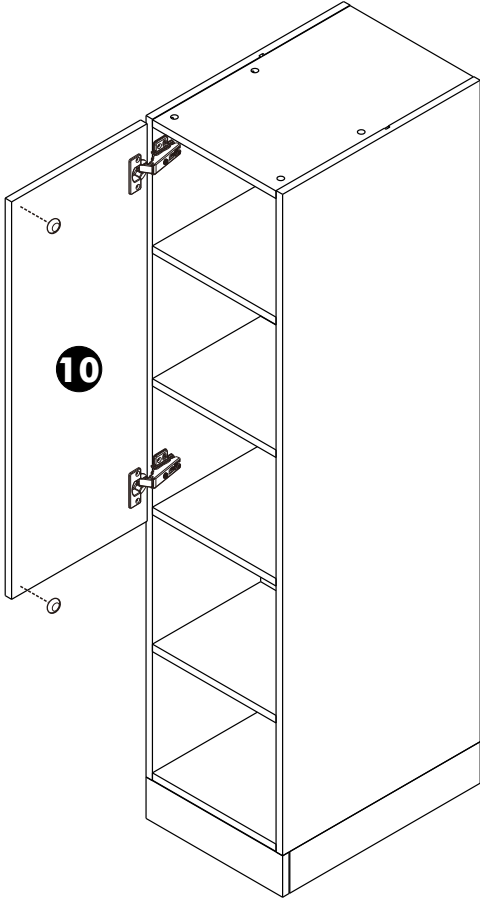

TYPE: L

TYPE: R