

FLORENCE

Chest 6 drawer

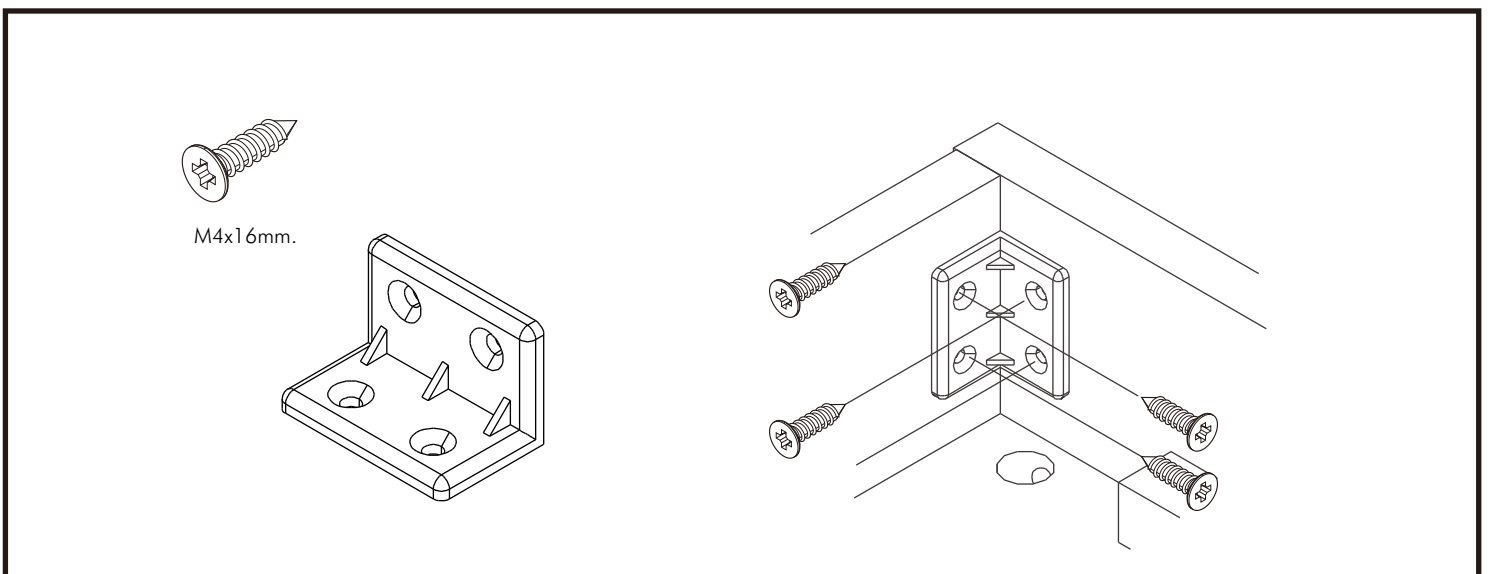

CONNECT SYSTEM

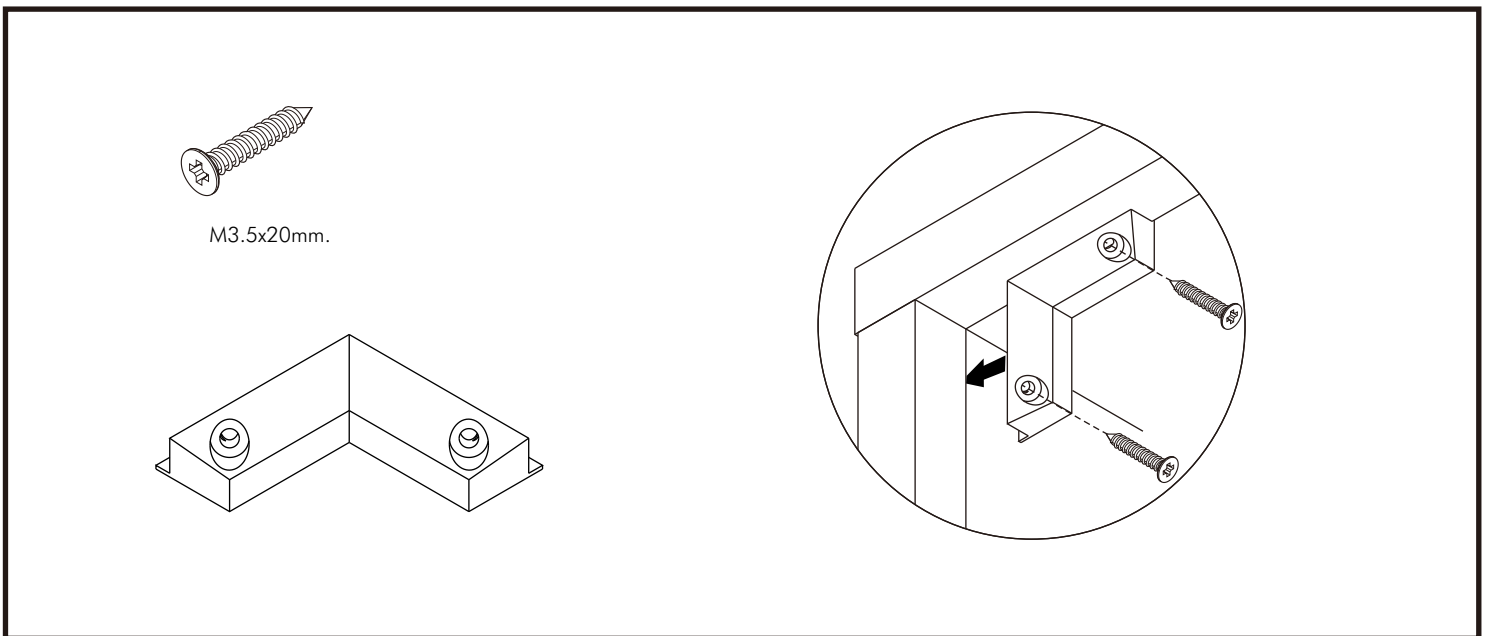
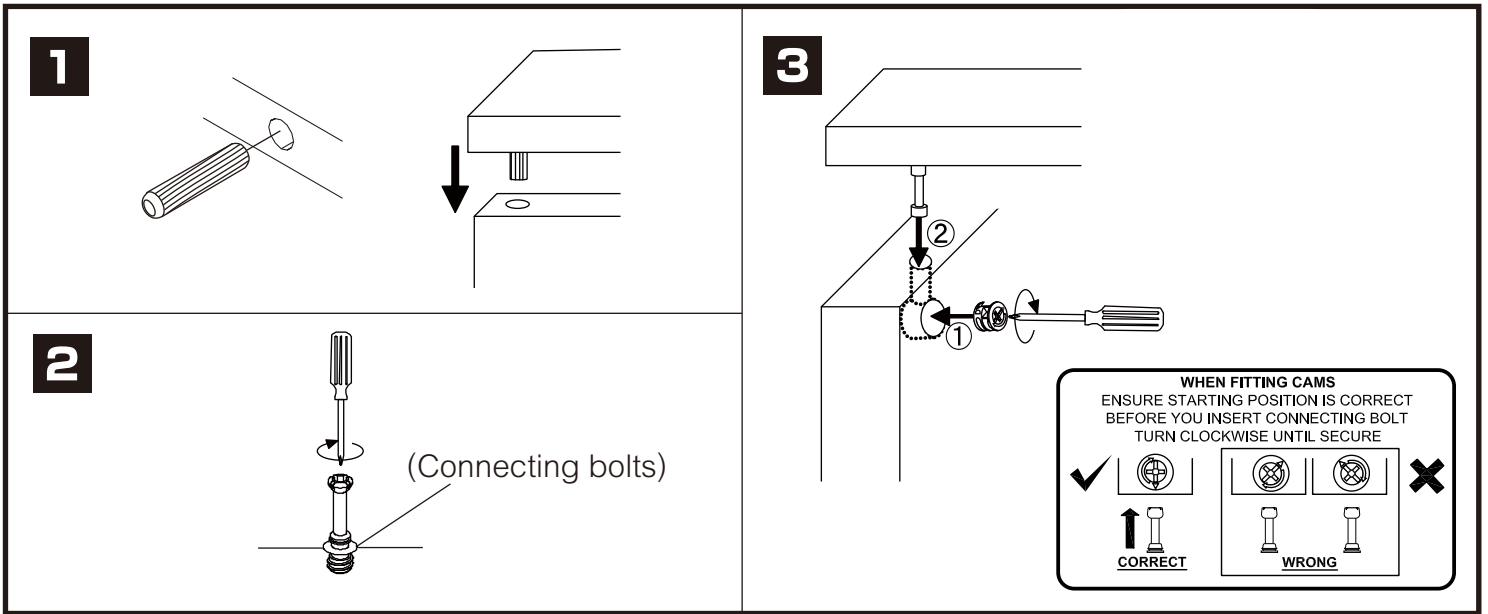

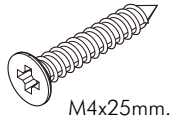

M4x25mm.

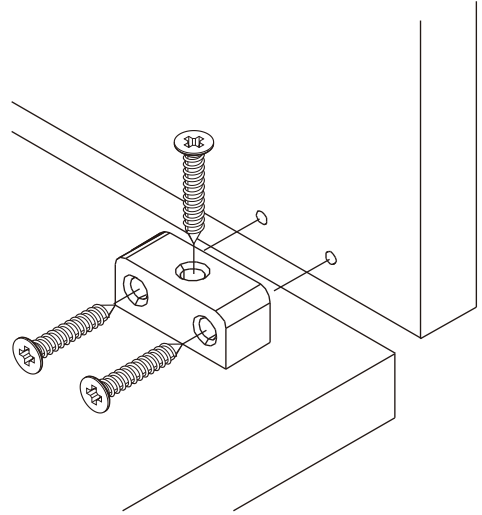
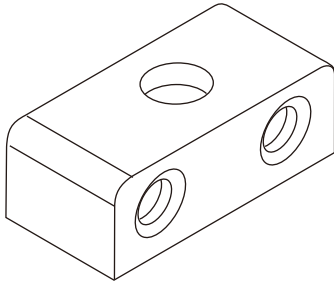

M3.5x13mm.

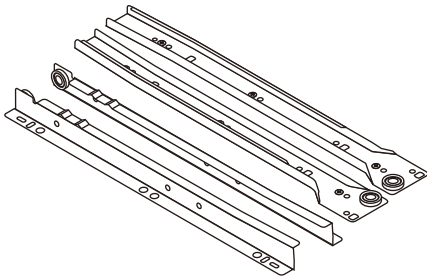
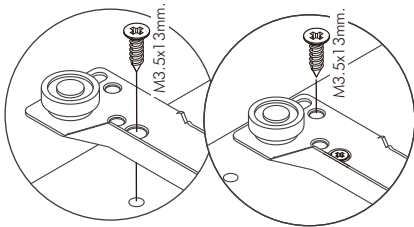

1

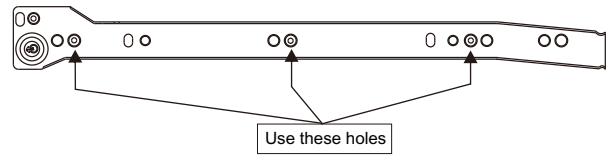

2

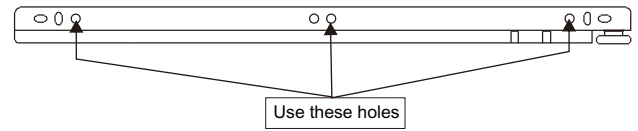

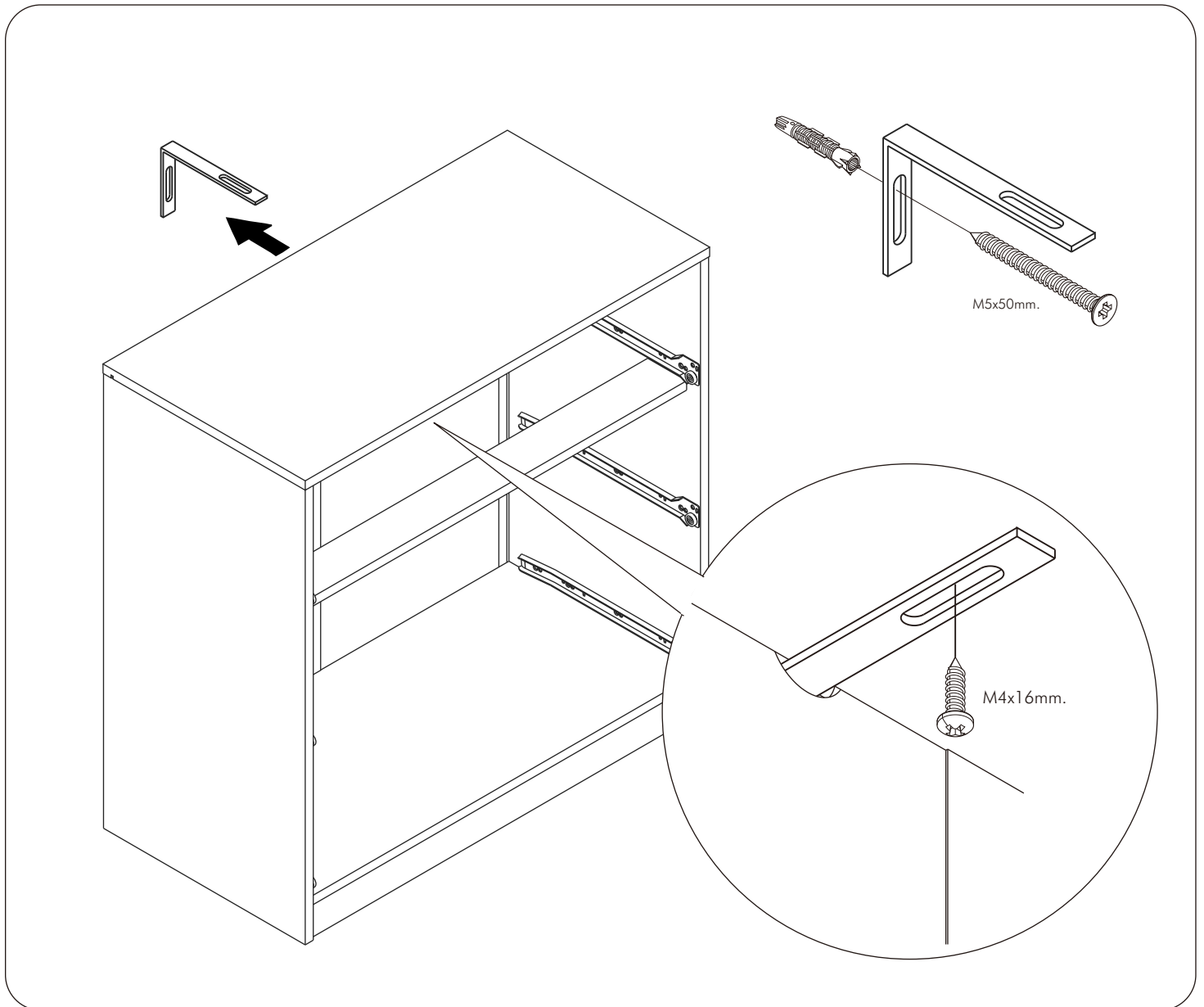

มาตรฐาน การระบุสินค้าที่ต้องยึด Fitting กันลื่น (Safety Fitting) ***หมายเหตุ สินค้าที่เป็นชุดเหล็ก ให้ติดตั้ง Fitting กันลื่นทุกตัว***

■ หมวด ตู้บานเปิด / ตู้บานปิด + ช่องใส่

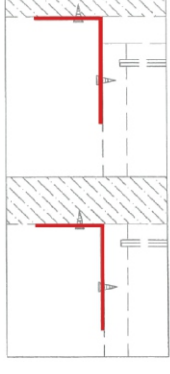

ติดตั้งบนพวง

ติดตั้งลดยกลบวง

■ หมวด ตู้ลิ้นชัก / ตู้ลิ้นชัก + บานเปิด / ตู้ลิ้นชัก / ตู้ลิ้นชัก + บานใส่

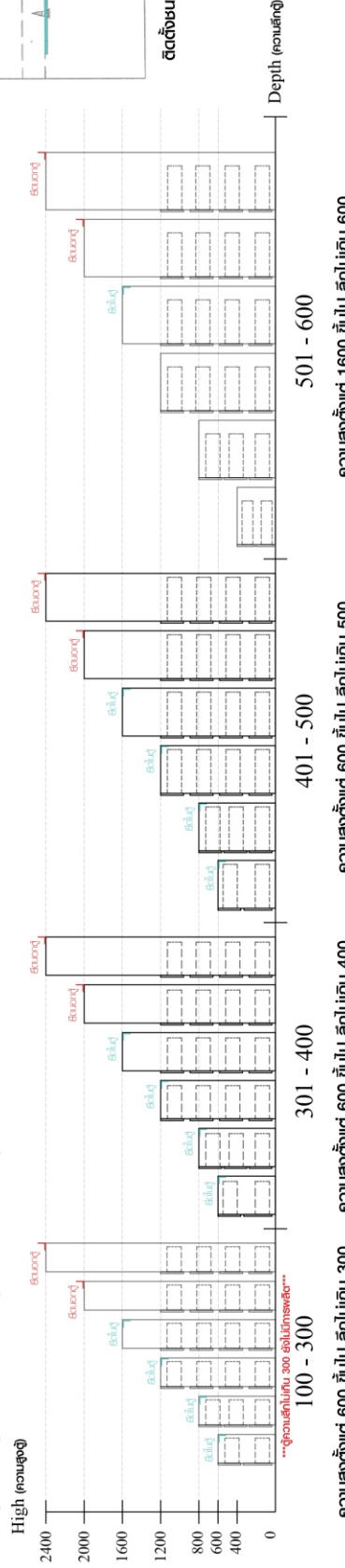

ติดตั้งบนพวง

ติดตั้งลดยกลบวง

■ หมวด ตู้บานใส่ / ตู้ใส่

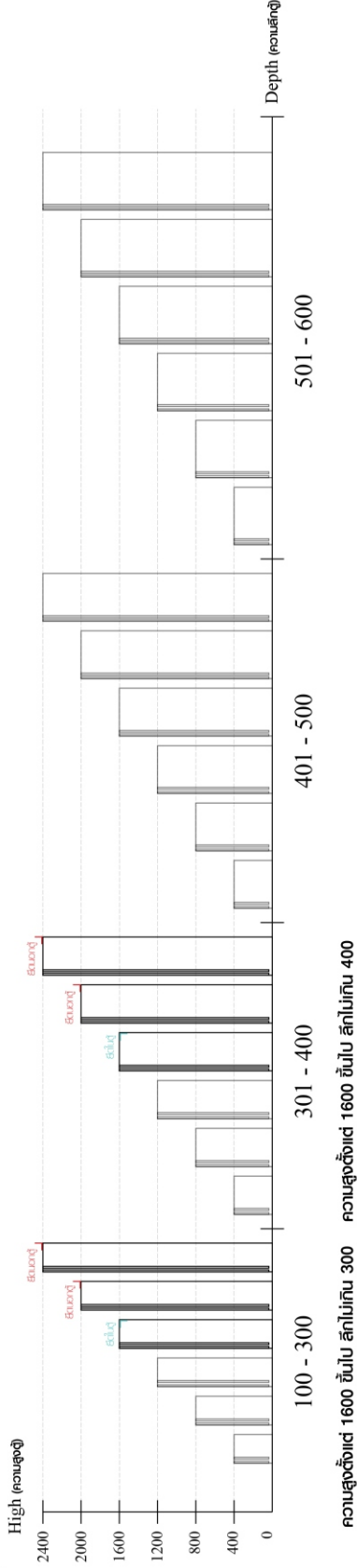

■ ติดตั้งฉากกันลื่นกับตู้สูง (ตั้งได้ 2 ม.ขึ้นไป)

HARDWARE

-BODY SET



x 24



x 18

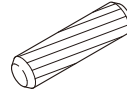

x 42



x 6

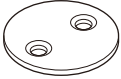

x 2

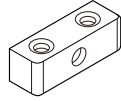

x 2

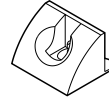

x 8

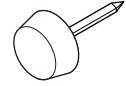

x 4

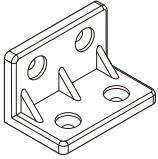

x 14

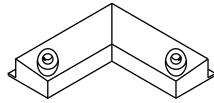

x 2



5x18 mm.

x 2

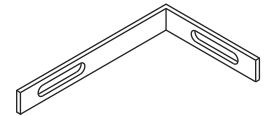

x 2

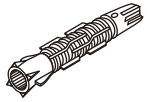

x 2

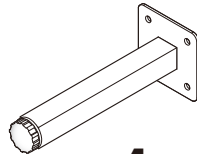

x 1



x 3

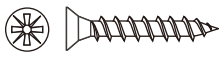

M3.5x20mm.

x 12



M4x16mm.

x 60



M4x25mm.

x 30



M4x30mm.

x 8



M4x50mm.

x 2



M5x50mm.

x 2



M4x16mm.

x 27

-DRAWER SET

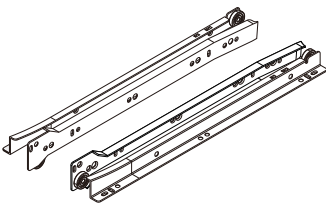

x 6 Set



M3.5x13mm.

x 84

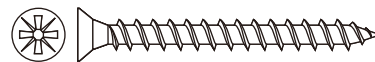

M4x40mm.

x 60

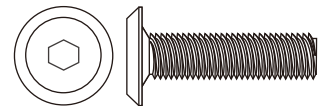

M6x25mm.

x 26

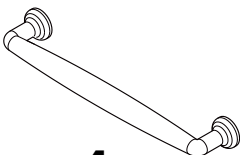

x 4

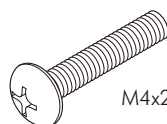

M4x22mm.

x 8

ASSEMBLY

-BODY SET

1.

-PART No.21,24



#19mm. **x 6**

Ø 5x18 mm.

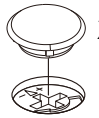

x 2

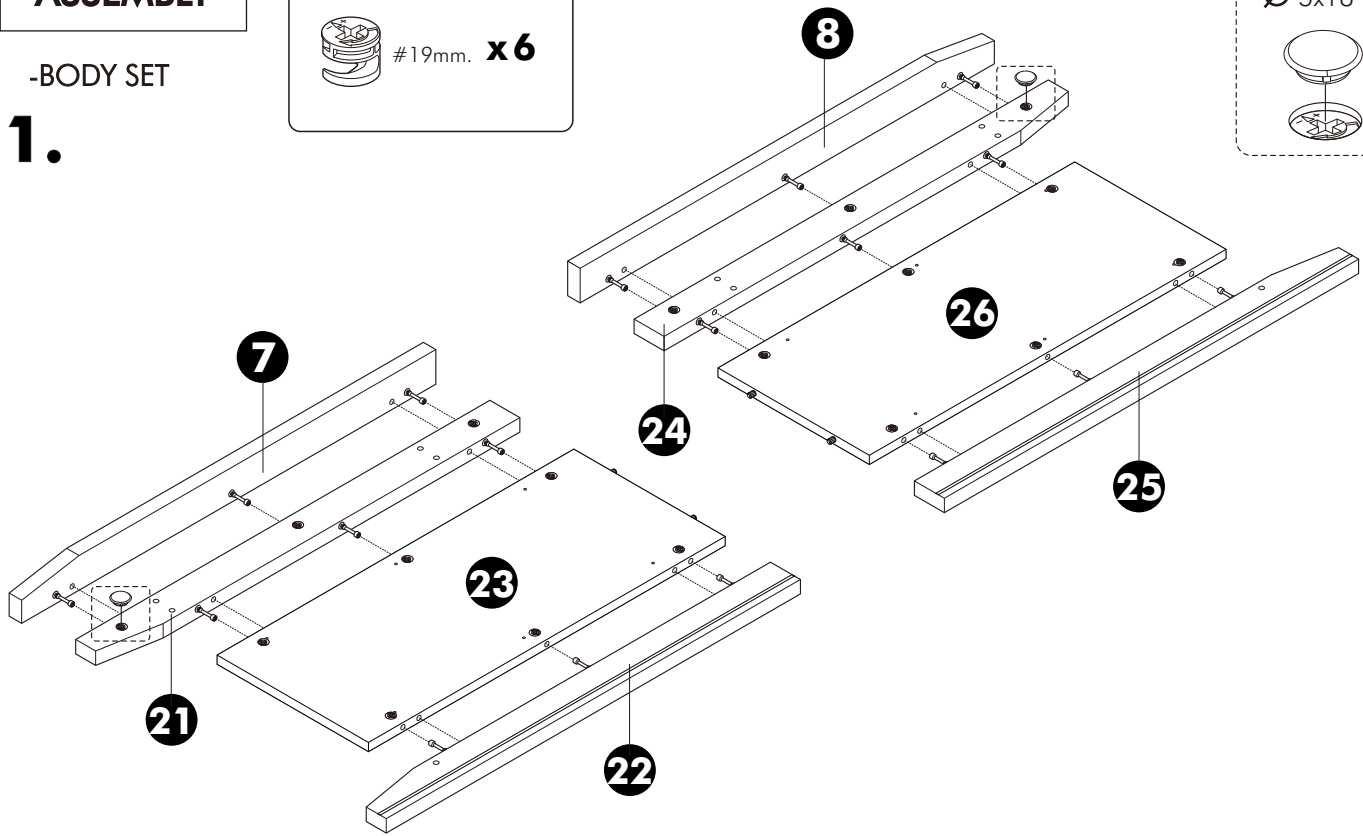

2.

NO GAP

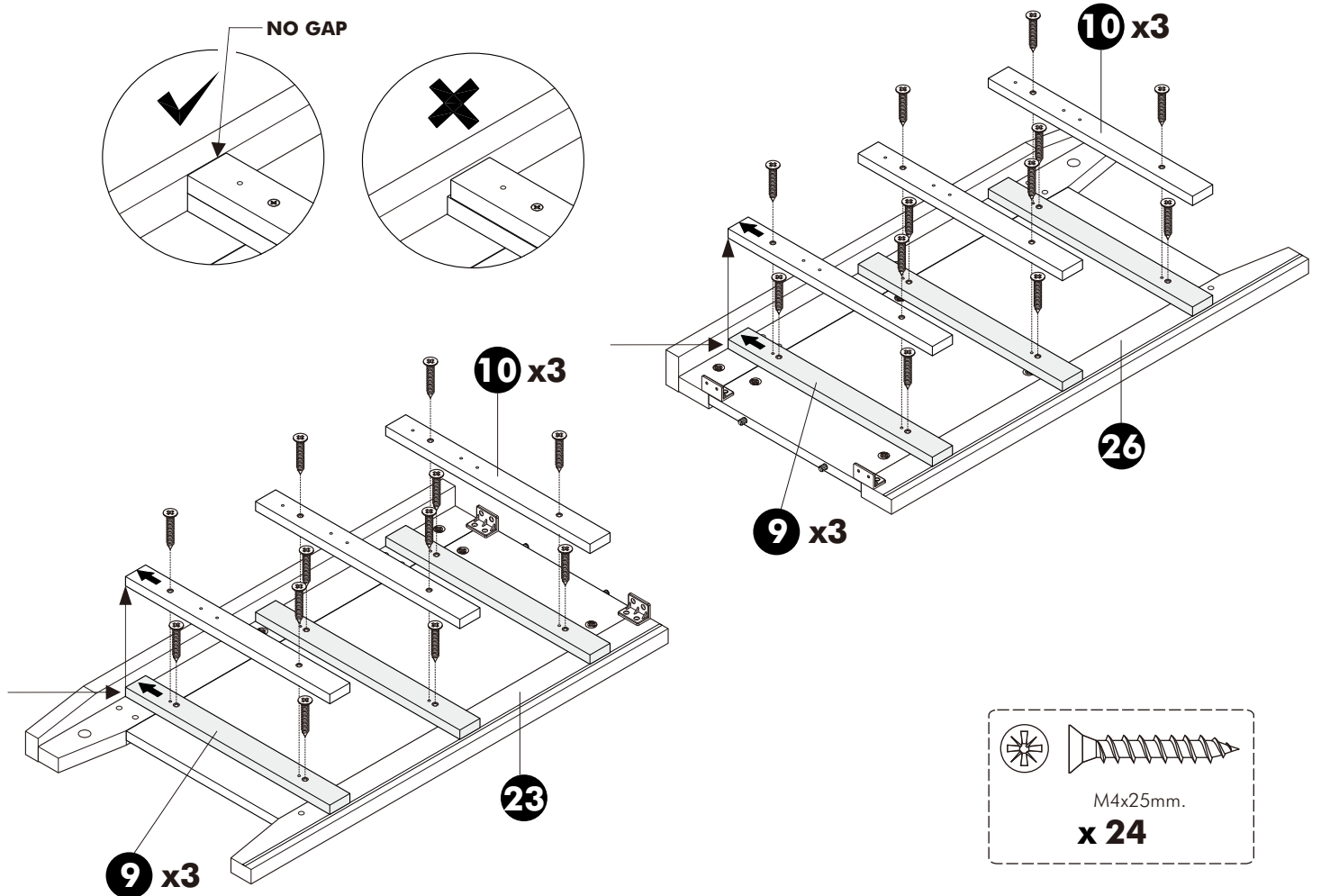
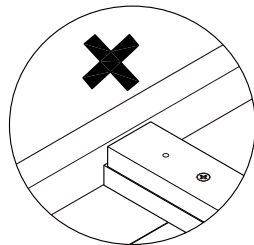
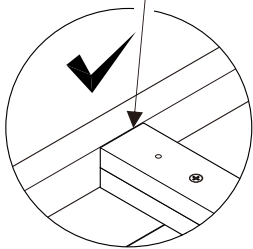

3.

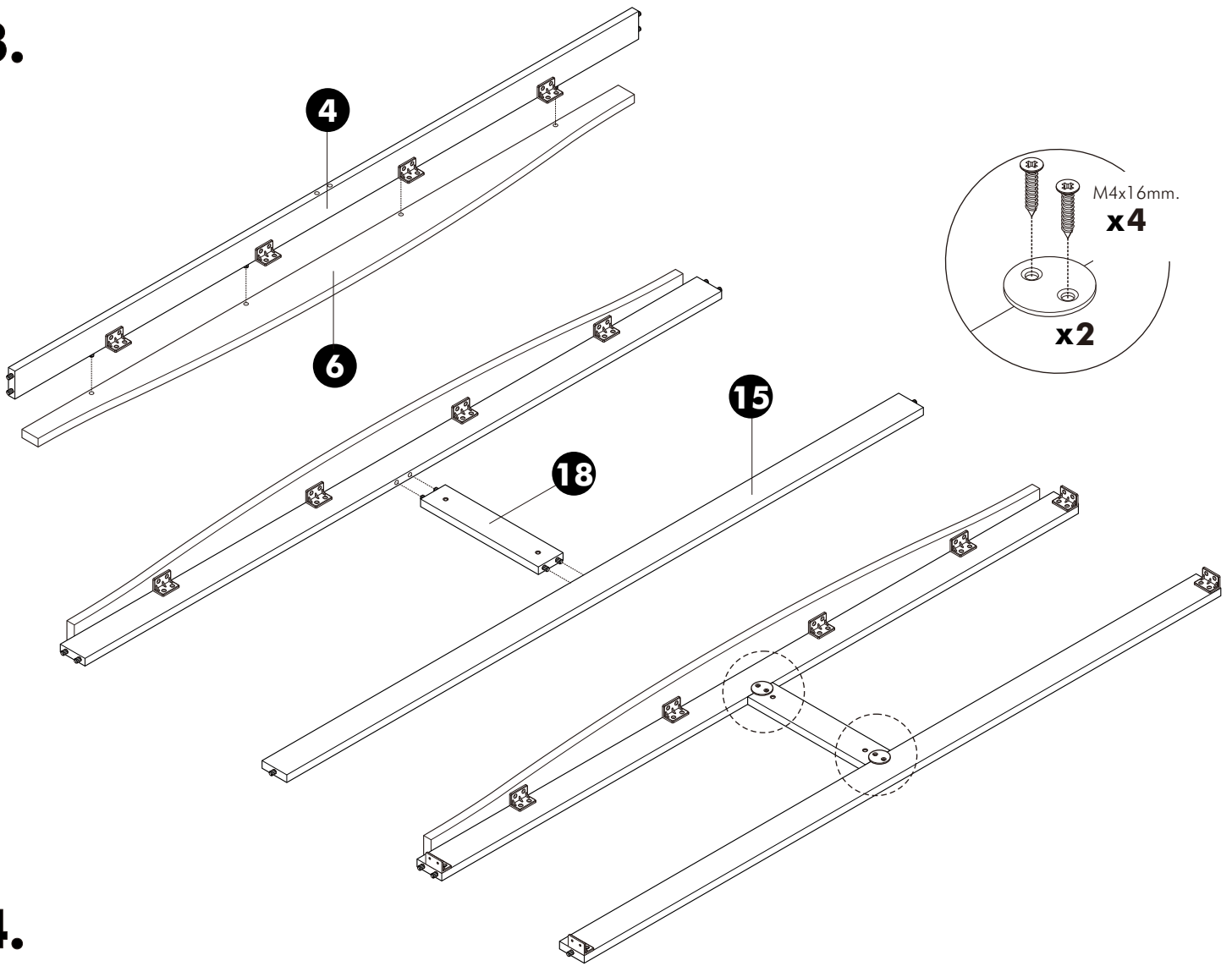

4.

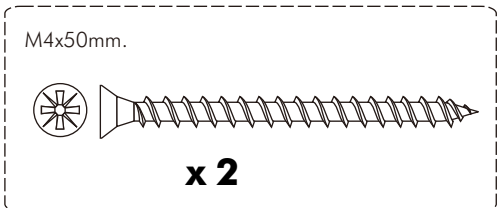
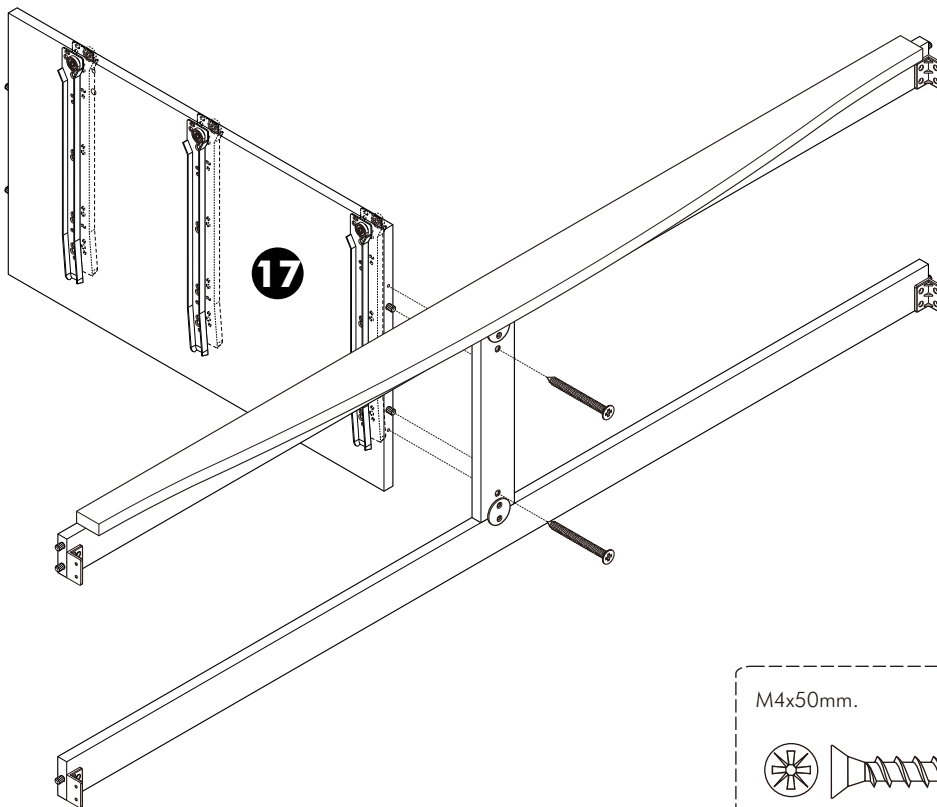

5.

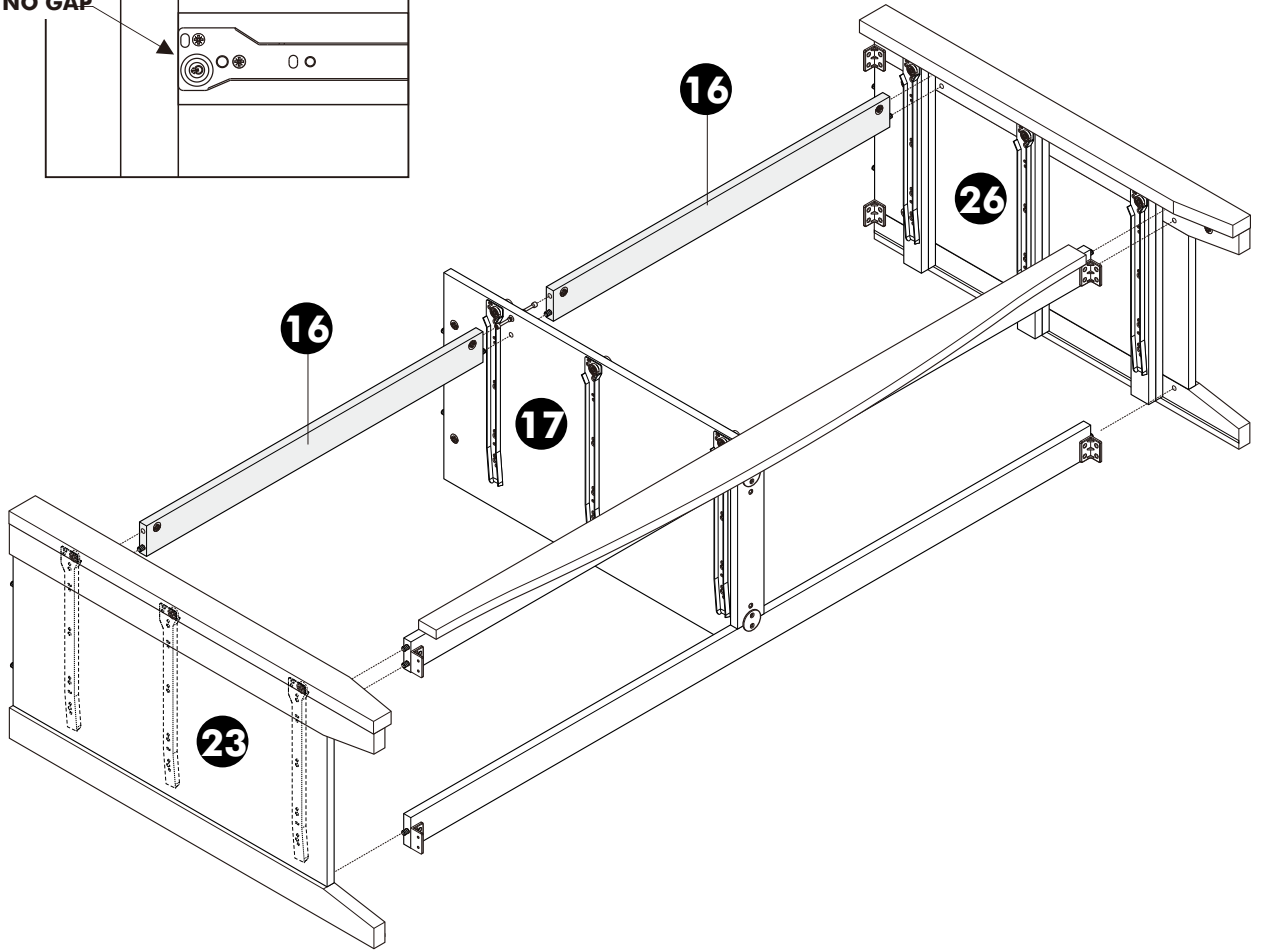
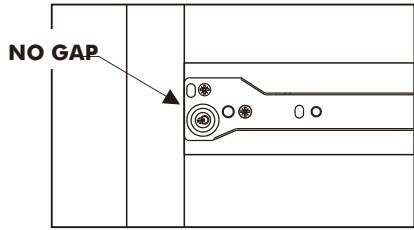

6.

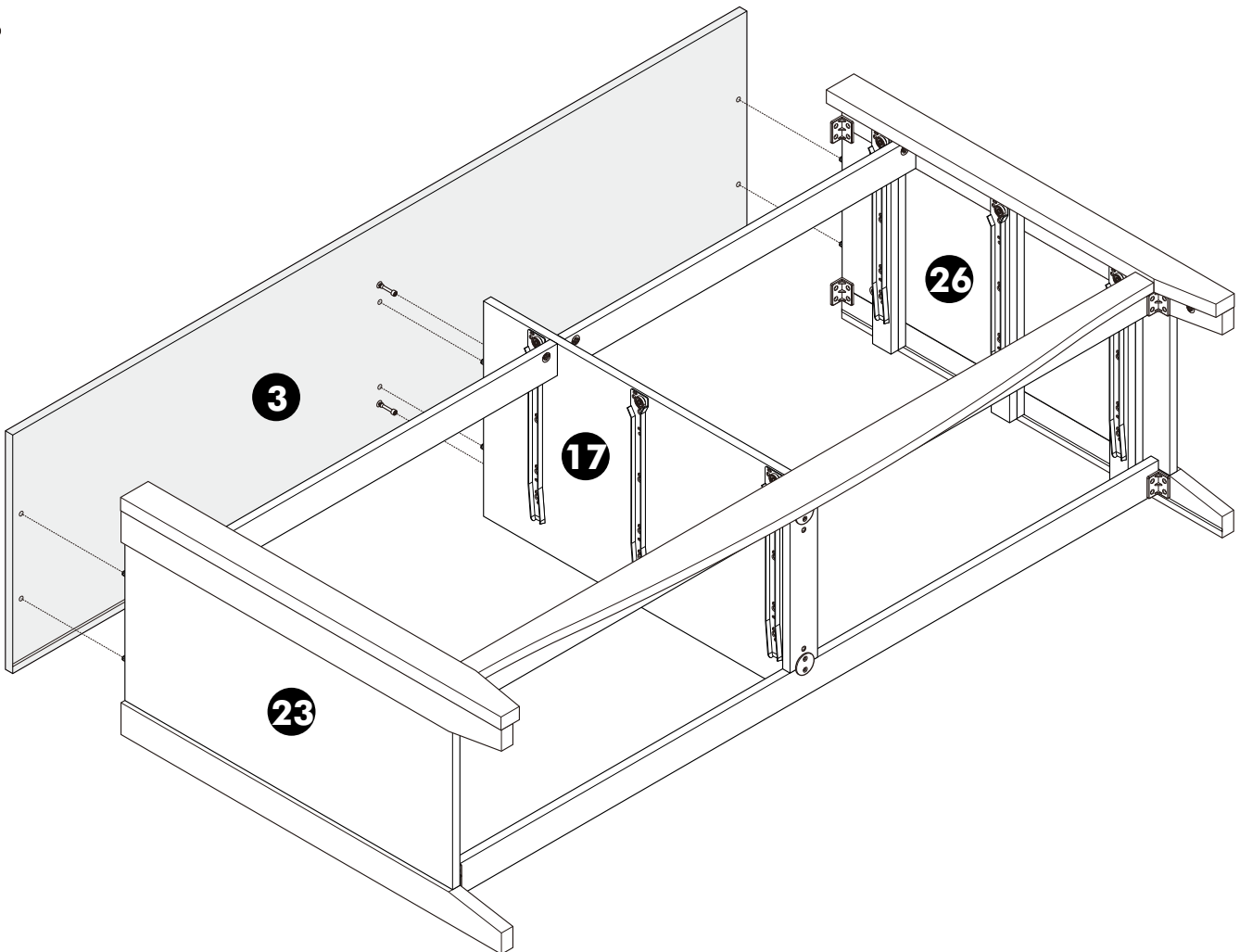

7.

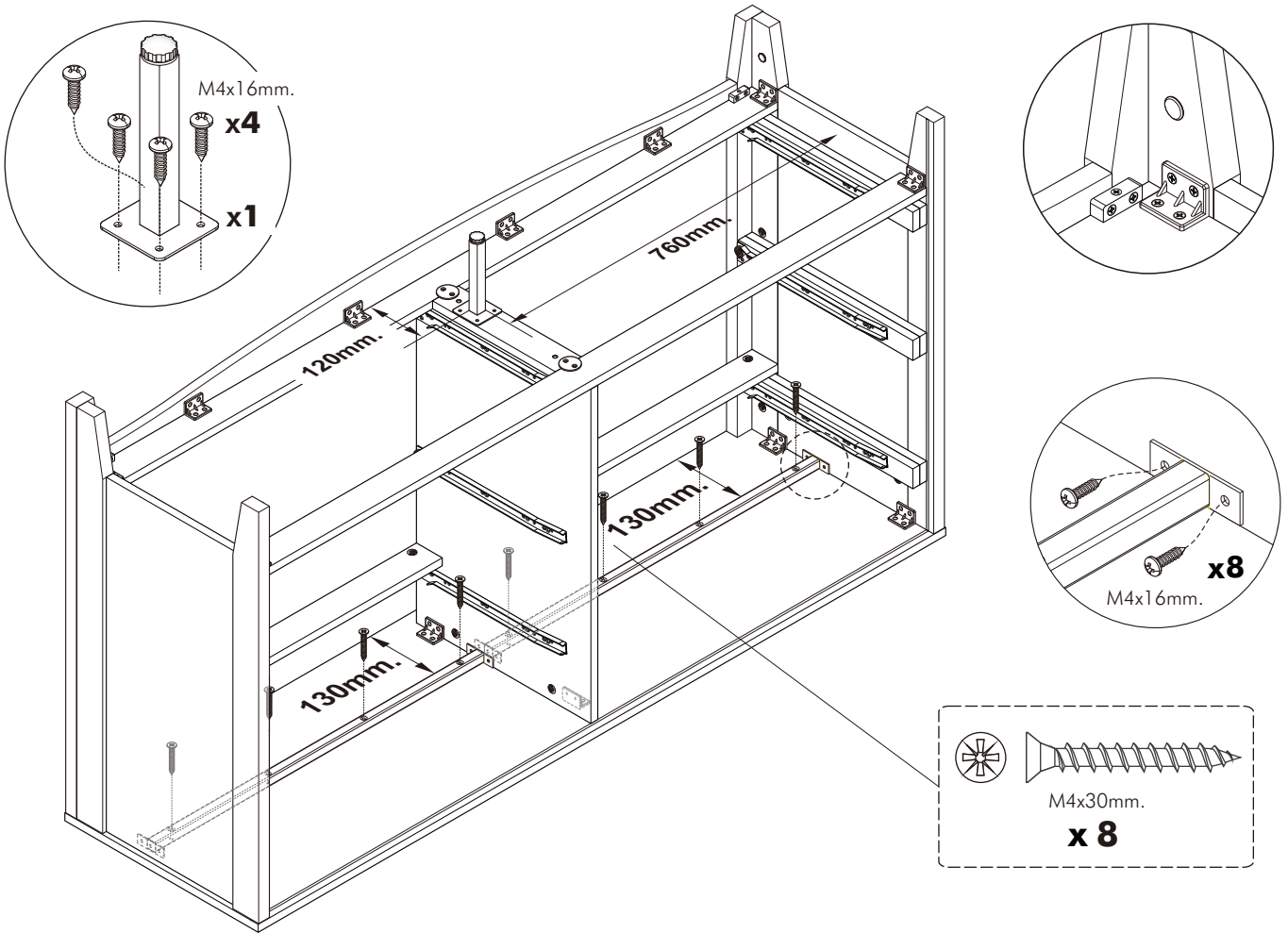

8.

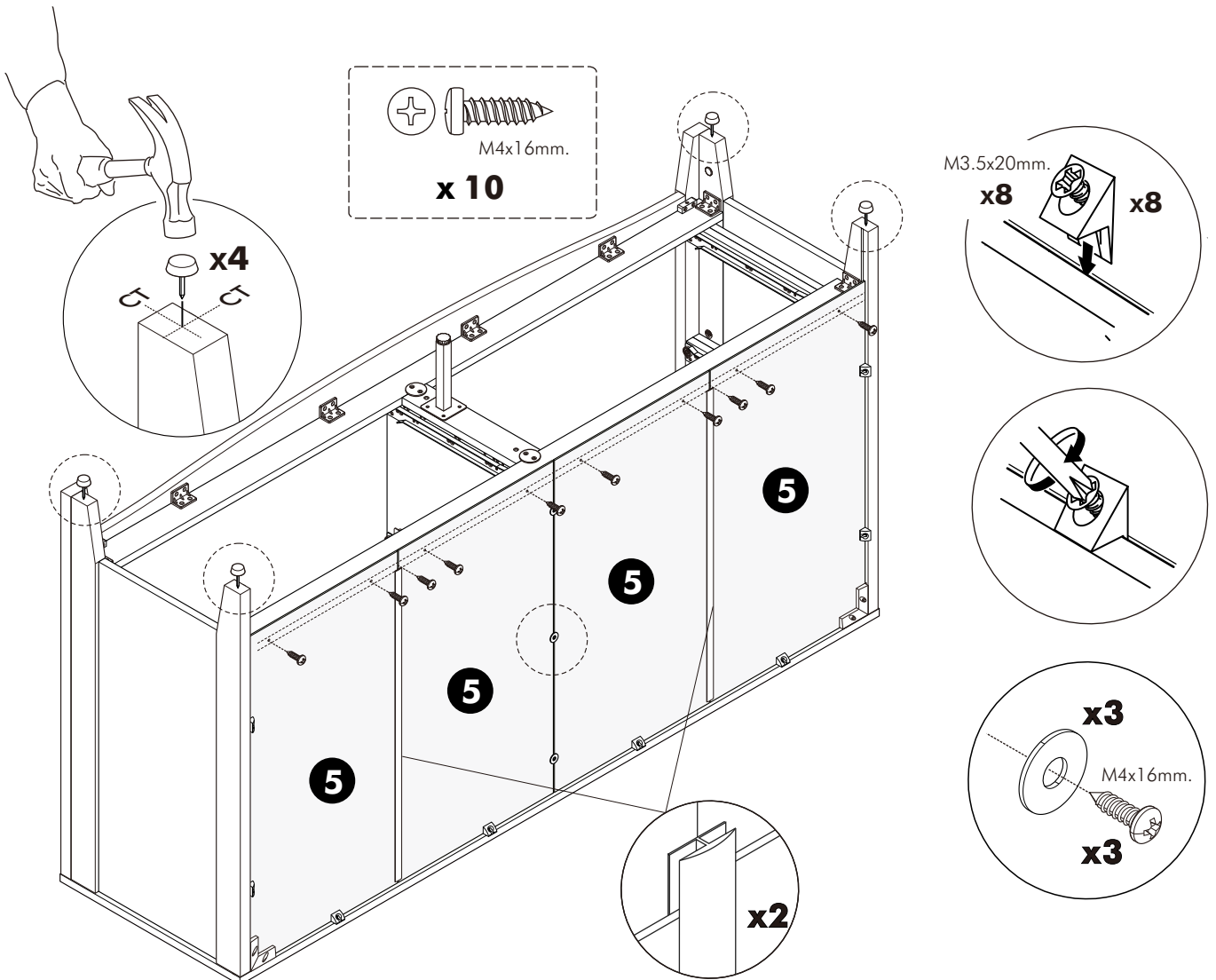

ASSEMBLY

-DRAWER SET

1.

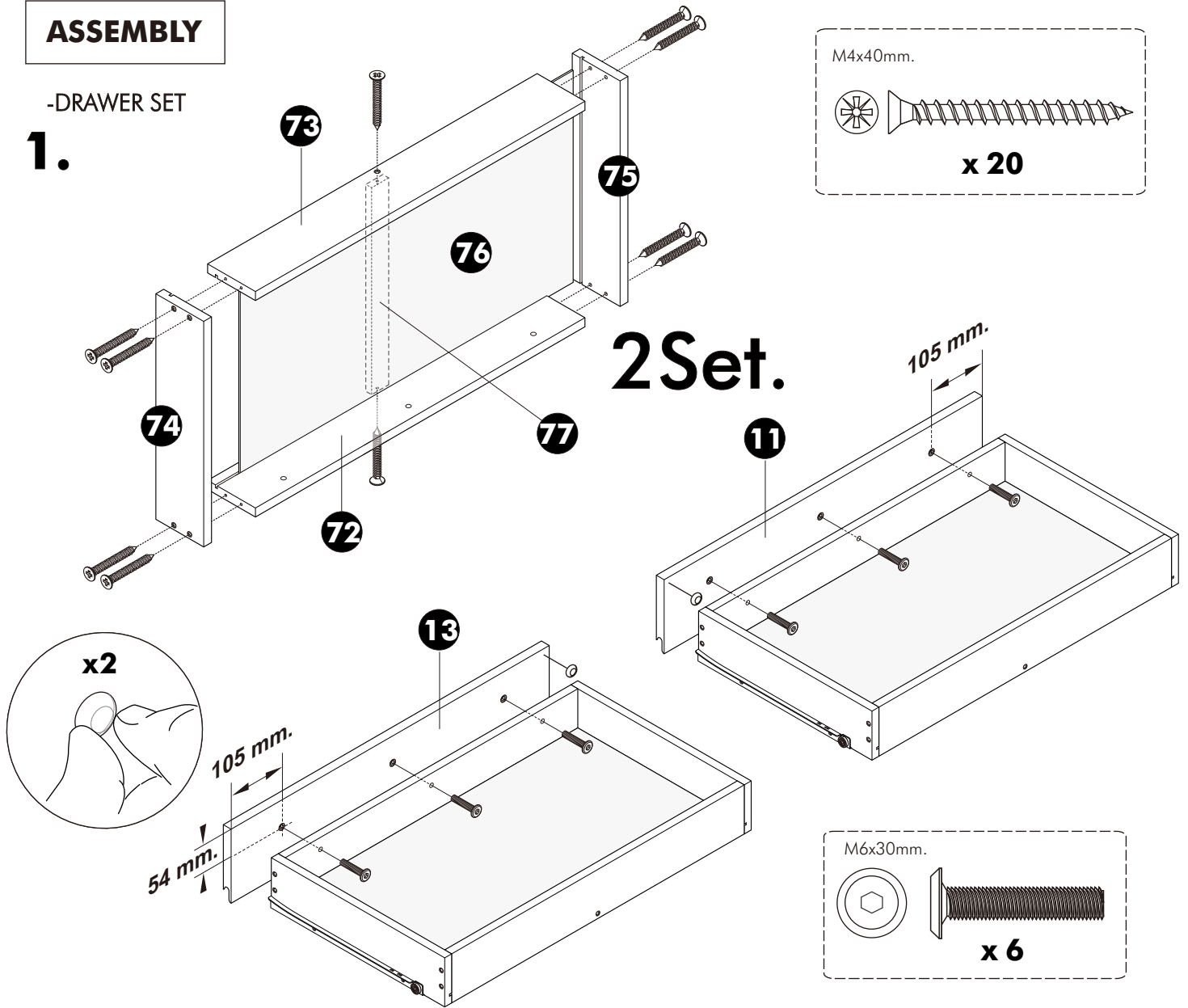

2.

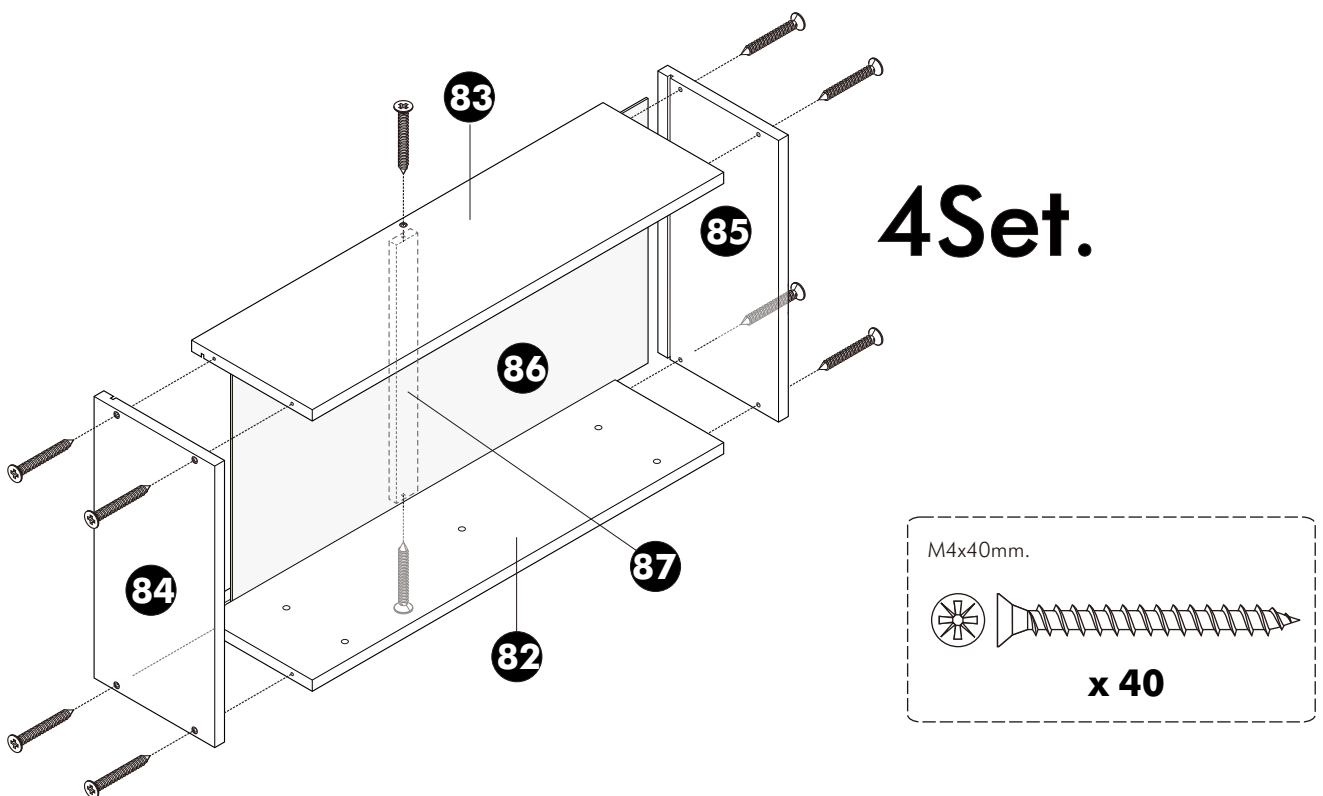

3.

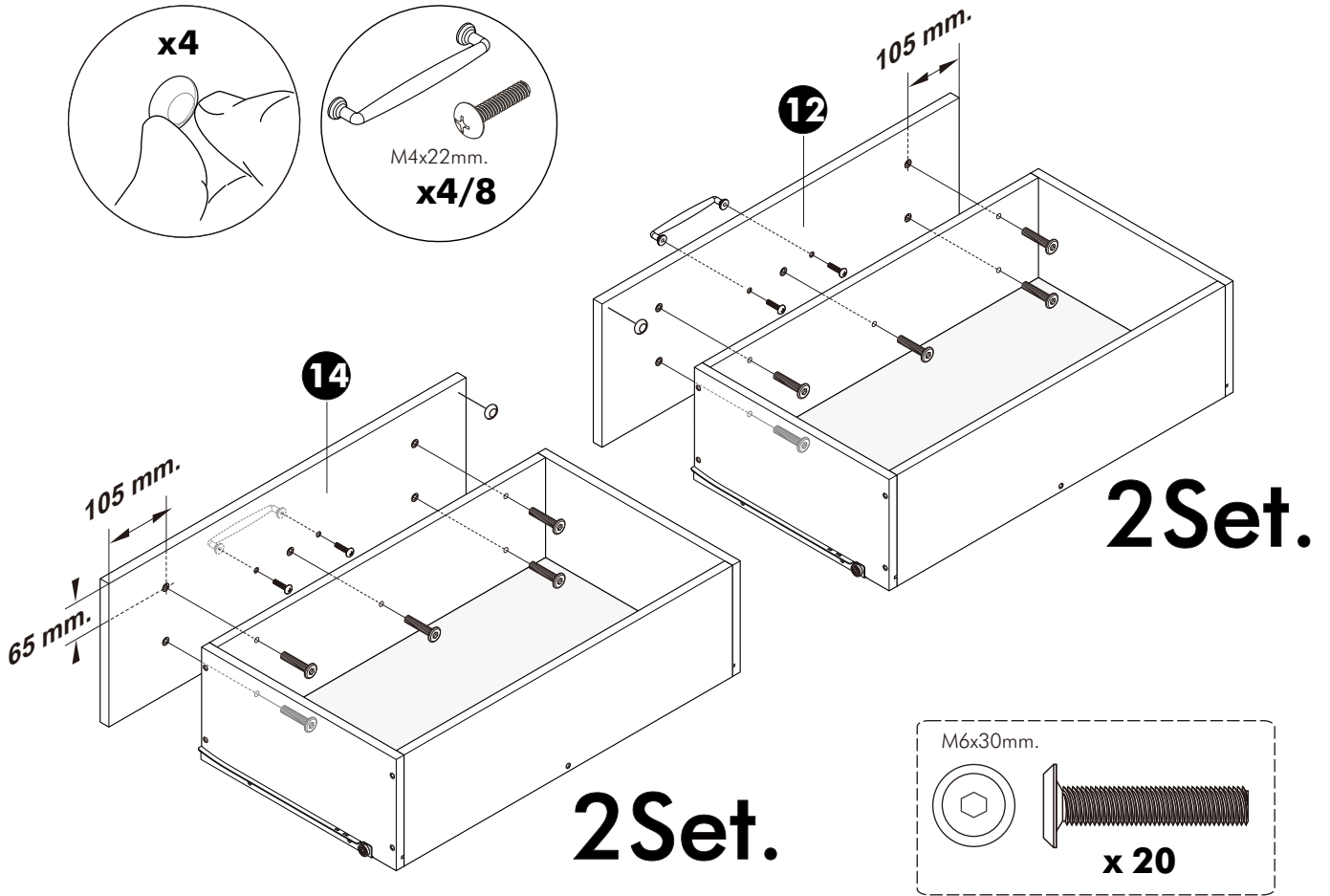
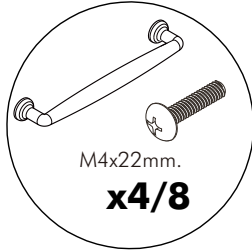
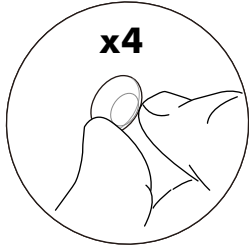

4.

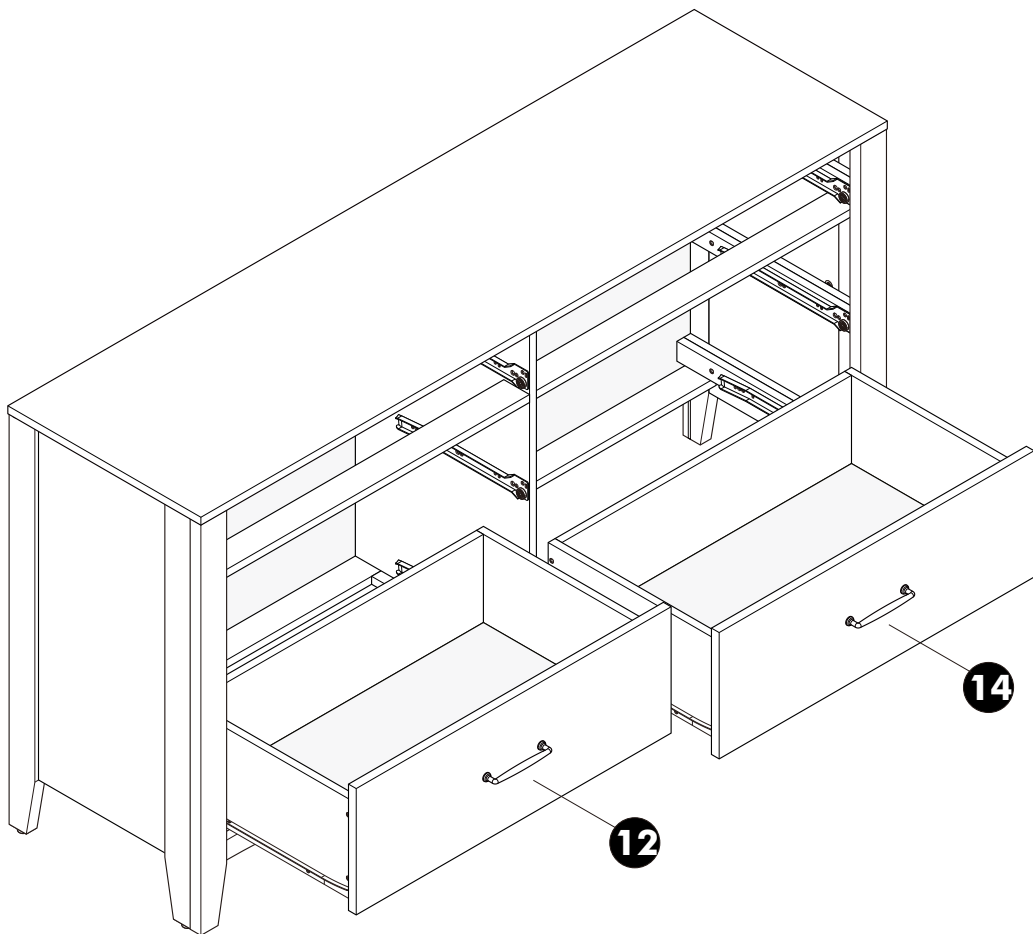

5.

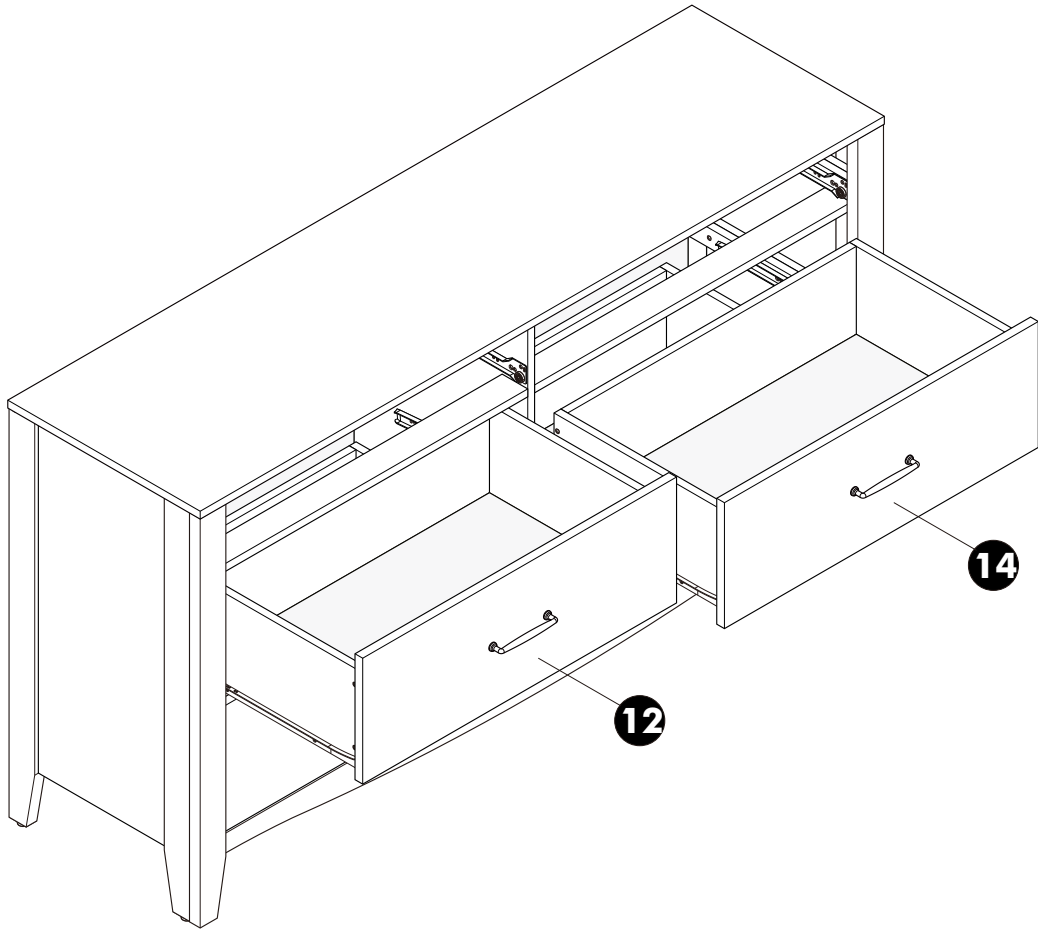

6.

