

ISTANBUL

Dressing table 120 Cm.

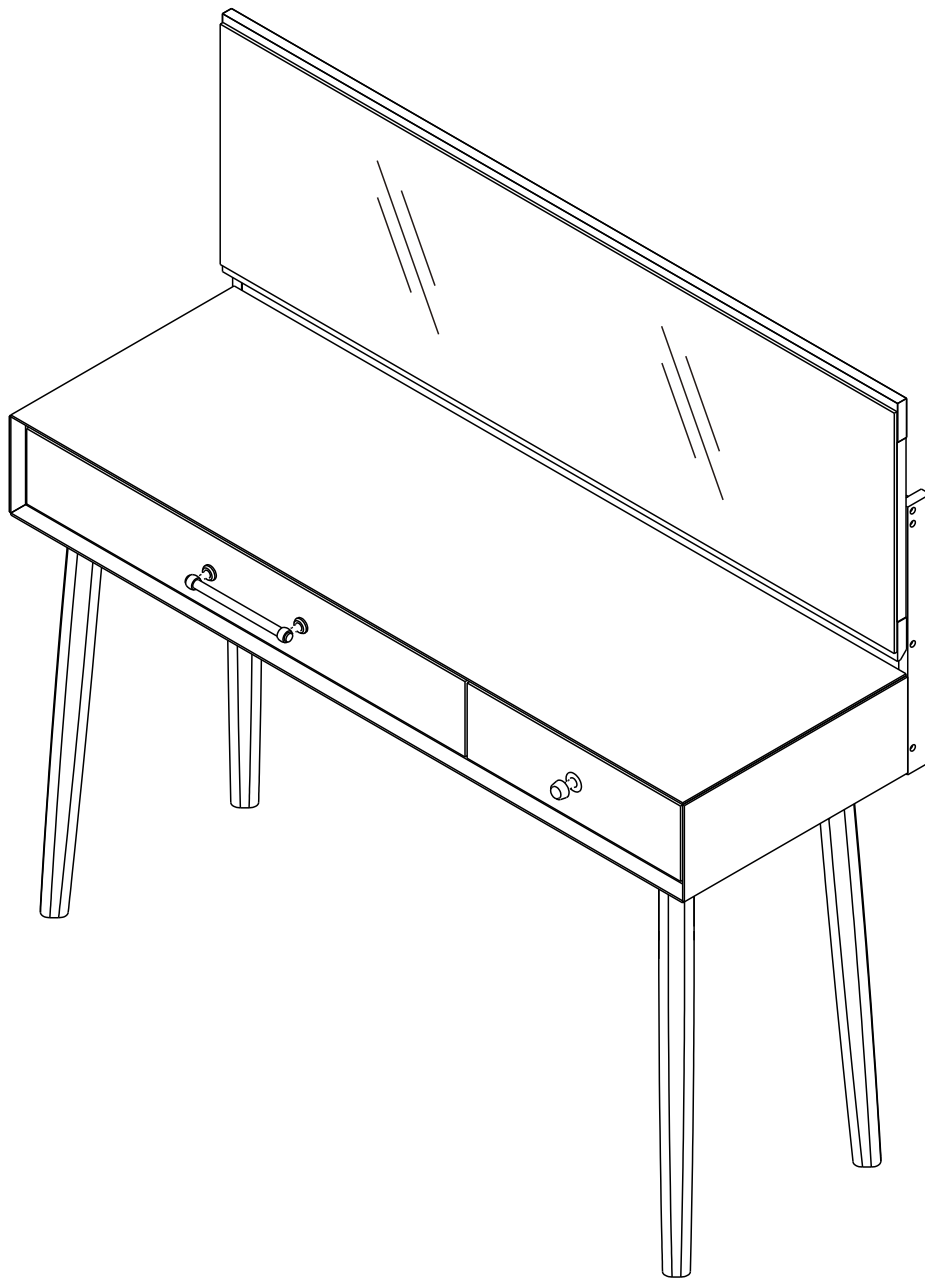

CONNECT SYSTEM

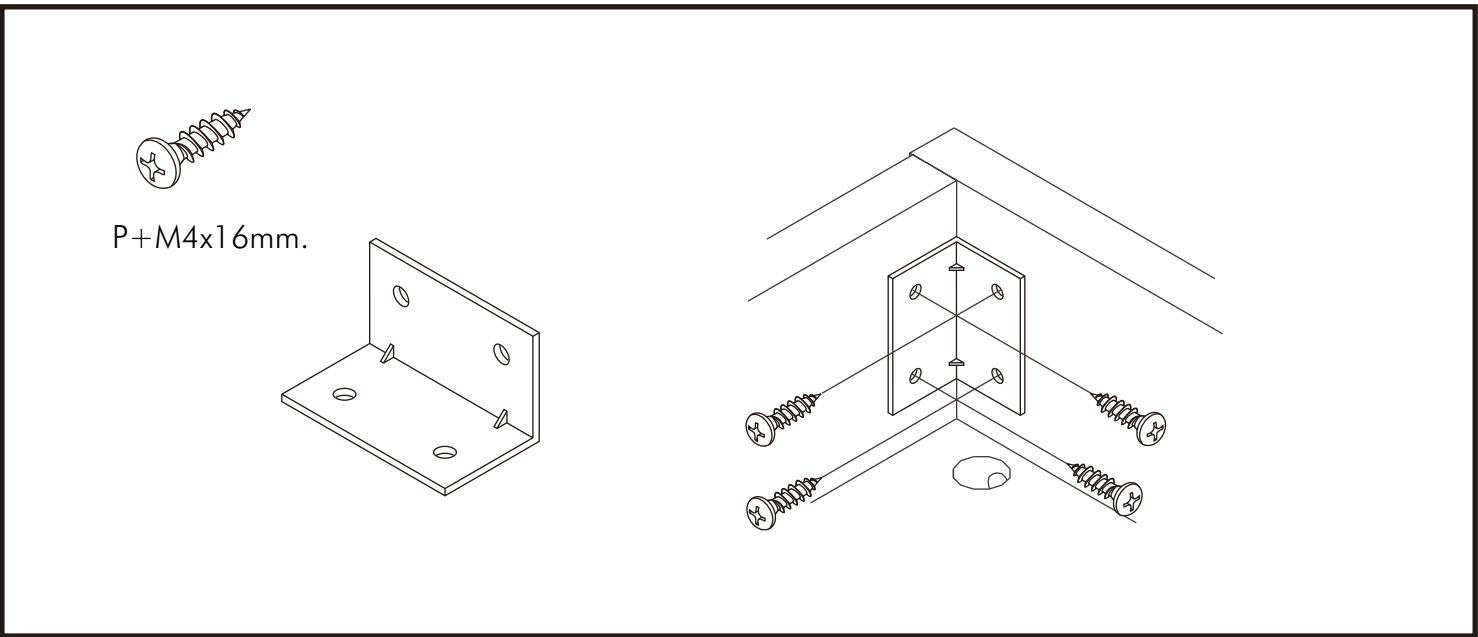
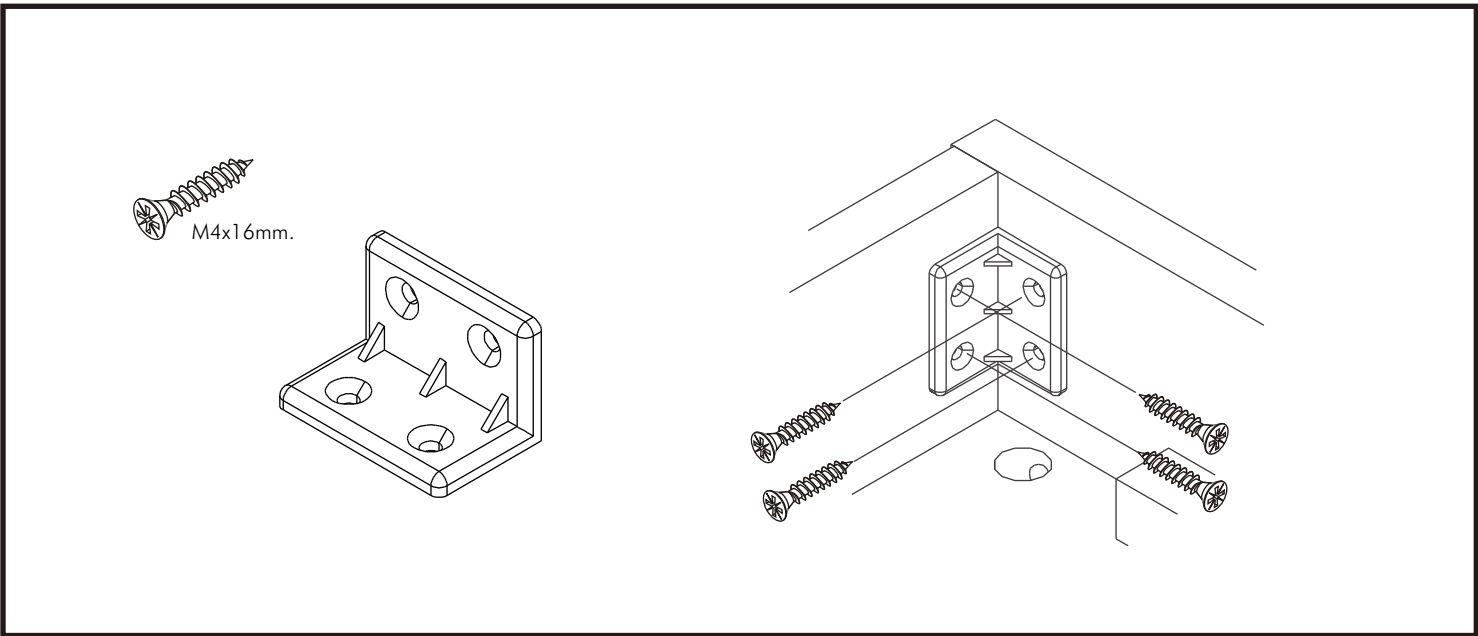
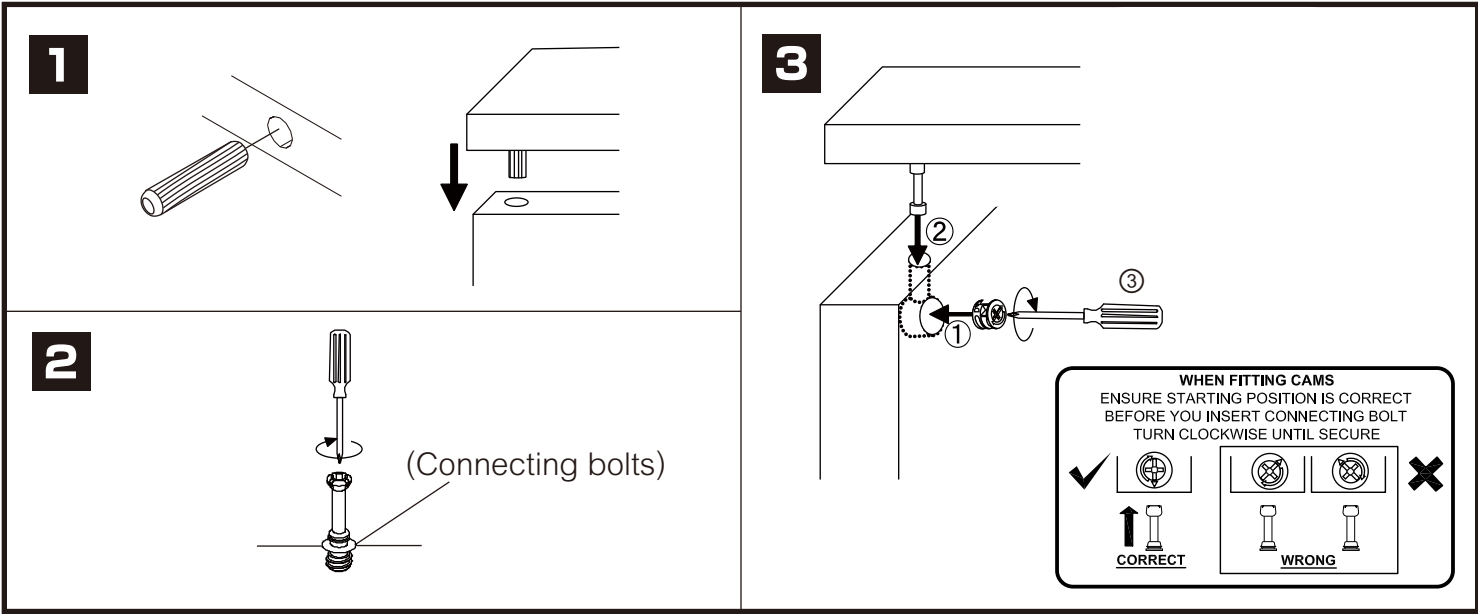

CONNECT SYSTEM

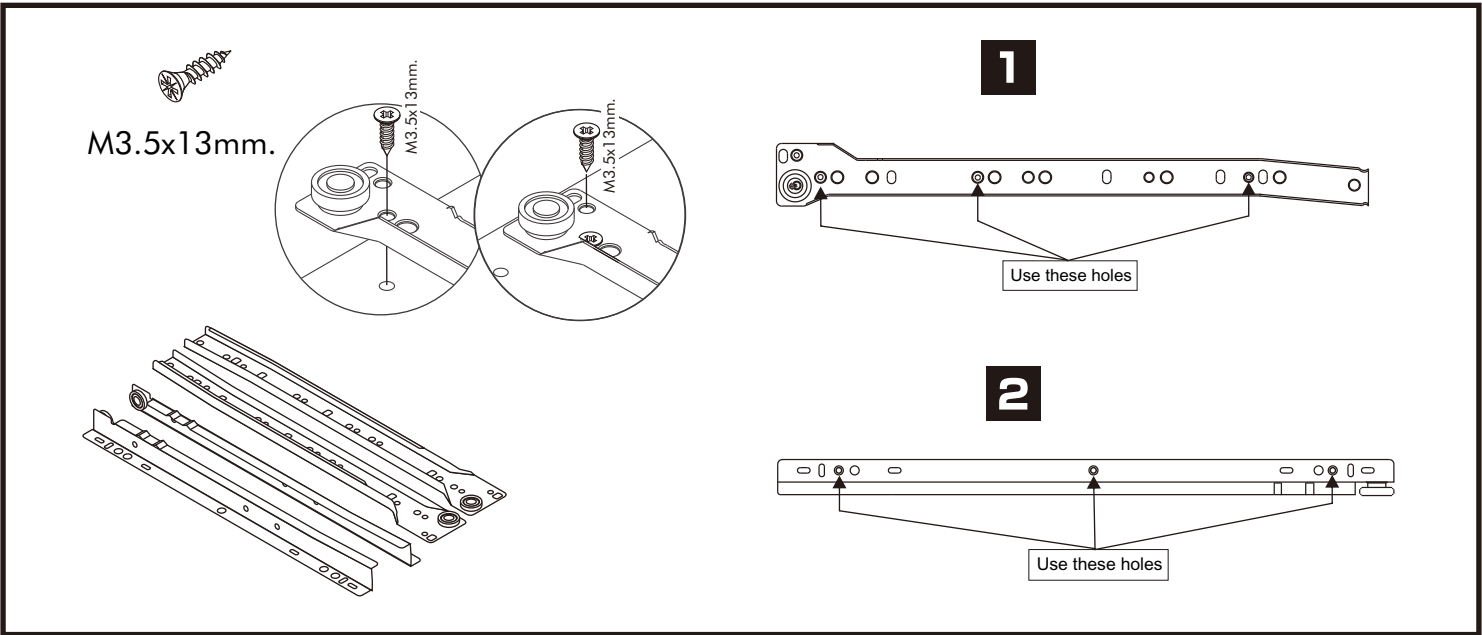

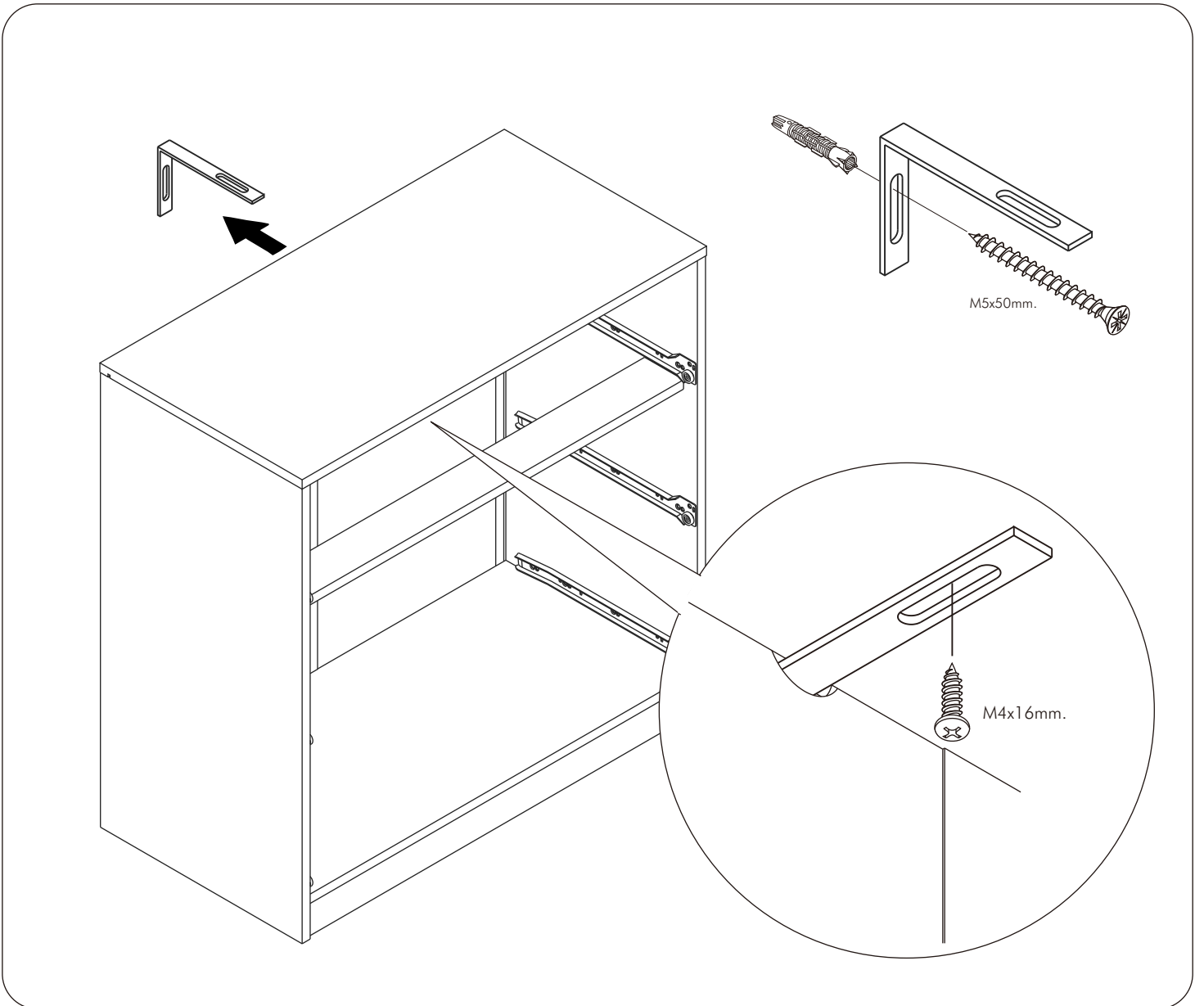
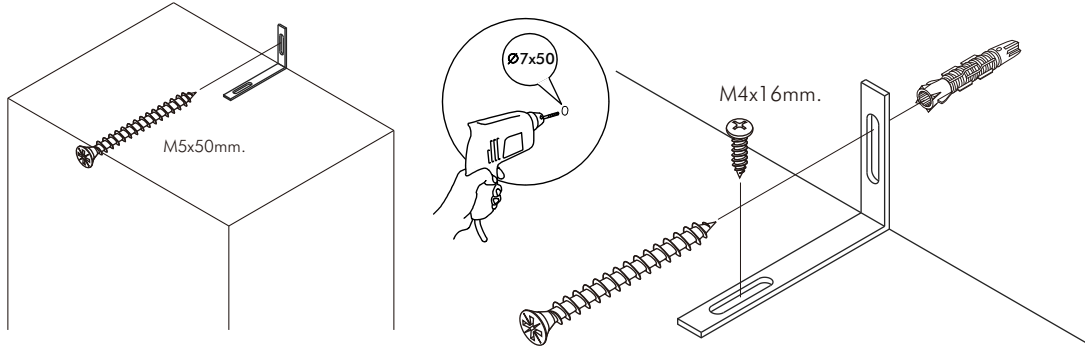
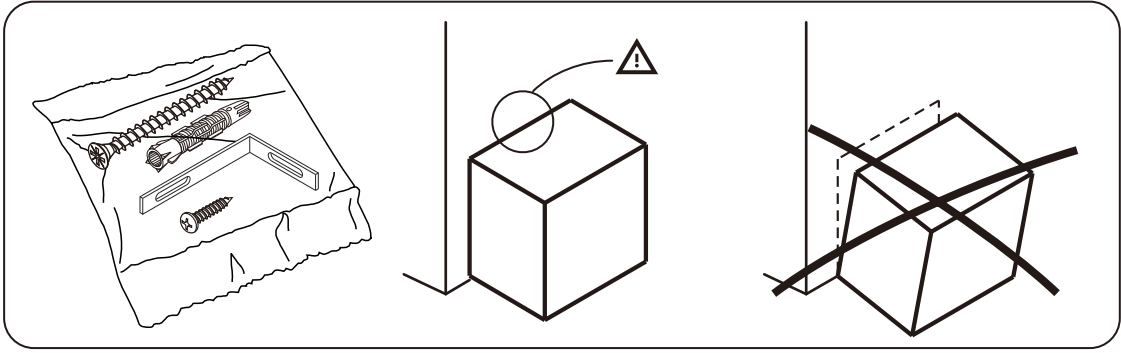

มาตรฐาน การระบุสินค้าที่ต้องยึด Fitting กันสั่น (Safety Fitting) ***หมายเหตุ เป็นชุดเด็ก ไม้ชุดตั้ง Fitting กันสั่นทุกตัว***

■ หมวด ตู้บานเปิด / ตู้บานปิด + ช่องใส่



■ ติดตั้งจากกันสั่นกับตู้สูง (ตั้งแต่ 2 m. ขึ้นไป)



■ หมวด ตู้ลิ้นชัก / ตู้ลิ้นชัก + ช่องใส่ / ตู้ลิ้นชัก + บานเปิด / ตู้ลิ้นชัก + บานสไลด์



■ ติดตั้งจากกันสั่นกับตู้เตี้ย (น้อยกว่า 2 m.)

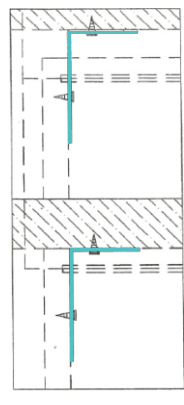

■ หมวด ตู้บานสไลด์ / ตู้ใส่

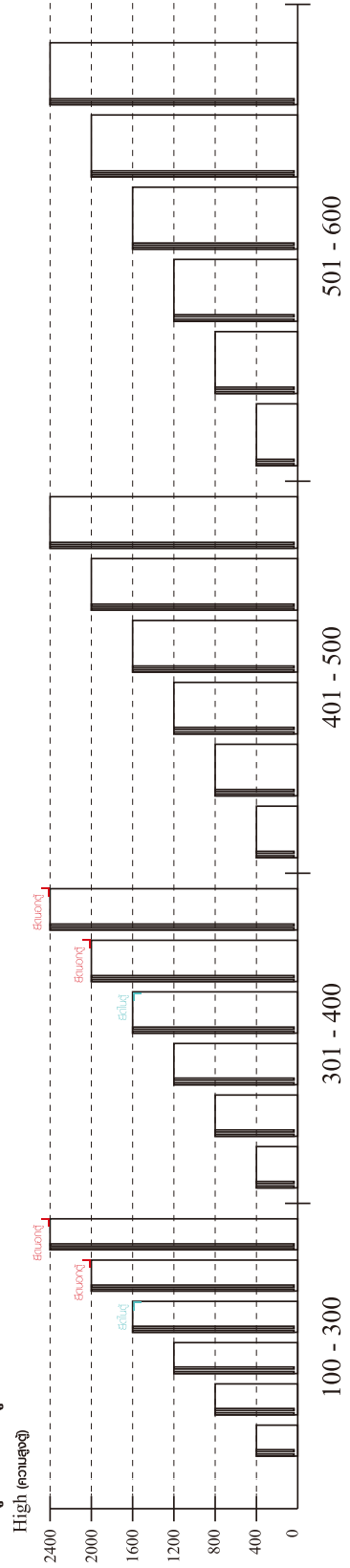

HARDWARE

-BODY SET

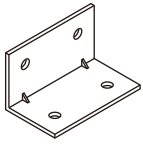

x 10

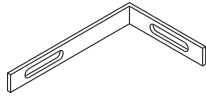

x 2

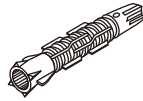

x 2

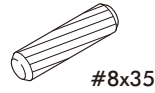

#8x35

x 8



x 2



x 2

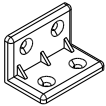

x 5



x 4

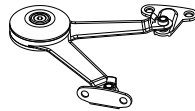

x 2



x 4



11 mm.

x 8

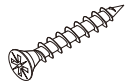

M4x25mm.

x 6



M3.5x13mm.

x 4

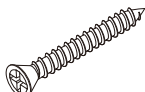

F+6x1"mm.

x 8



M4x16mm.

x 36

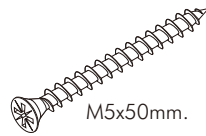

M5x50mm.

x 2

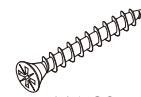

M4x30mm.

x 8



M4x50mm.

x 10

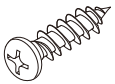

M4x16mm.

x 58



M4x45mm.

x 16

-DRAWER SET

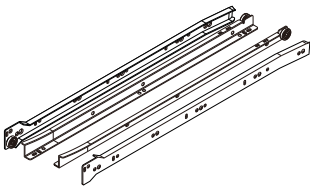

x 2



M3.5x13mm.

x 24



M4x40mm.

x 20



M6x23mm.

x 5

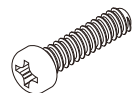

P+M4x20mm.

x 3

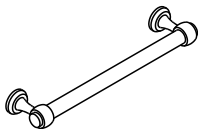

x 1



x 1

ASSEMBLY

-BODY SET

1.

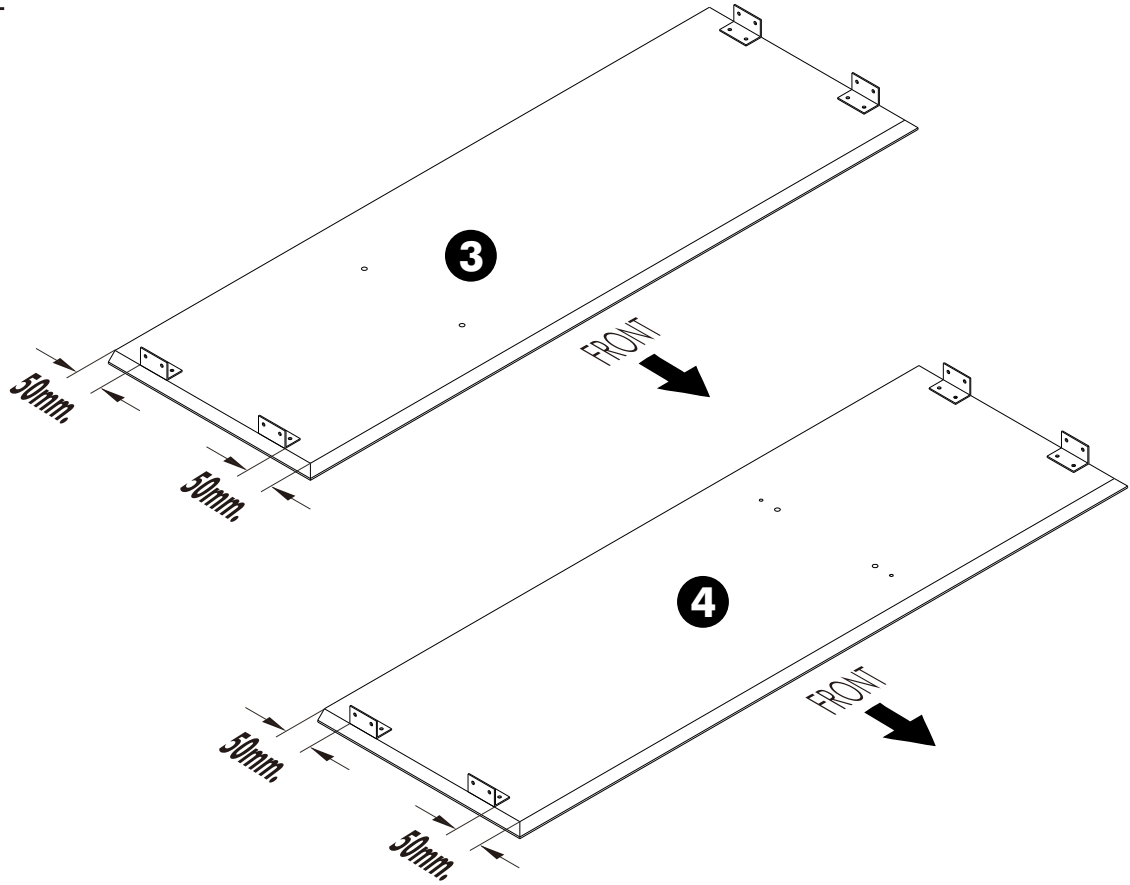

2.

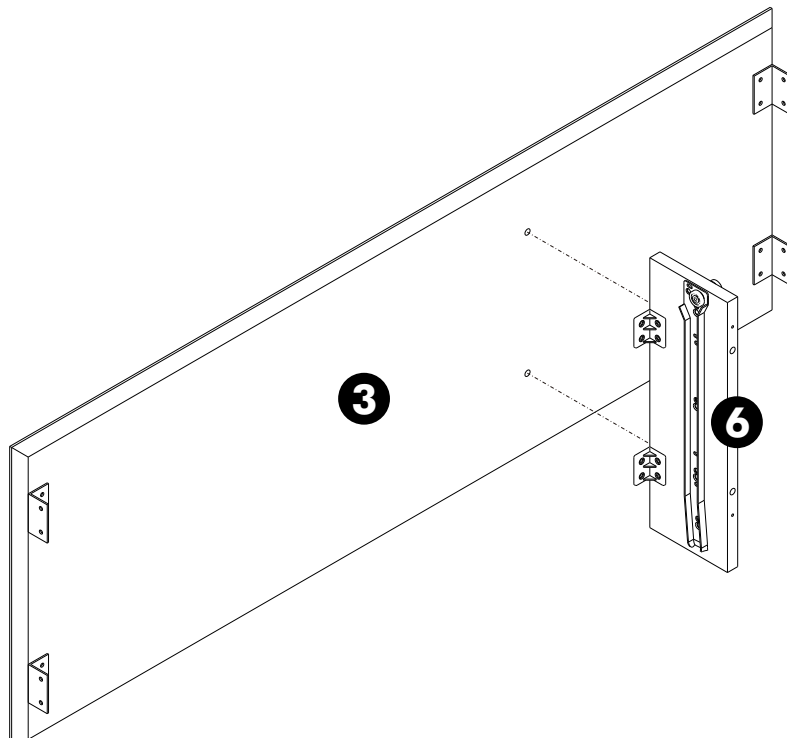

3.

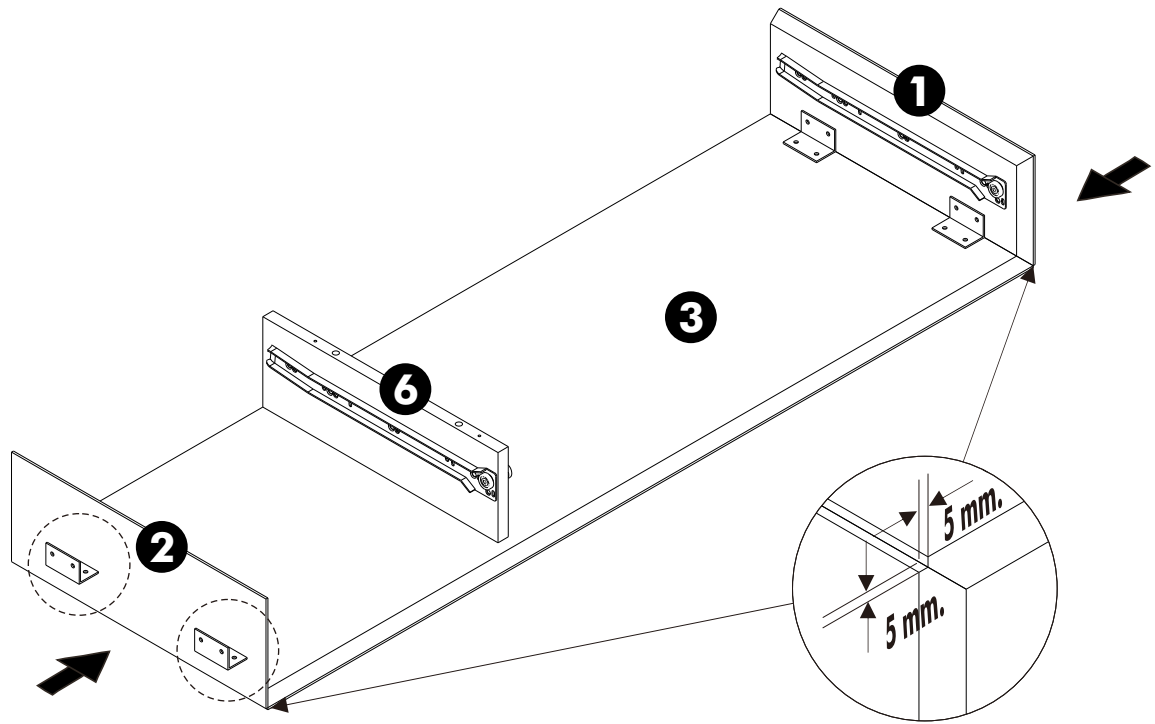

4.

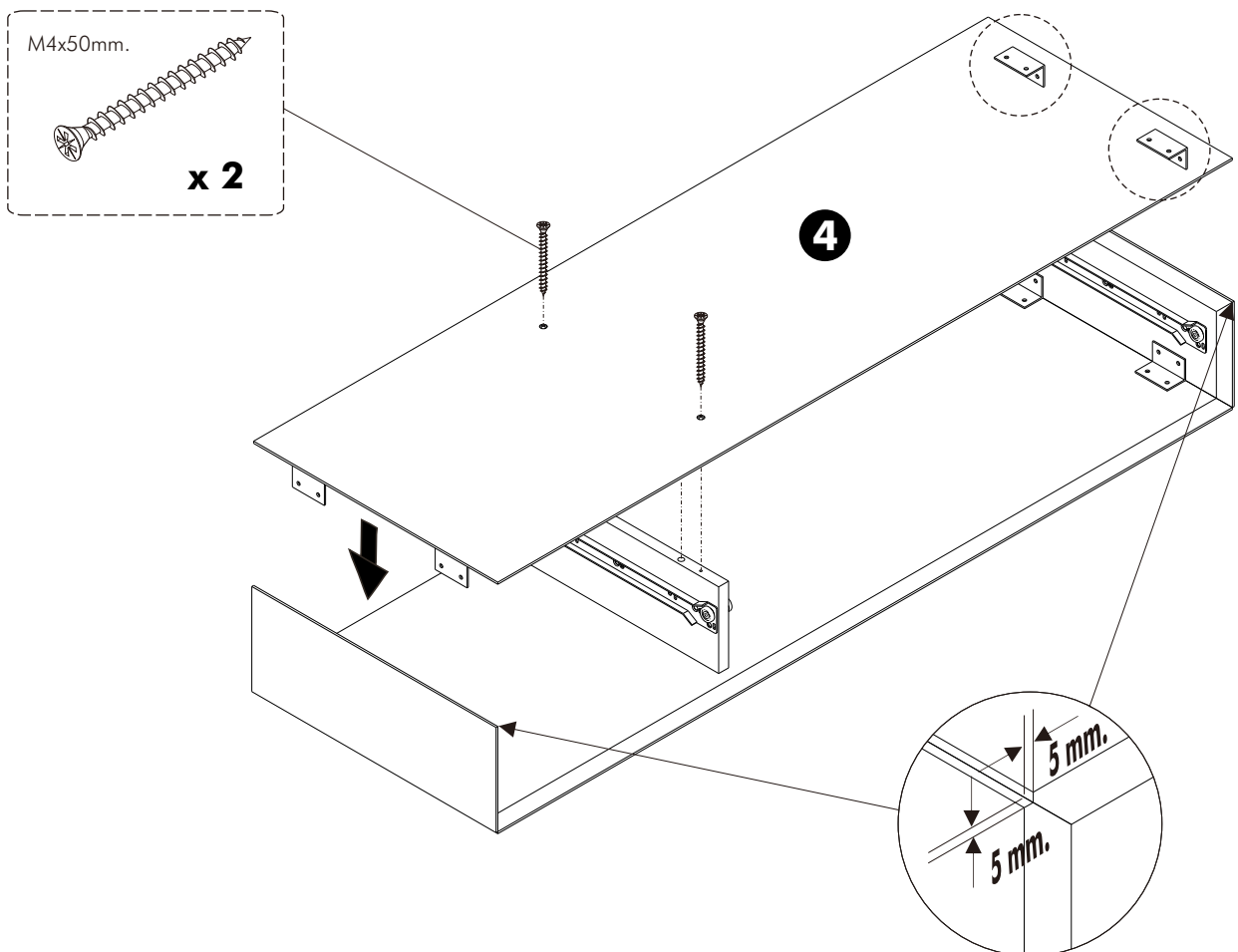

5.

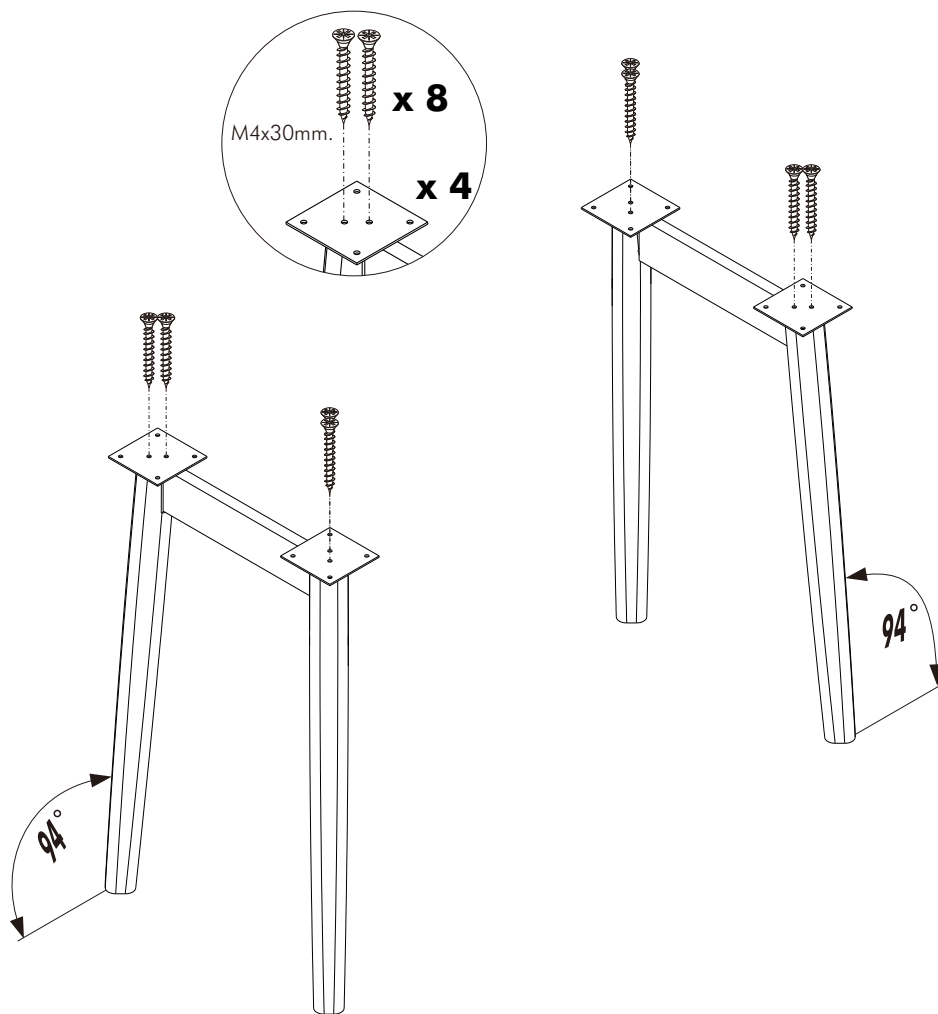

6.

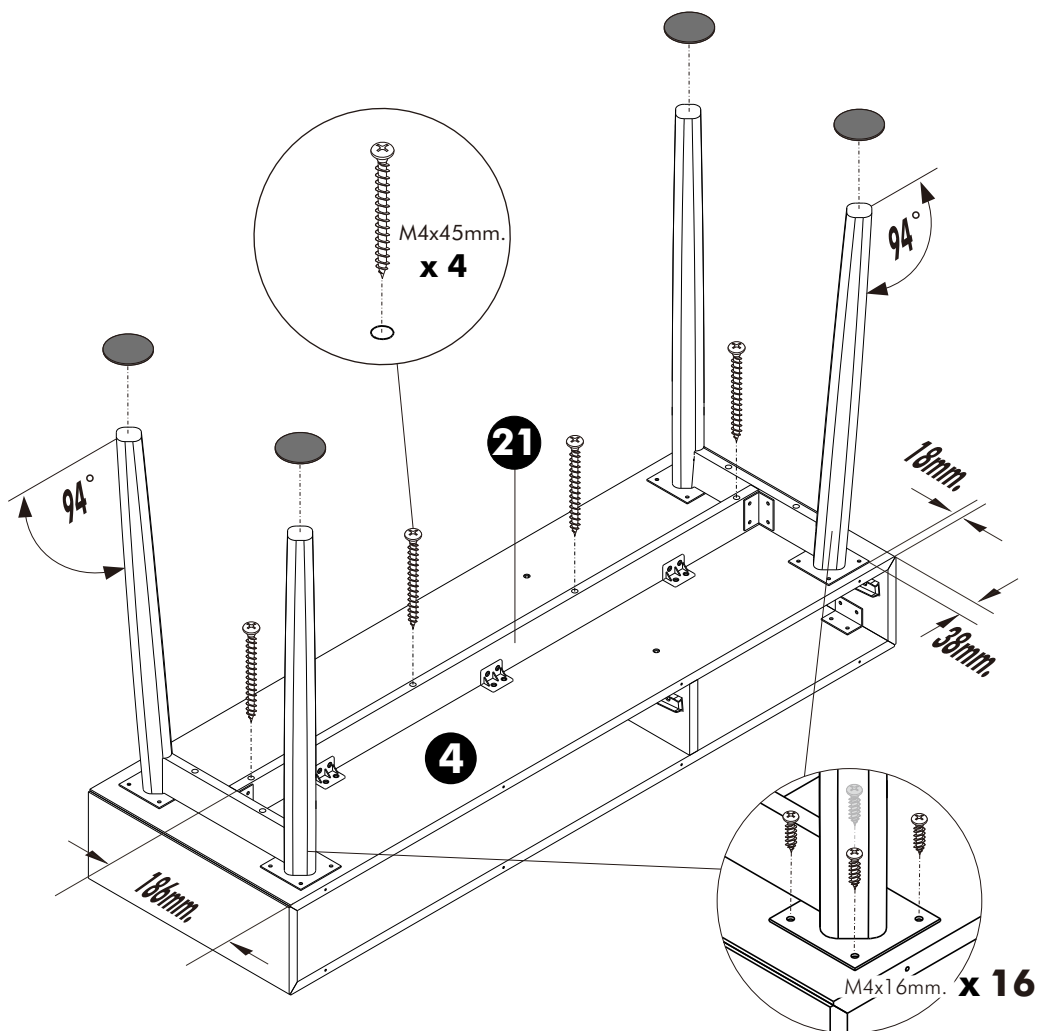

7.

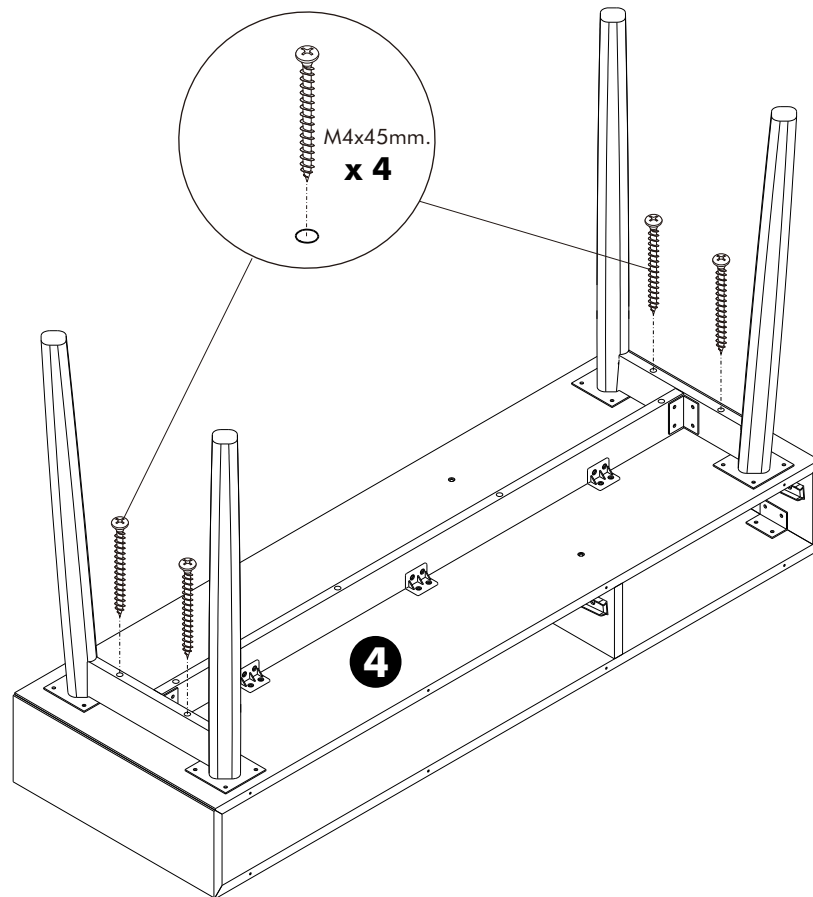

8.

ASSEMBLY

-DRAWER SET

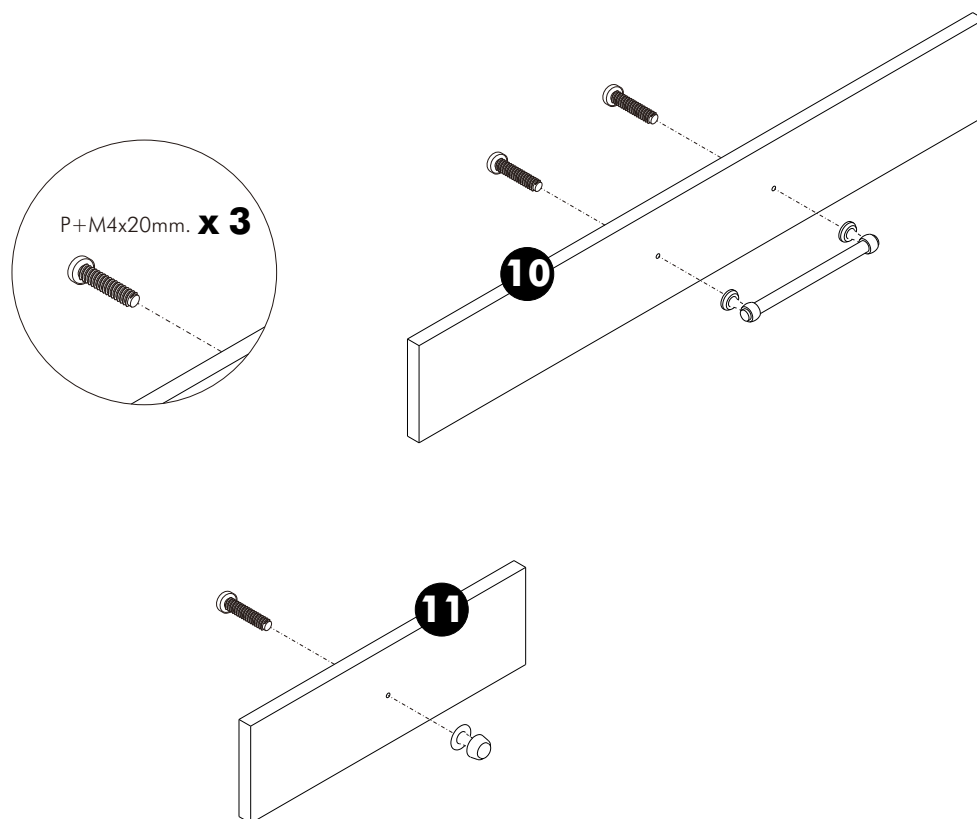

9.

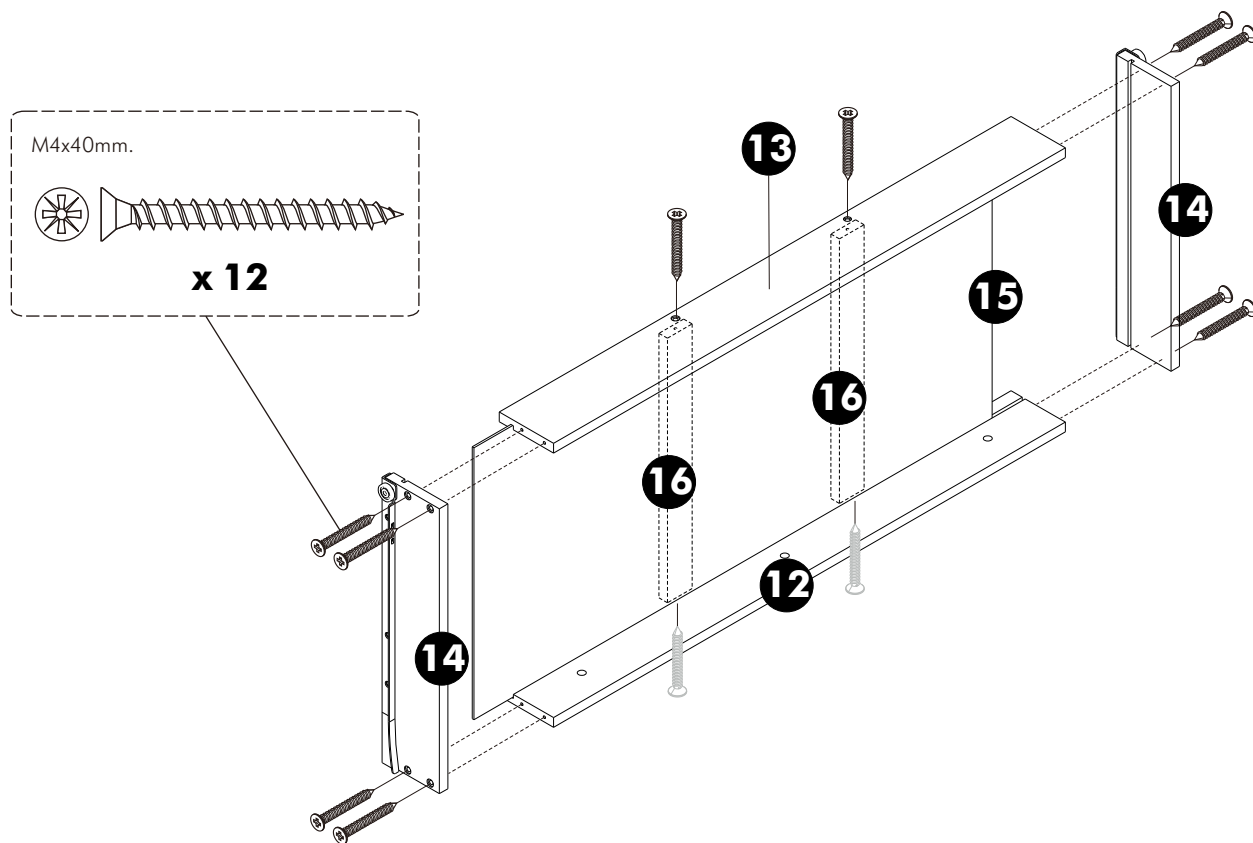

10.

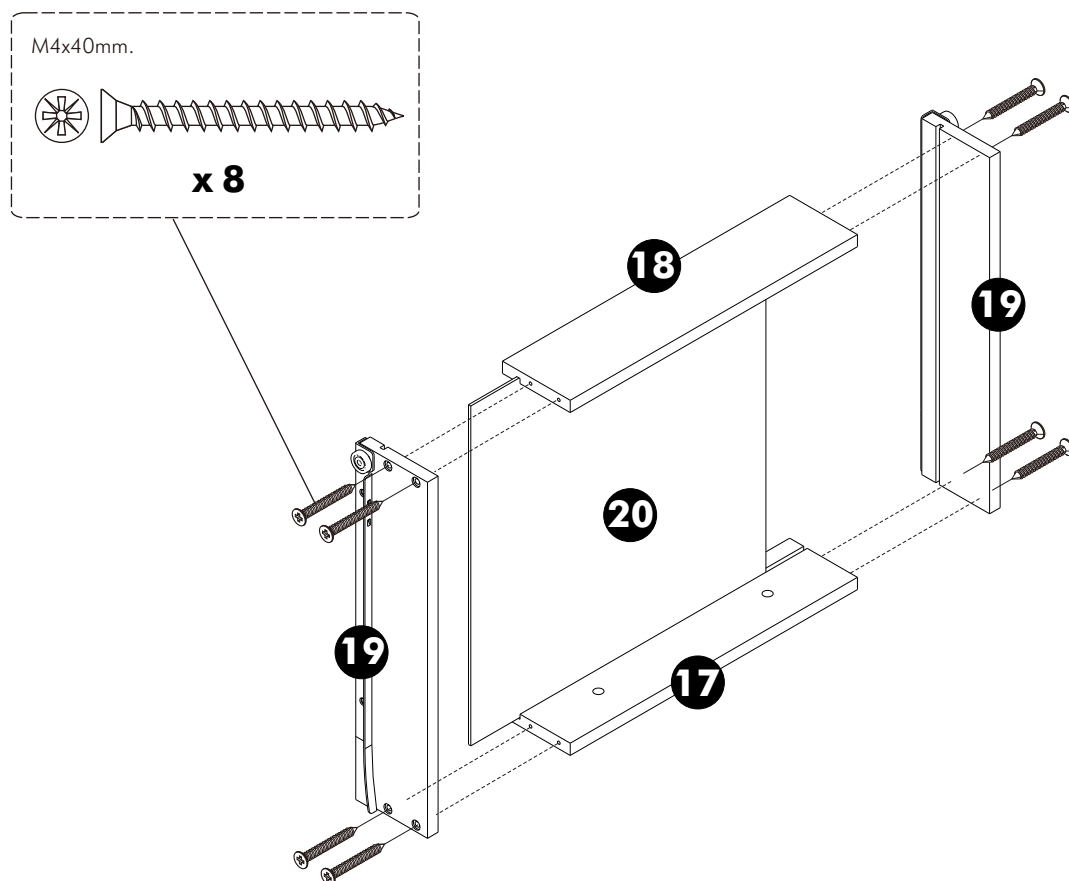

11.

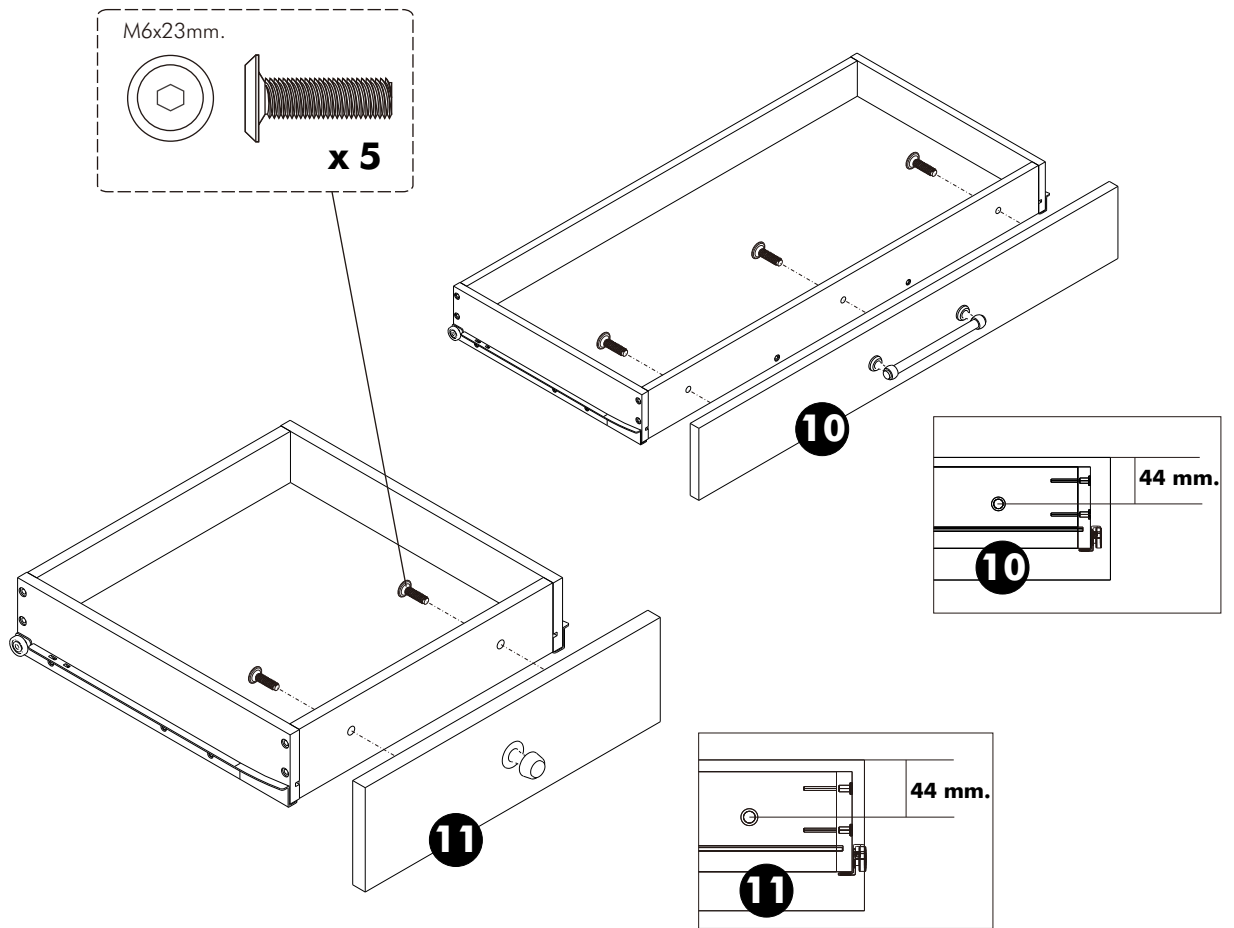

12.

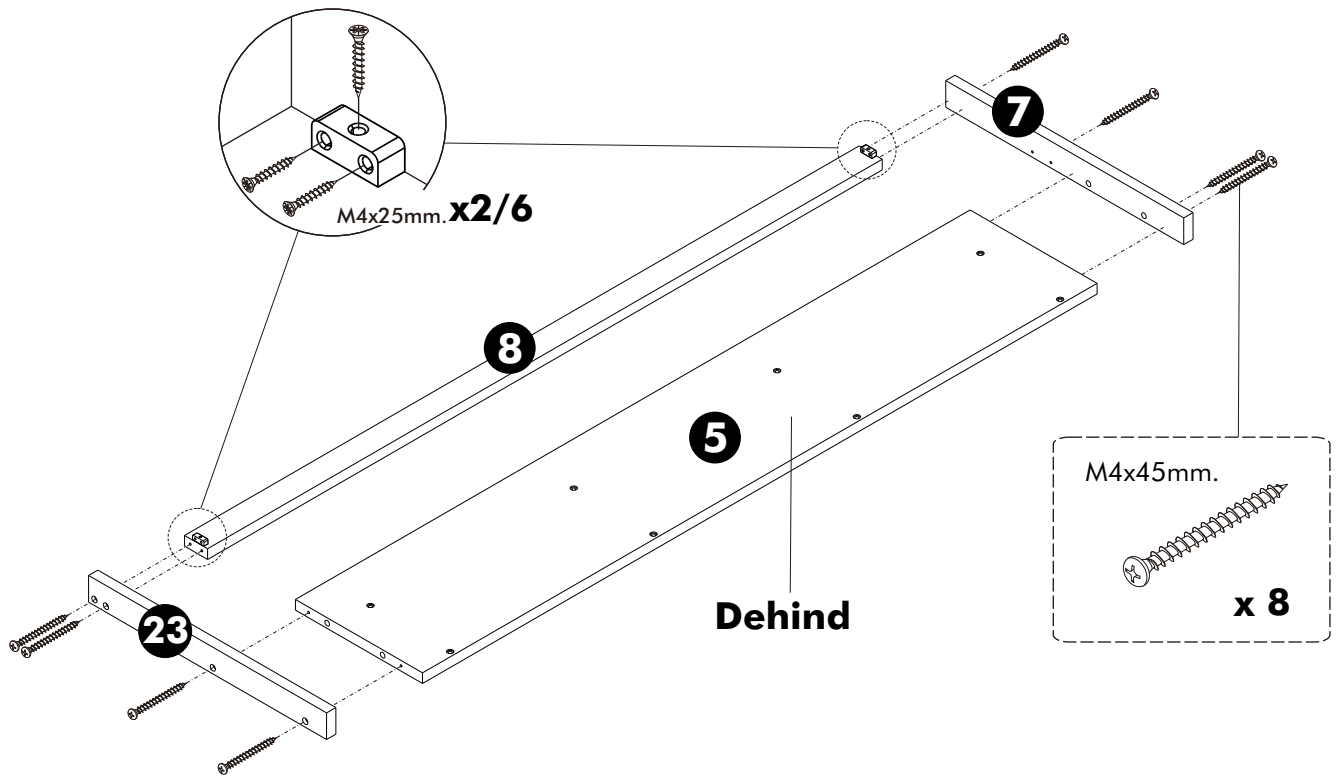

13.

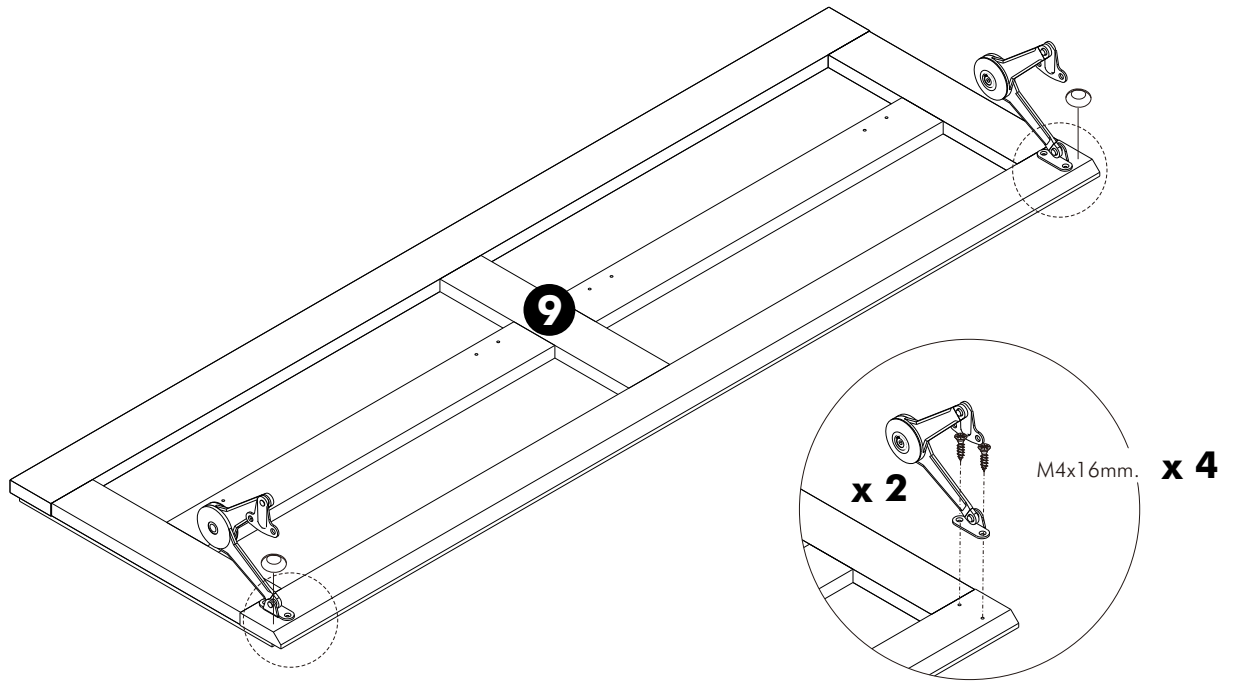

14.

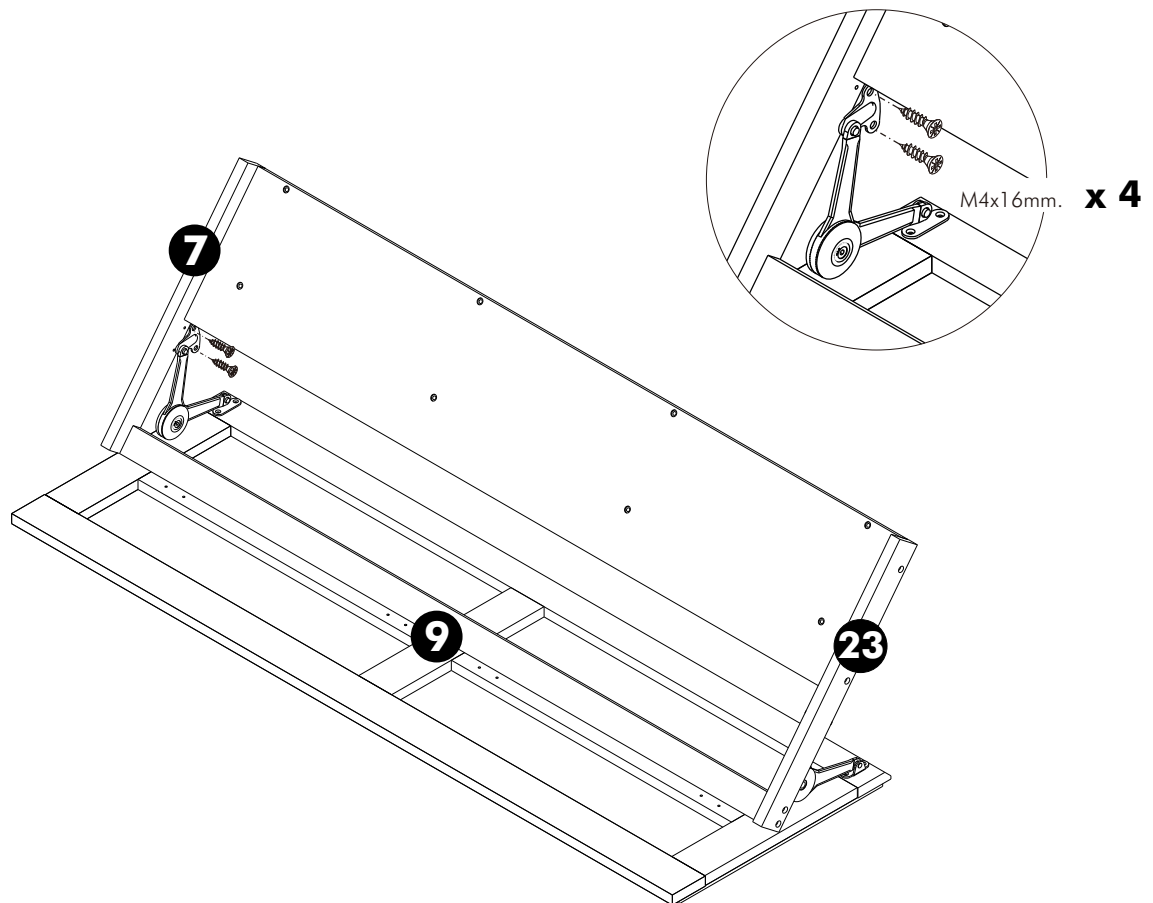

15.

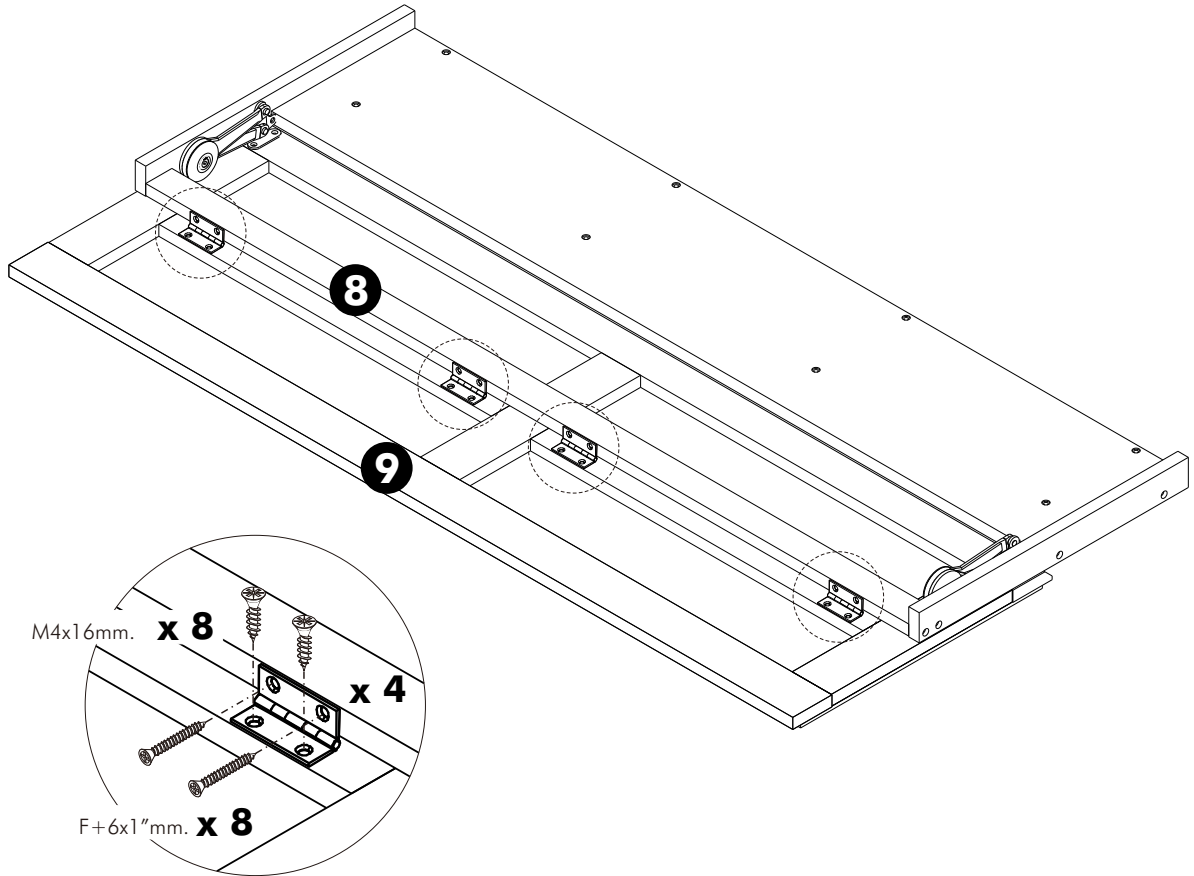

16.

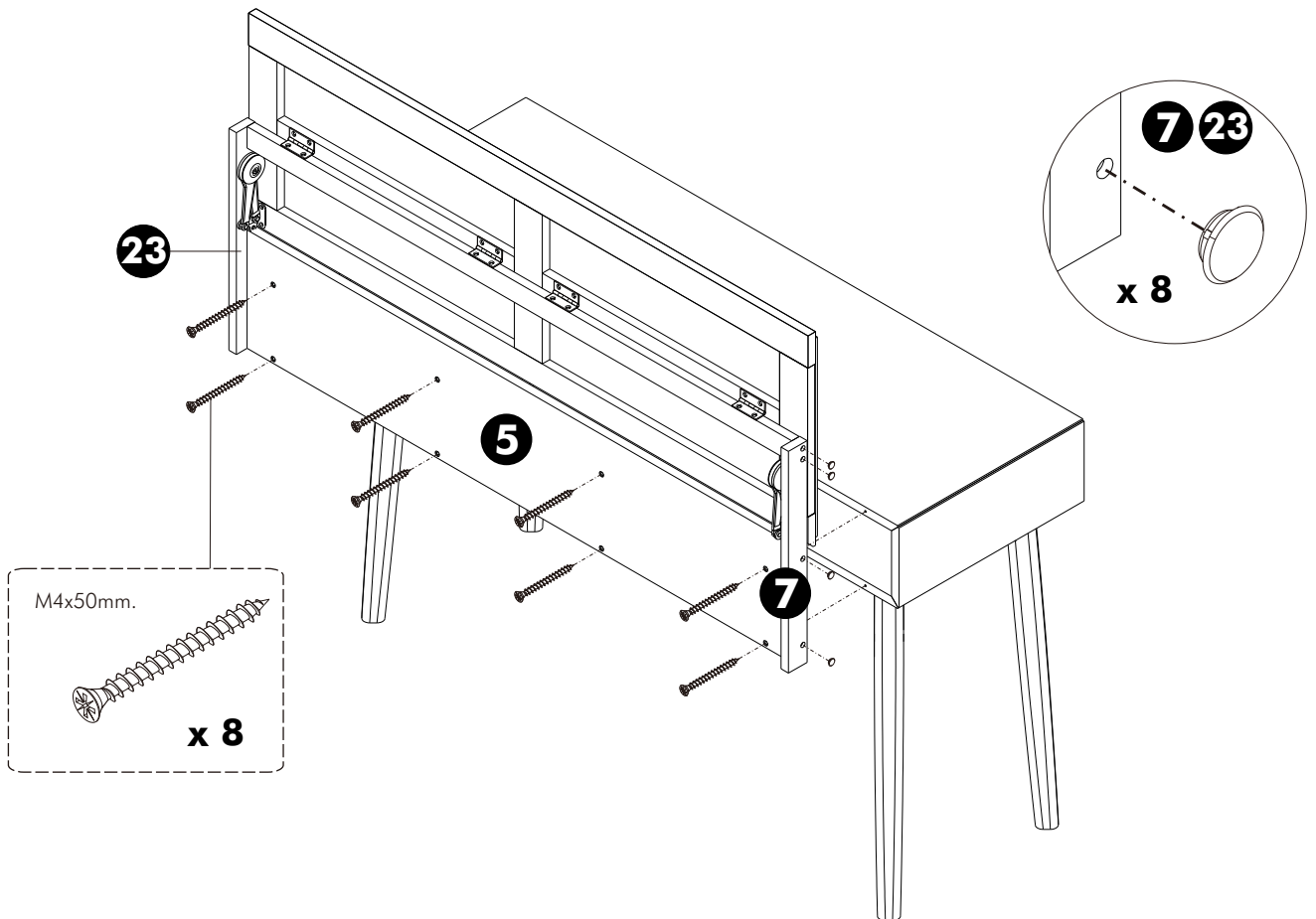

17.

