

VELO

Dressing 150/200 cm.

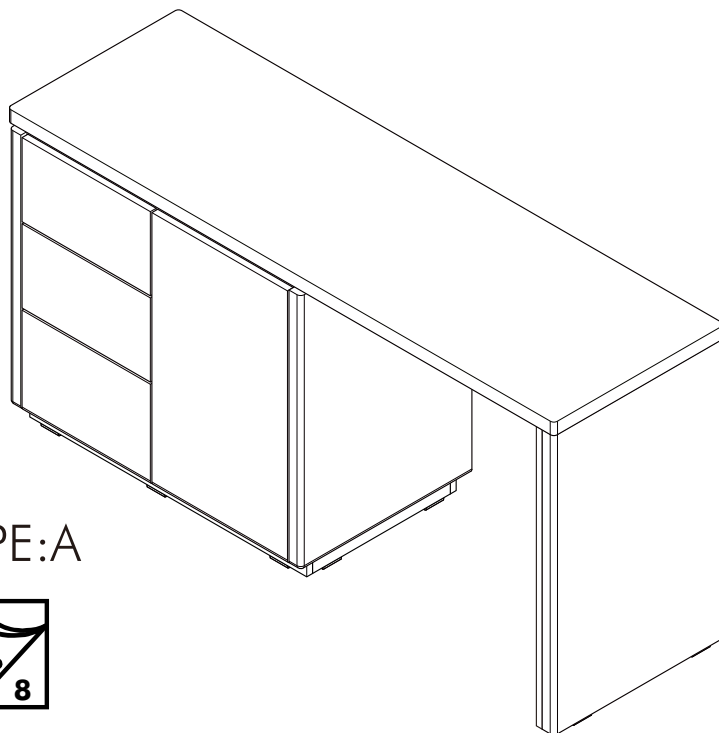

TYPE:A

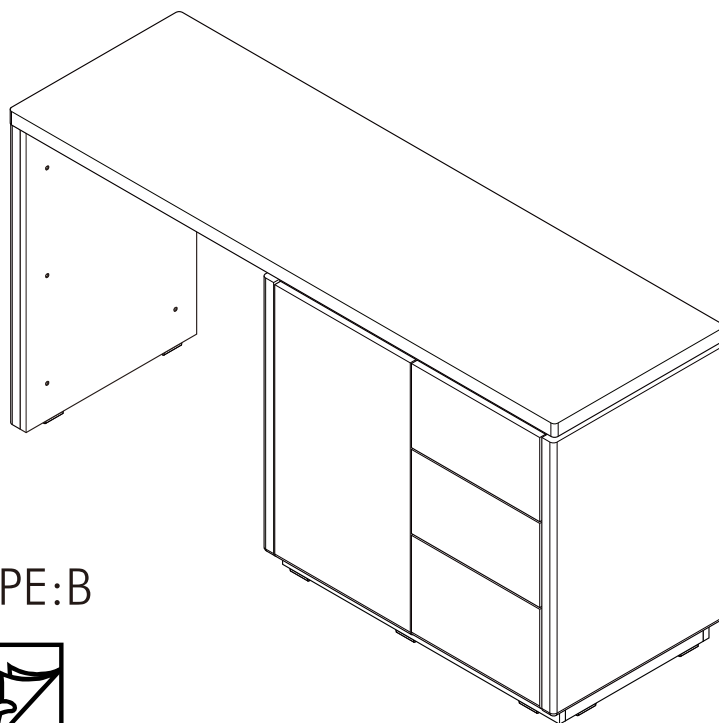

TYPE:B



CONNECT SYSTEM

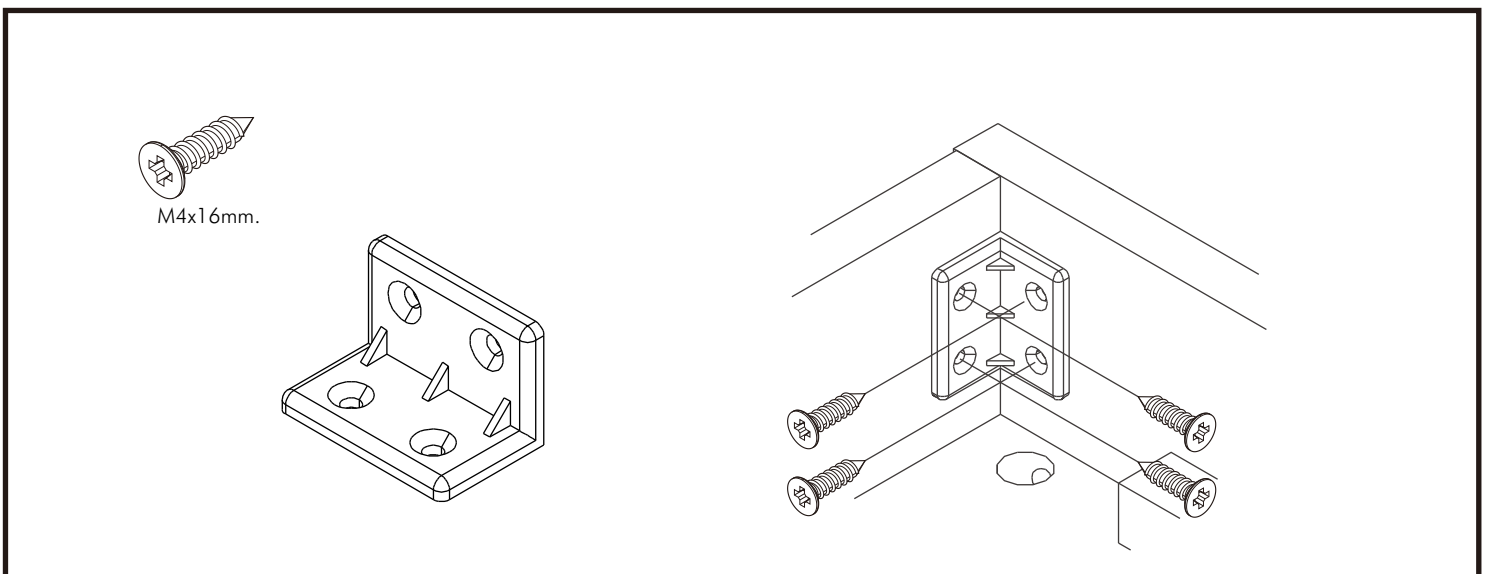
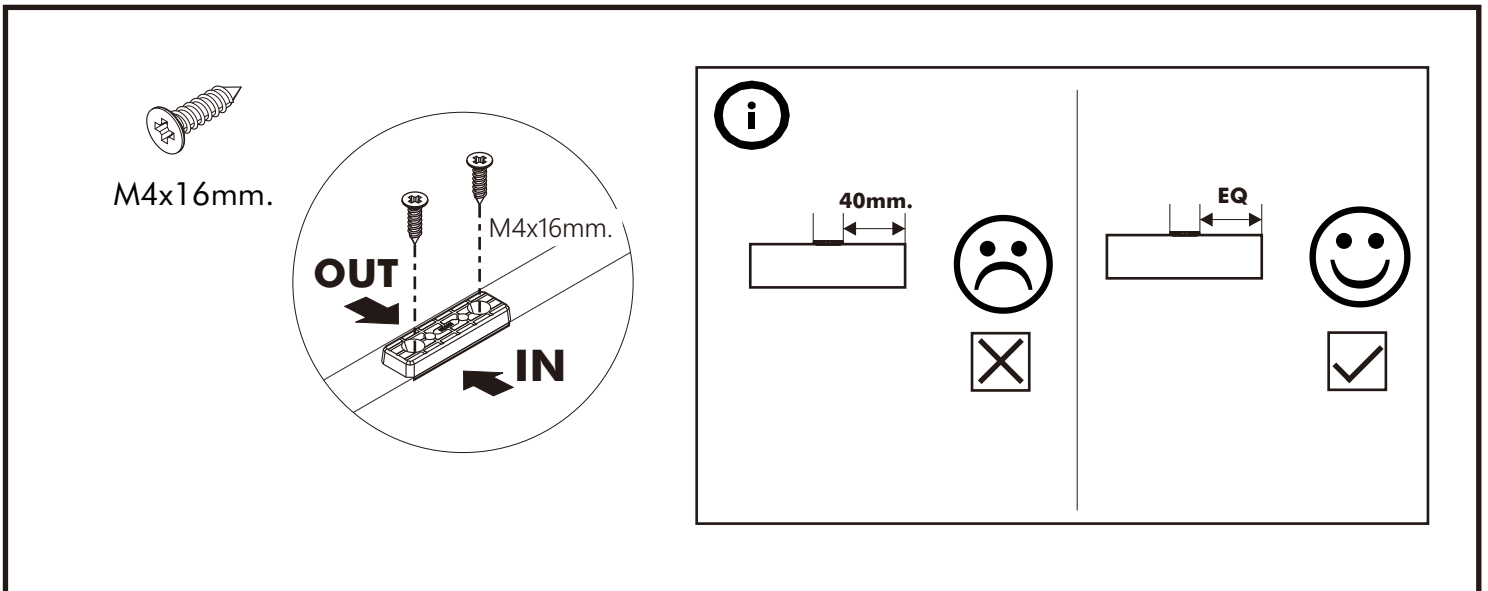
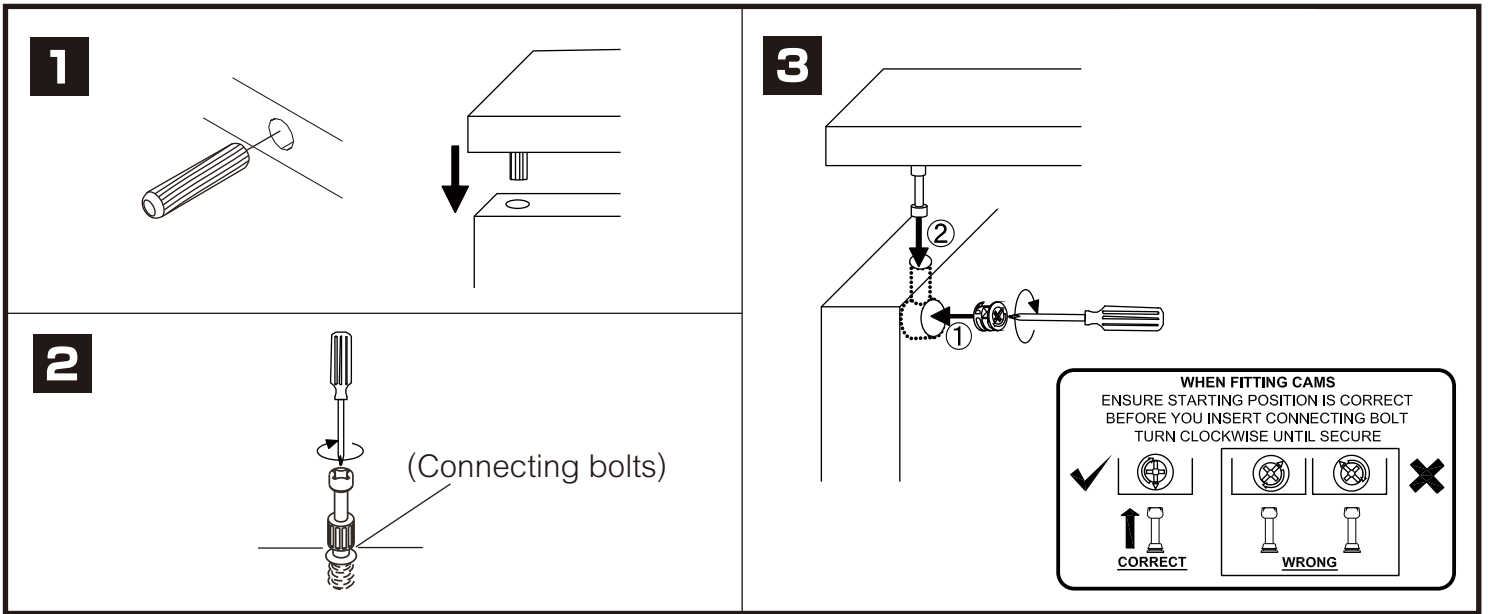

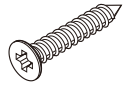

M3.5x20mm.

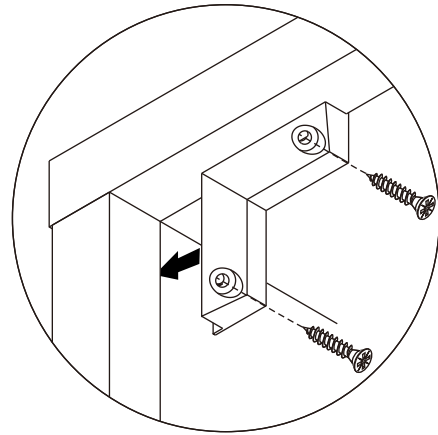
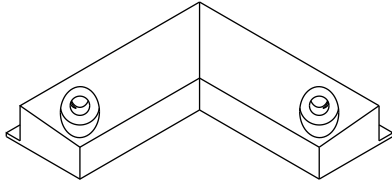

M4x16mm.

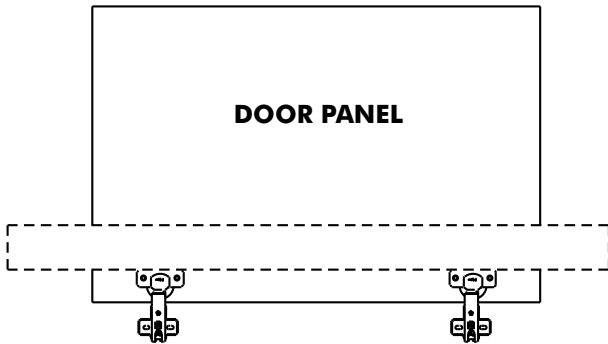

DOOR PANEL

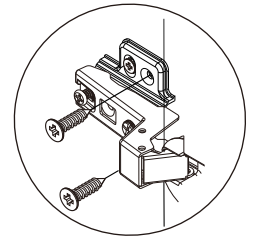
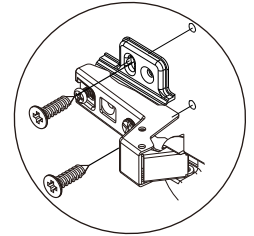
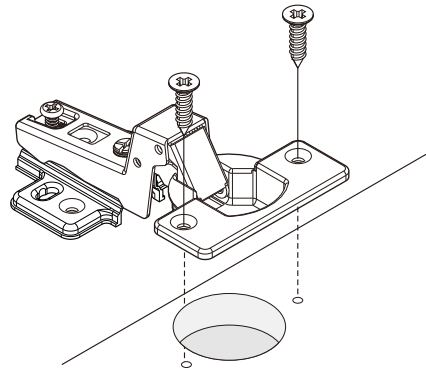

#6x1/2"

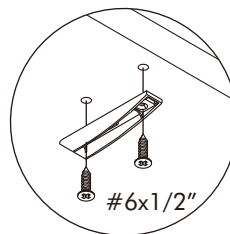
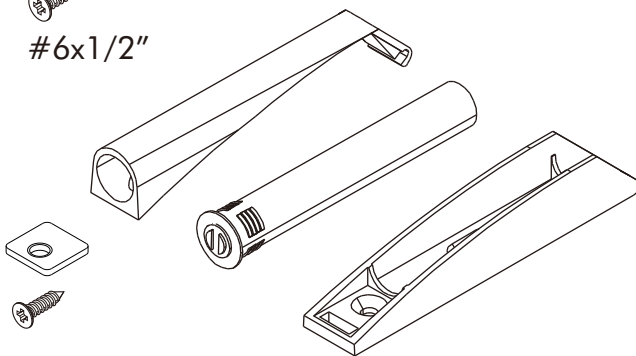

#6x1/2"

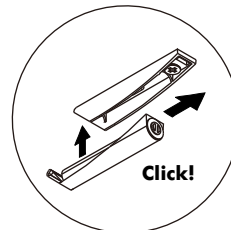

Click!

#5x3/8"

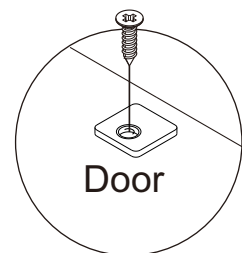

Door

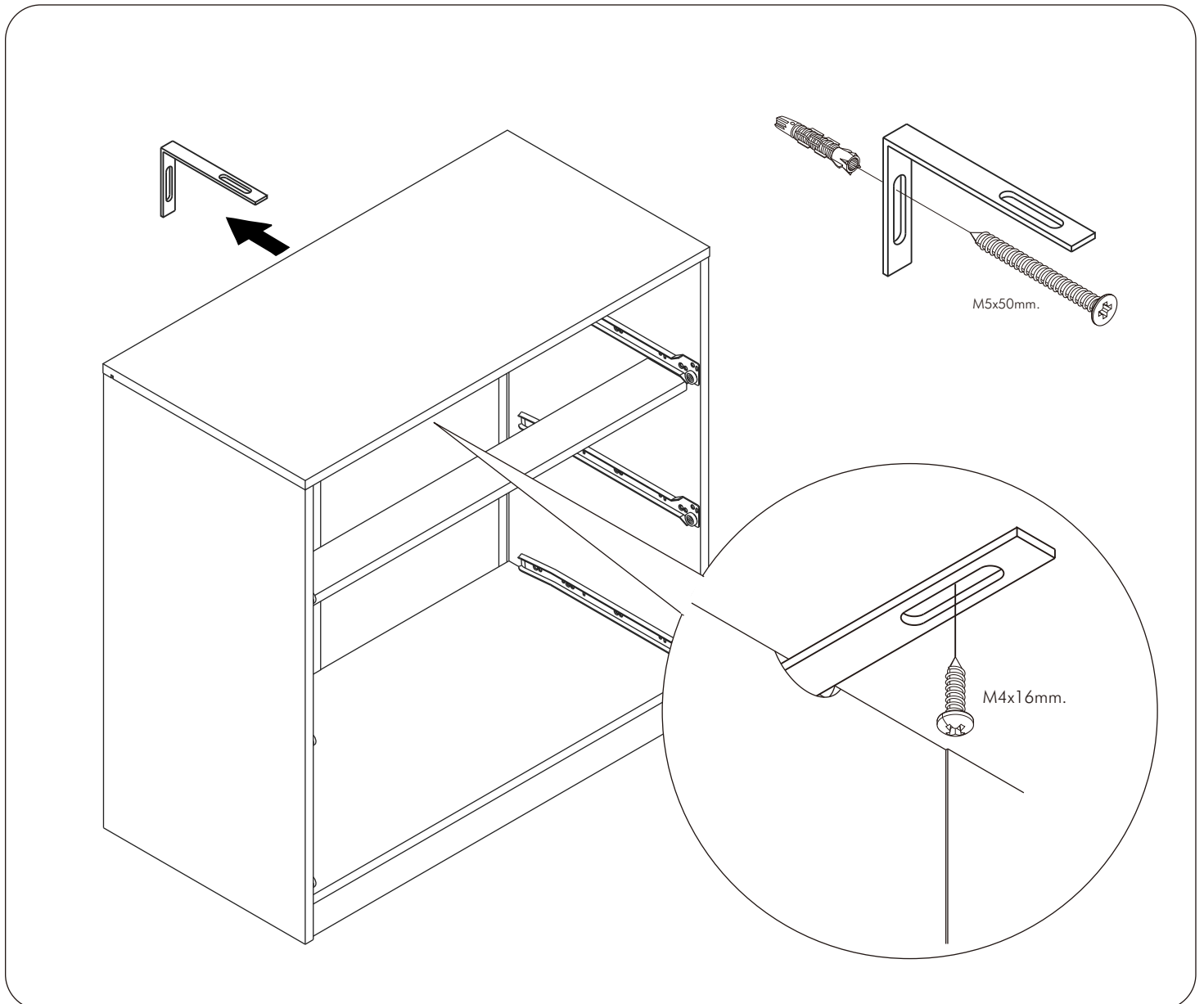
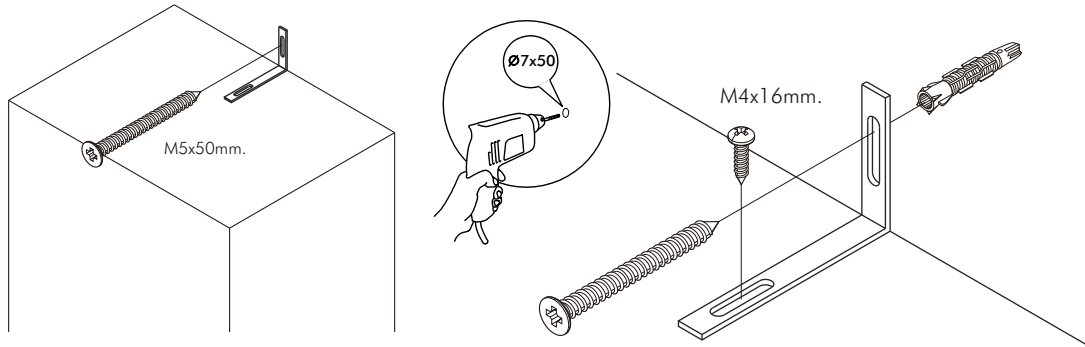
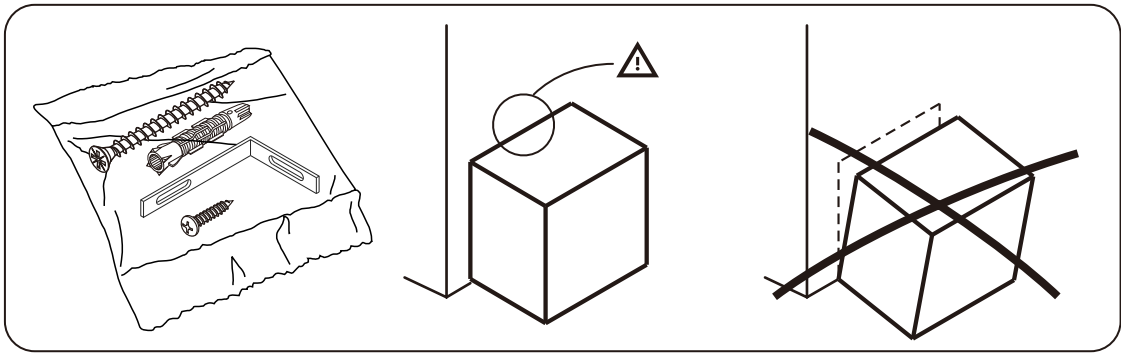

มาตรฐาน การระบุสินค้าที่ต้องยึด Fitting กันลื่น (Safety Fitting) ***หมายเหตุ สินค้าที่เป็นชุดเหล็ก ให้ติดตั้ง Fitting กันลื่นทุกตัว***

■ หมวด ตู้บานเปิด / ตู้บานปิด + ช่องใส่

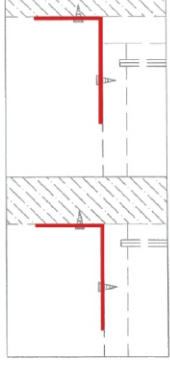
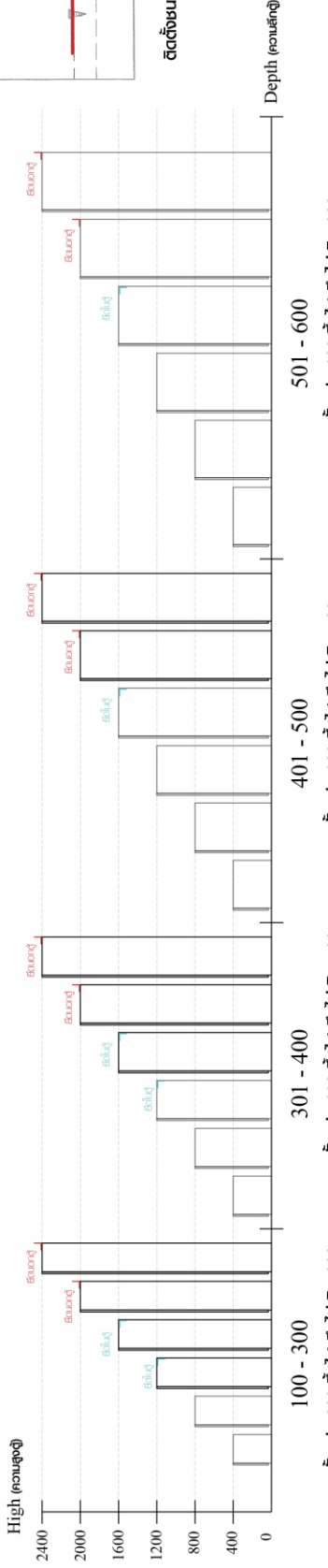

ติดตั้งบนพวง

ติดตั้งลดยกลบวง

■ ติดตั้งฉากกันลื่นกับตู้สูง (ตั้งแต่ 2 ม.ขึ้นไป)

■ หมวด ตู้ลิ้นชัก / ตู้ลิ้นชัก + บานเปิด / ตู้ลิ้นชัก + บานสไลด์

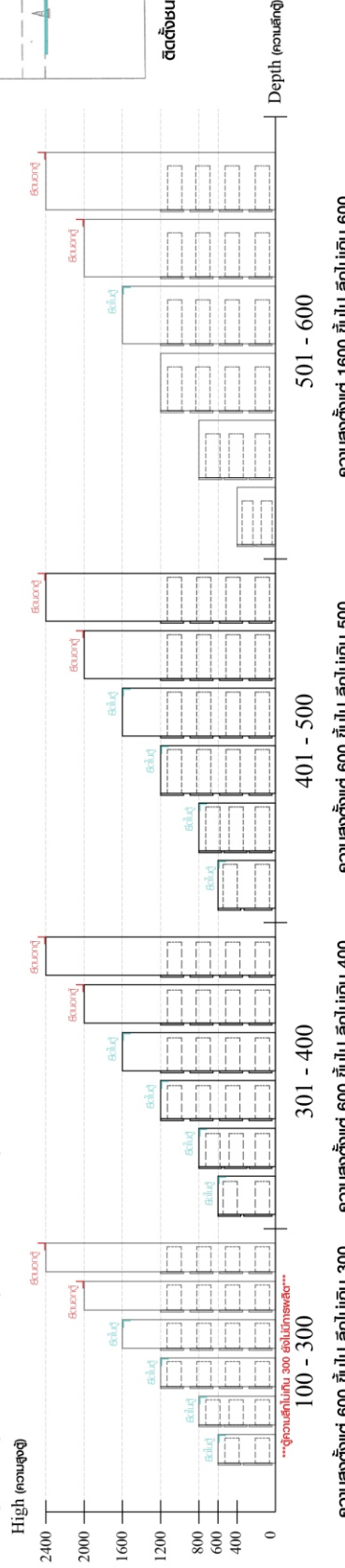

ติดตั้งบนพวง

ติดตั้งลดยกลบวง

■ ติดตั้งฉากกันลื่นกับตู้เตี้ย (น้อยกว่า 2 ม.)

■ หมวด ตู้บานสไลด์ / ตู้ใส

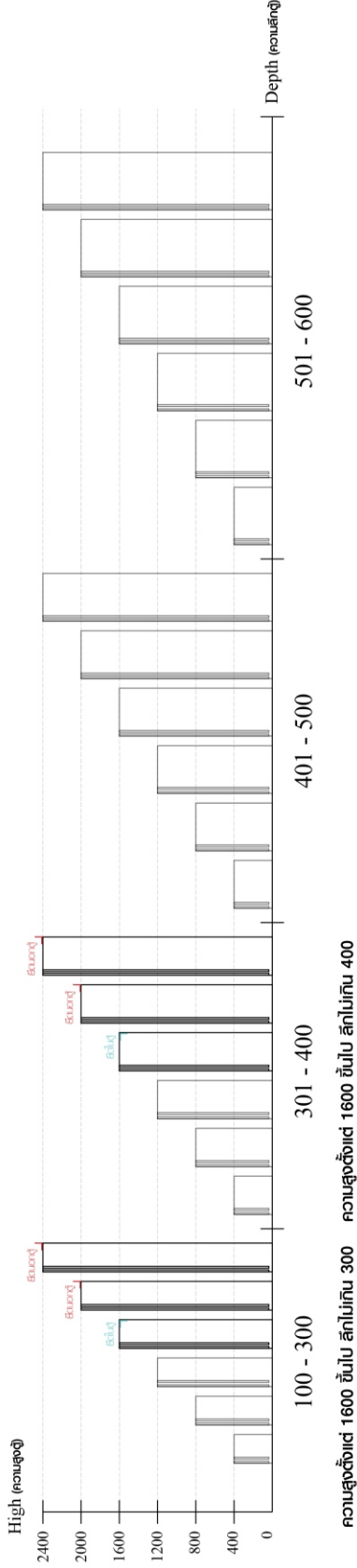

HARDWARE

-BODY SET

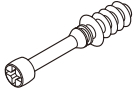

x 12



15mm.

x 10



19mm.

x 2

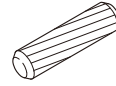

x 15

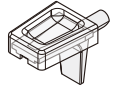

x 4

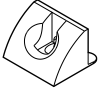

x 6

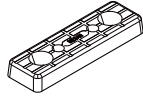

x 14



∅ 11mm.

x 30



x 2

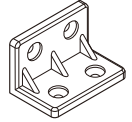

x 14

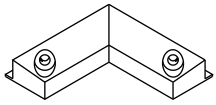

x 2

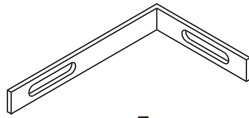

x 1

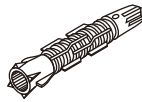

x 1

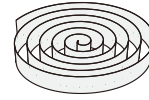

15x1000mm.

x 6

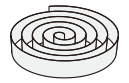

15x780mm.

x 6



M3.5x20mm.

x 14



M4x16mm.

x 72



M4x25mm.

x 14



M4x30mm.

x 18



M4x50mm.

x 2



M5x50mm.

x 1



M4x16mm.

x 9

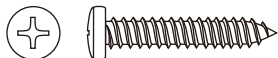

M4x20mm.

x 3

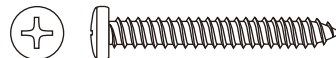

M4x30mm.

x 6

HARDWARE

-DRAWER SET

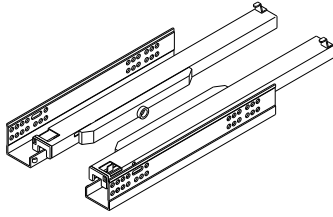

x 3 set



M3.5x13mm.

x 18

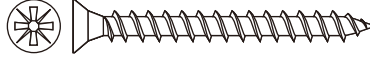

M4x40mm.

x 24

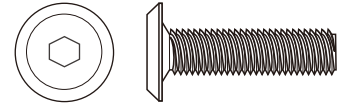

M6x25mm.

x 6

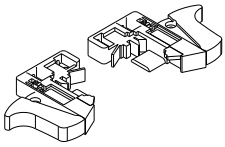

x 3 set



M4x13mm.

x 18

-DOOR SET

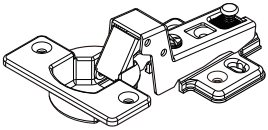

x 2



M4x16mm.

x 12

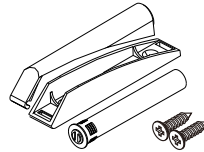

x 1 set



x 1



M4x8mm.

x 1



Ø 3.5Cm.

x 2

-PART STEEL

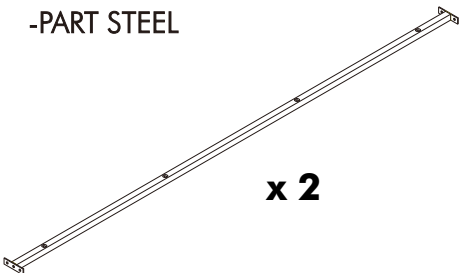

x 2

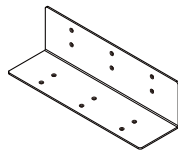

x 1

ASSEMBLY

TYPE:A

-BODY SET

1.

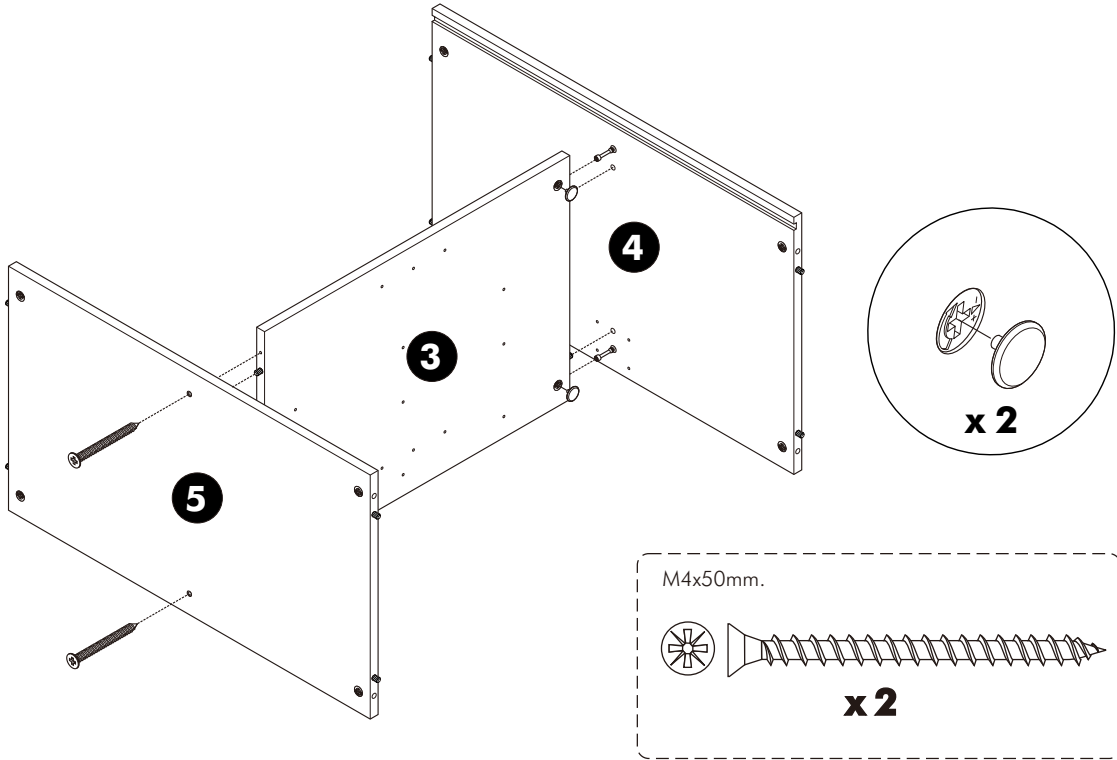

2.

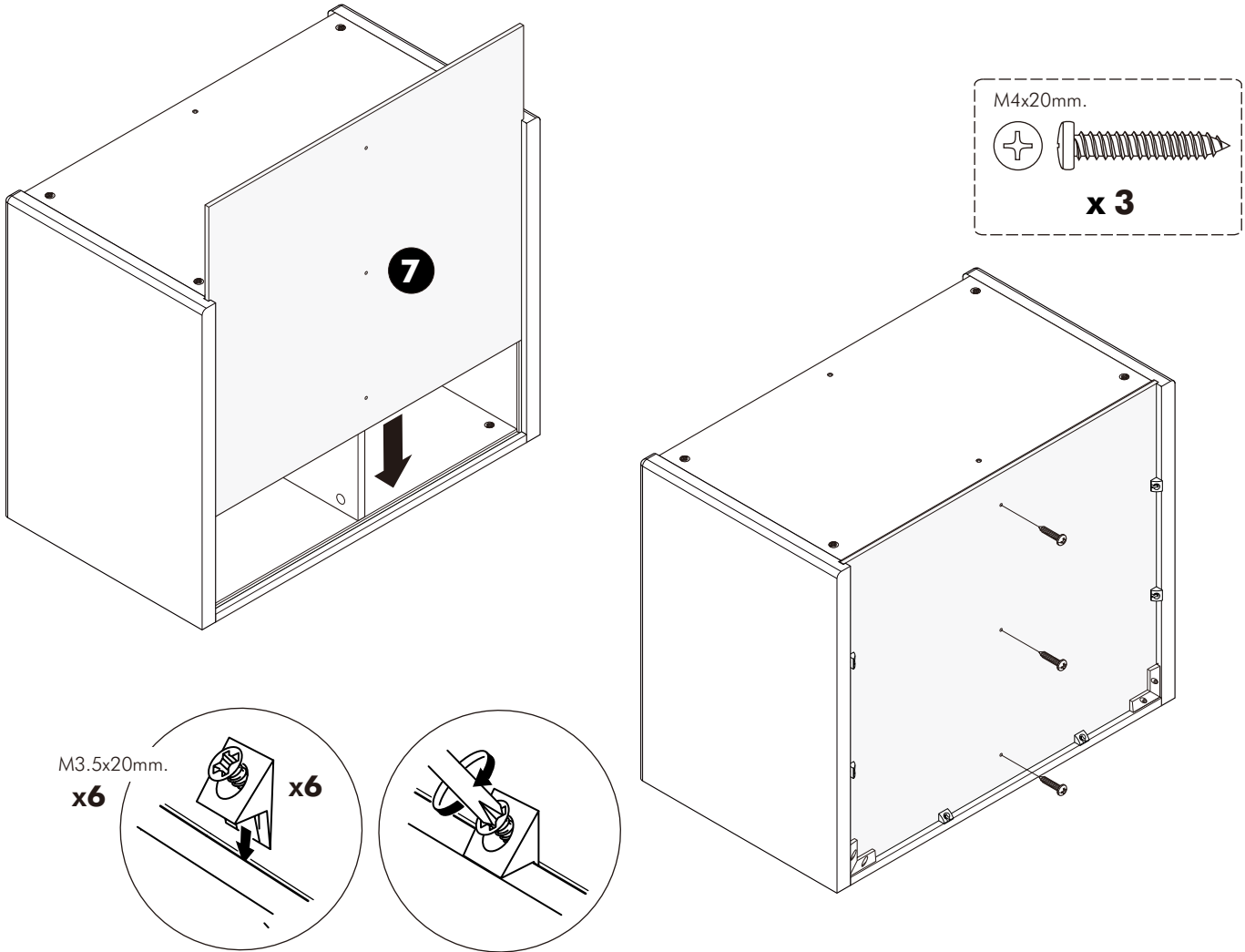

5.

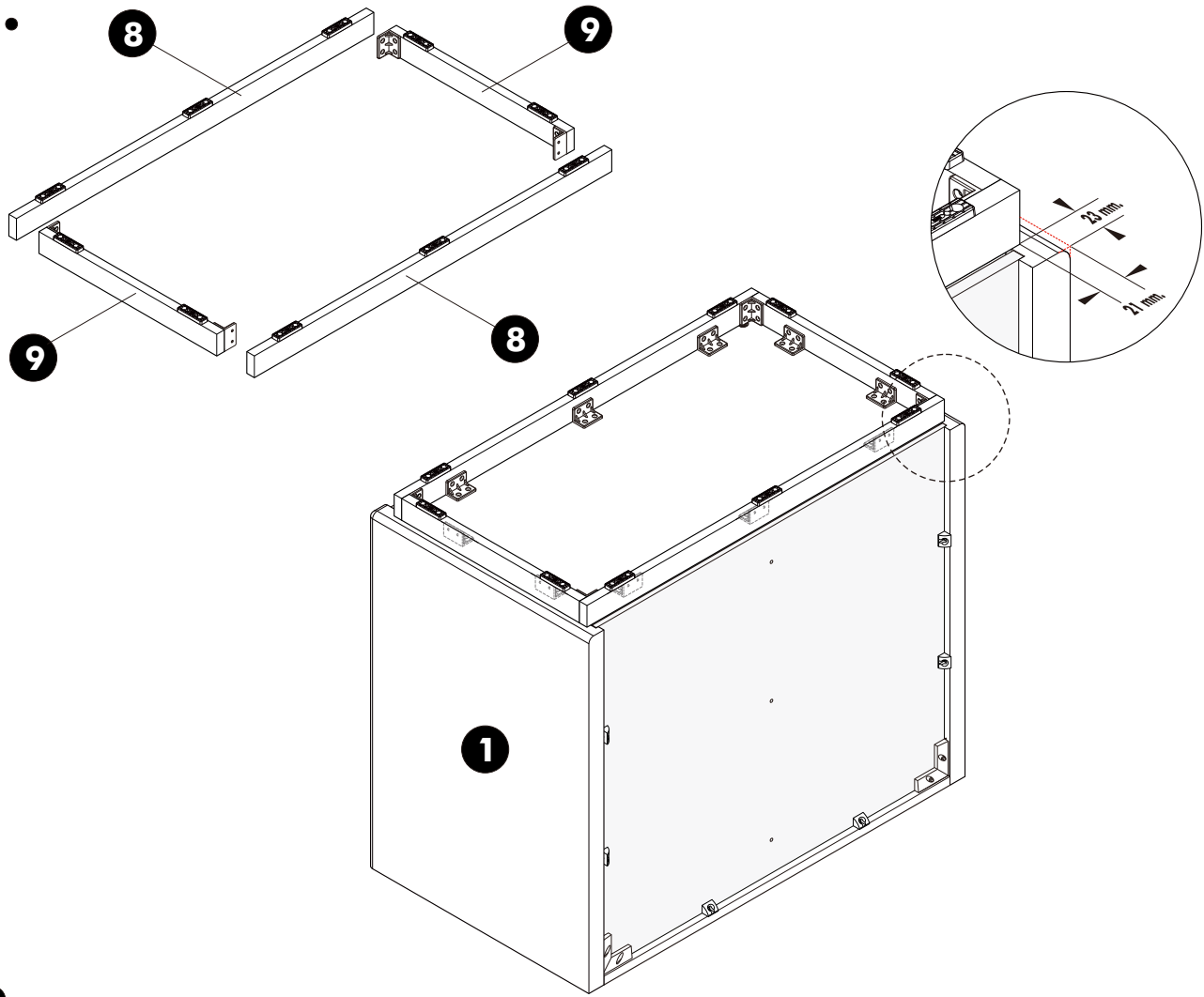

6.

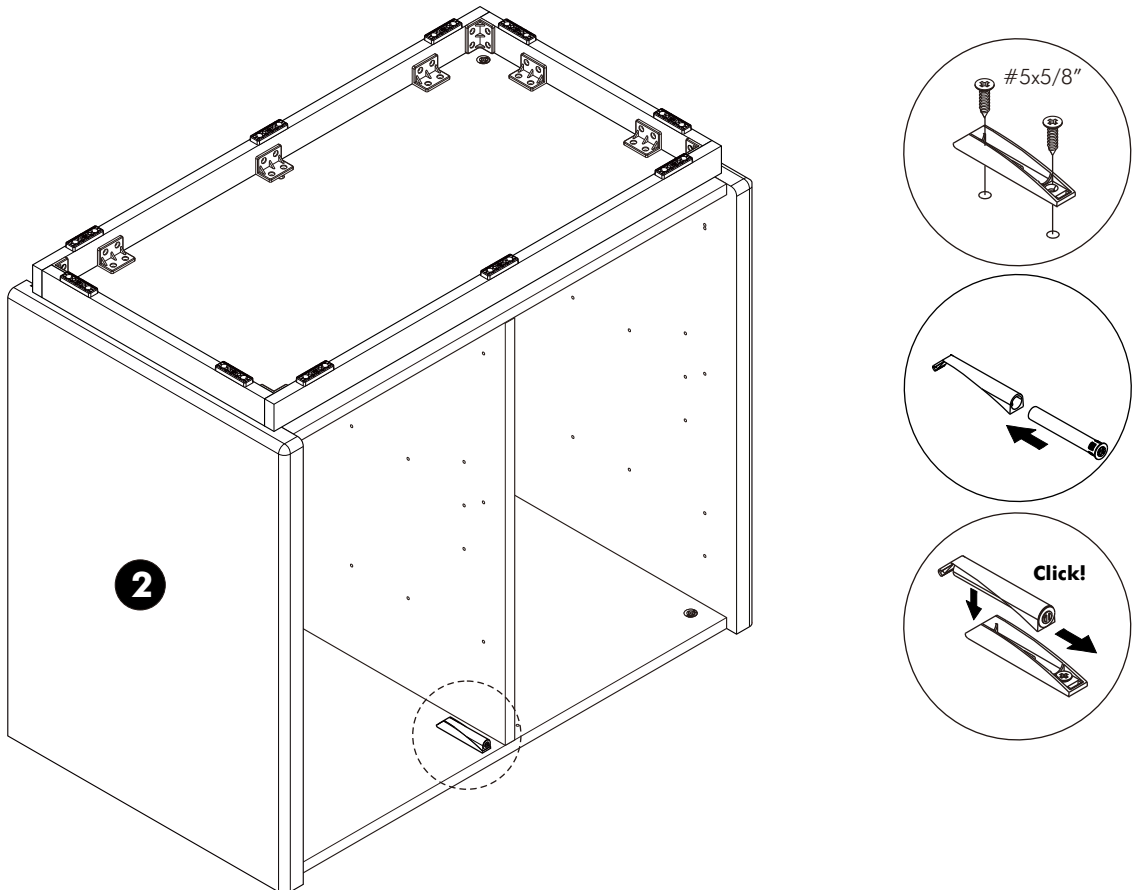

7.

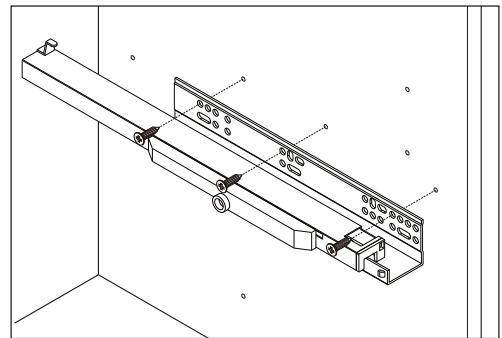
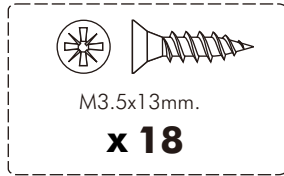
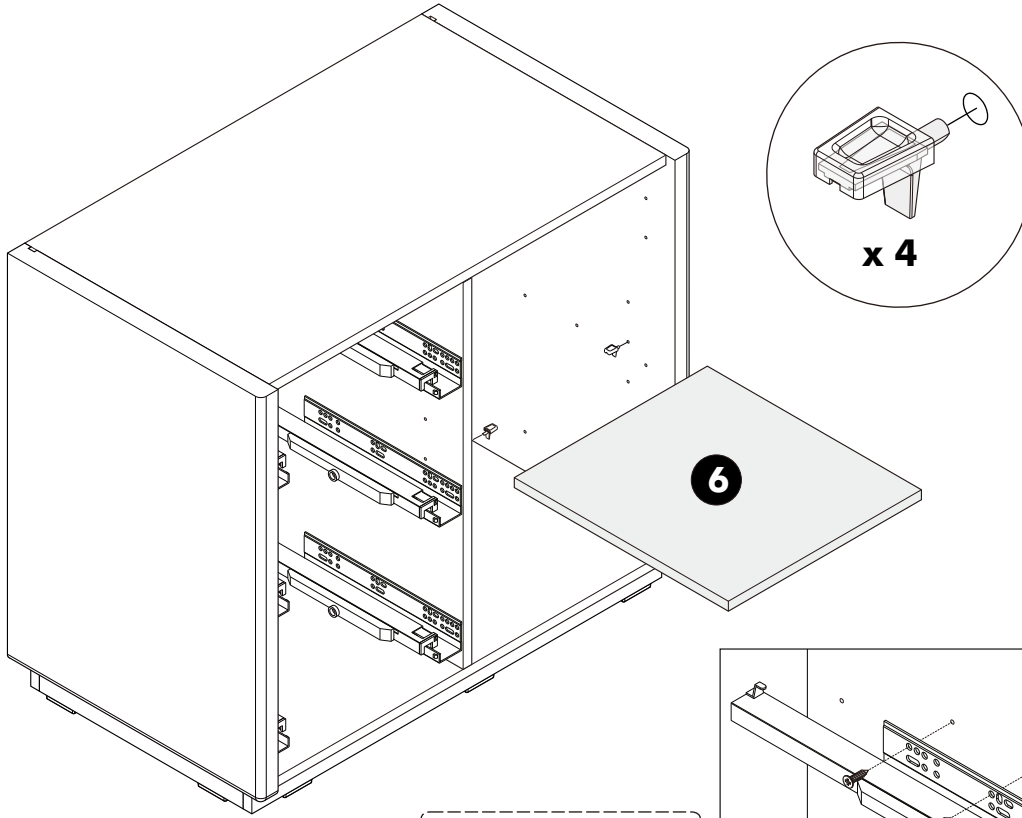

ASSEMBLY

TYPE:A/B

-DRAWER SET

1.

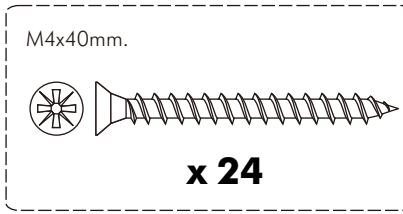
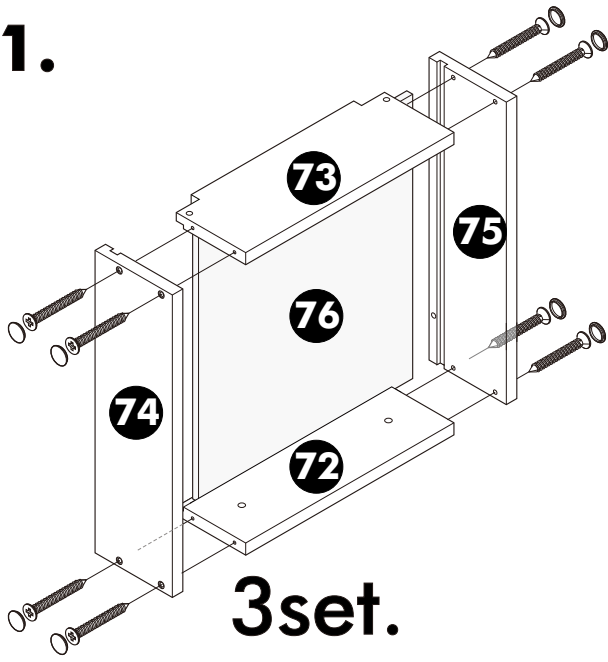

2set.

1set.

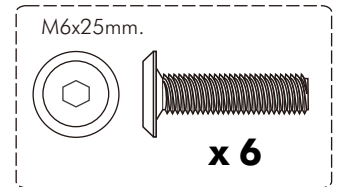
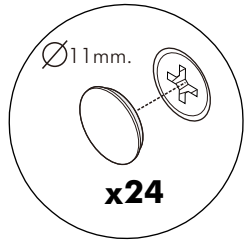
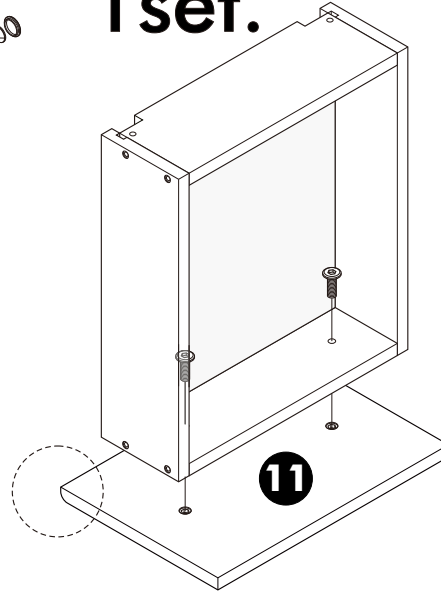

2.

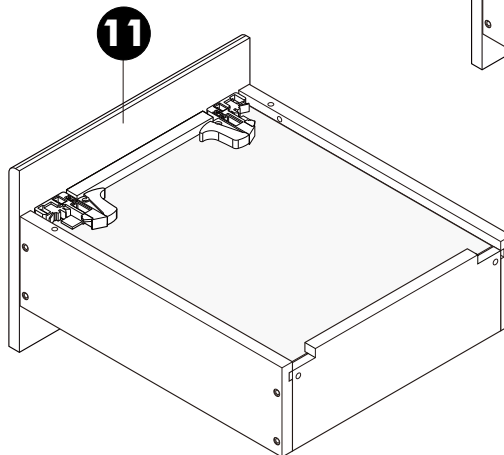
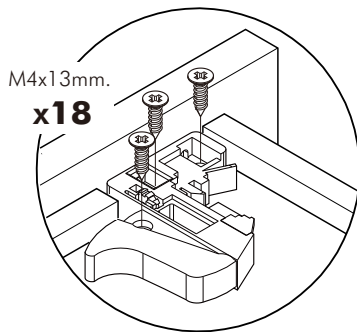

2set.

3.

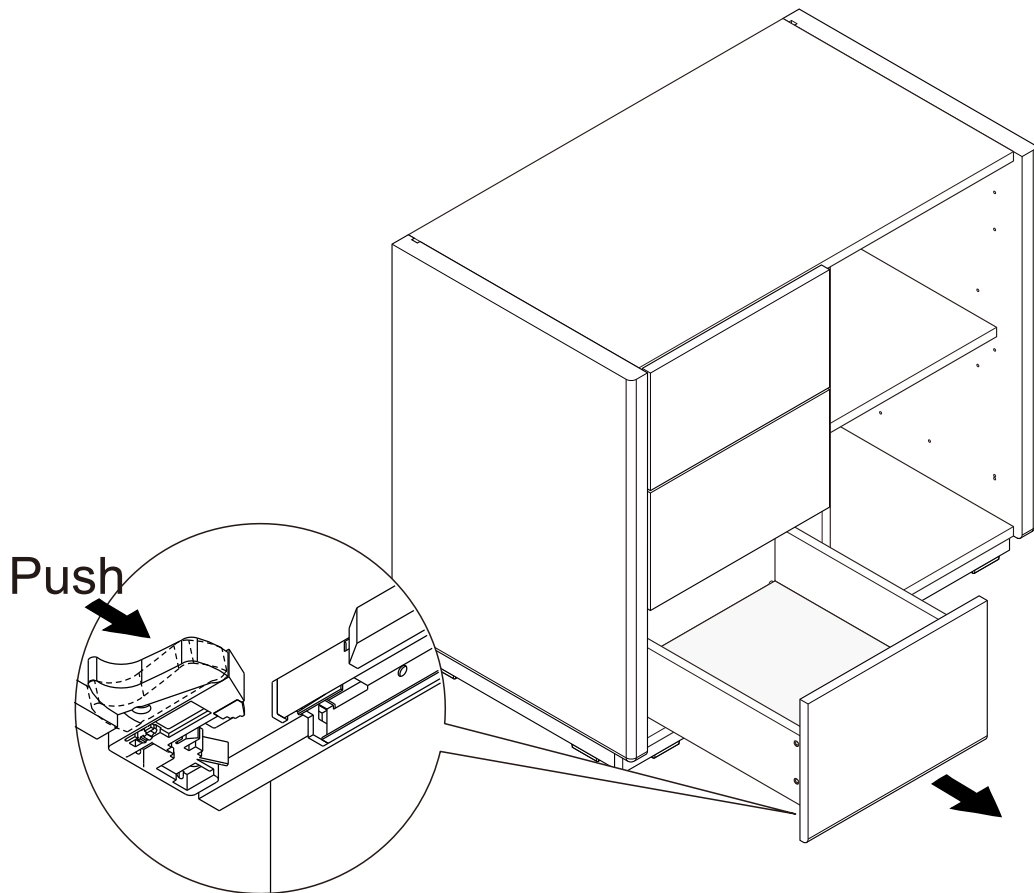
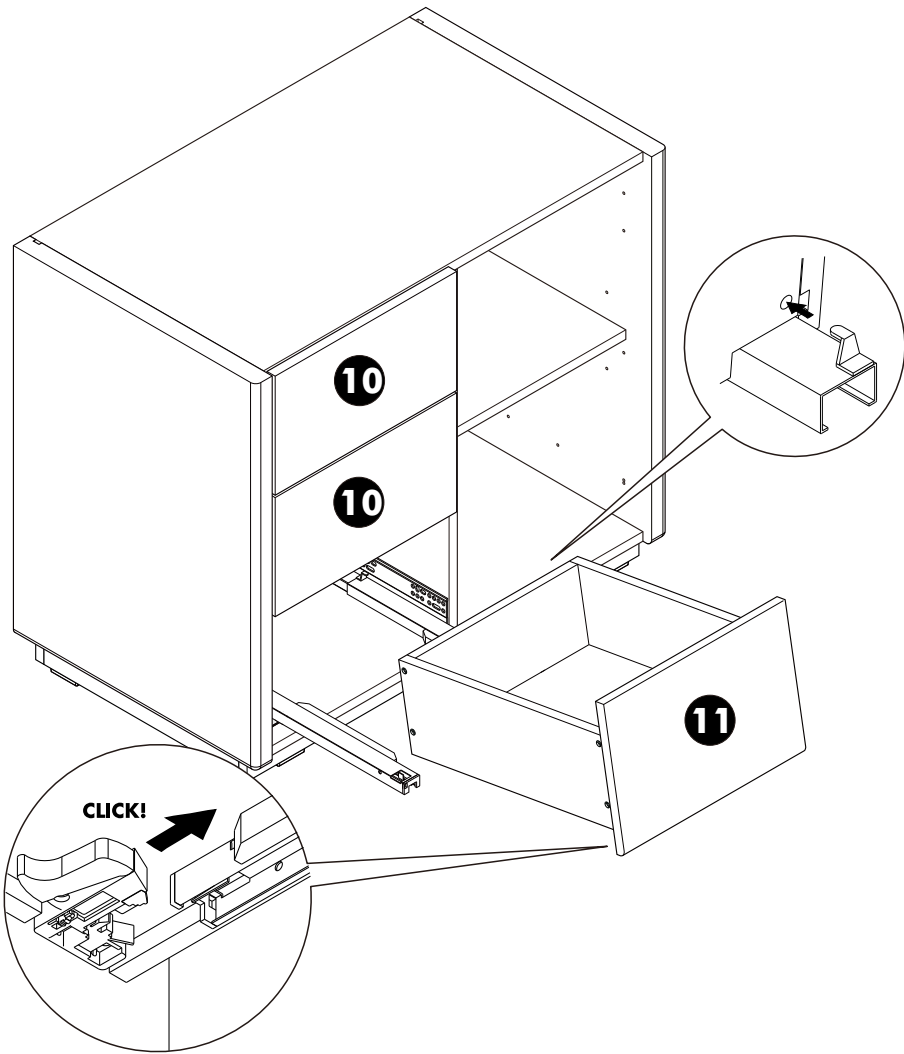



Gap ad justment

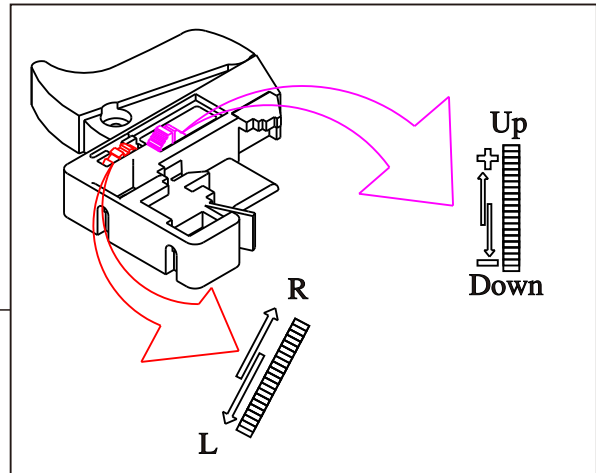
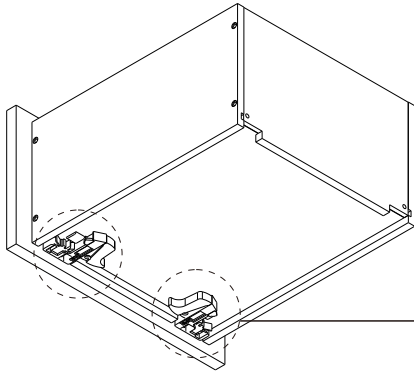

Gap space $\geq 5\text{mm}$.

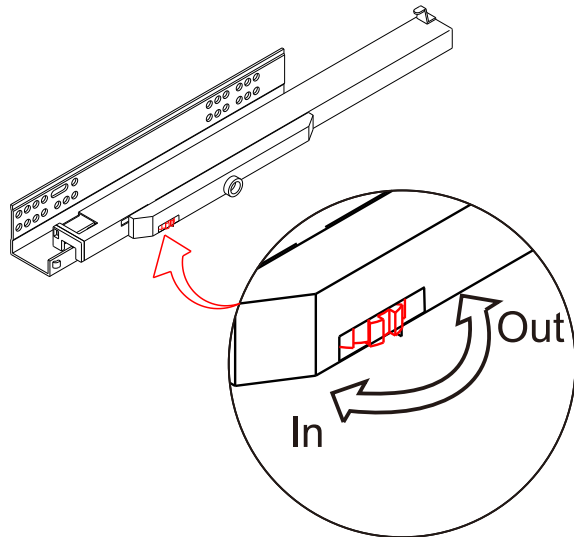

ASSEMBLY

-DOOR SET

1.

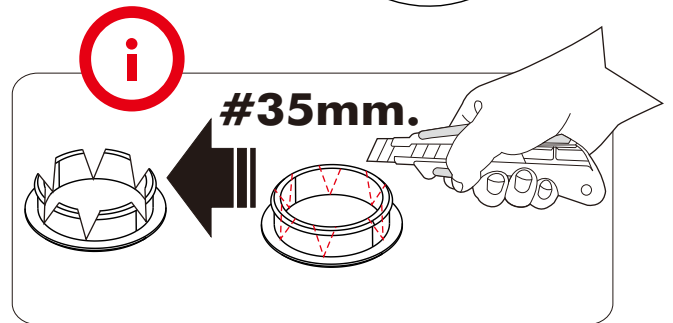
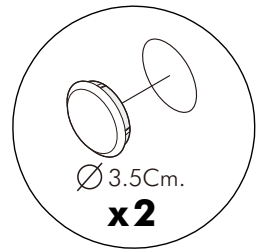
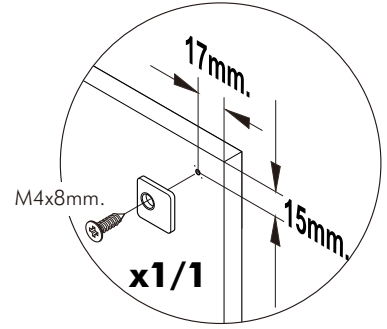
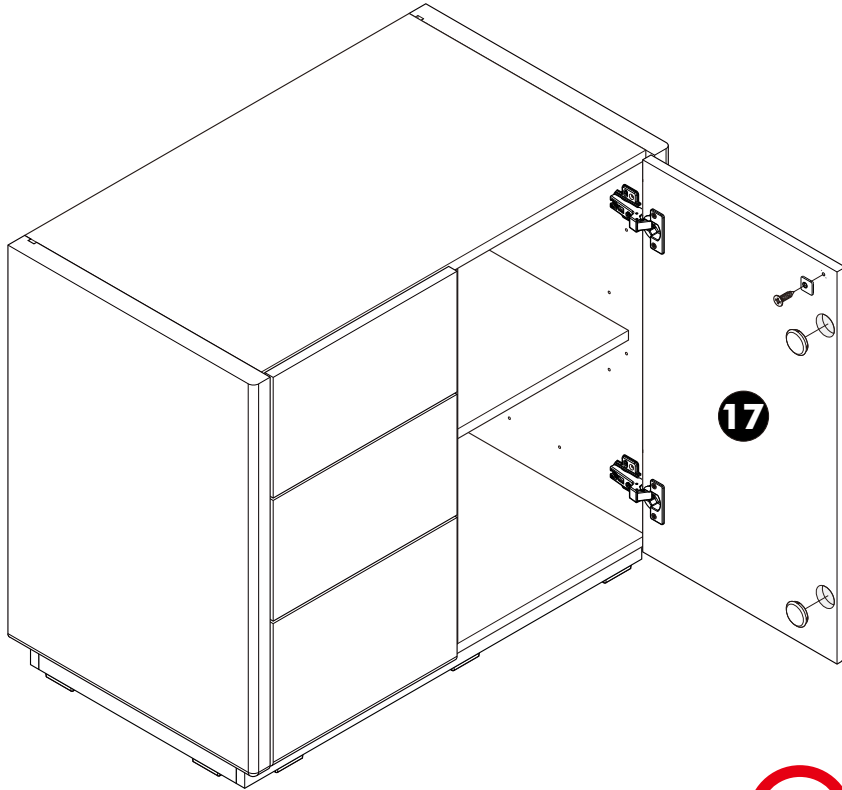

ASSEMBLY

TYPE:A/B

-TOP SET

1.

-PART No.12



#19mm. **x2**

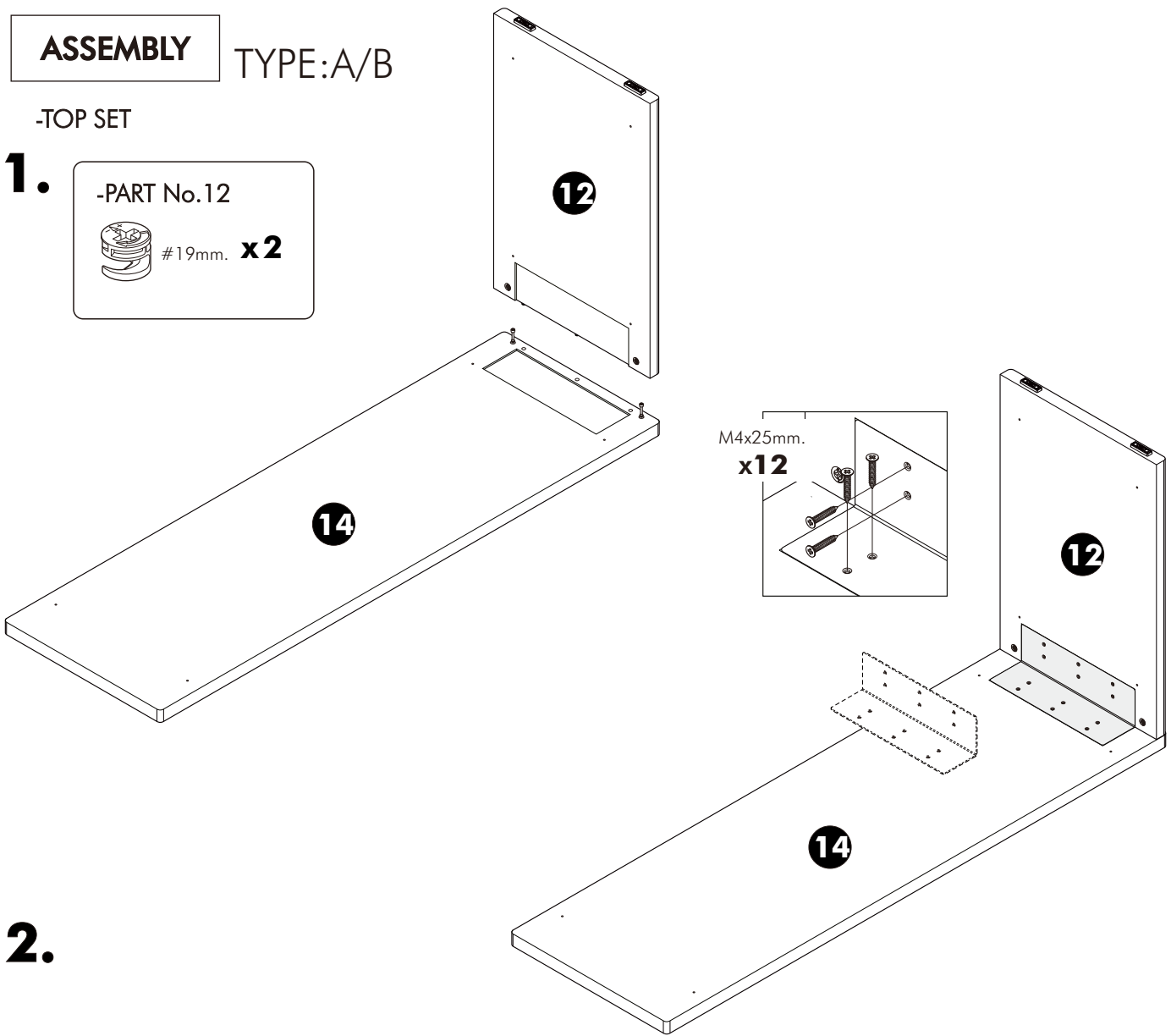

2.

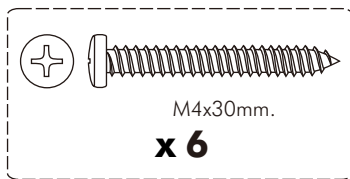

M4x30mm.

x 6

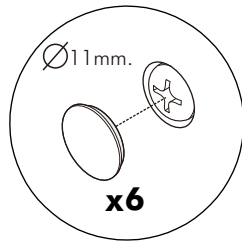

Ø11mm.

x6

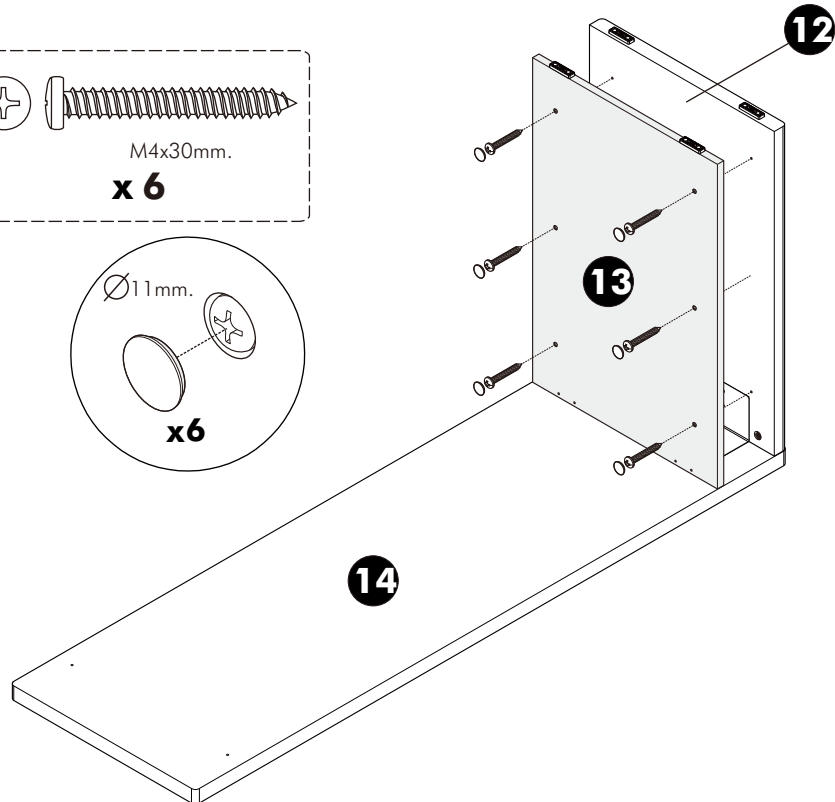

3.

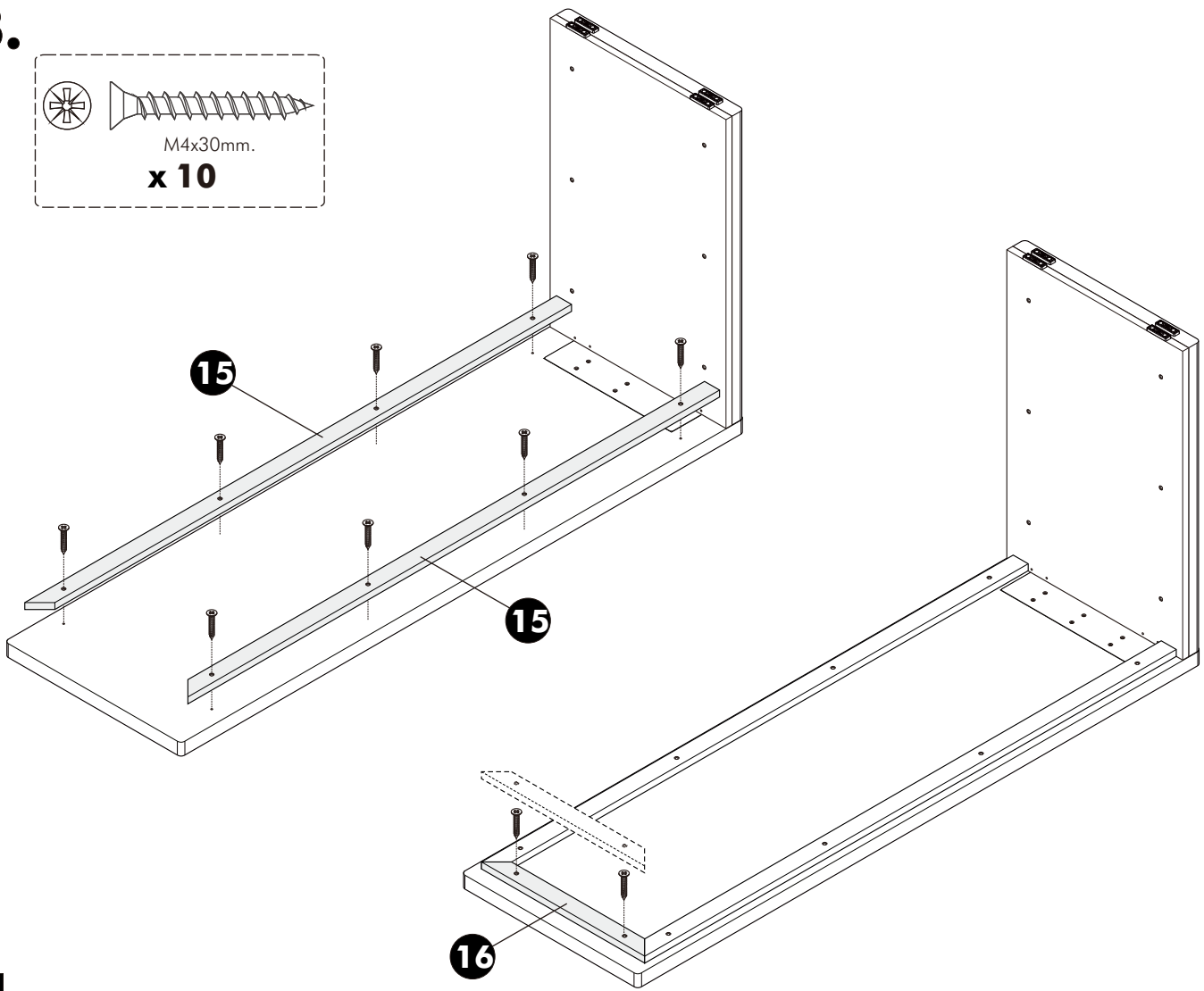
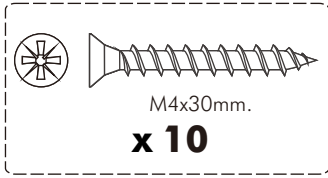

4.

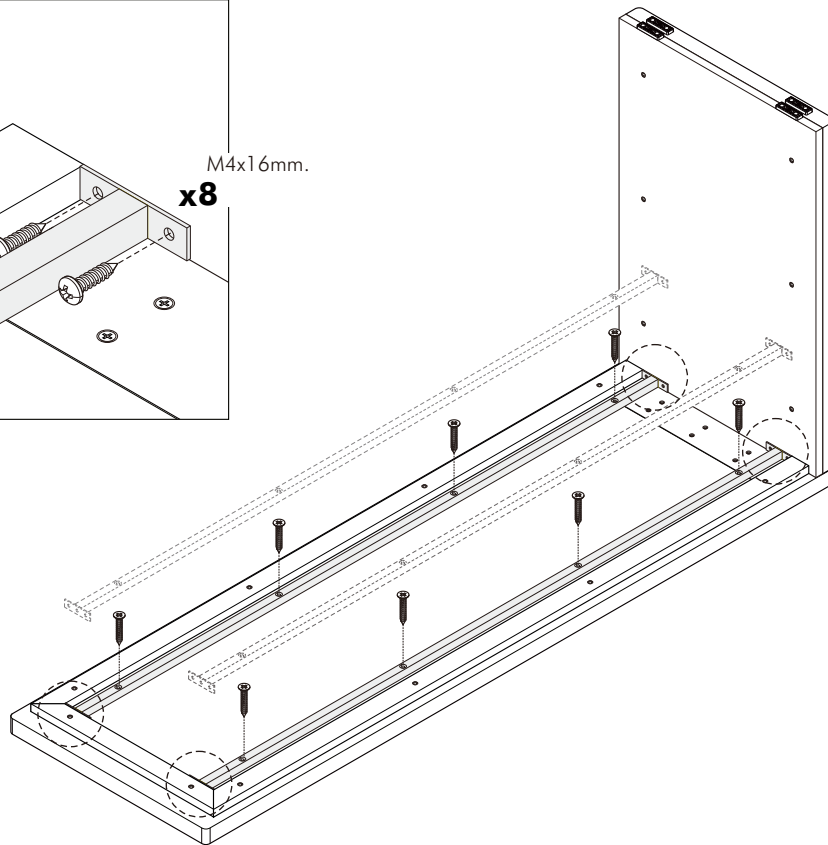
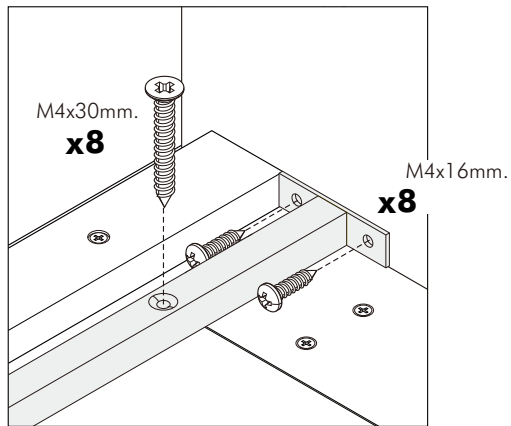

5.

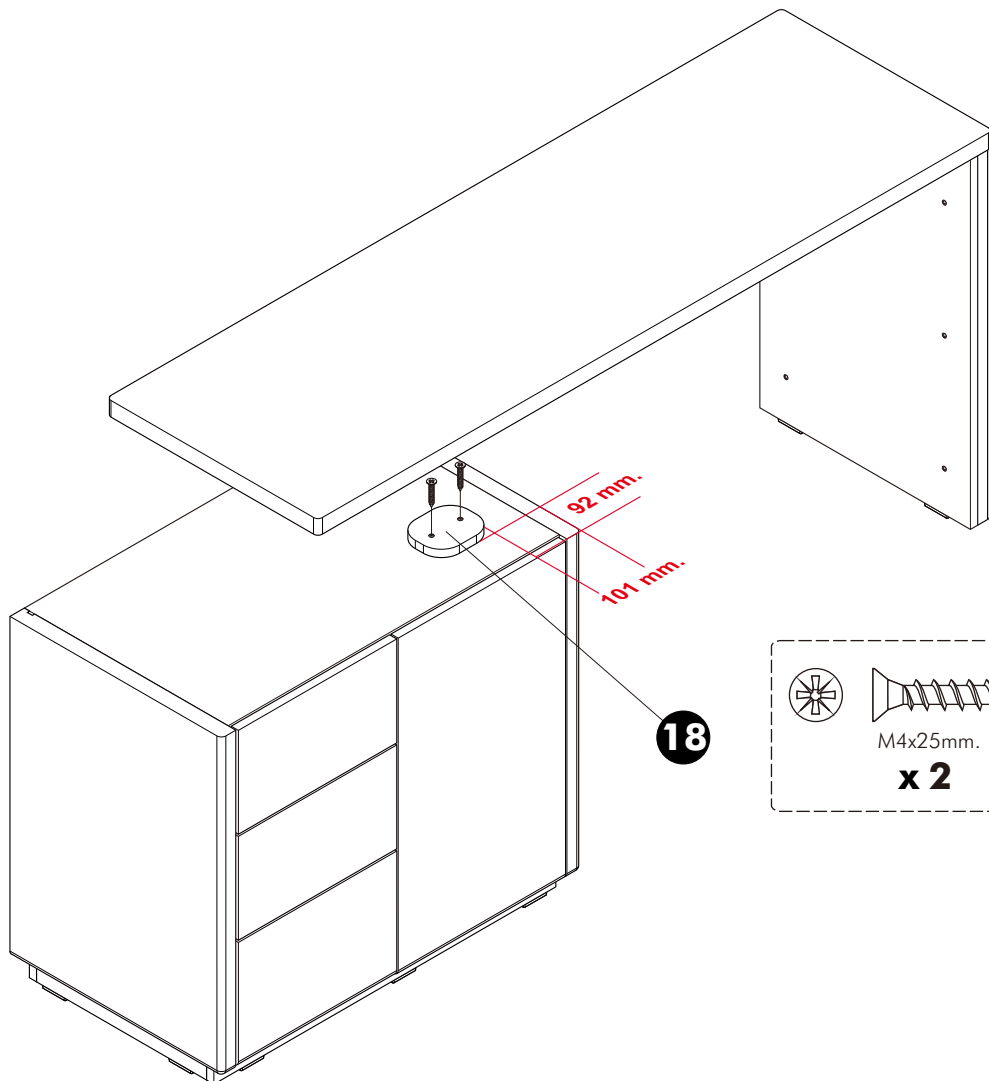
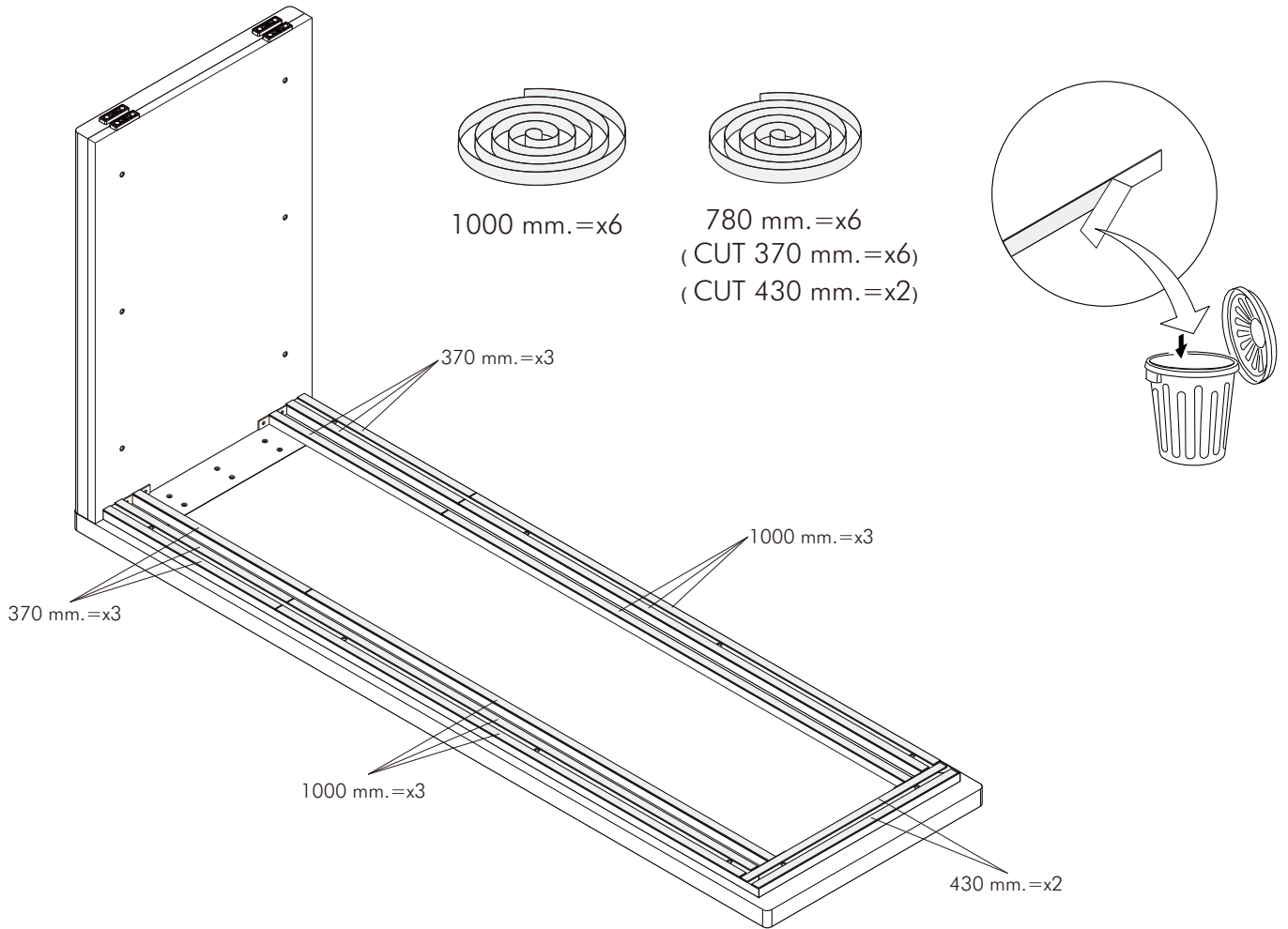



TYPE:A -150

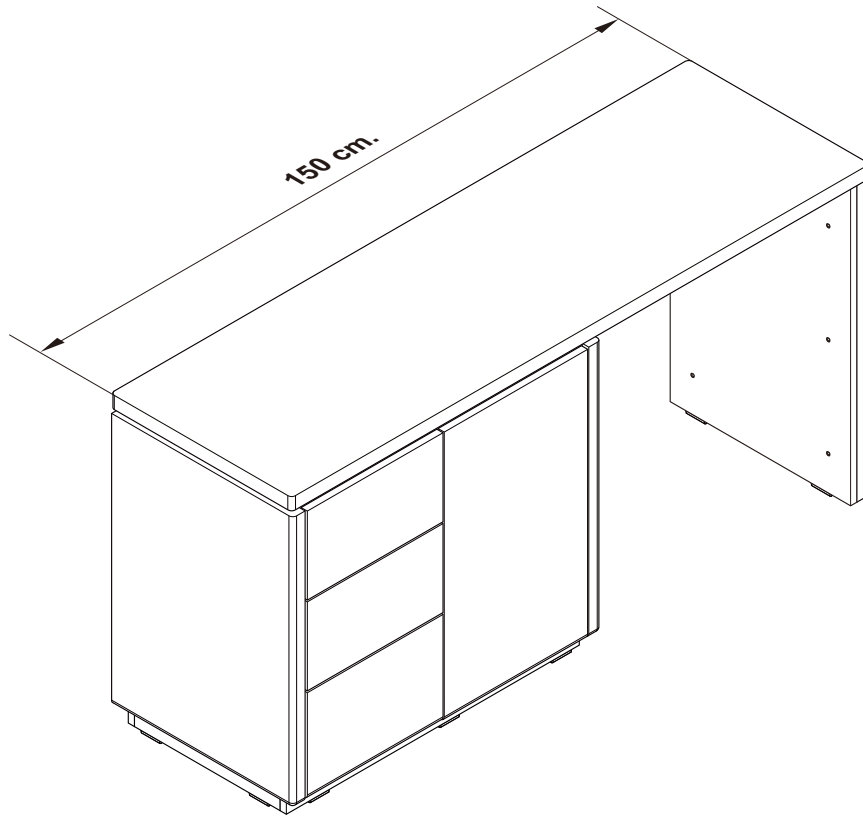

TYPE:A -200

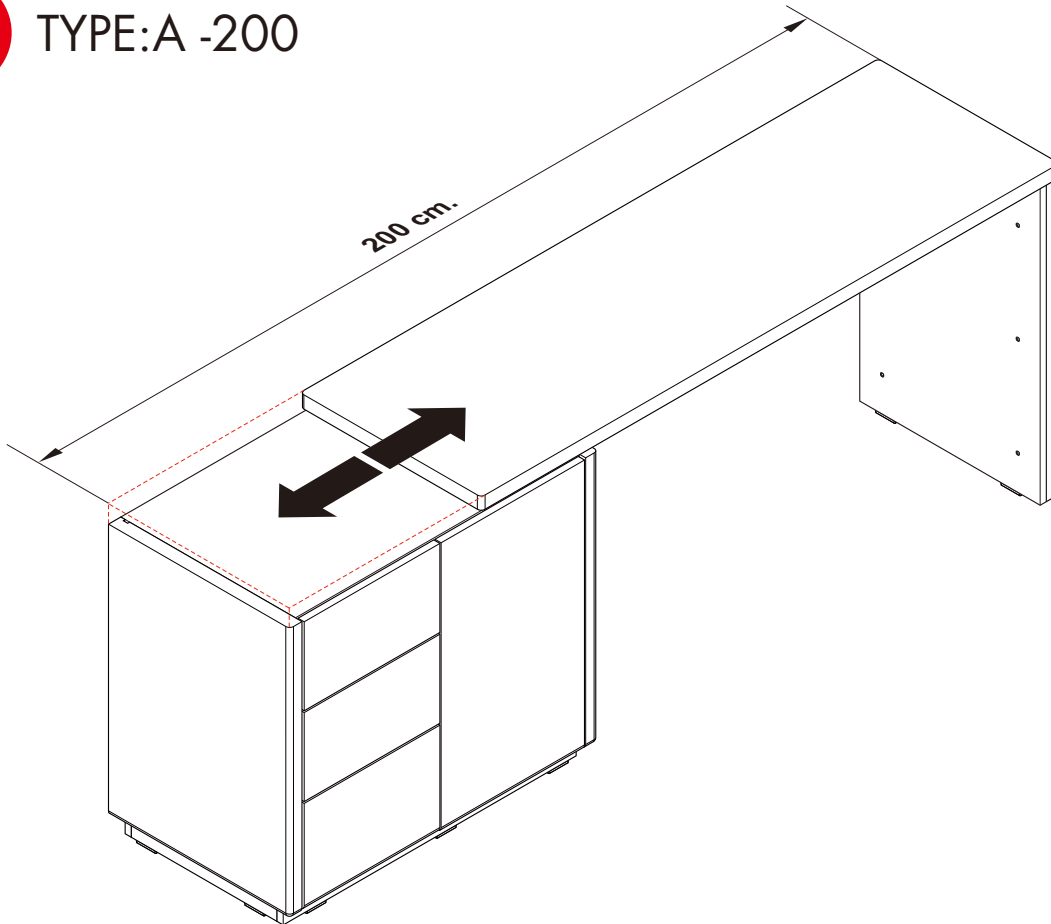

ASSEMBLY

TYPE:B

-BODY SET

1.

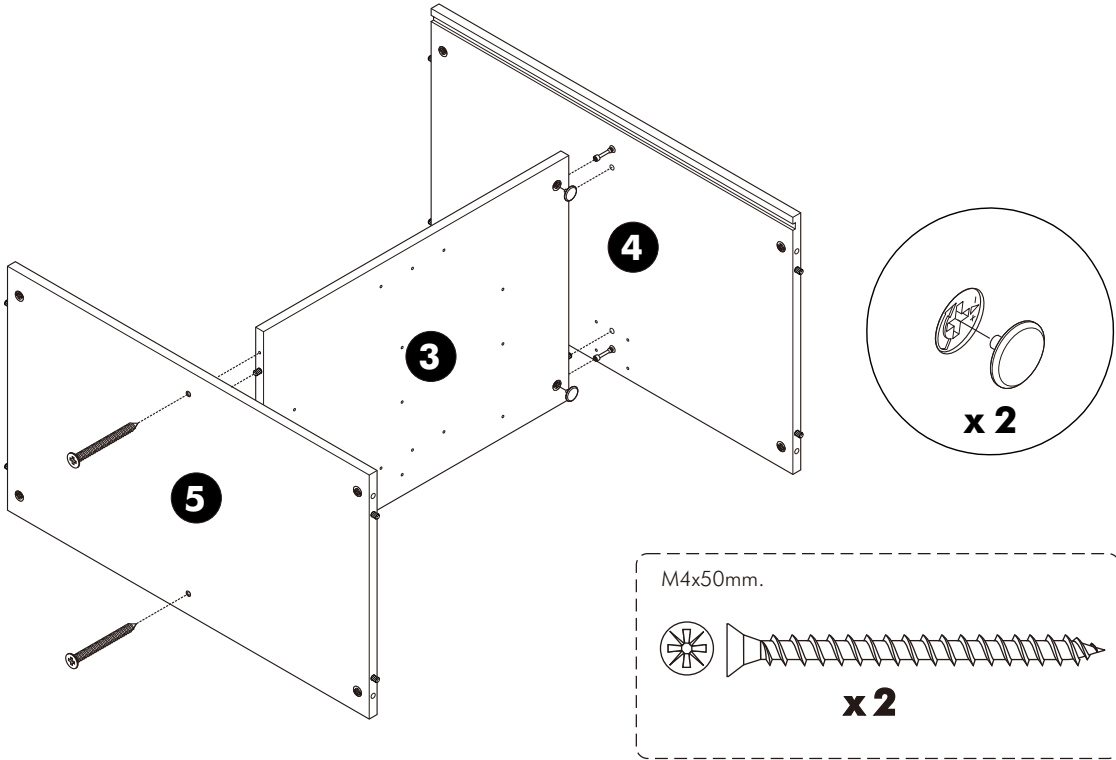

2.

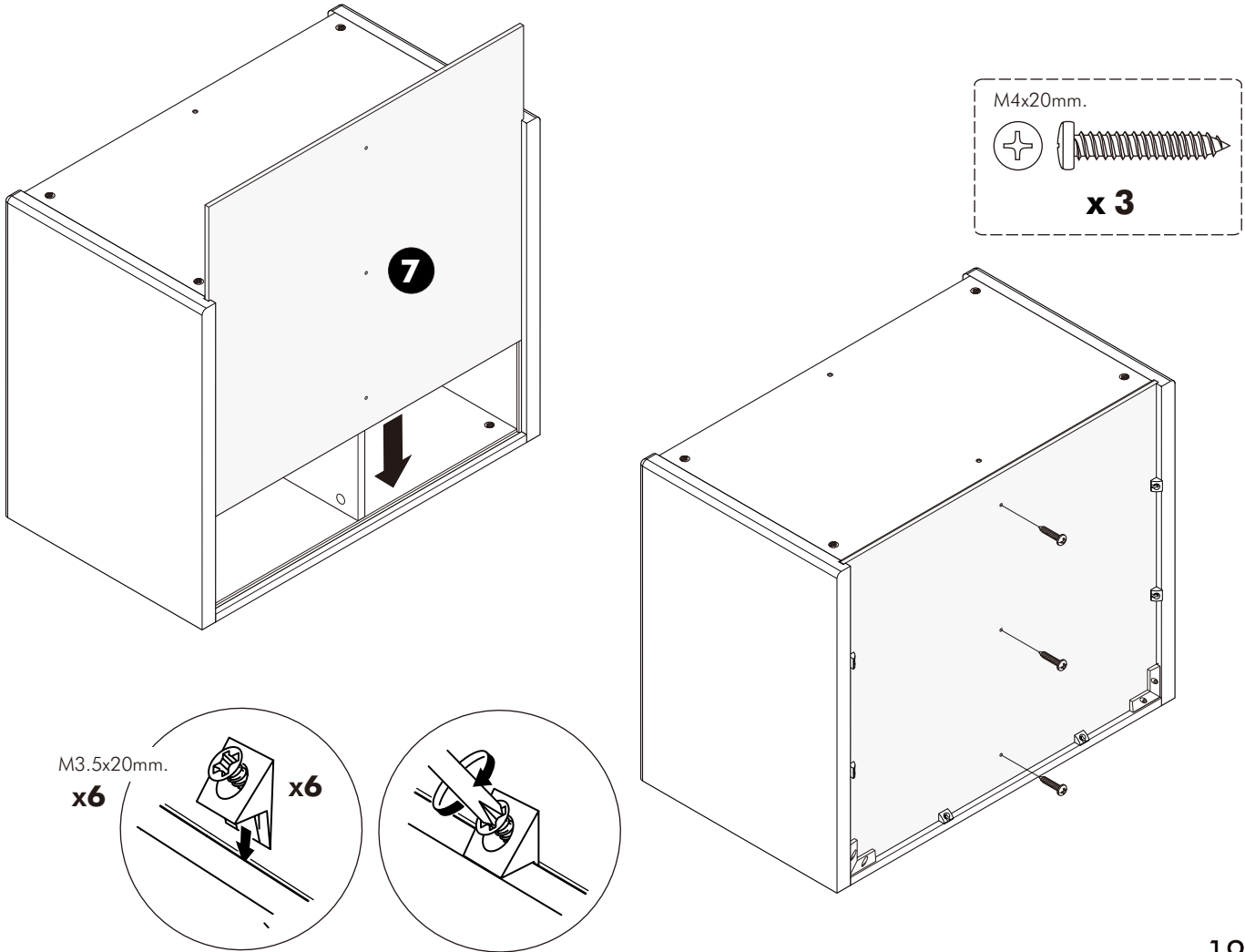

5.

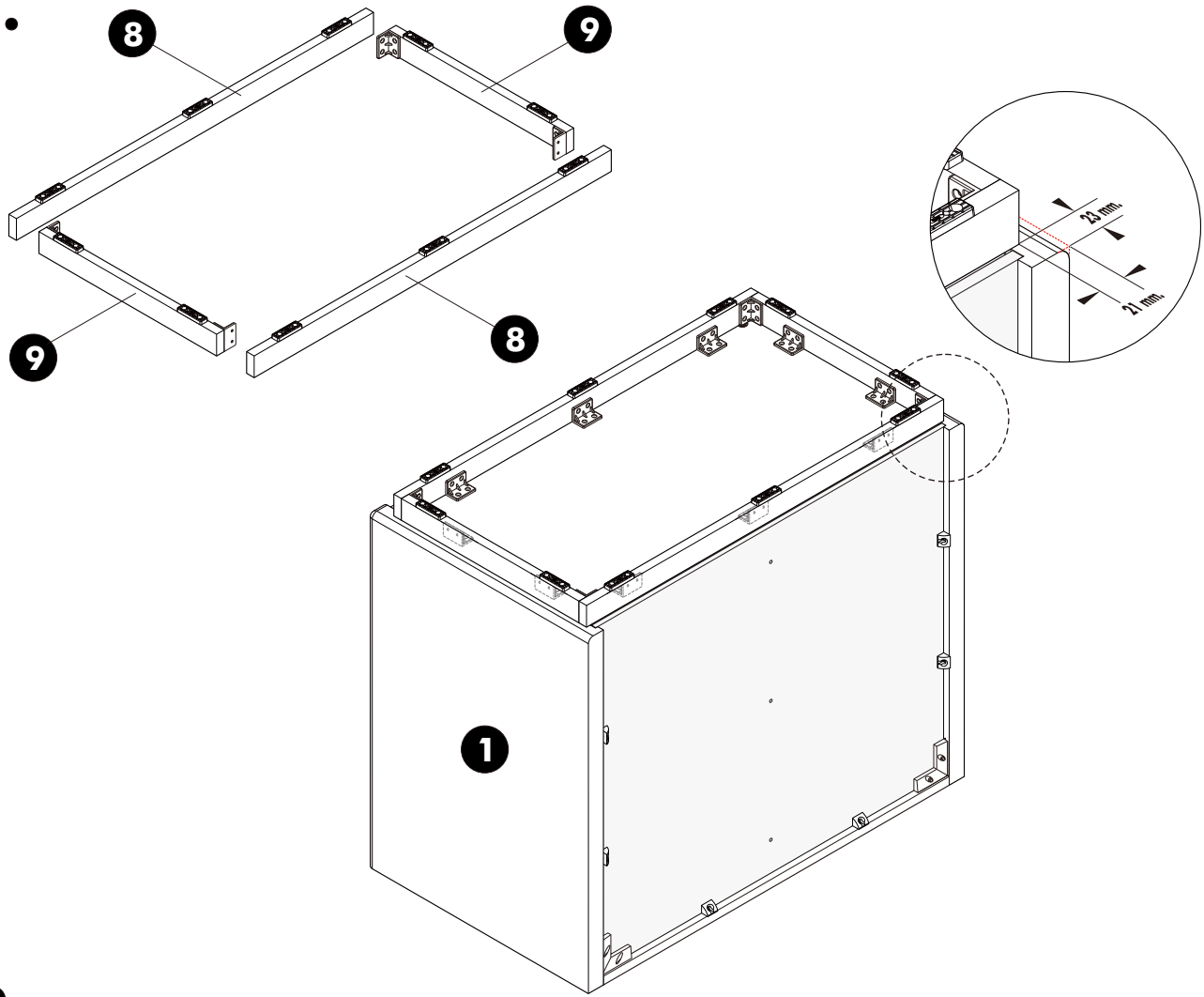

6.

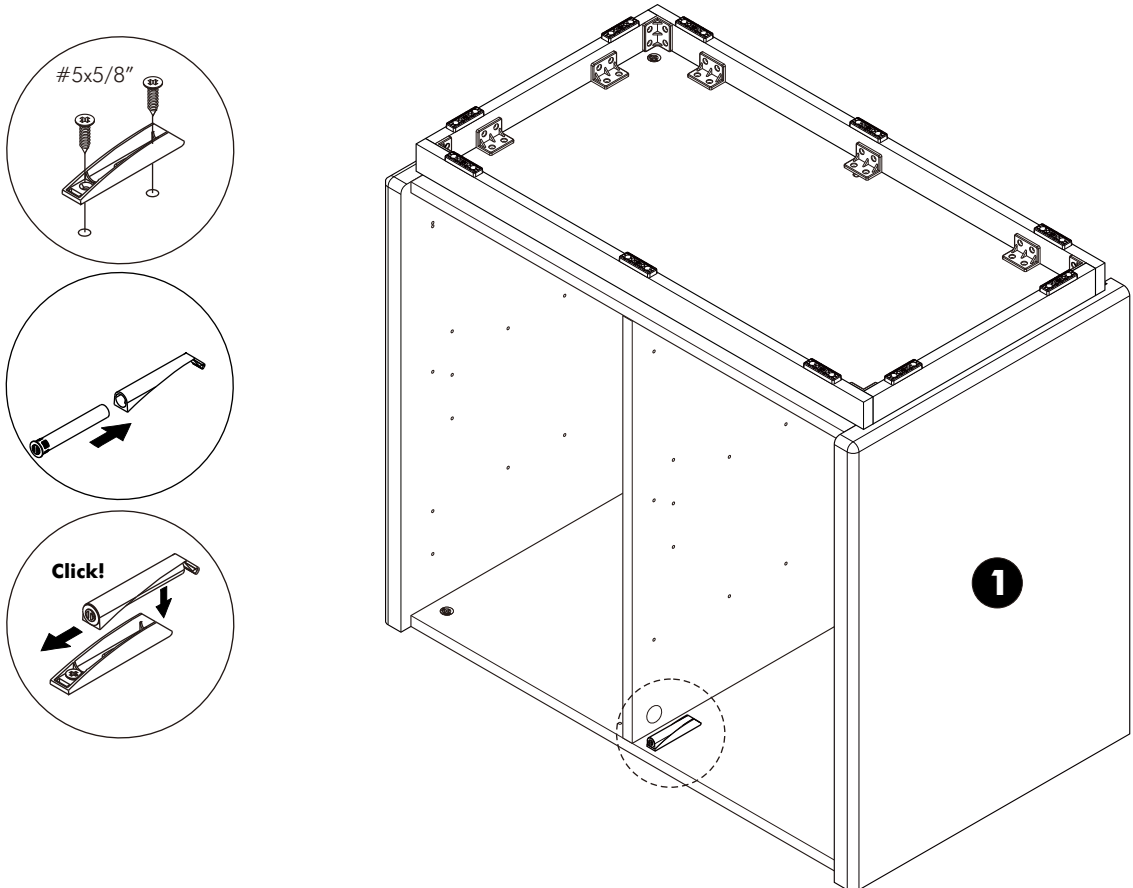

7.

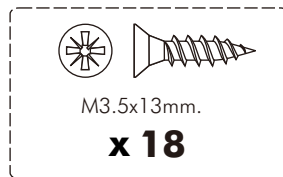
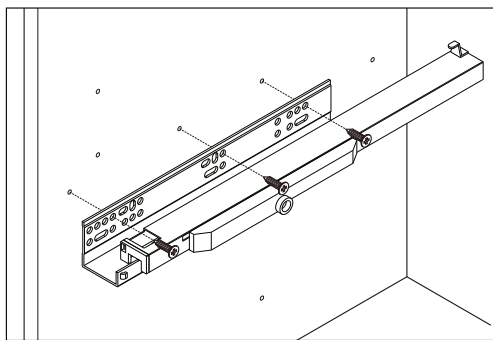
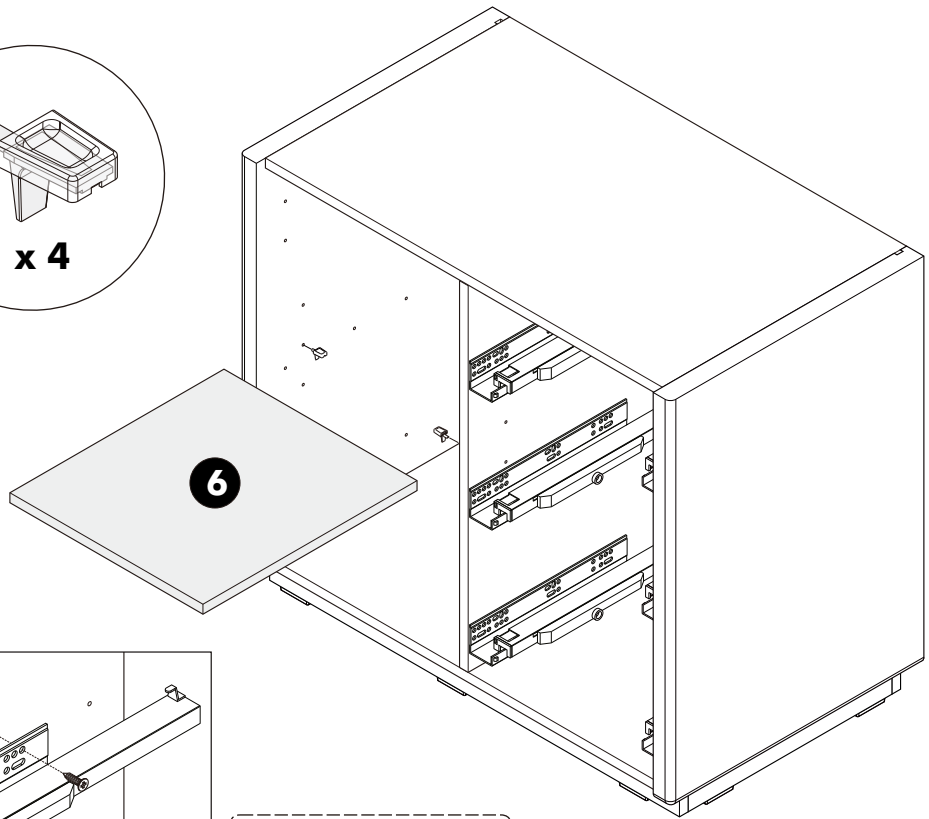
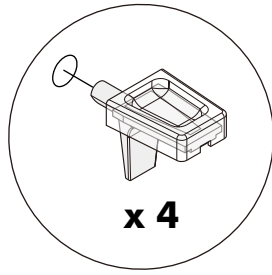

ASSEMBLY

-DOOR SET

1.

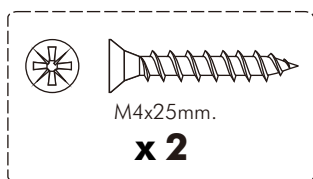
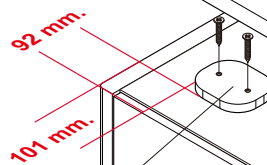
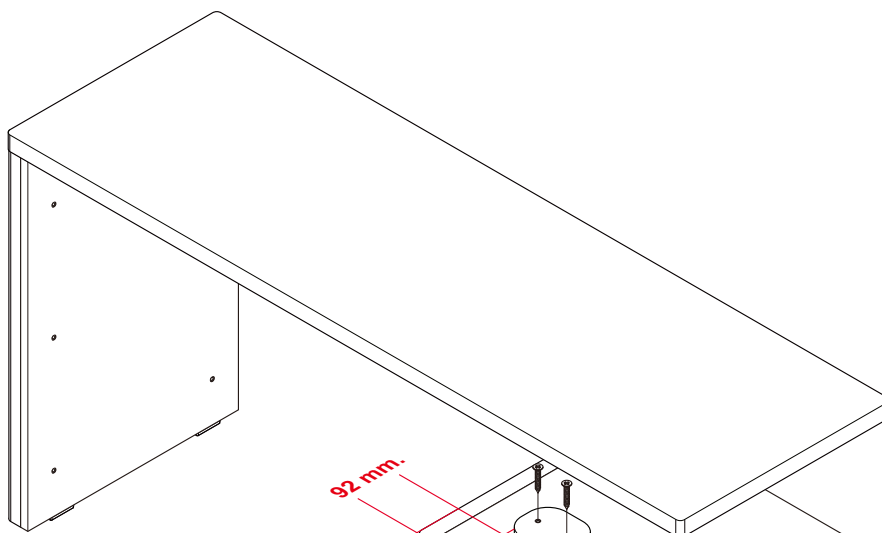
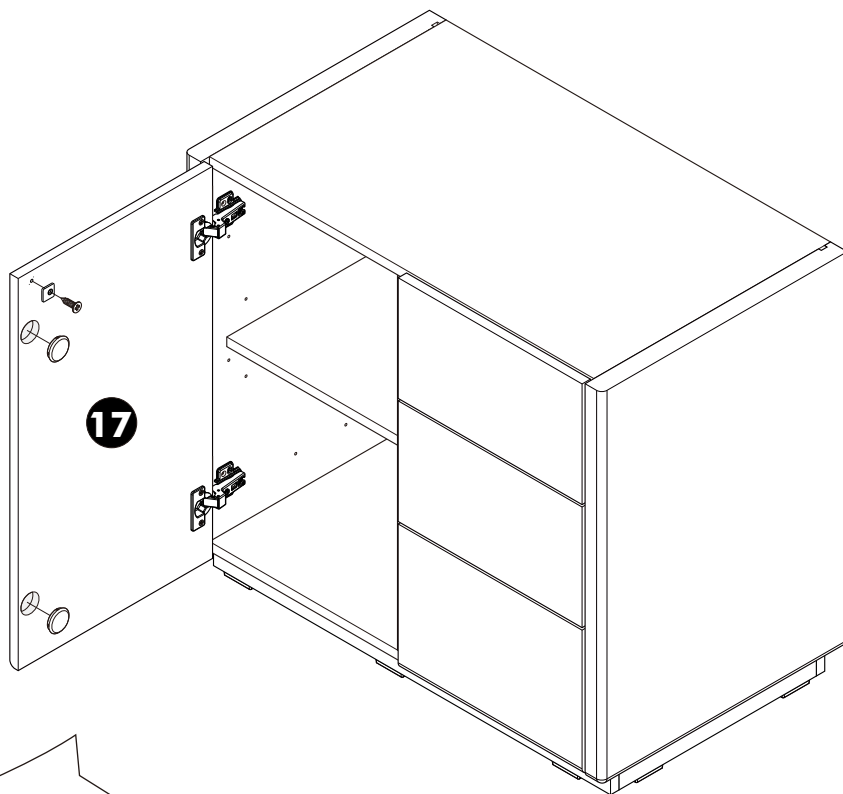
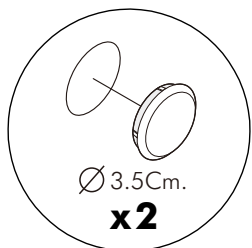
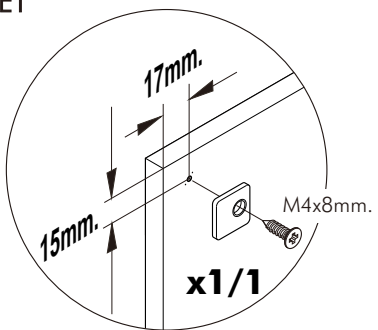

18

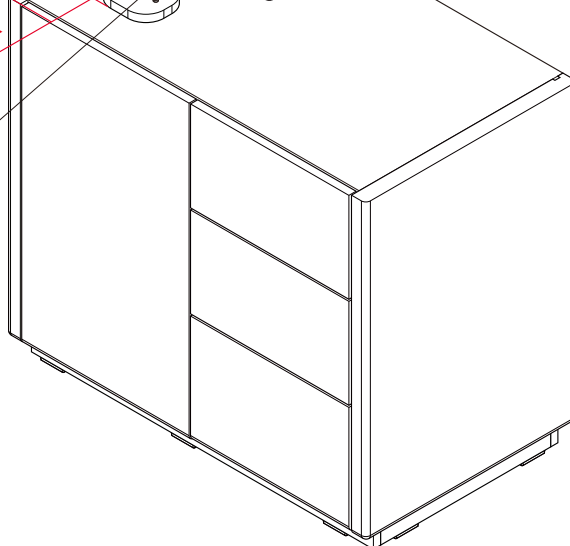



TYPE:B -150

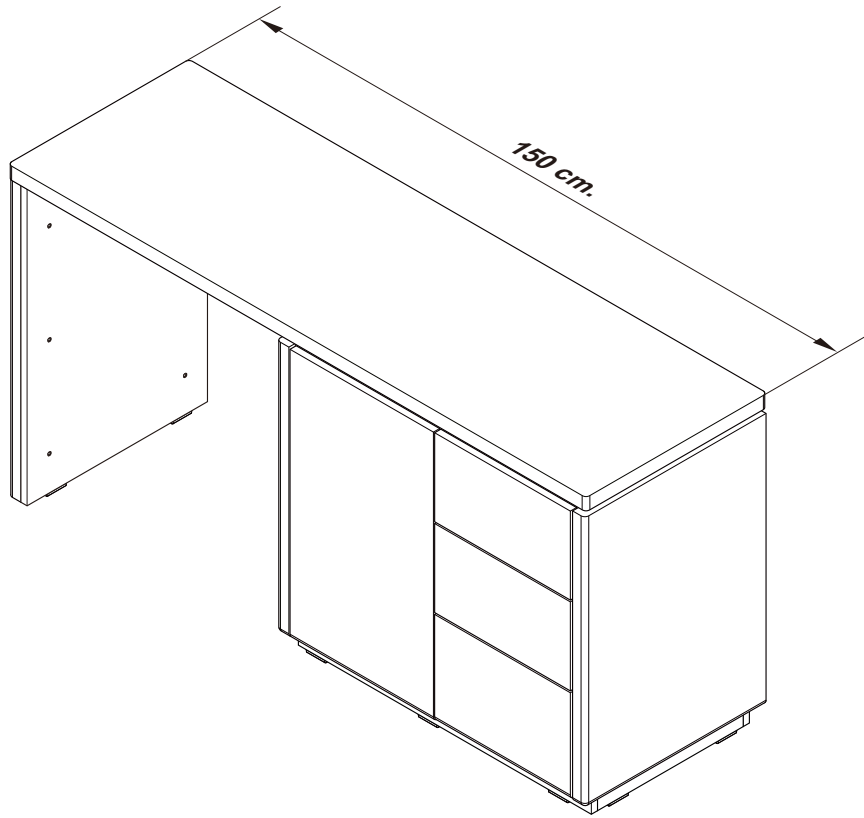

TYPE:B -200

