

BLANC/HI

Wardrobe 4

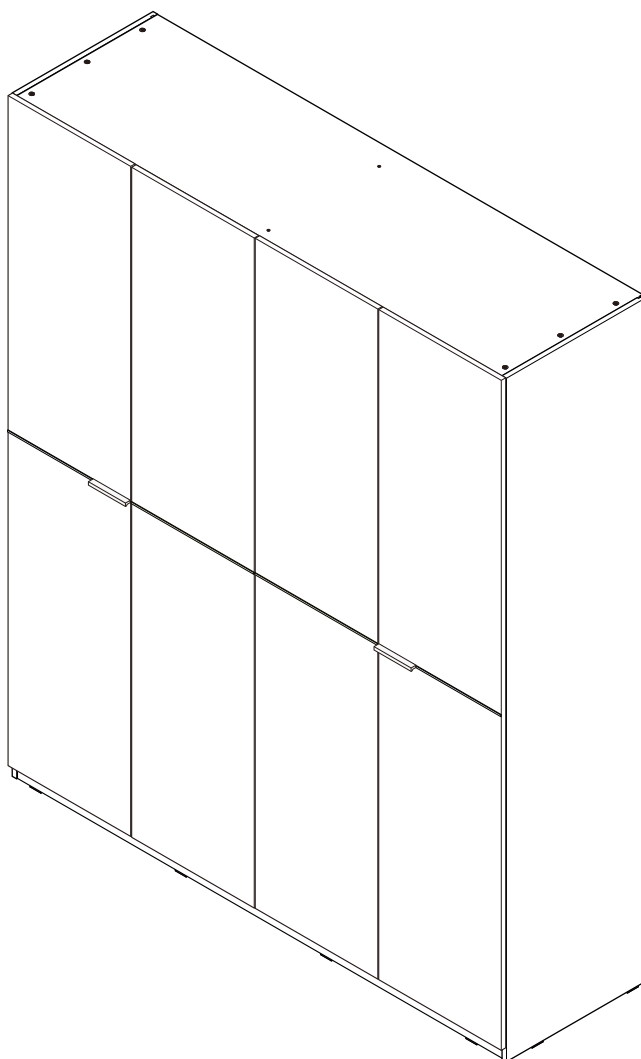

Can be assembled
both vertically and horizontally

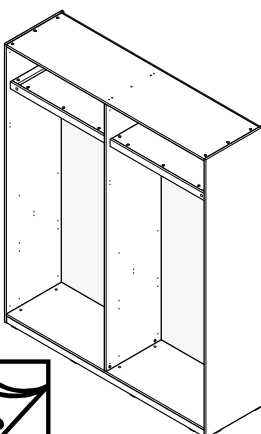
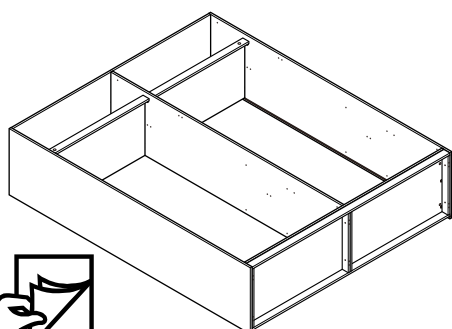

CONNECT SYSTEM

1

3

2

(Connecting bolts)

WHEN FITTING CAMS
 ENSURE STARTING POSITION IS CORRECT
 BEFORE YOU INSERT CONNECTING BOLT
 TURN CLOCKWISE UNTIL SECURE

✓				✗
	CORRECT	WRONG		

M4x16mm.

i

40mm.

☹️

✗

EQ

😊

✓

M4x13mm.

Ø3x3mm

9mm.

9mm.

1mm.

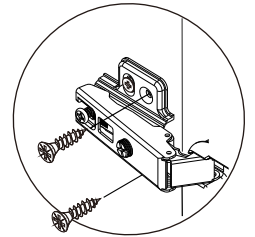
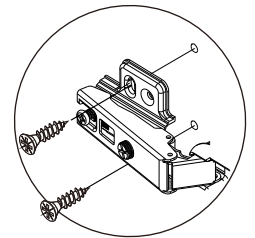
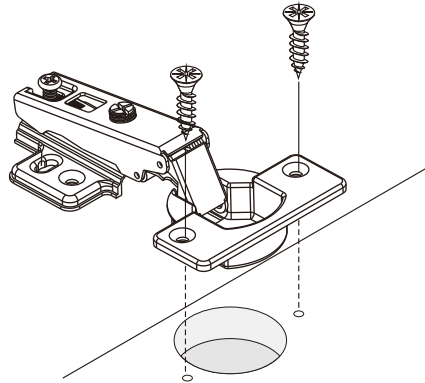
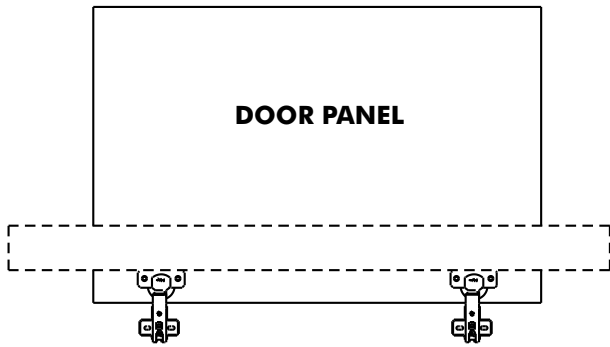
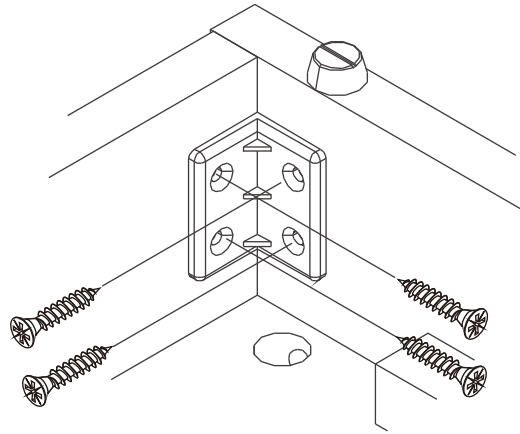
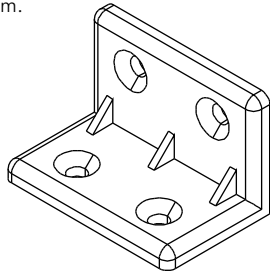

1

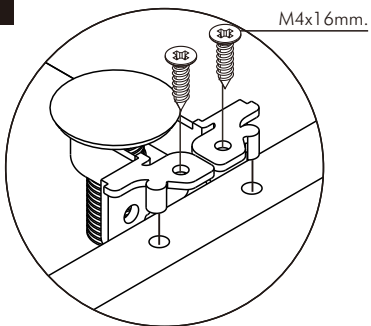

2

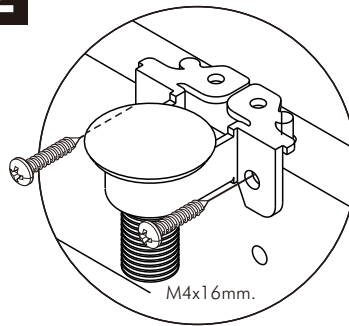

3

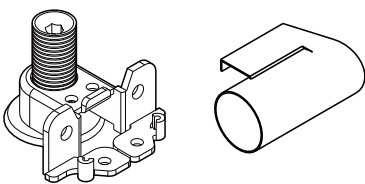
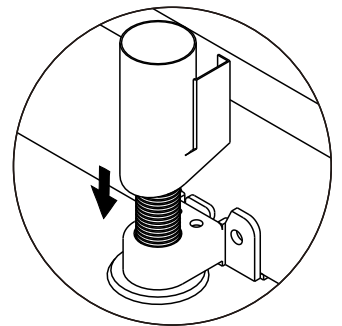



มาตรฐาน การระบุสินค้าที่ต้องยึด Fitting กันล้ม (Safety Fitting) ***หมายเหตุ เป็นชุดเด็ก ไม้ชุดตั้ง Fitting กันล้มทุกตัว***

■ หมวด ตู้บานเปิด / ตู้บานปิด + ช่องใส่

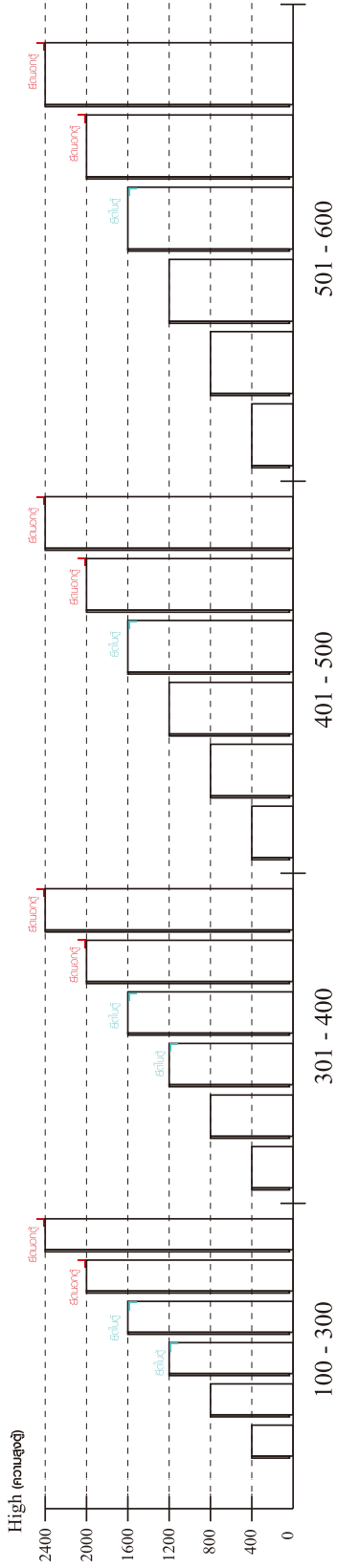

■ ยึดตั้งฉากกันล้มกับตู้สูง (ตั้งได้ 2 m. ขึ้นไป)



ยึดตั้งชนผนัง

ยึดตั้งลอยหลบผนัง

ความสูงตั้งได้ 1200 ขึ้นไป สลักไม้กัน 300

ความสูงตั้งได้ 1600 ขึ้นไป สลักไม้กัน 400

ความสูงตั้งได้ 1600 ขึ้นไป สลักไม้กัน 300

ความสูงตั้งได้ 1600 ขึ้นไป สลักไม้กัน 400

ความสูงตั้งได้ 1600 ขึ้นไป สลักไม้กัน 300

■ หมวด ตู้ลิ้นชัก / ตู้ลิ้นชัก + ช่องใส่ / ตู้ลิ้นชัก + บานเปิด / ตู้ลิ้นชัก + บานสไลด์

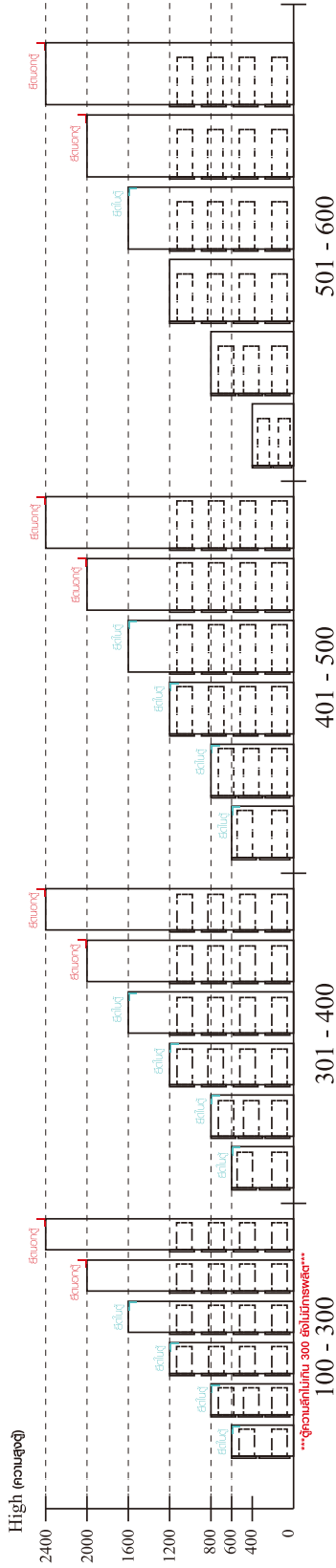

■ ยึดตั้งฉากกันล้มกับตู้เตี้ย (น้อยกว่า 2 m.)

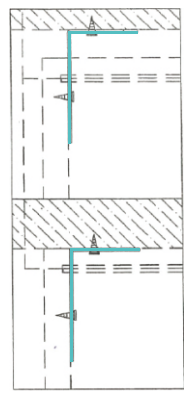

ยึดตั้งชนผนัง

ยึดตั้งลอยหลบผนัง

ความสูงตั้งได้ 600 ขึ้นไป สลักไม้กัน 300

ความสูงตั้งได้ 600 ขึ้นไป สลักไม้กัน 400

ความสูงตั้งได้ 600 ขึ้นไป สลักไม้กัน 300

ความสูงตั้งได้ 1600 ขึ้นไป สลักไม้กัน 300

ความสูงตั้งได้ 1600 ขึ้นไป สลักไม้กัน 400

■ หมวด ตู้บานสไลด์ / ตู้ใส่

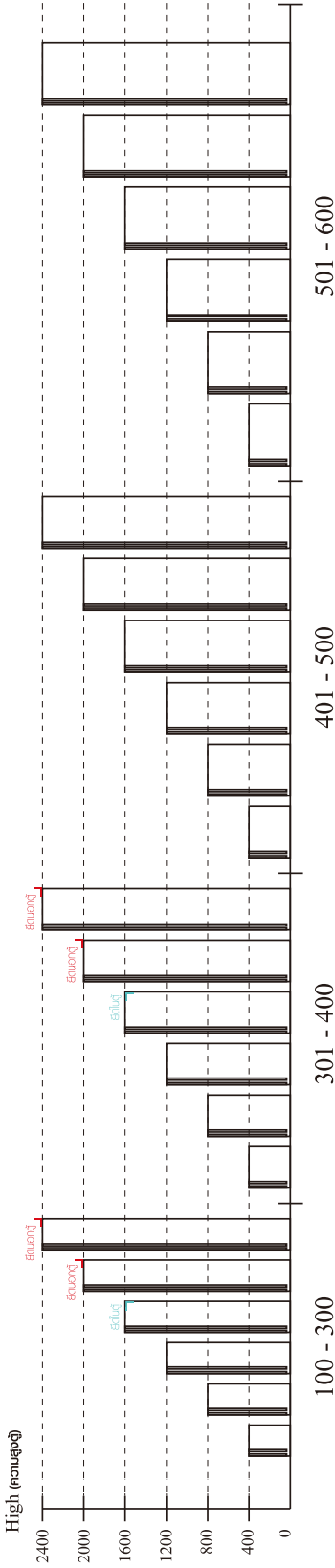

ความสูงตั้งได้ 1600 ขึ้นไป สลักไม้กัน 300

ความสูงตั้งได้ 1600 ขึ้นไป สลักไม้กัน 400

ความสูงตั้งได้ 1600 ขึ้นไป สลักไม้กัน 300

ความสูงตั้งได้ 1600 ขึ้นไป สลักไม้กัน 300

ความสูงตั้งได้ 1600 ขึ้นไป สลักไม้กัน 400

HARDWARE

-BODY SET



x 42



x 42

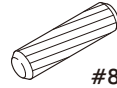

#8x35

x 46

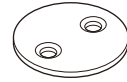

x 4

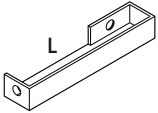

x 3

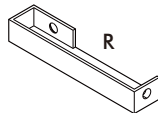

x 3

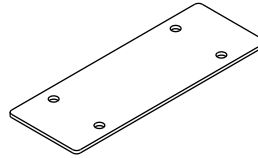

x 2

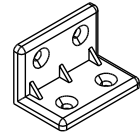

x 18



x 14

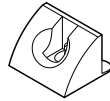

x 8

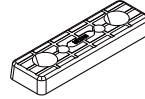

x 14

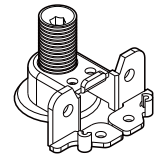

x 6

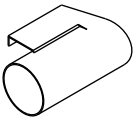

x 6



x 16



5x18 mm.

x 6

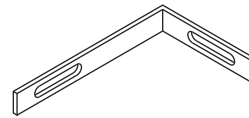

x 2

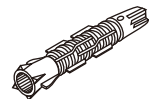

x 2



M3.5x25mm.

x 8



M4x13mm.

x 26



M4x16mm.

x 112



M4x25mm.

x 42



M4x30mm.

x 26



M5x50mm.

x 2



6x3/8"

x 8



M4x16mm.

x 14



M4x20mm.

x 25



M4x30mm.

x 24



6x1/2"

x 6

HARDWARE

-DRAWER SET

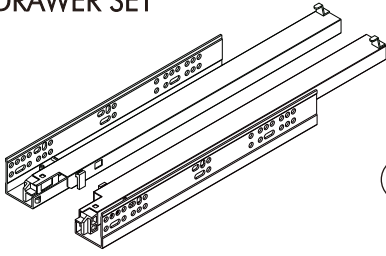

x 3 Set

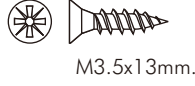

x 18

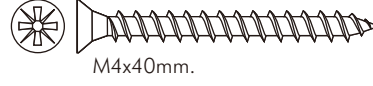

x 36

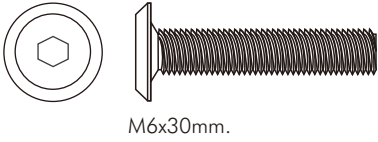

x 11

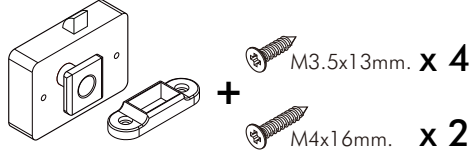

x 1 Set

-DOOR SET

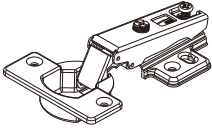

Full overlay

x 10

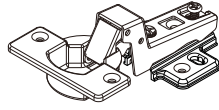

Half overlay

x 10



x 120



x 8

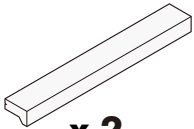

x 2

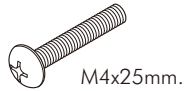

x 4

-LAMP SET

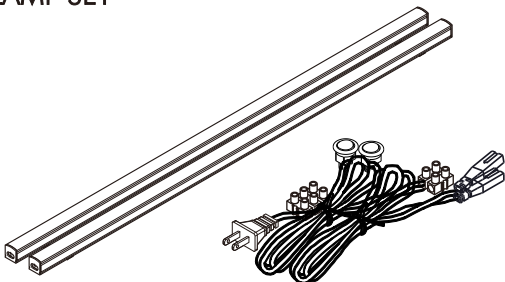

x 1 Set



x 10

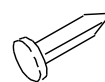

x 10

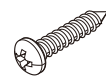

x 3

ASSEMBLY

Horizontal assembly

-BODY SET

1.

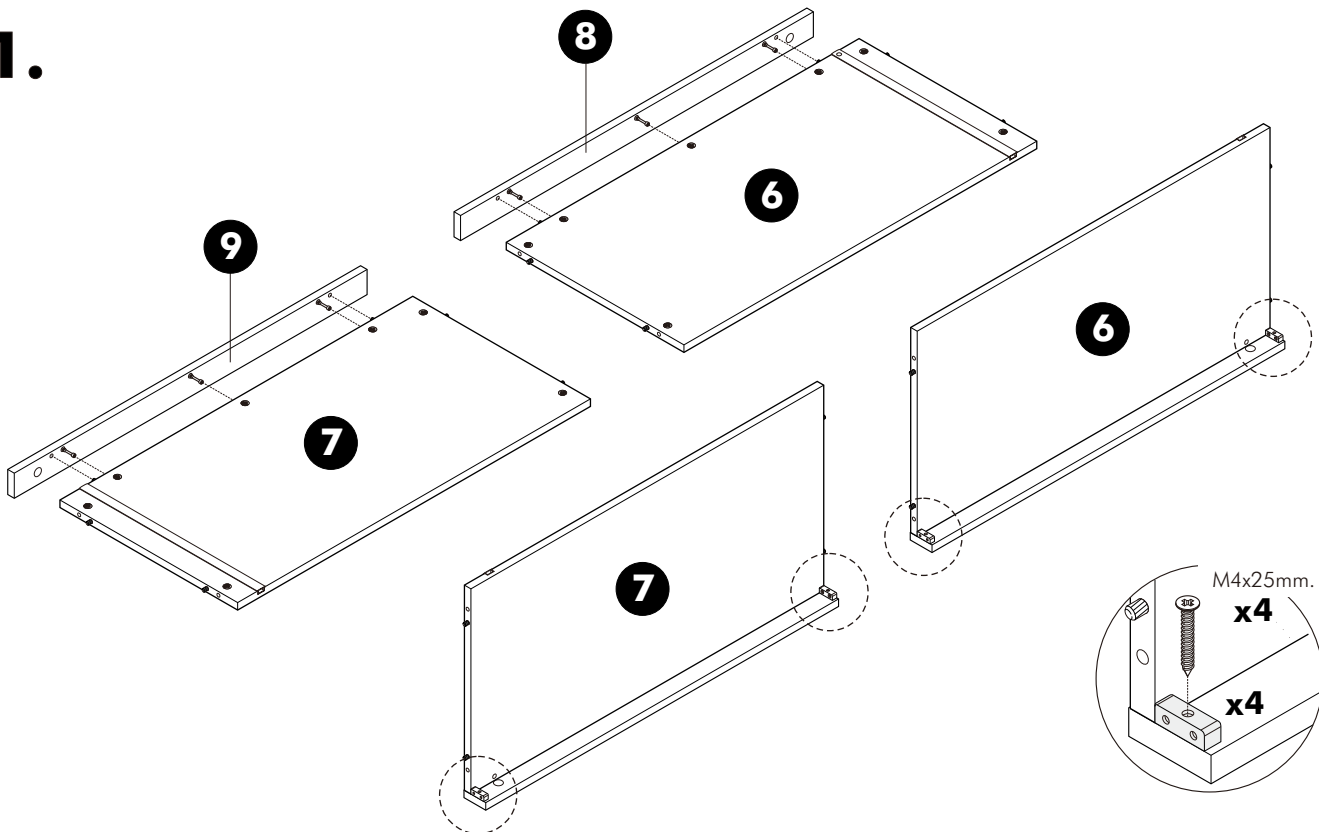

2.

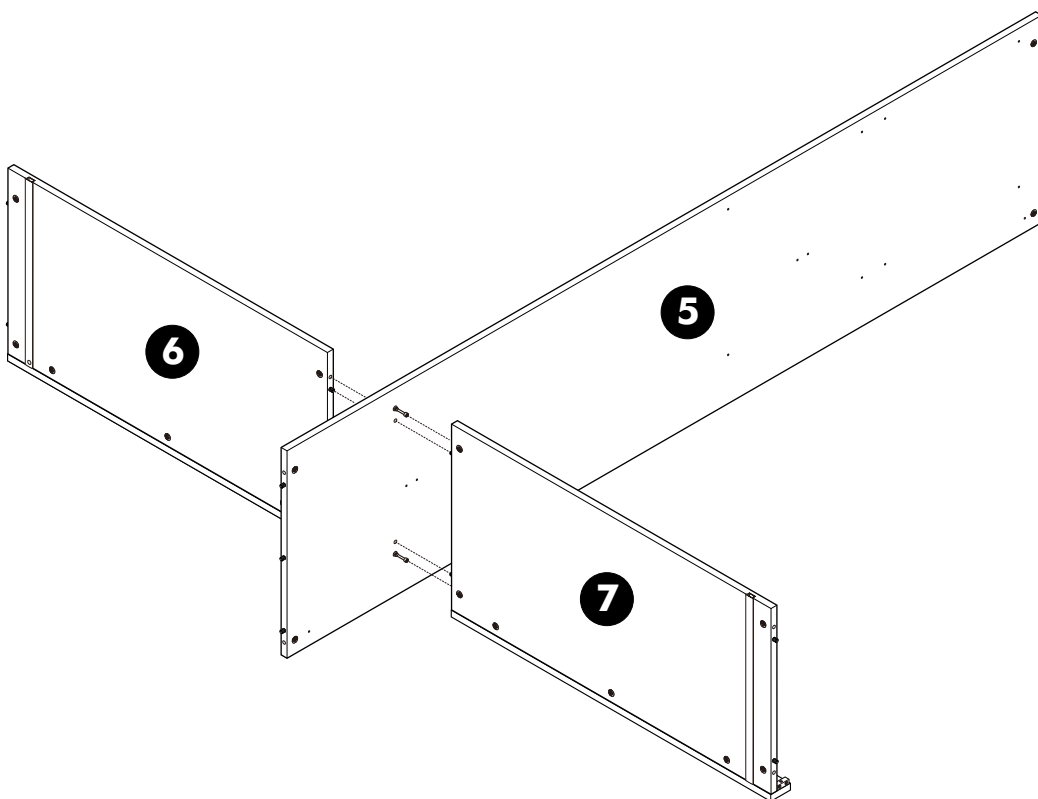

3.

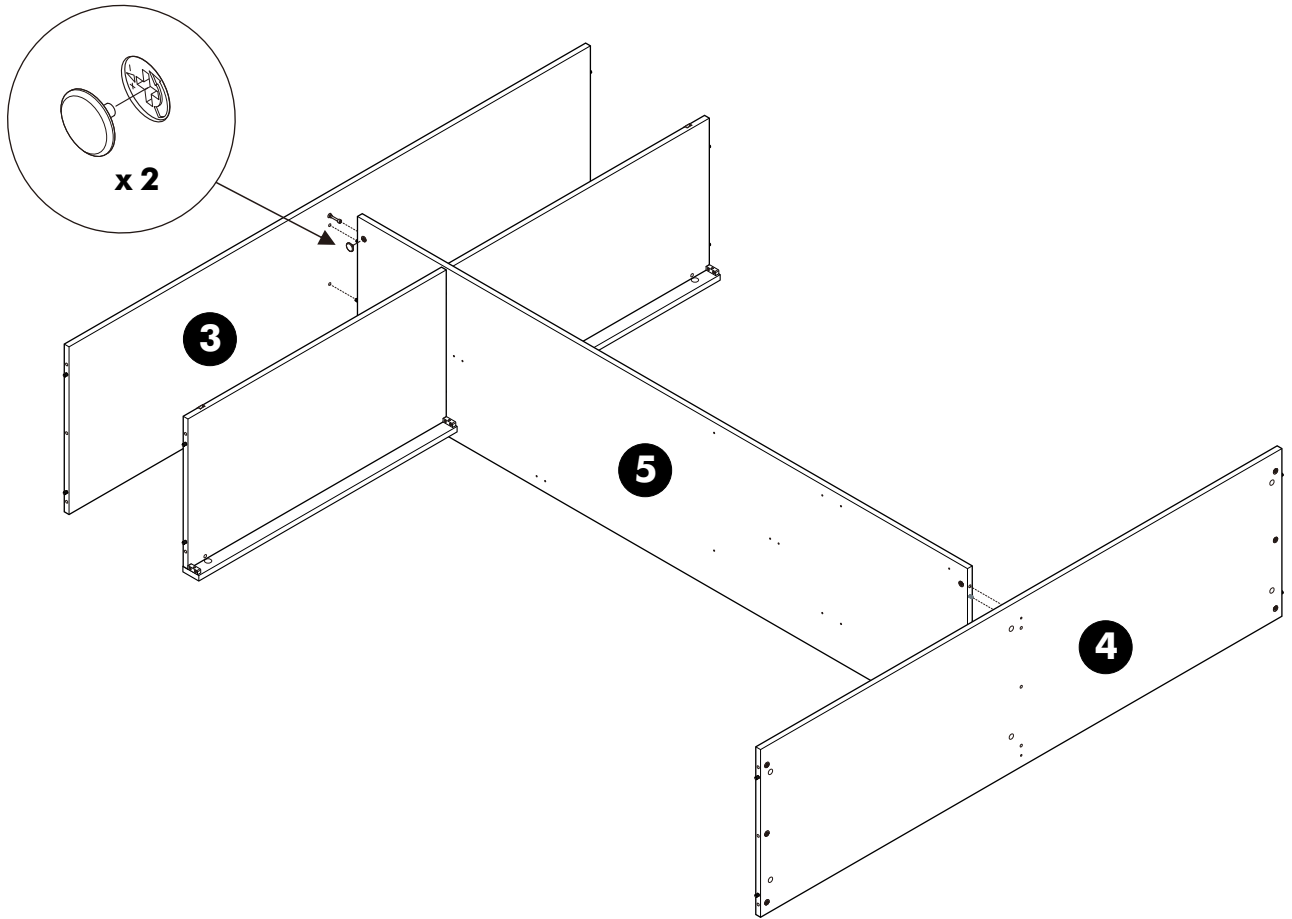

4.

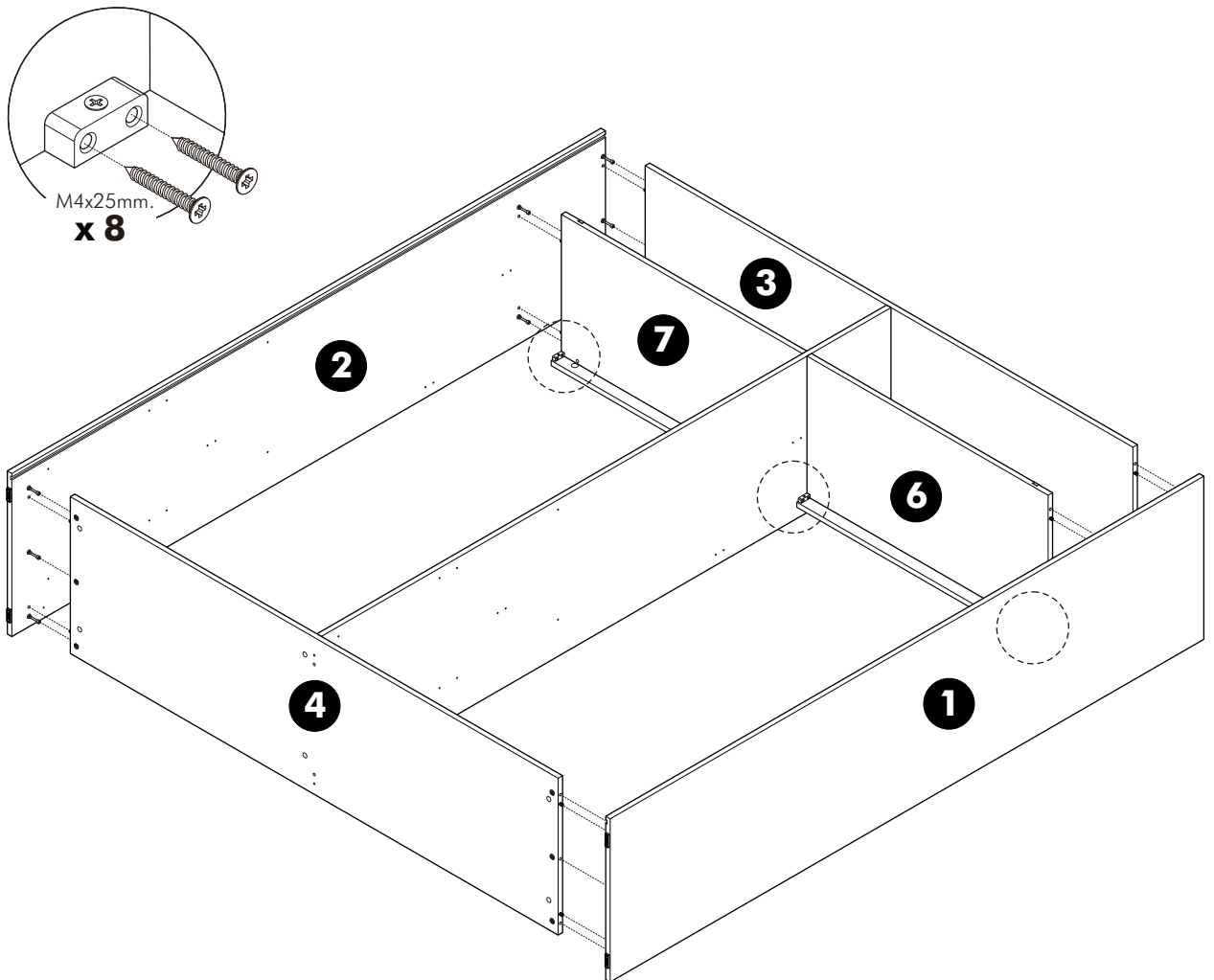

5.

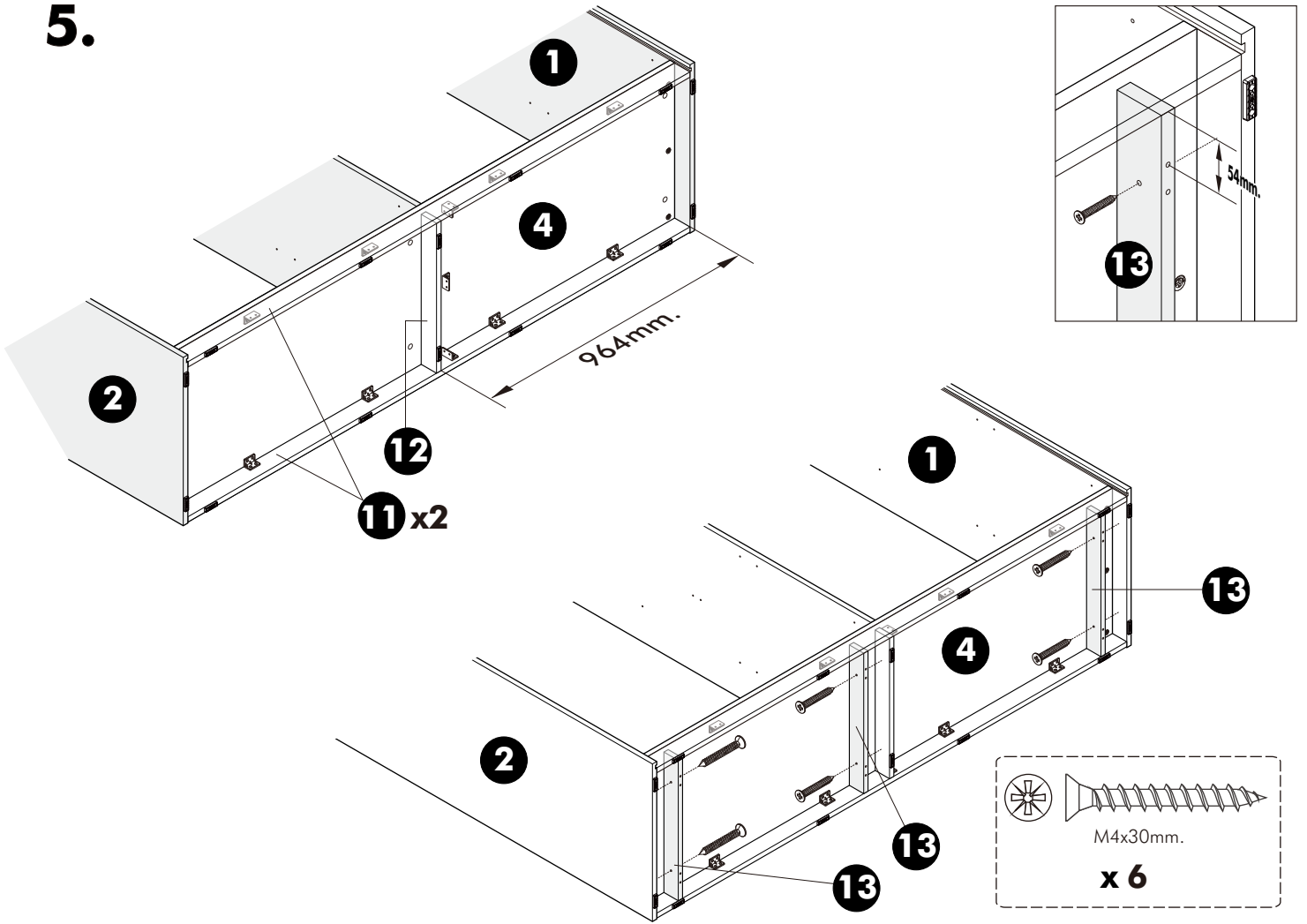

6.

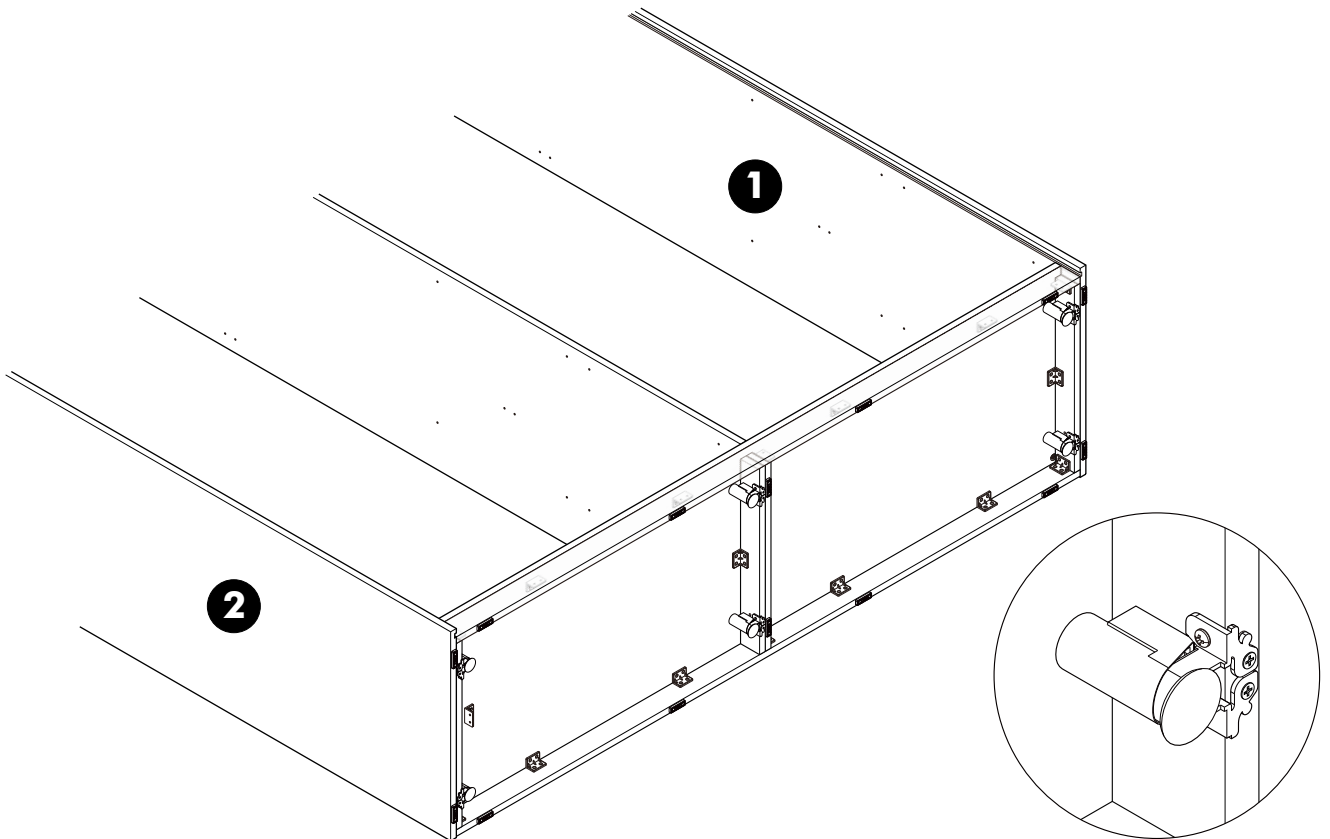

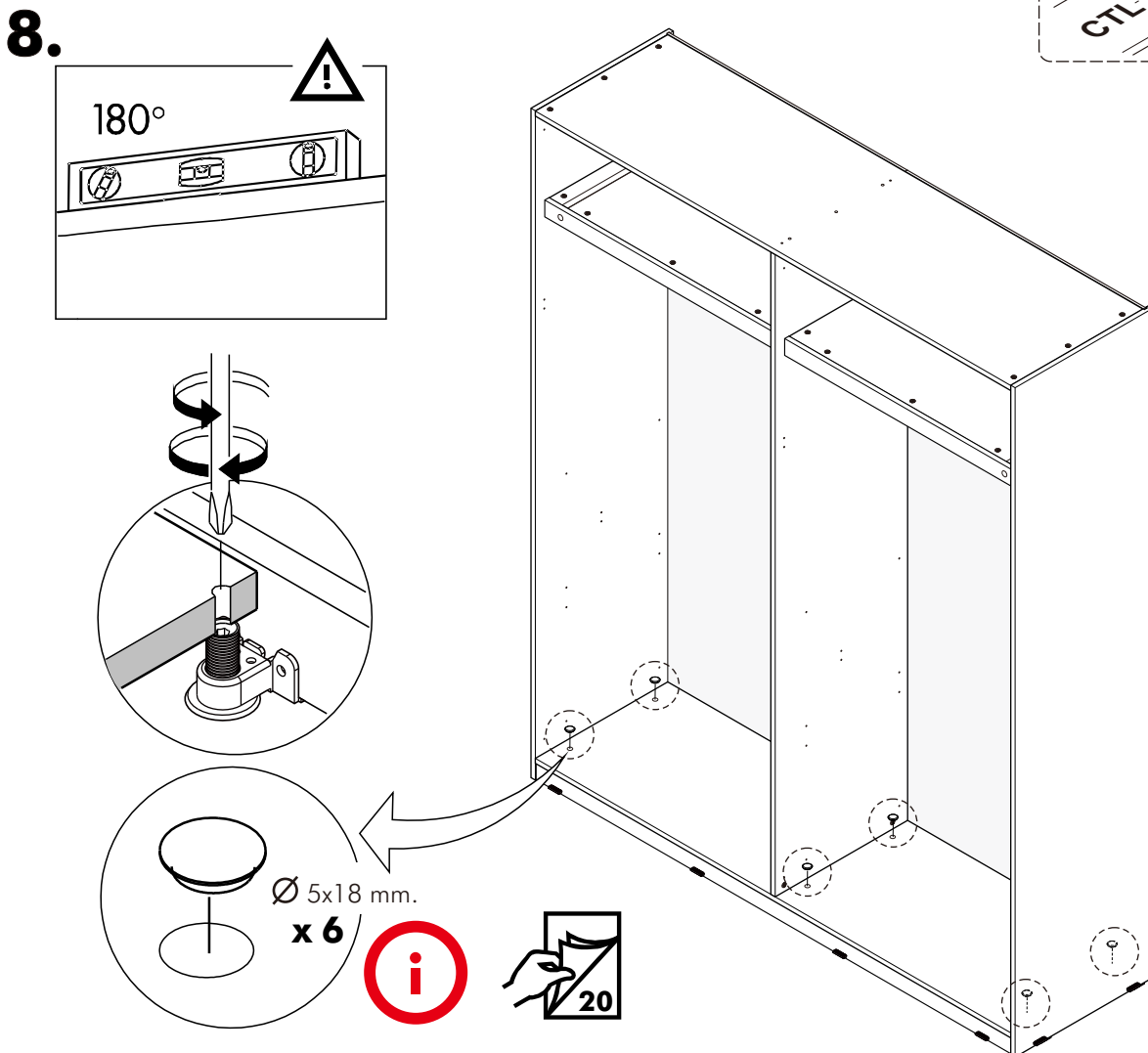
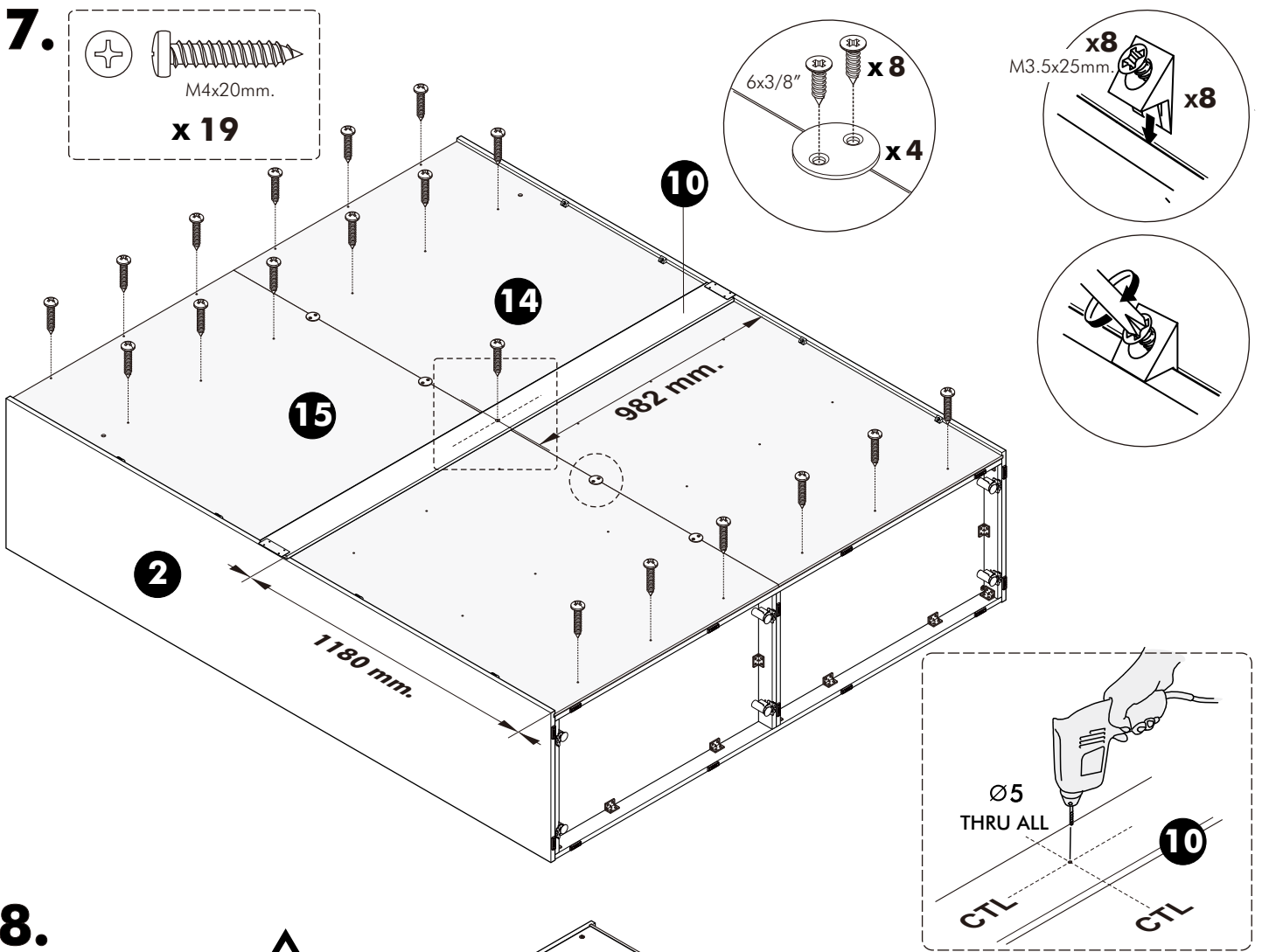

9.

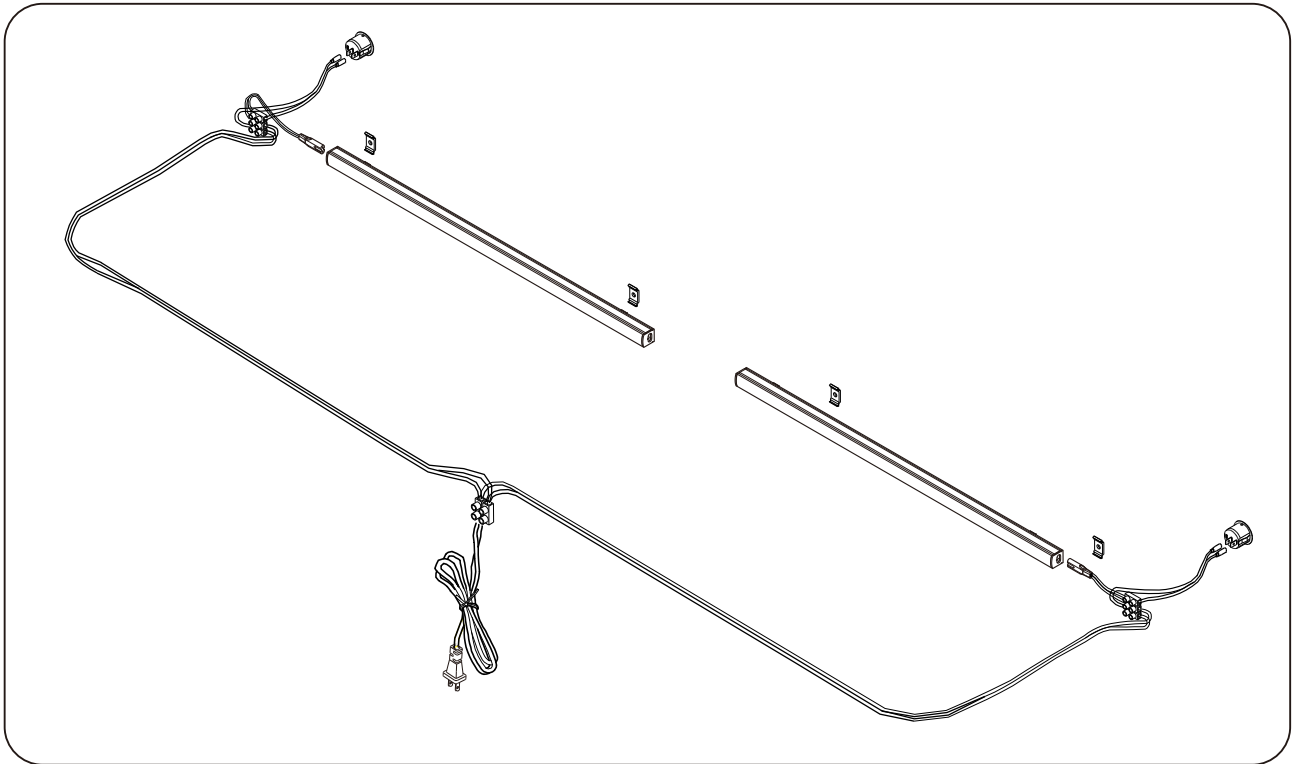

10.

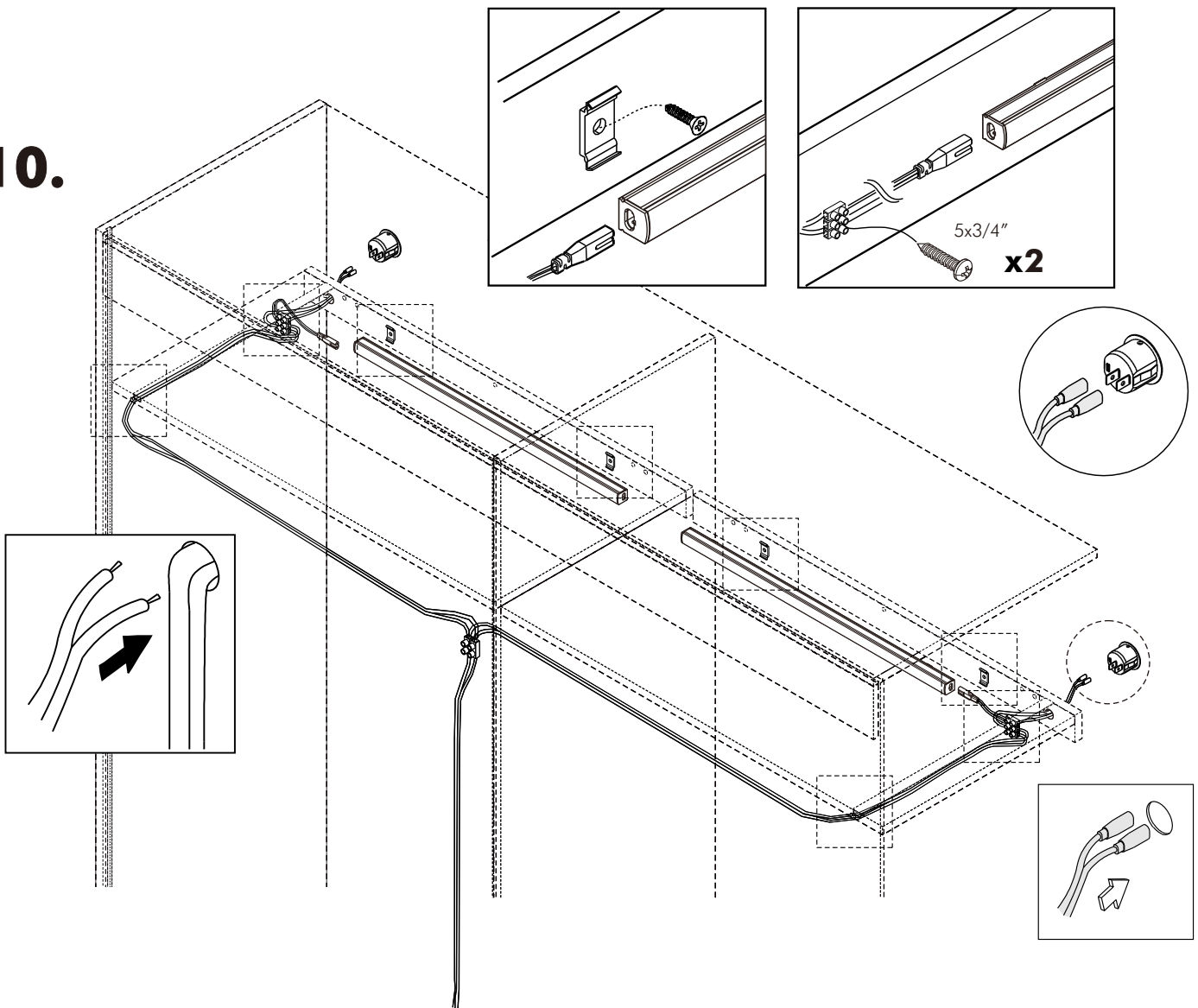

11.

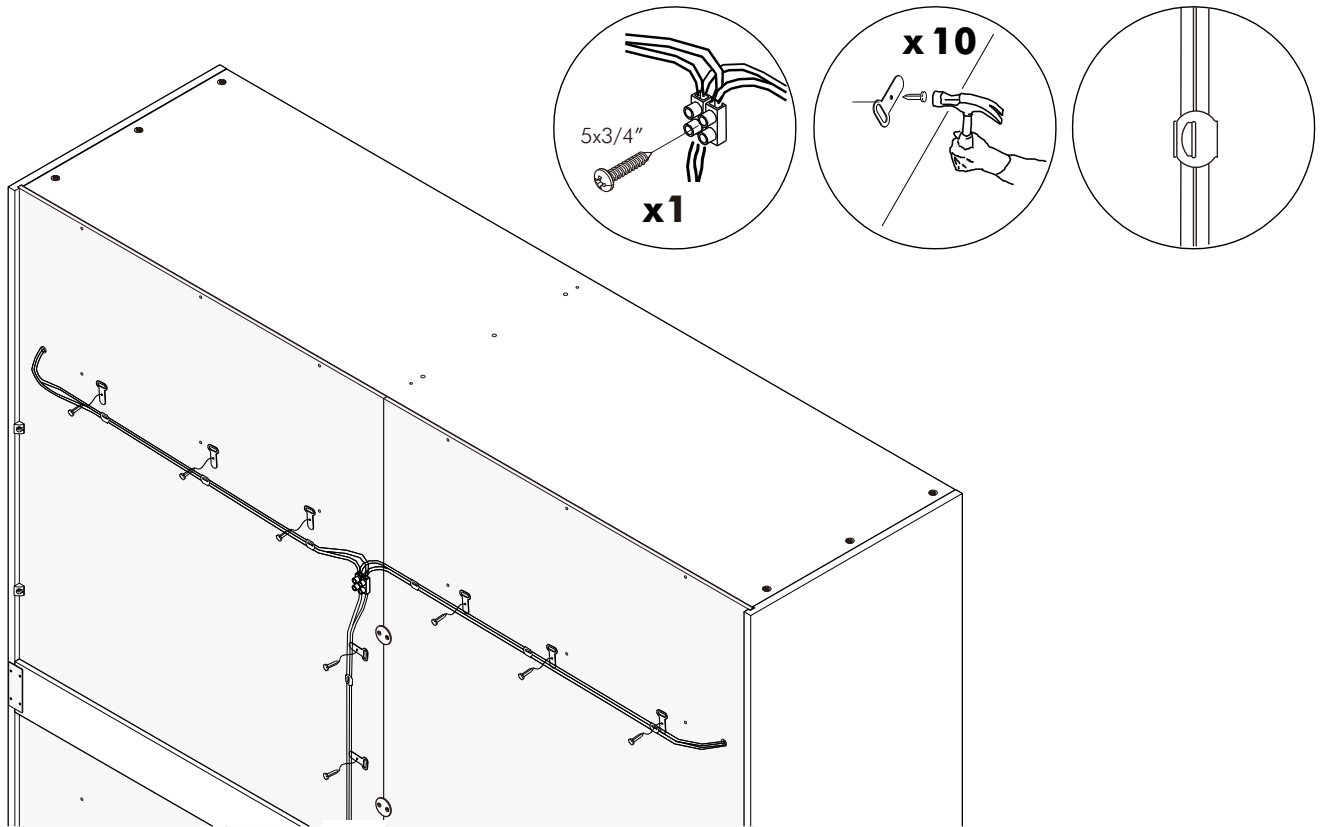

12.

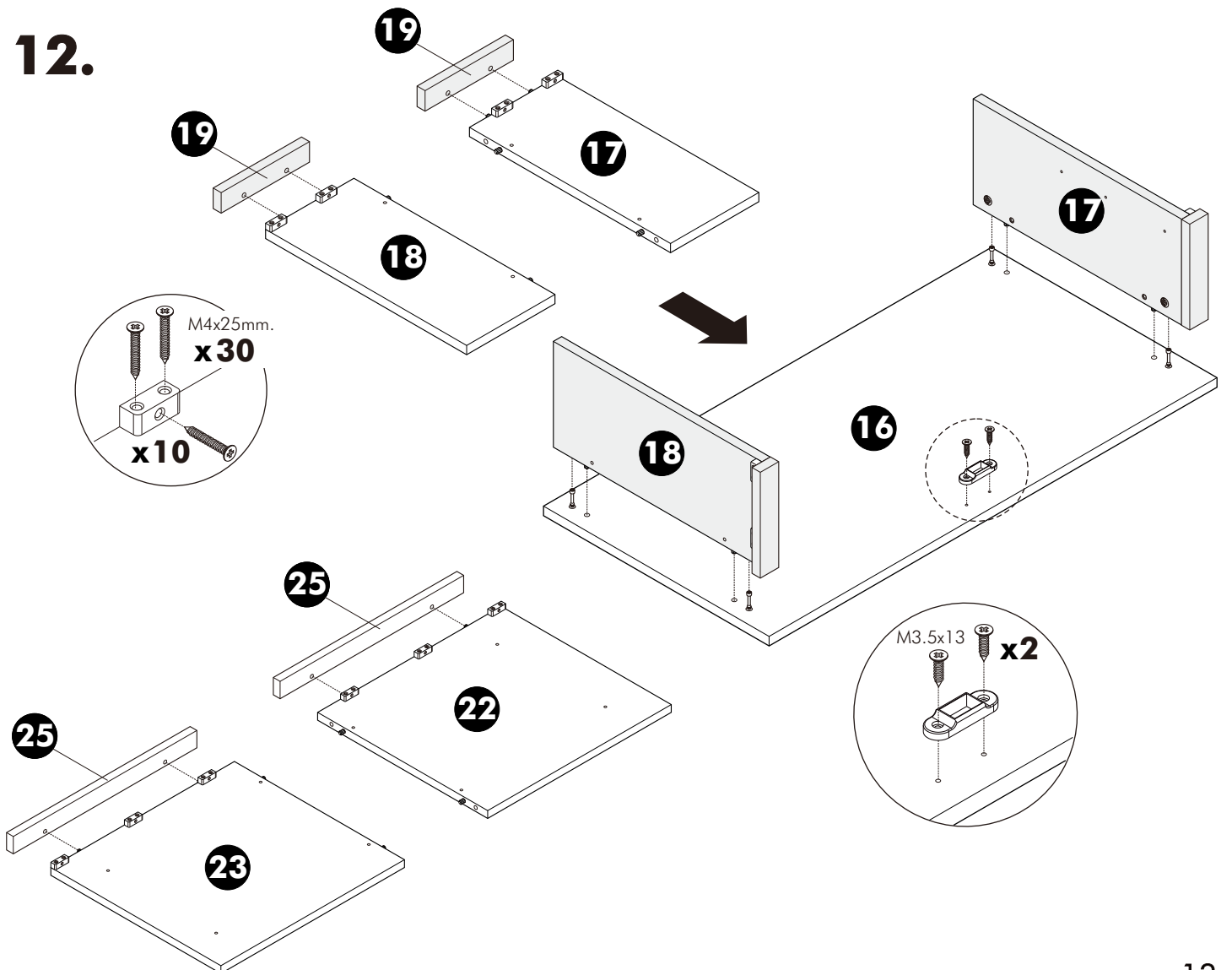

13.

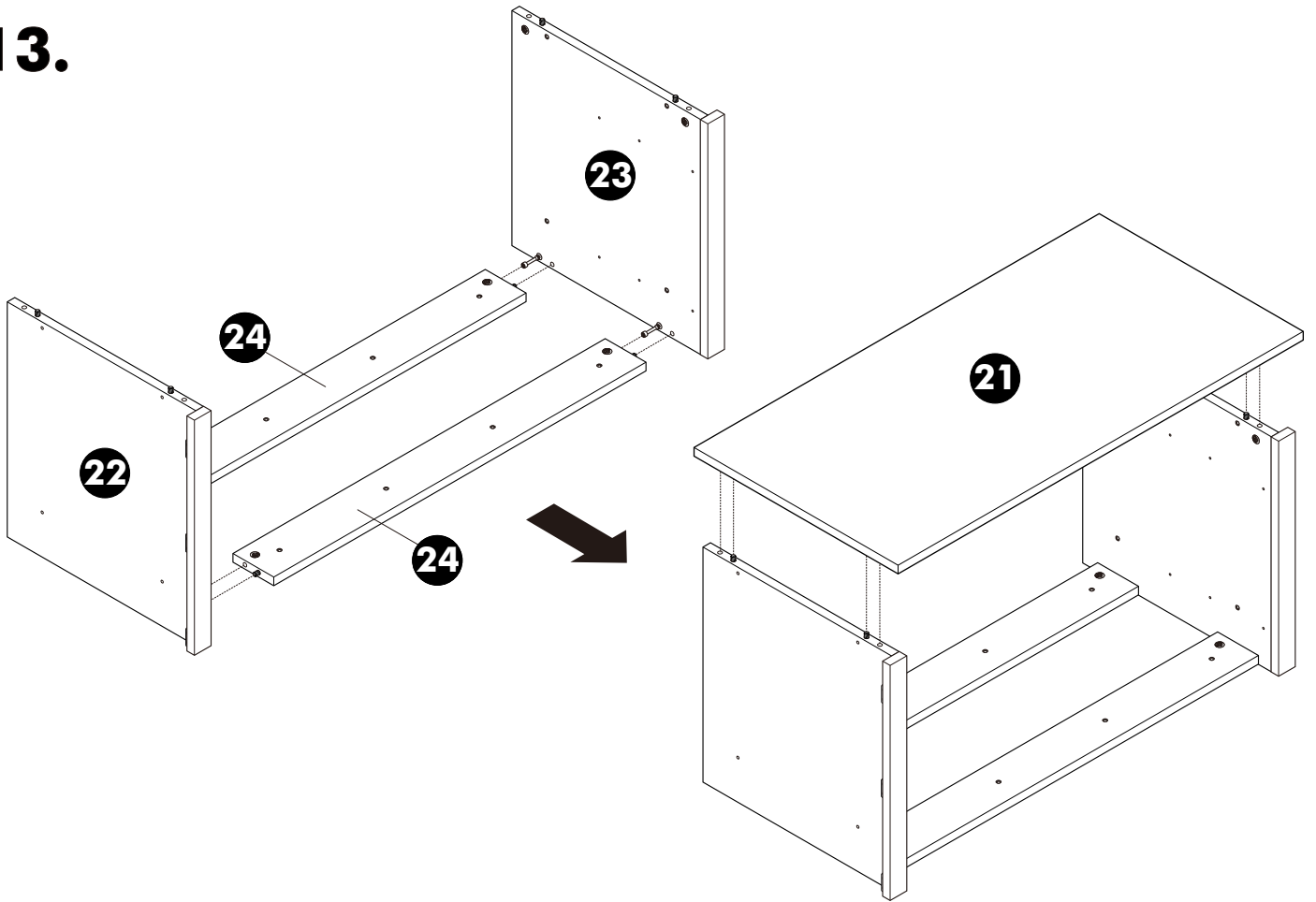

14.

i TYPE- A1

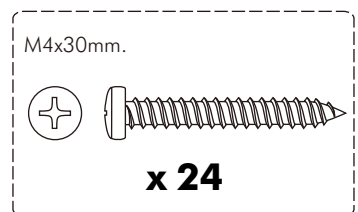
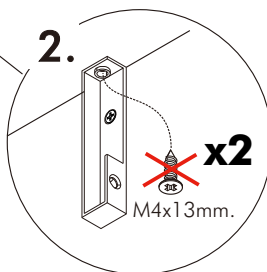
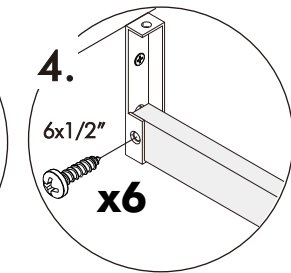
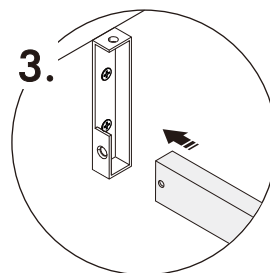
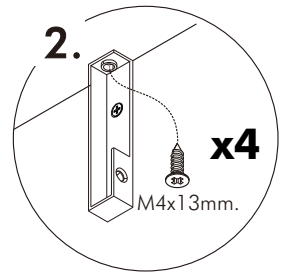
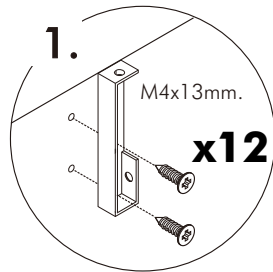
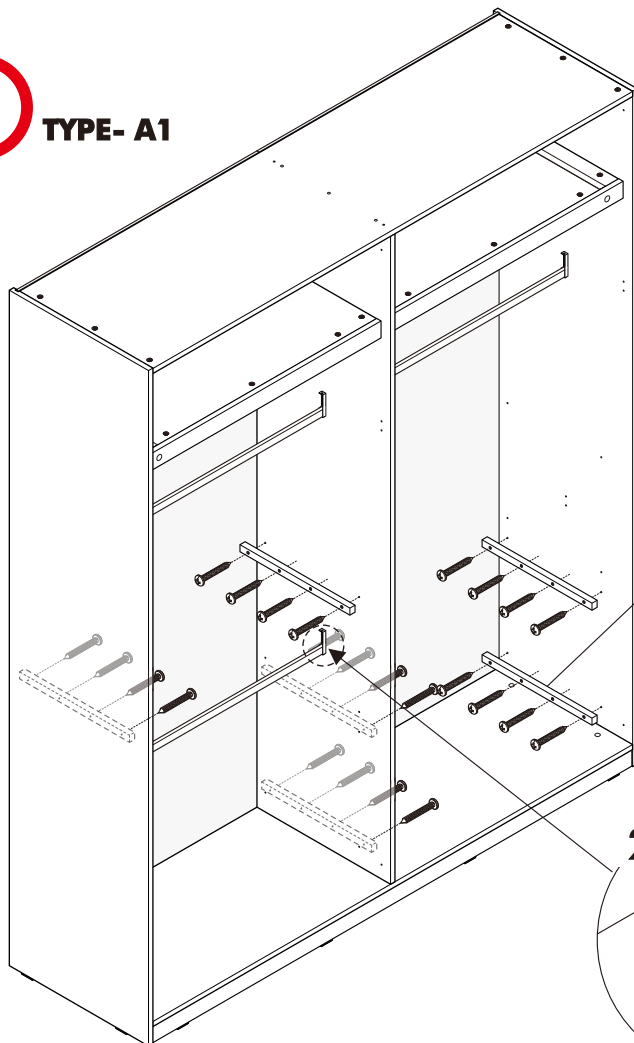

15.  **TYPE- A1**

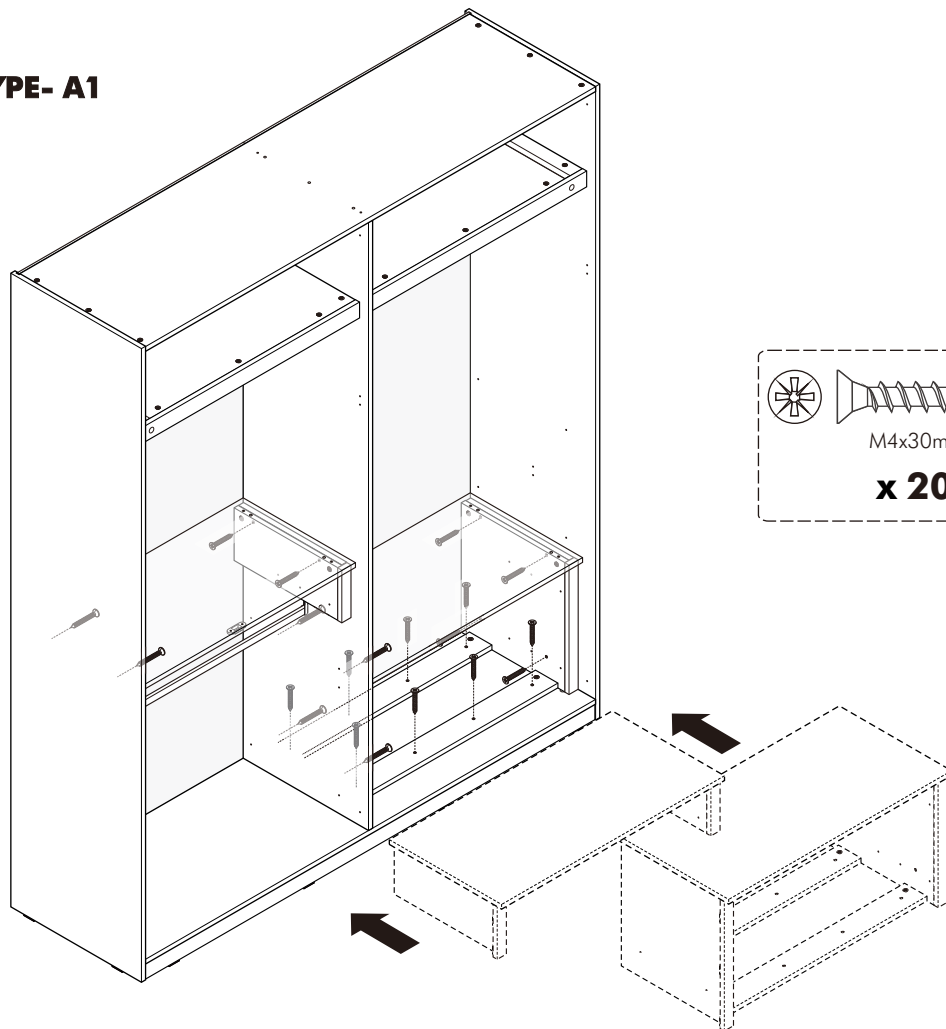

16.  **TYPE- A1**

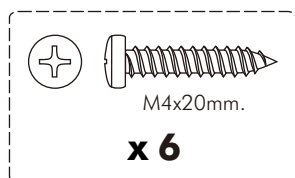
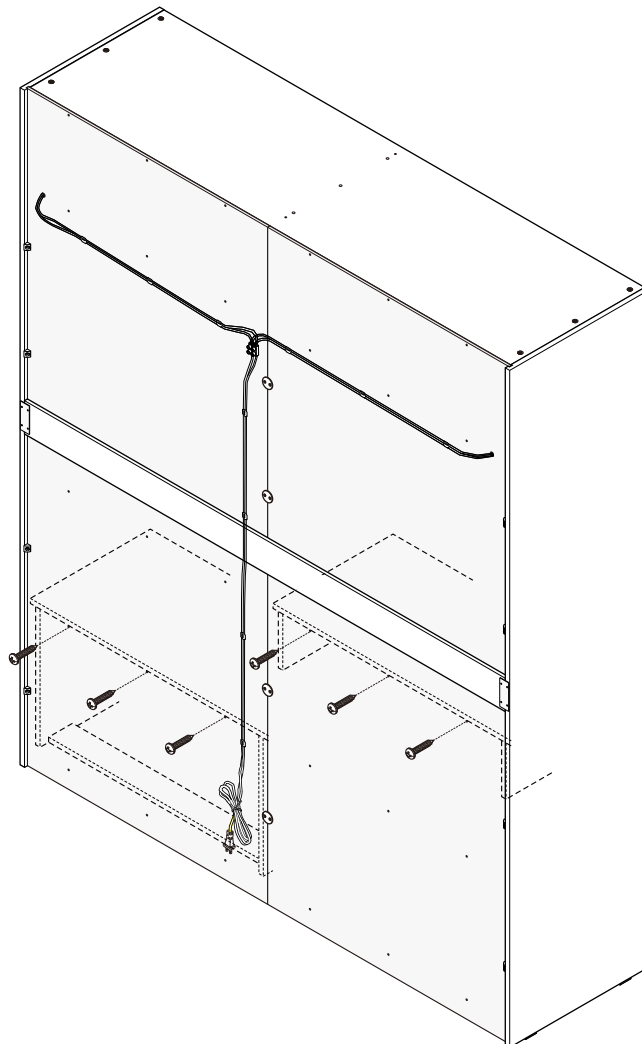

17.

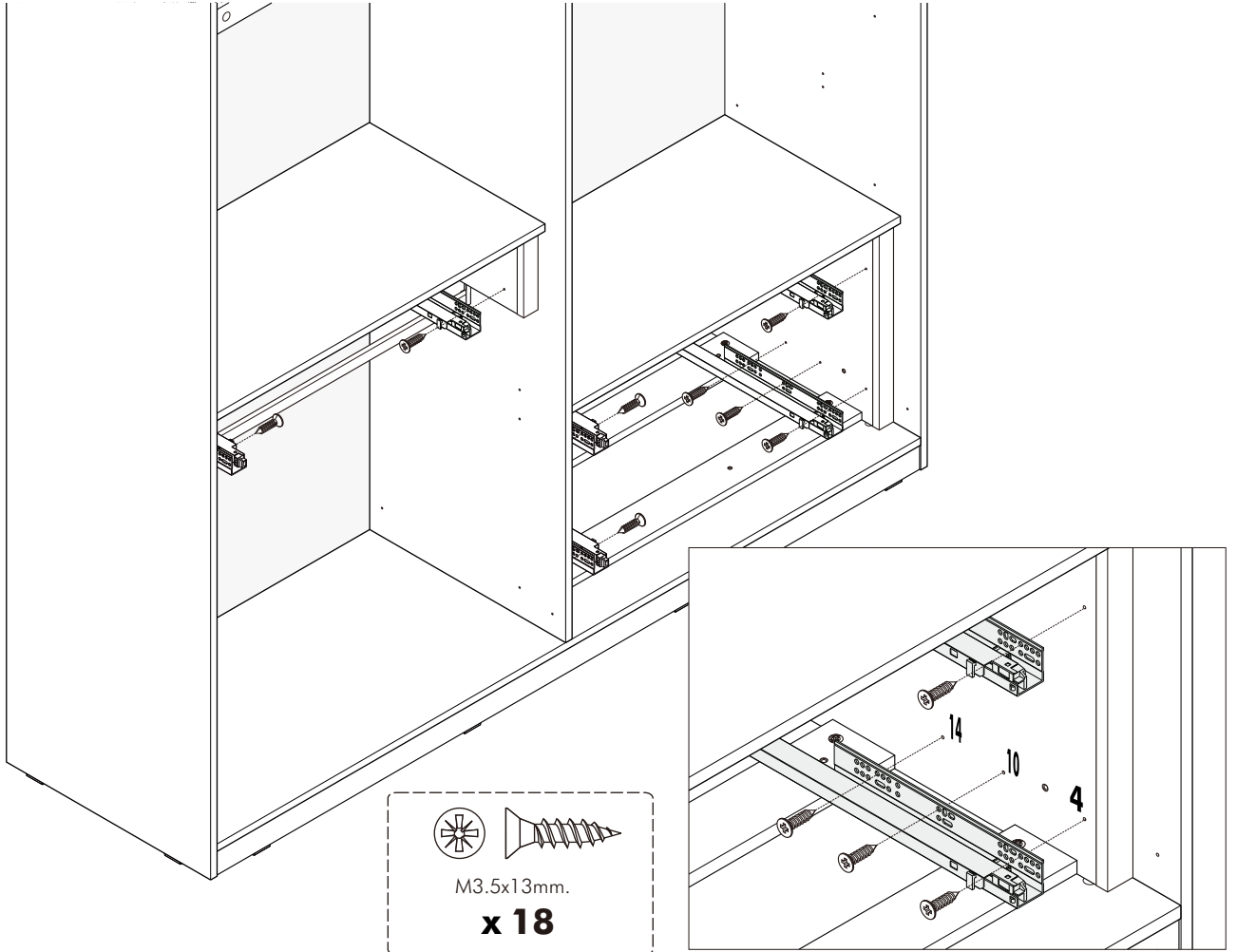

M3.5x13mm.
x 18

ASSEMBLY

-DRAWER SET

1.

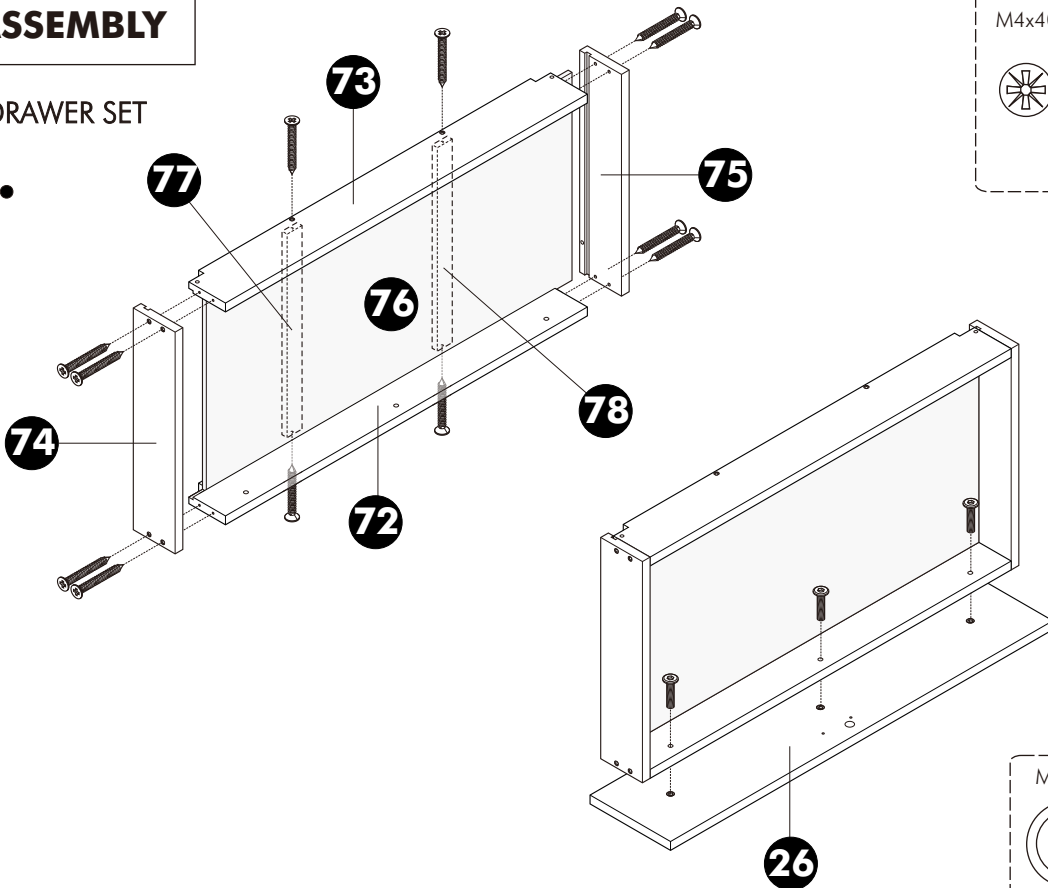

M4x40mm.
x 12

M6x30mm.
x 3

4.

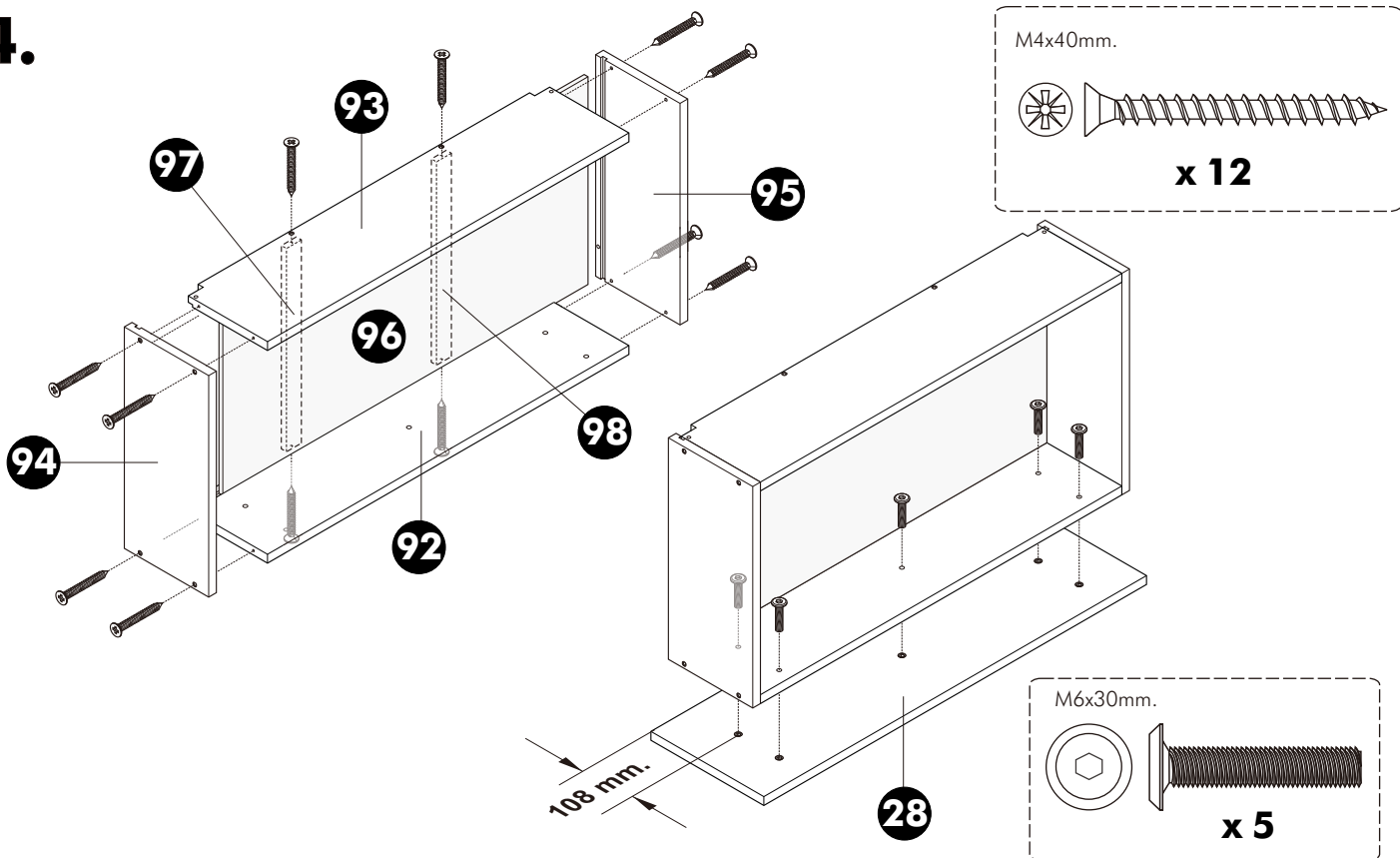

5.



TYPE- A1

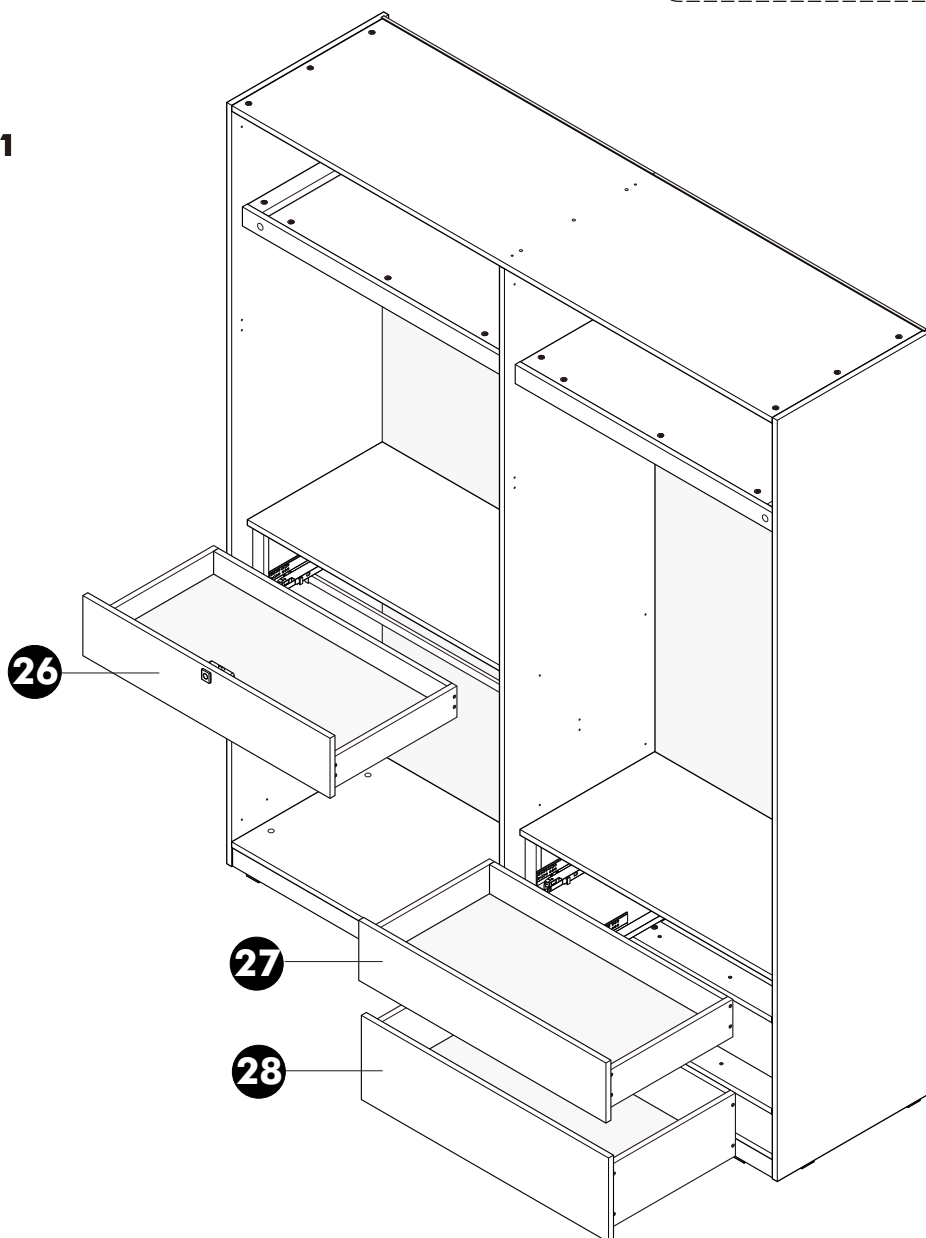
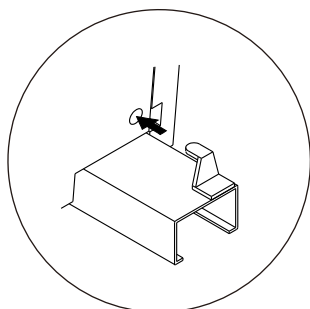
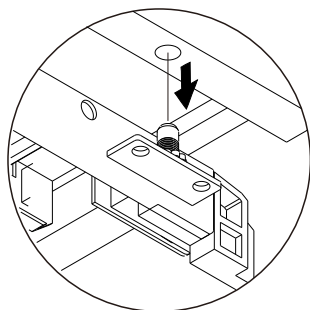
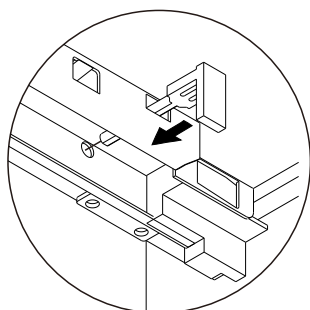

ASSEMBLY

-DOOR SET

1.

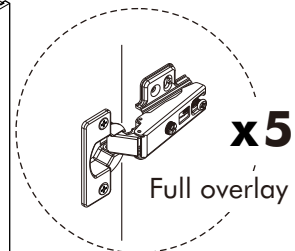
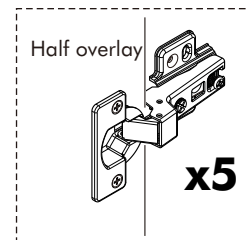
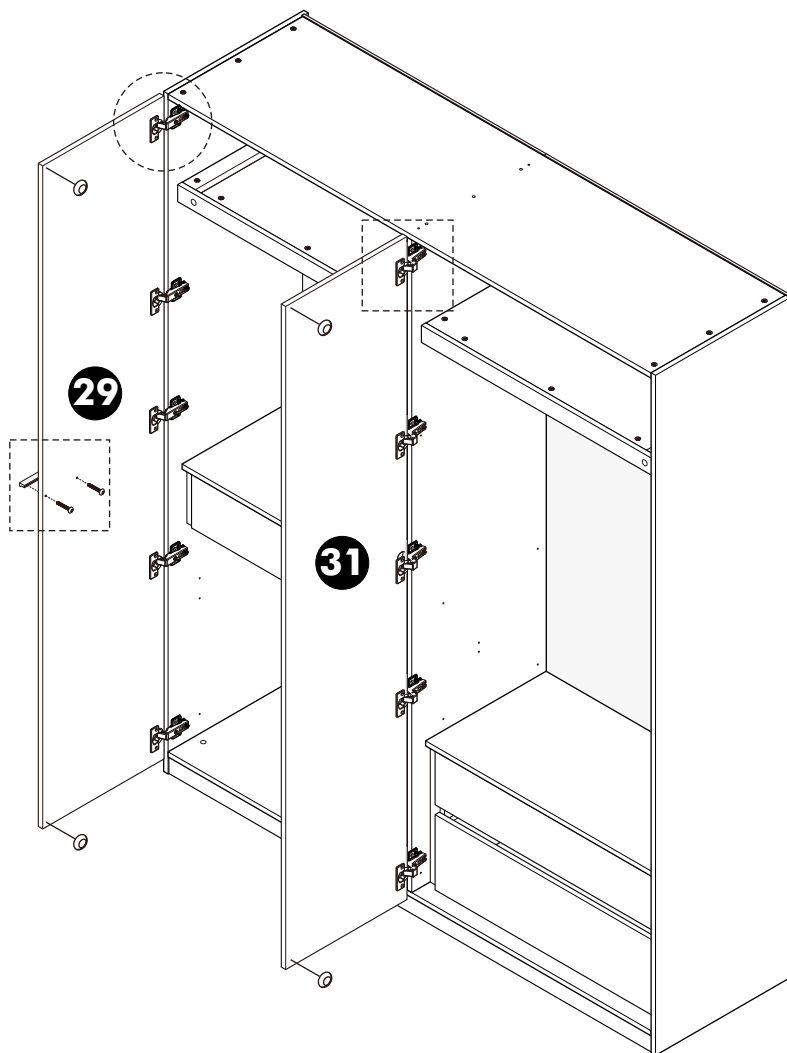
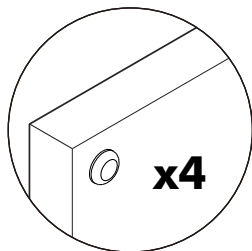
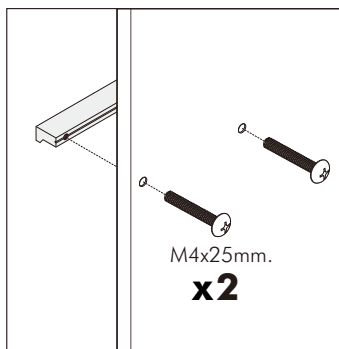

2.

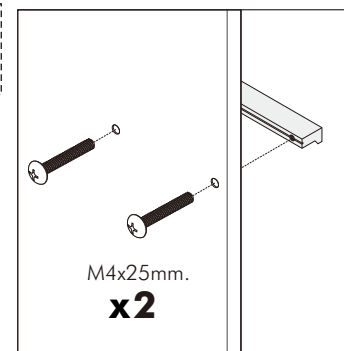
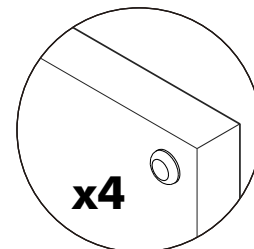
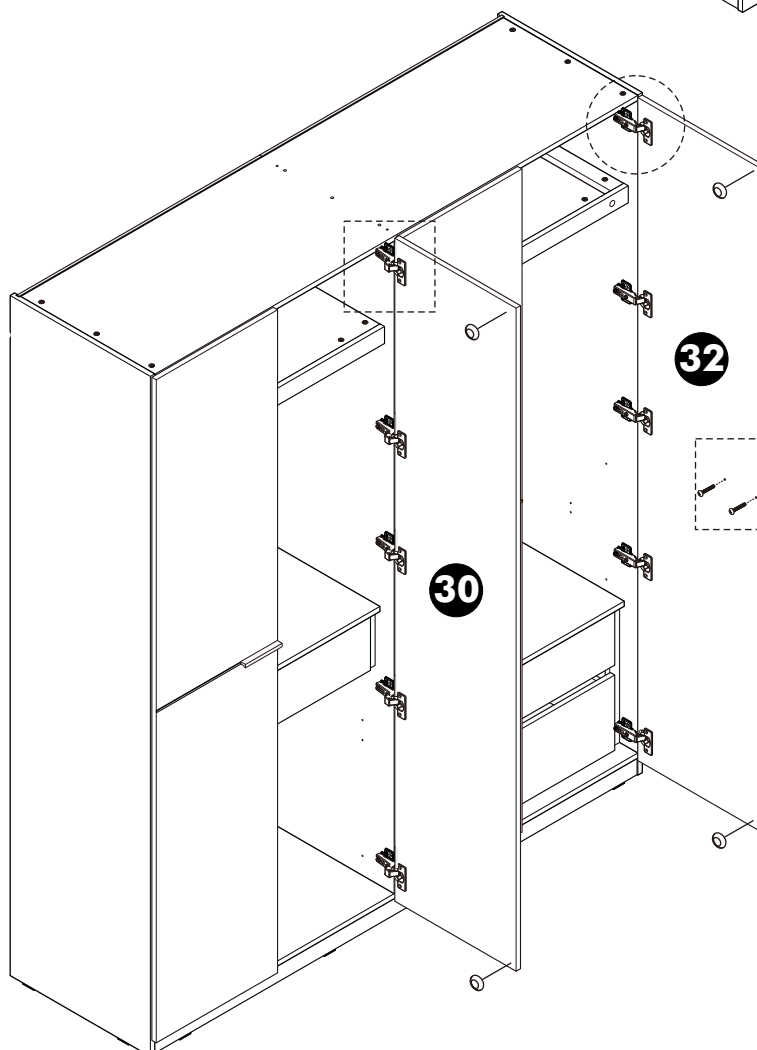
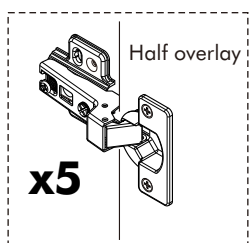
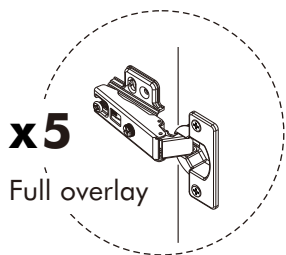



TYPE- A1

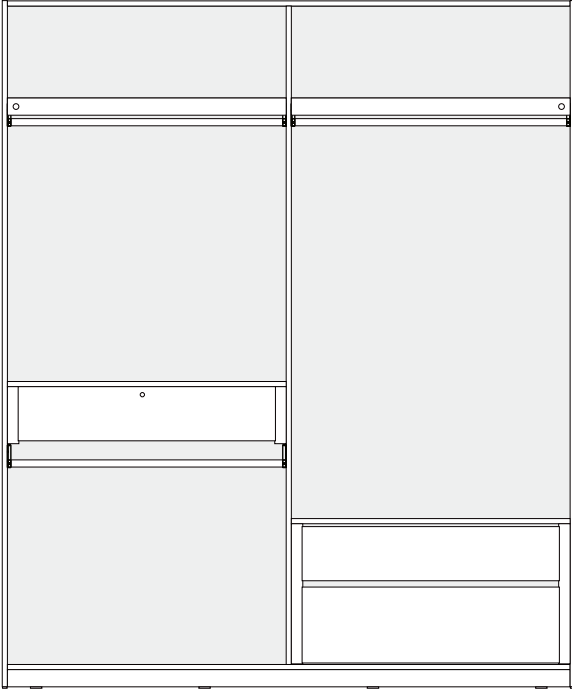

x 2

TYPE- A2

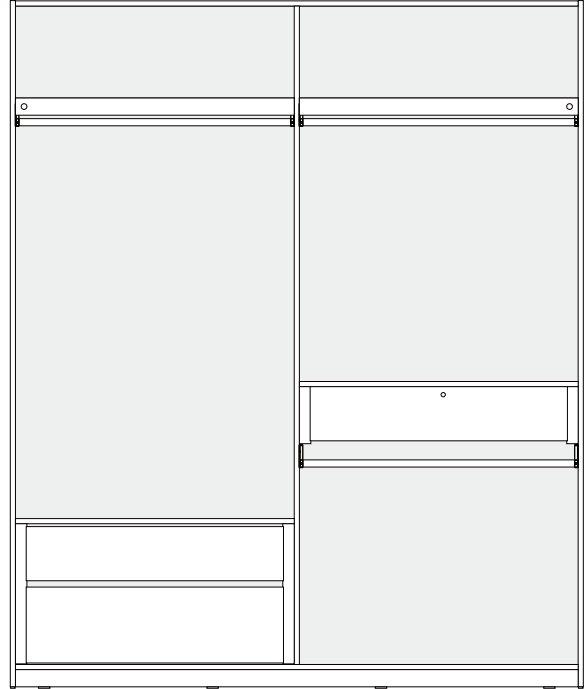

x 4

TYPE- B1

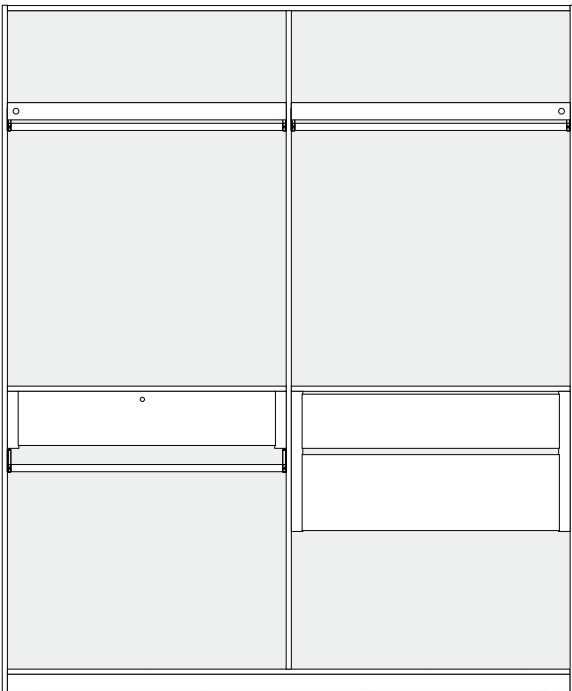

x 6

TYPE- B2

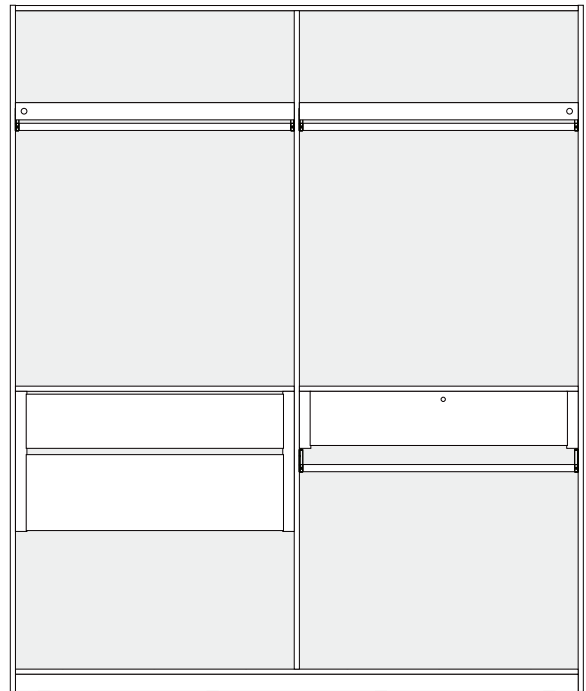

x 6



TYPE- B1
TYPE- B2

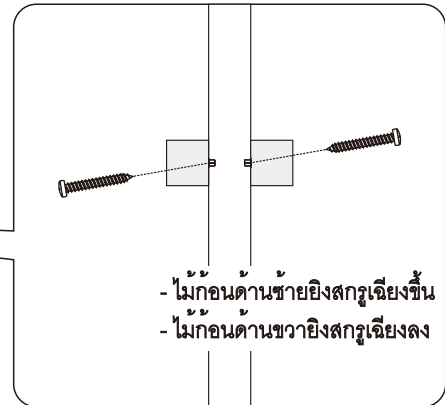
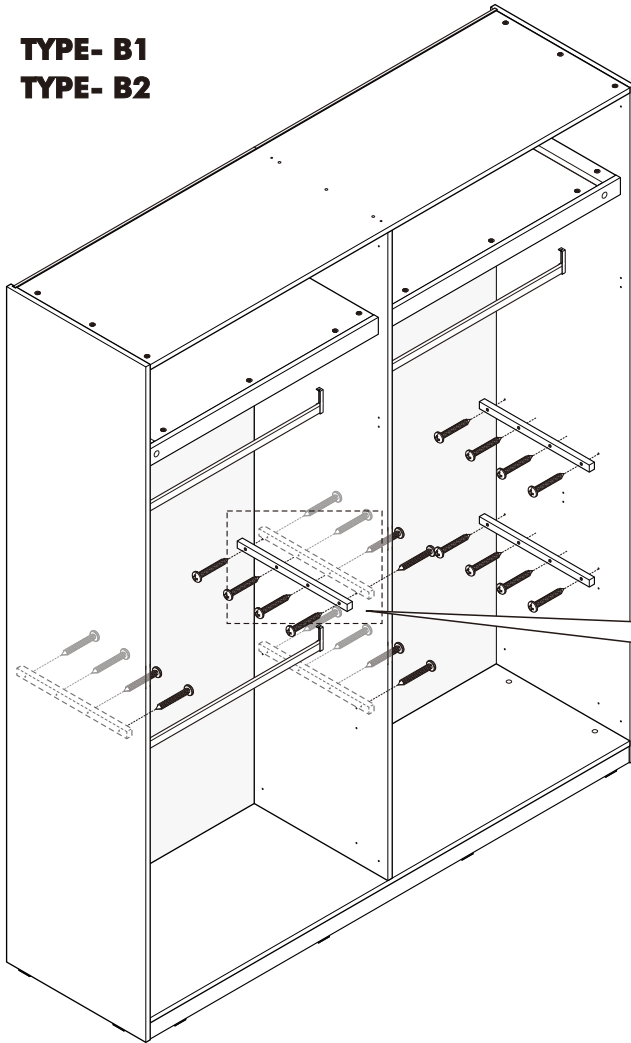

MANUAL : FINGERPRINT LOCK

ใช้แบตเตอรี่ AAA จำนวน 3 ก้อน (จำหน่ายแยกต่างหาก)



โหมดลงทะเบียนลายนิ้วมือ



ขั้นตอนที่ 1



ขั้นตอนที่ 2



ขั้นตอนที่ 3



ขั้นตอนที่ 4

โหมดลบข้อมูล / รีเซ็ตเป็นค่าโรงงาน



ขั้นตอนที่ 1

การเพิ่มลายนิ้วมือ



ขั้นตอนที่ 1



ขั้นตอนที่ 2



ขั้นตอนที่ 3

กรณีแบตเตอรี่หมด ไม่สามารถปลดล็อกอุปกรณ์ได้

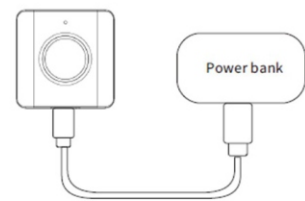

เชื่อมต่ออุปกรณ์เข้ากับสาย USB type C แล้ว จ่ายไฟให้เครื่อง จากนั้นจะสามารถปลดล็อกได้ตามปกติ

ASSEMBLY

Vertical assembly

-BODY SET

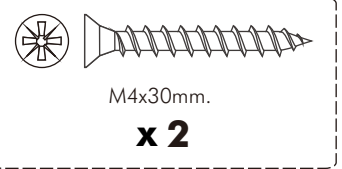

1.

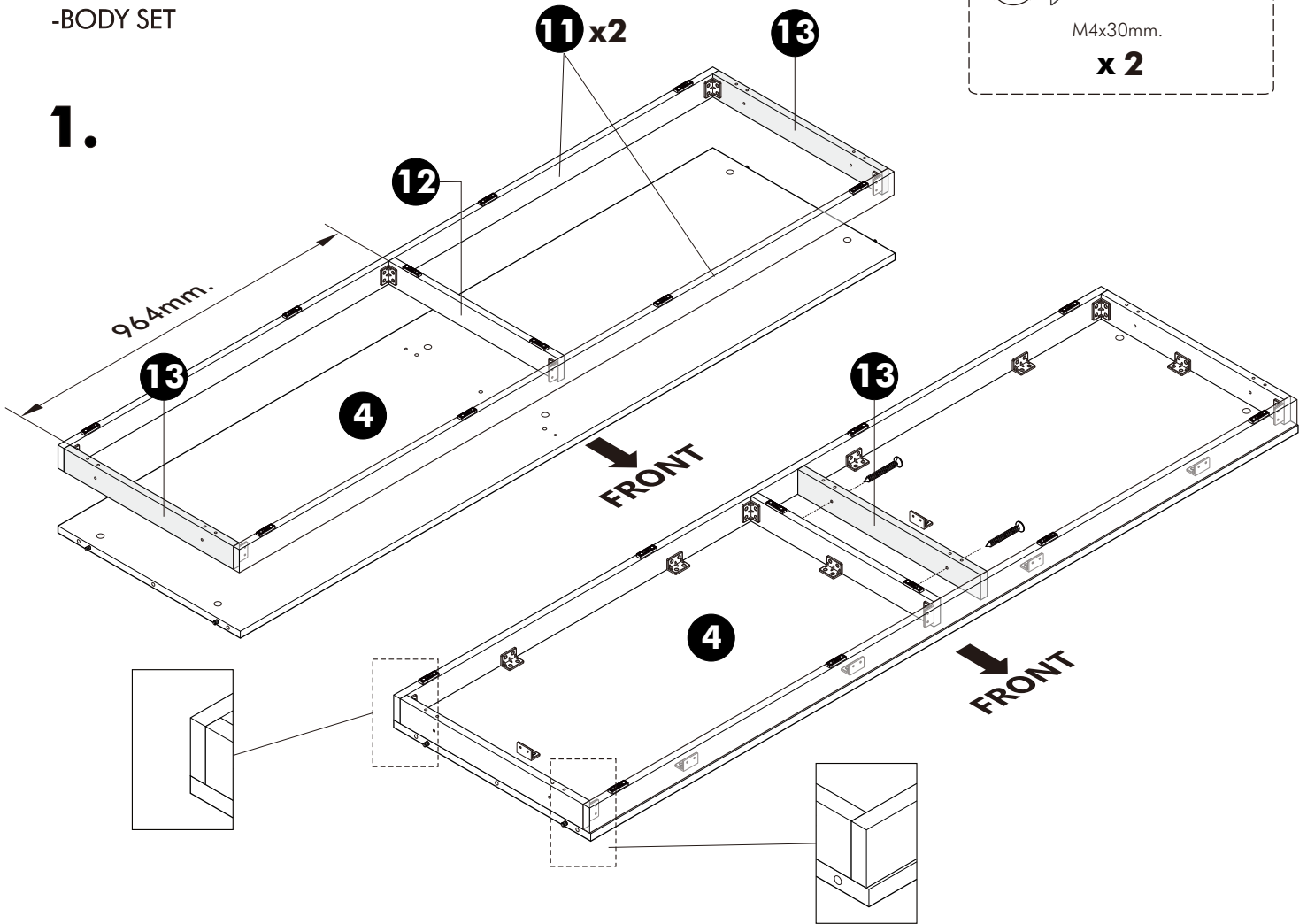

2.

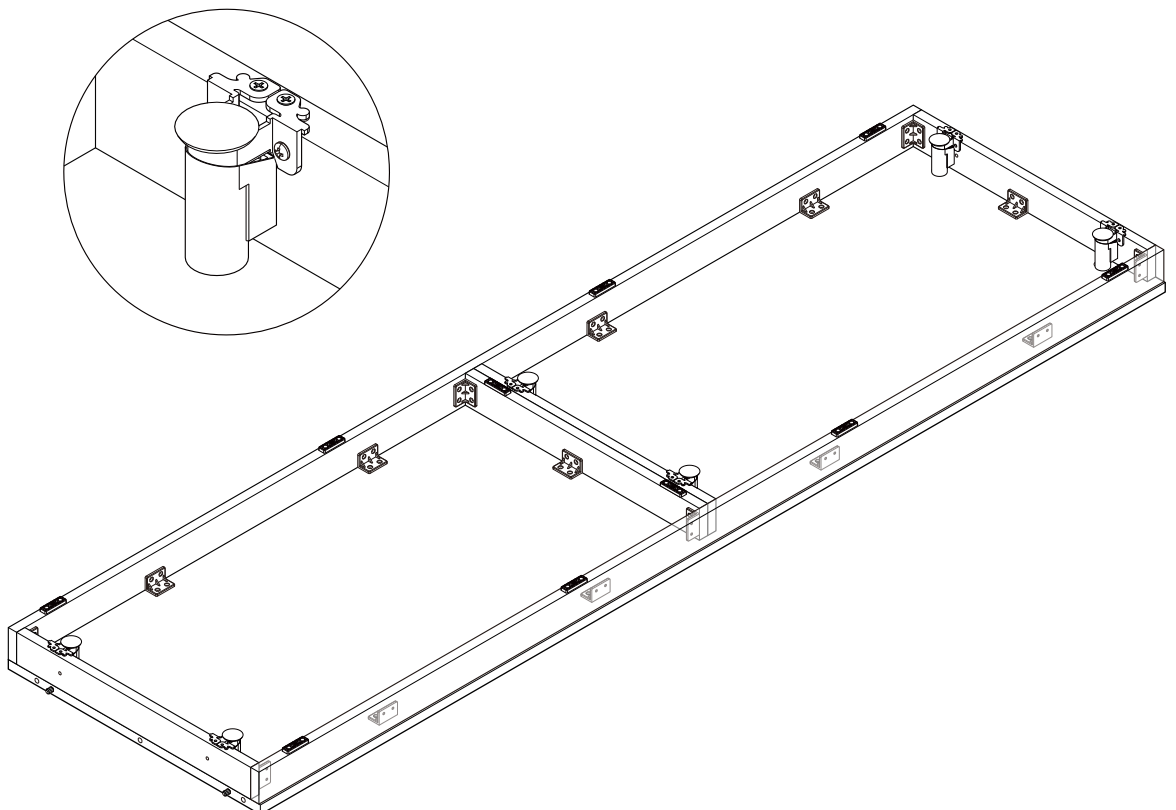

3.

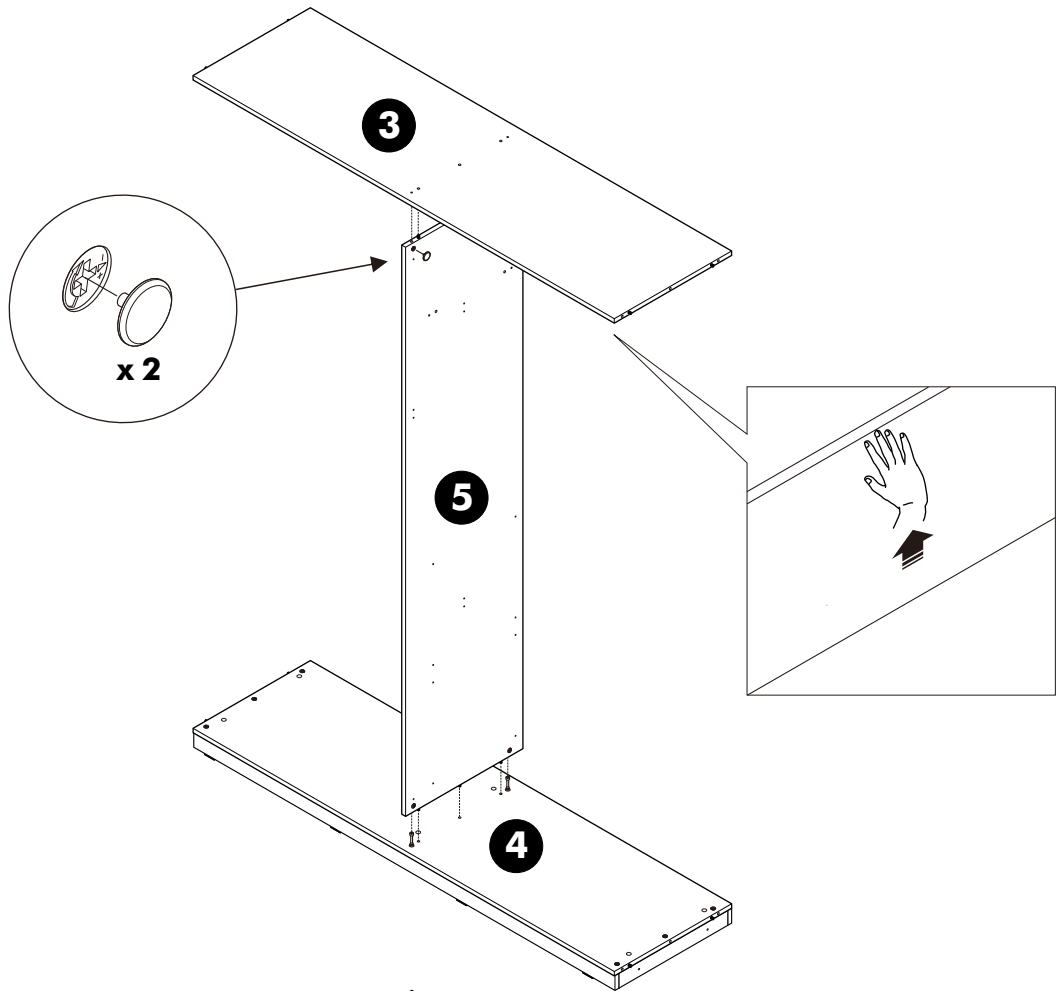

4.

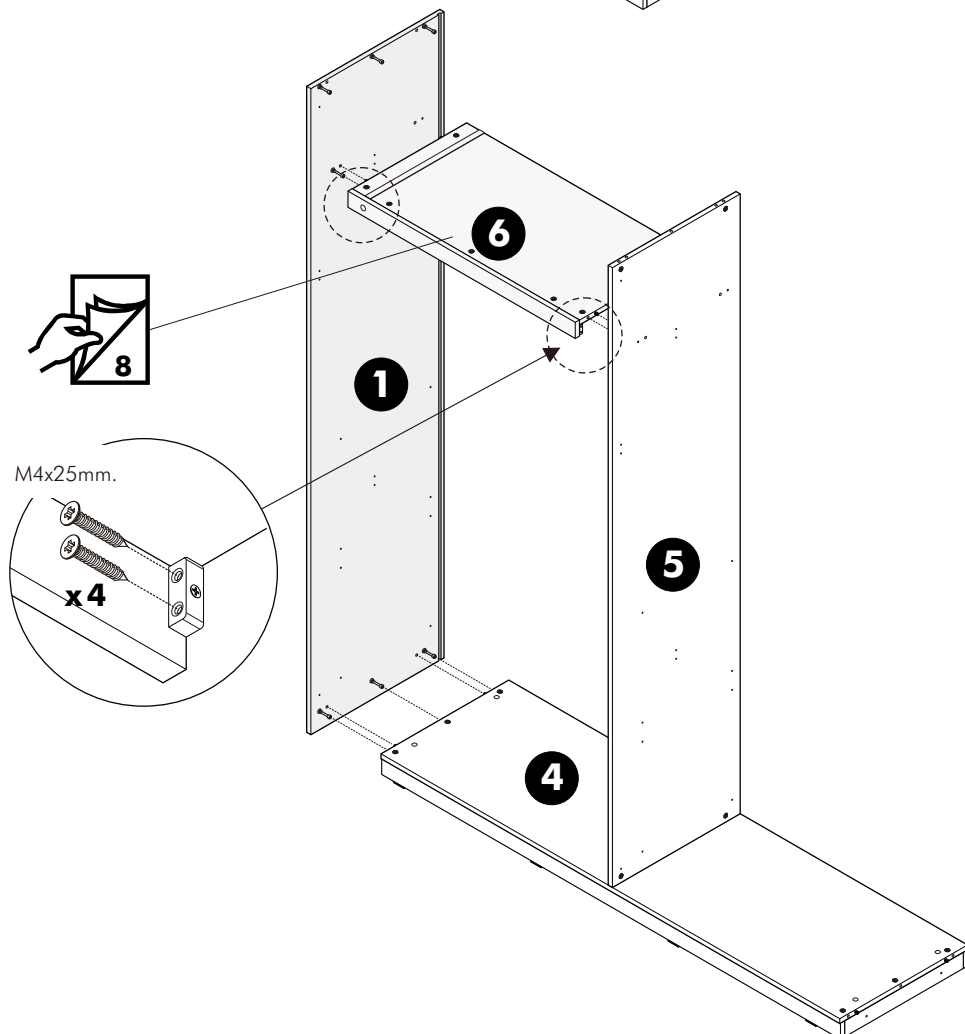

5.

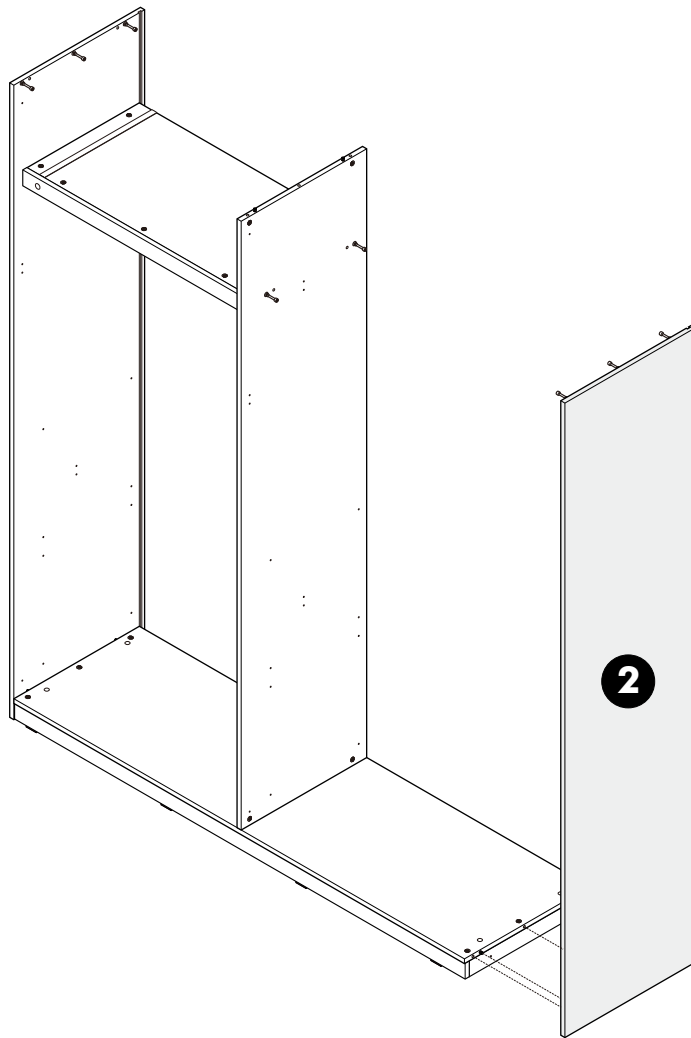

6.

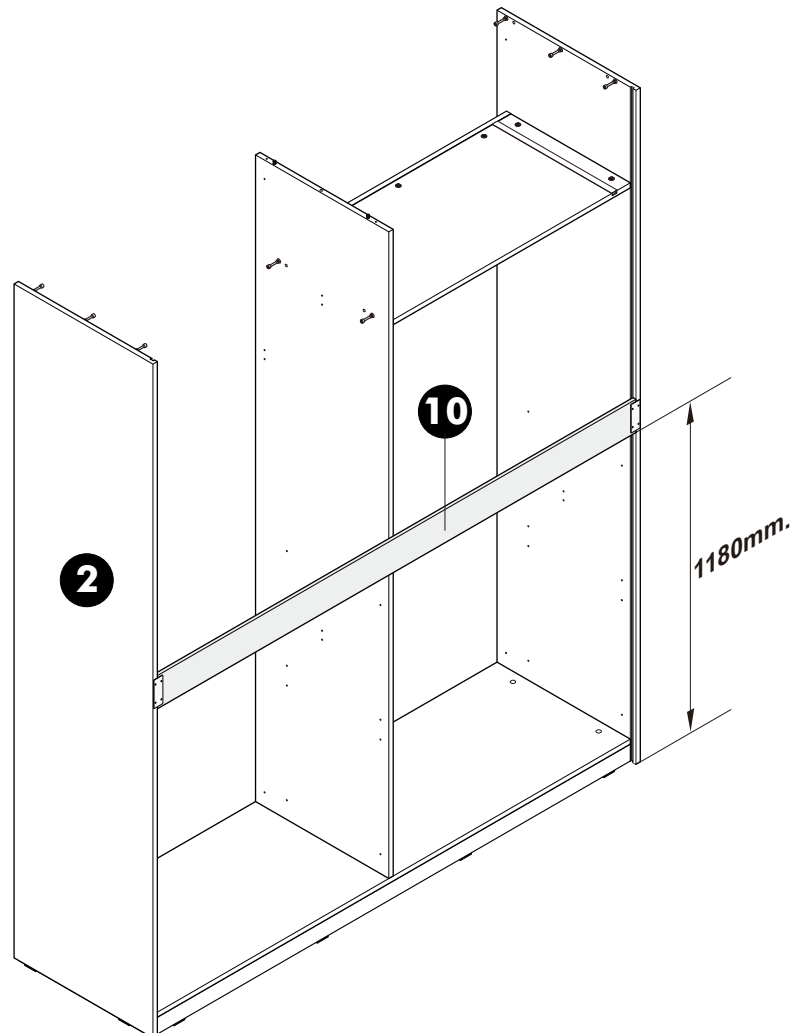

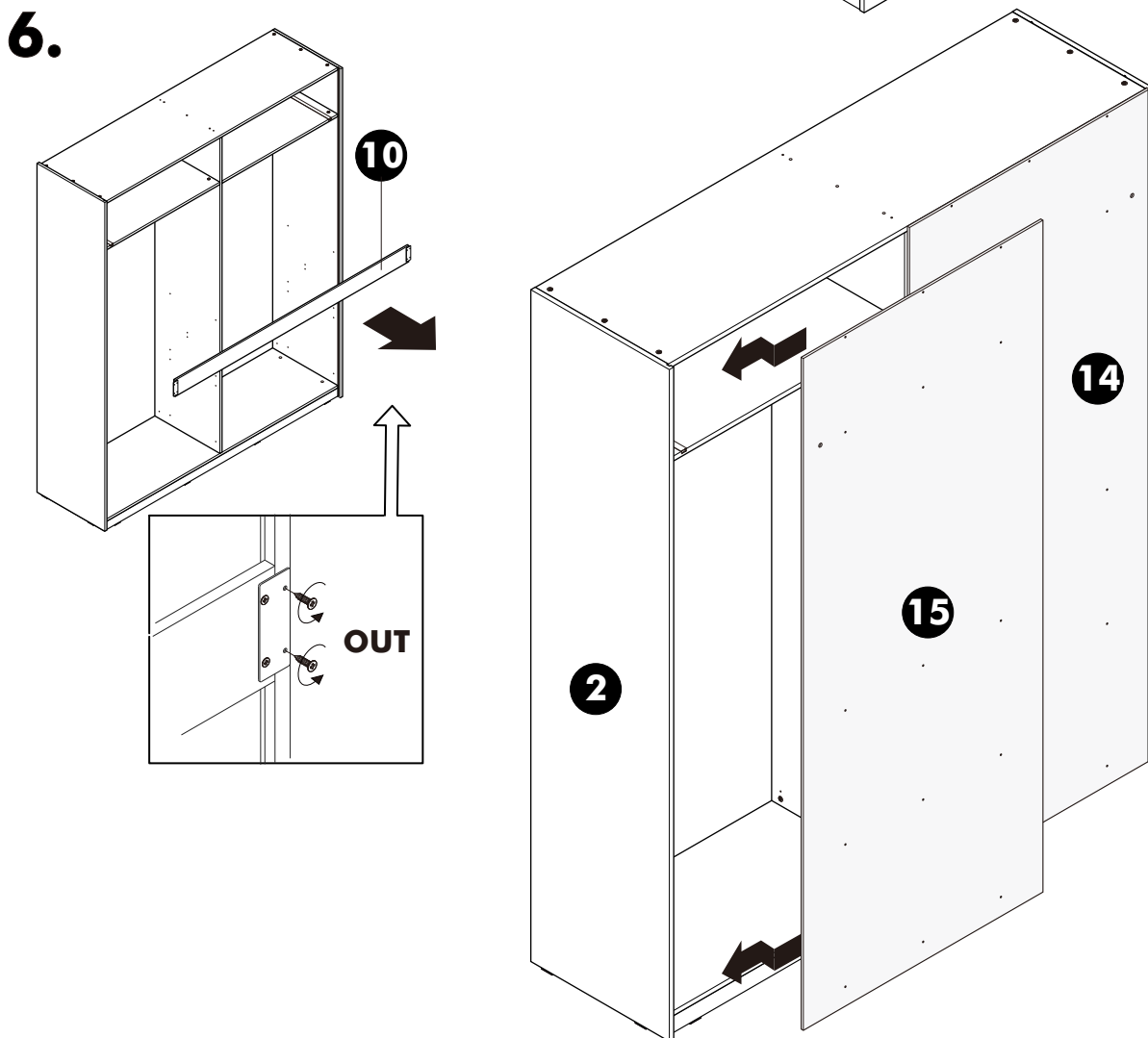
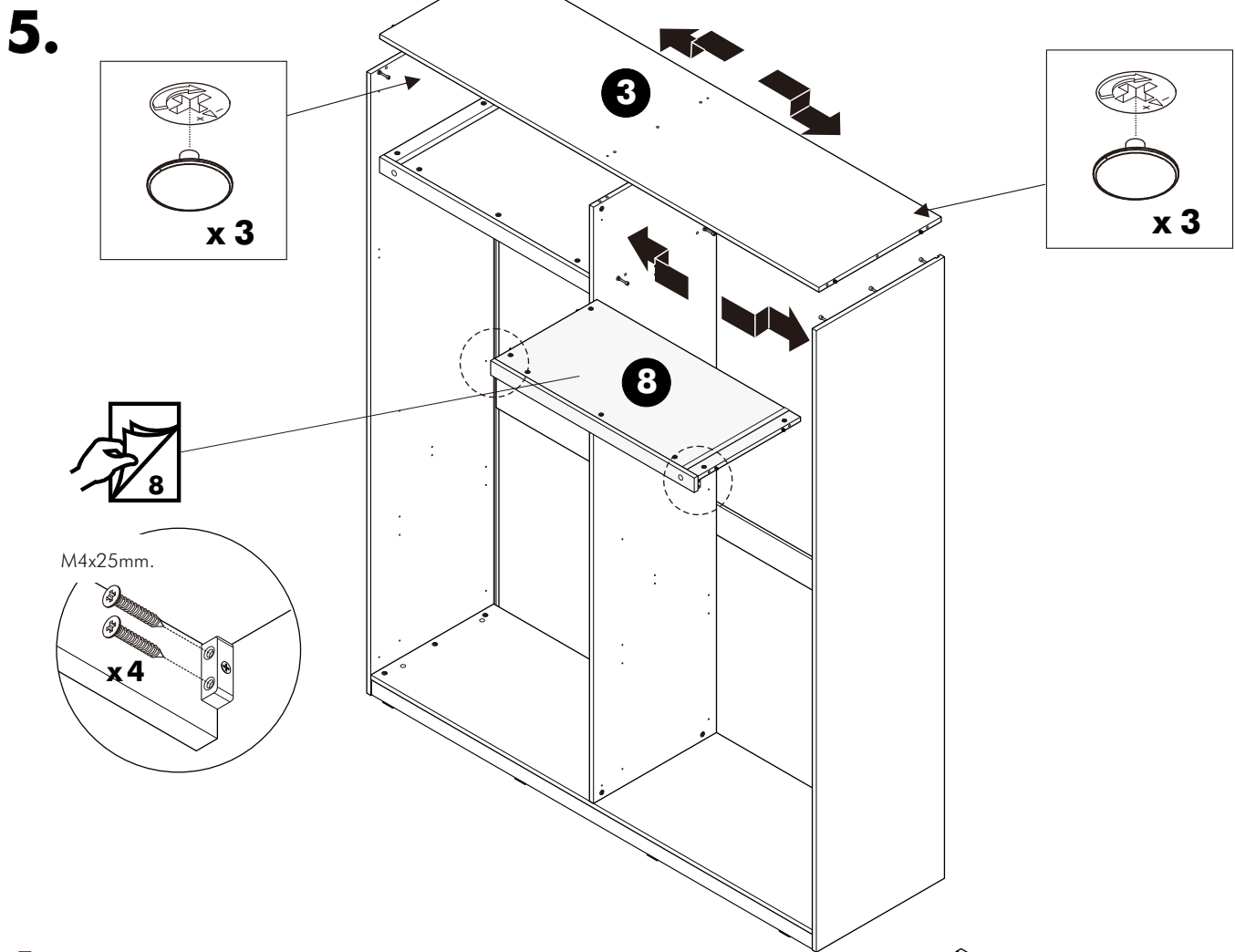

7.

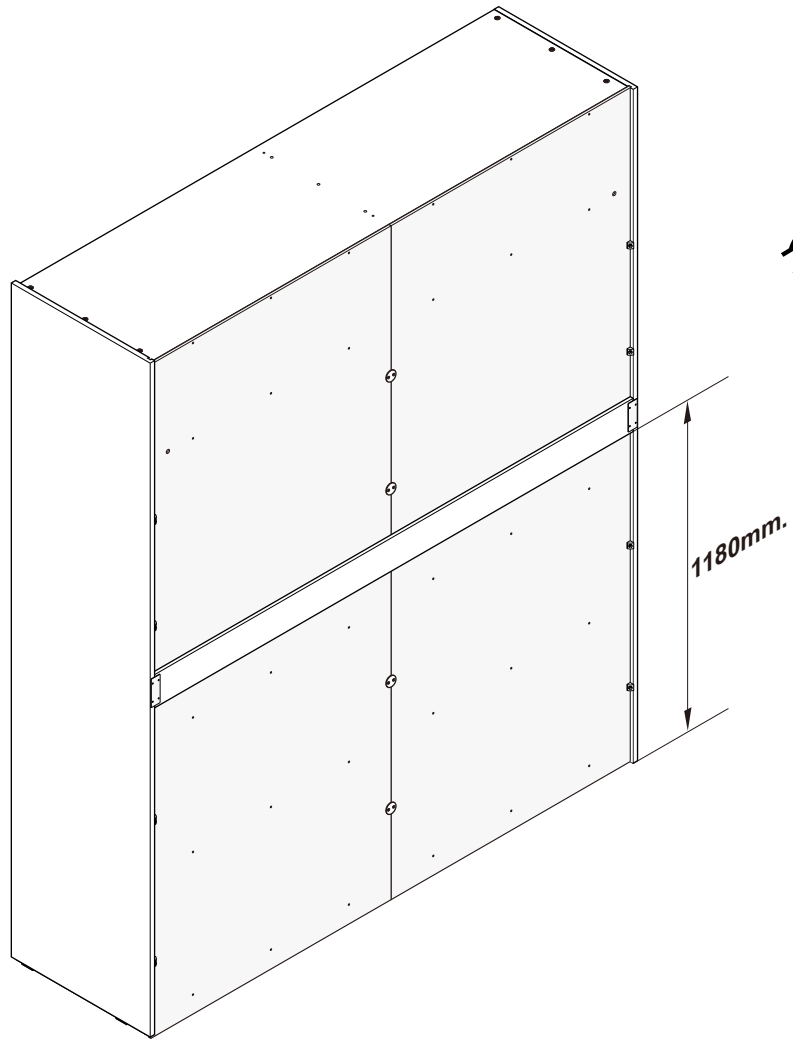

8.

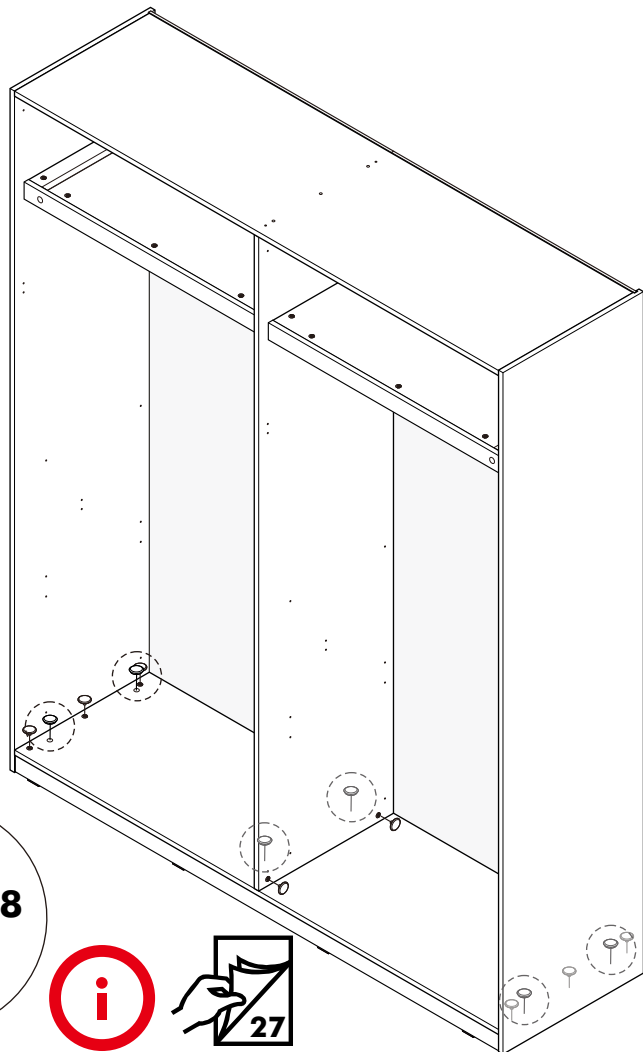
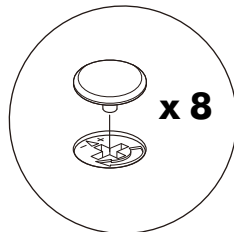
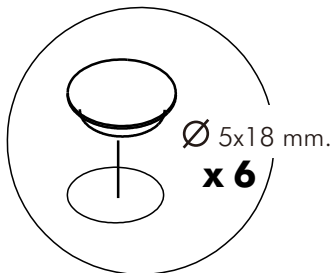
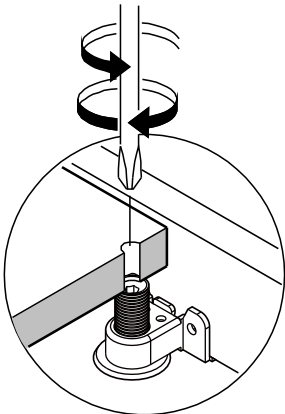
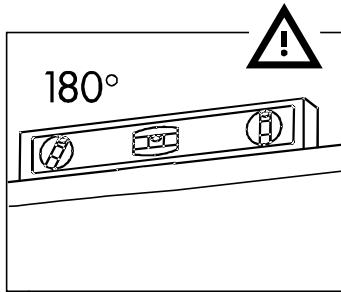



TYPE- A1

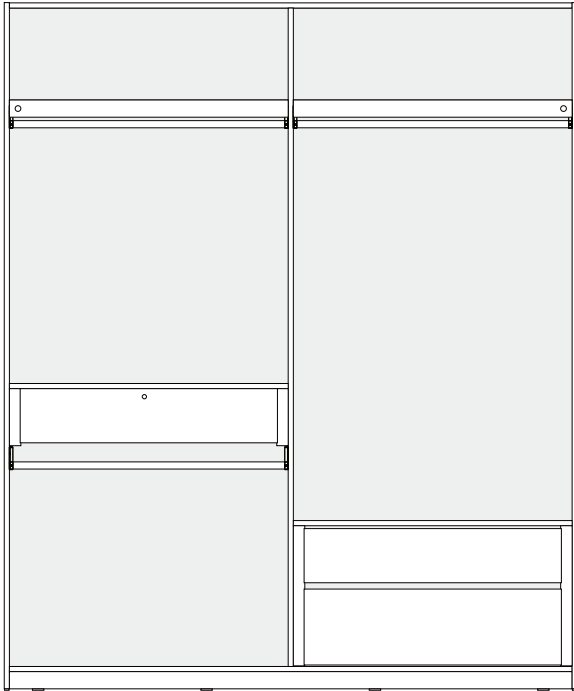

x 4



x 12

TYPE- A2

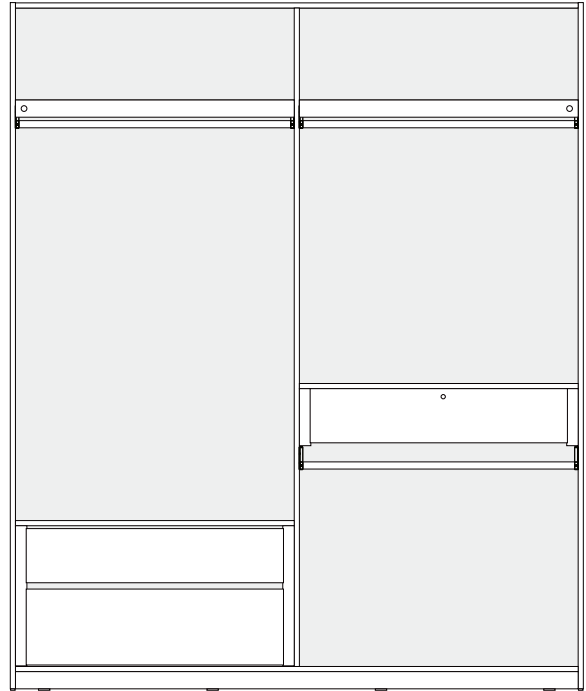

x 2



x 13

TYPE- B1

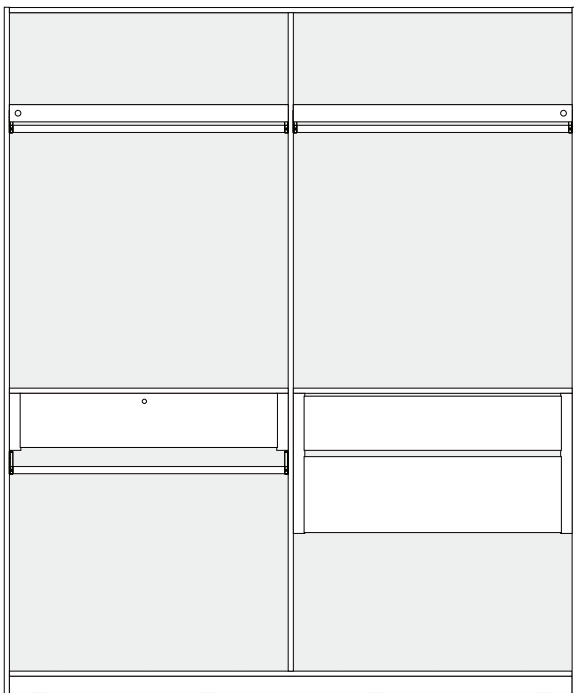

x 6



x 16

TYPE- B2

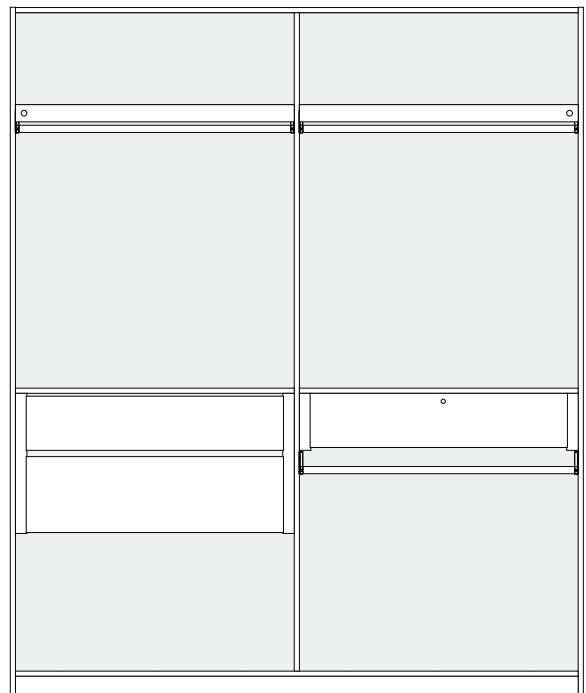

x 6



x 16