

PI

BODY 100 FUNCTION-E

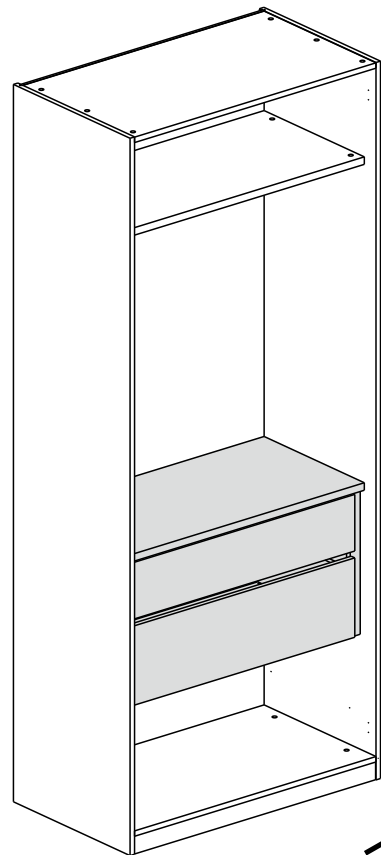

CONNECT SYSTEM

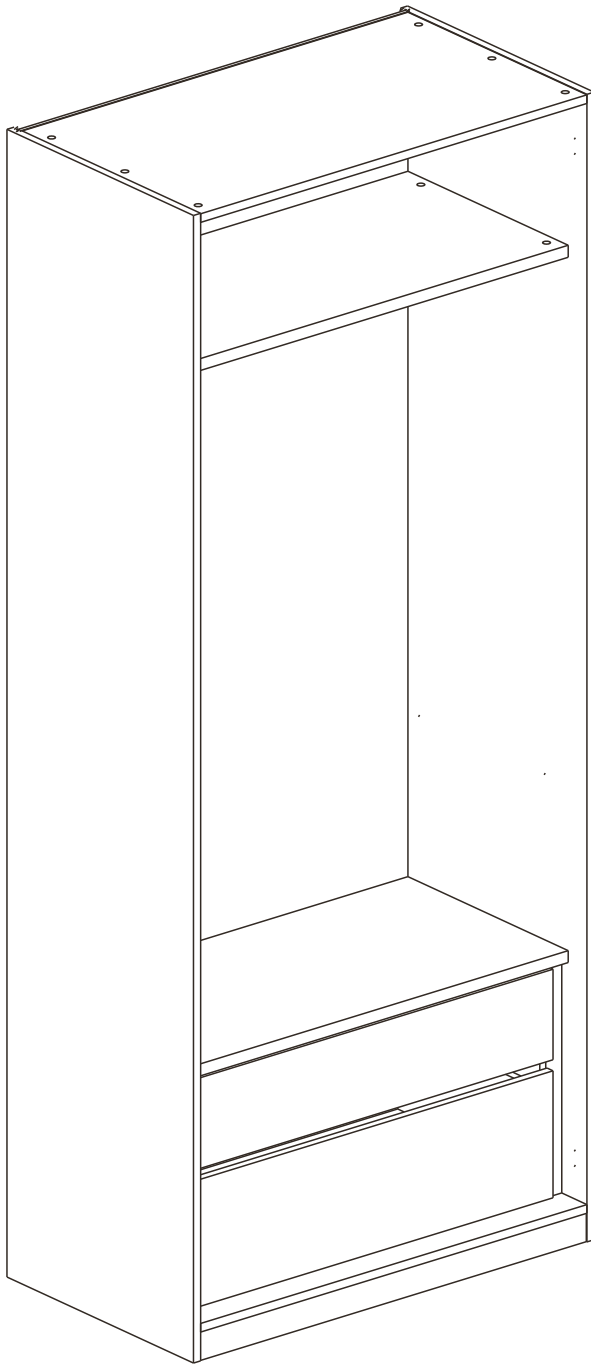
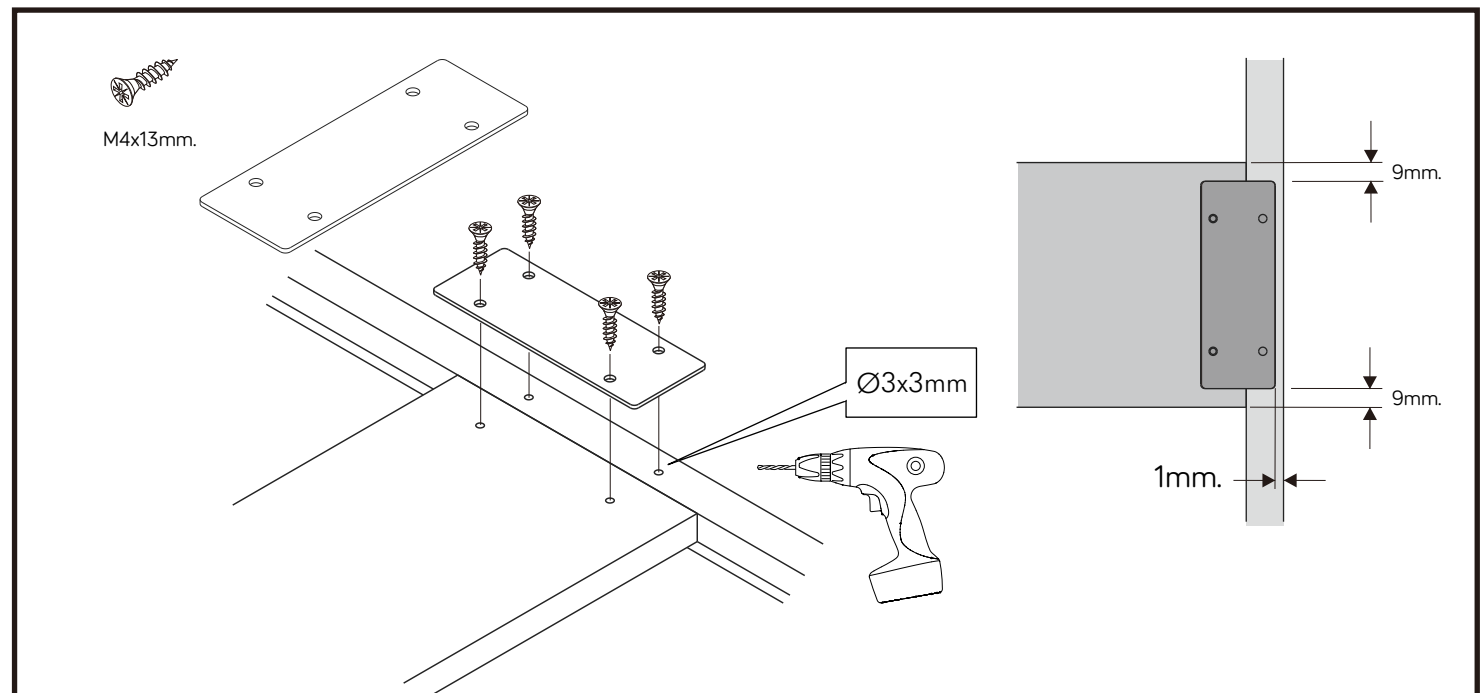
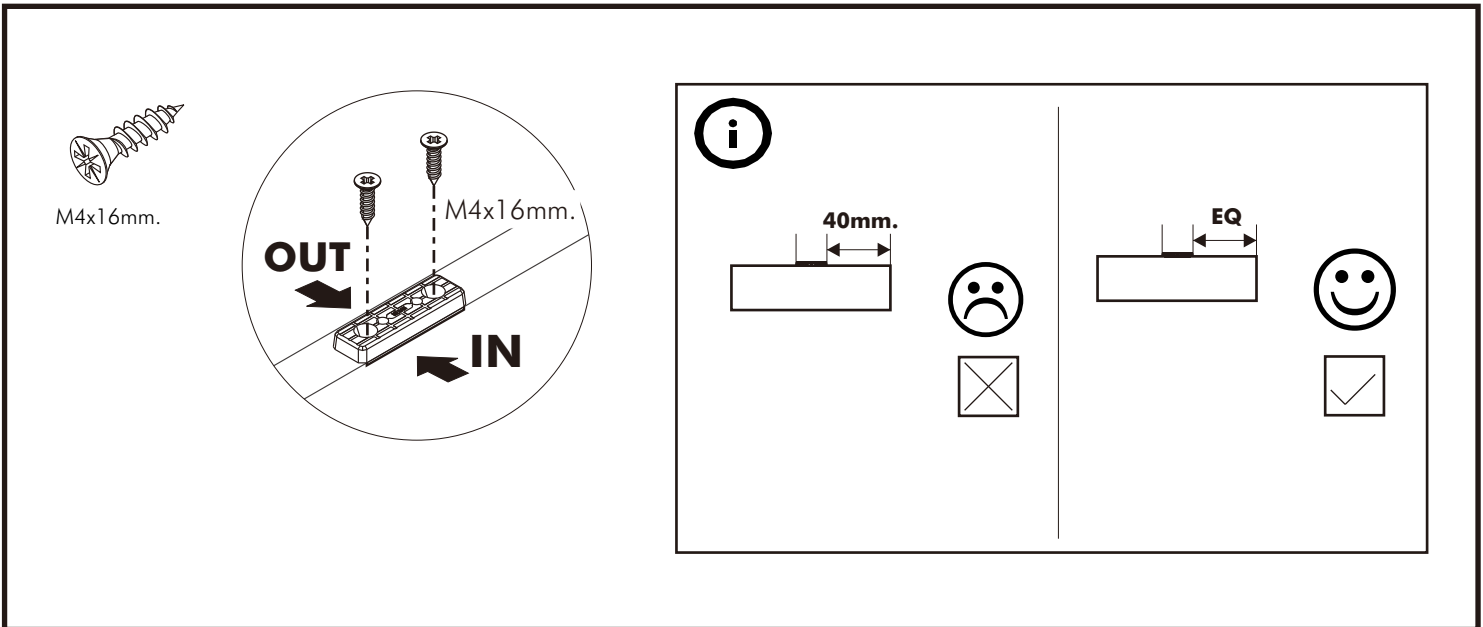
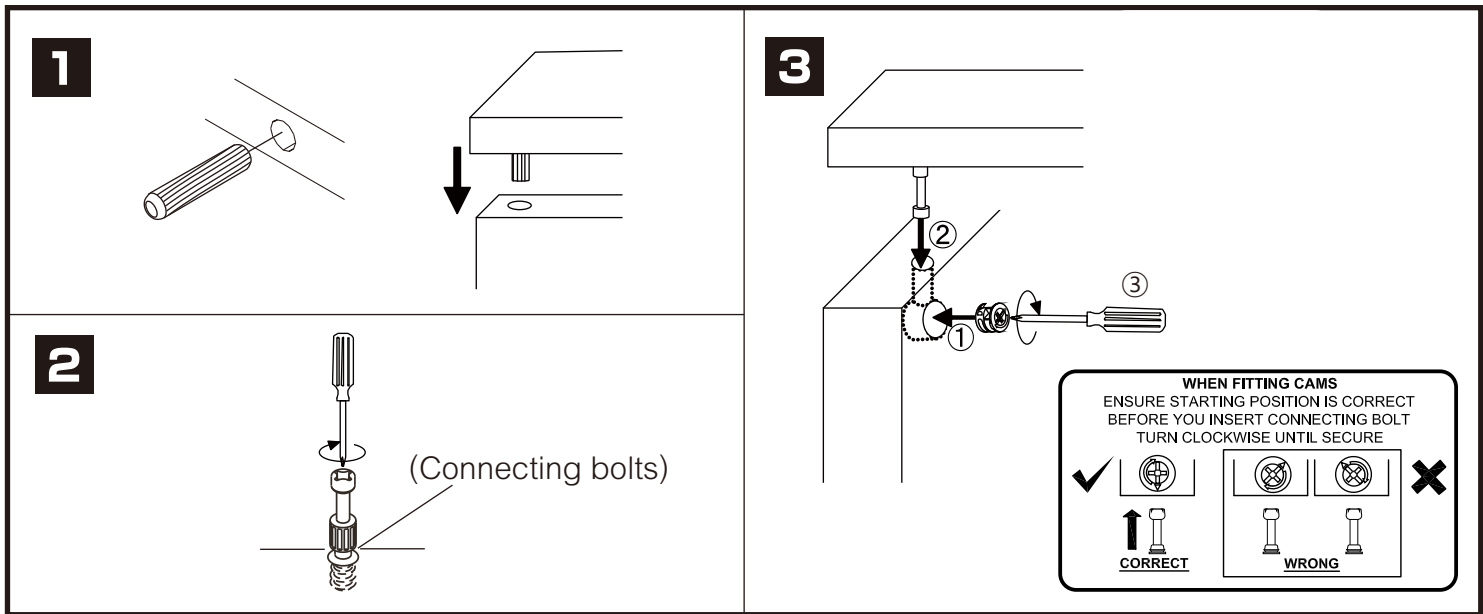

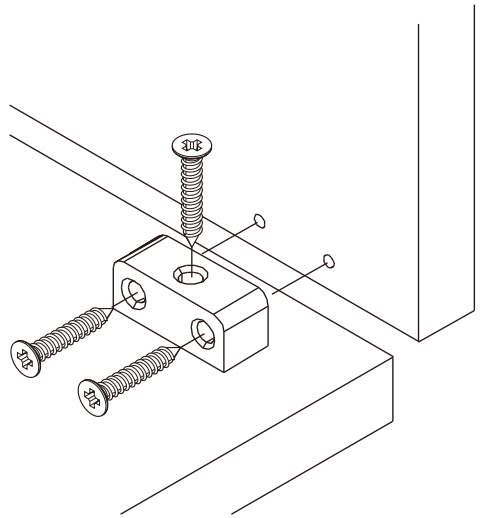
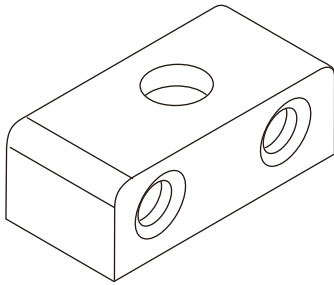
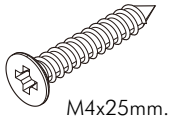
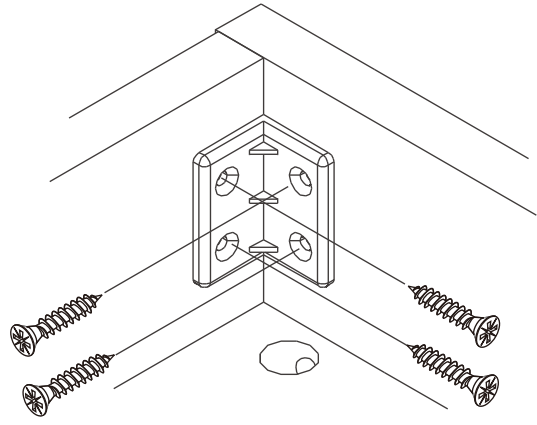
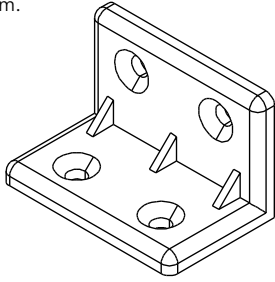
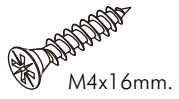

1

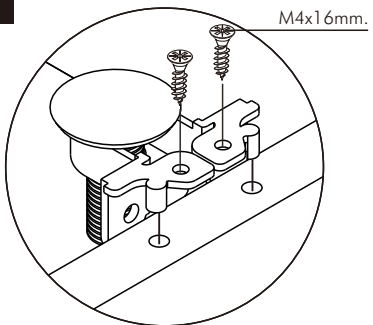

2

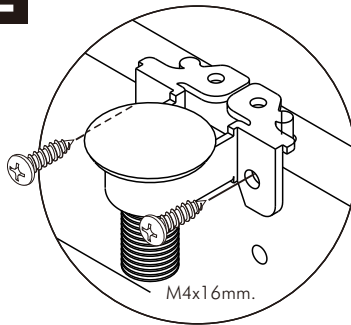

3

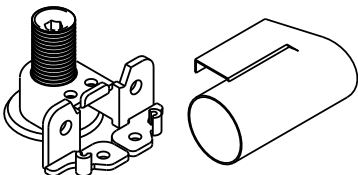
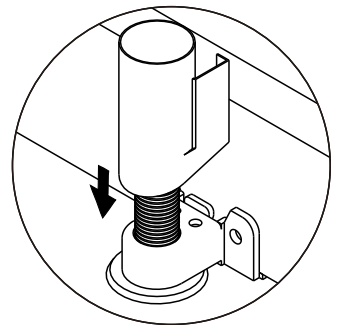

x2

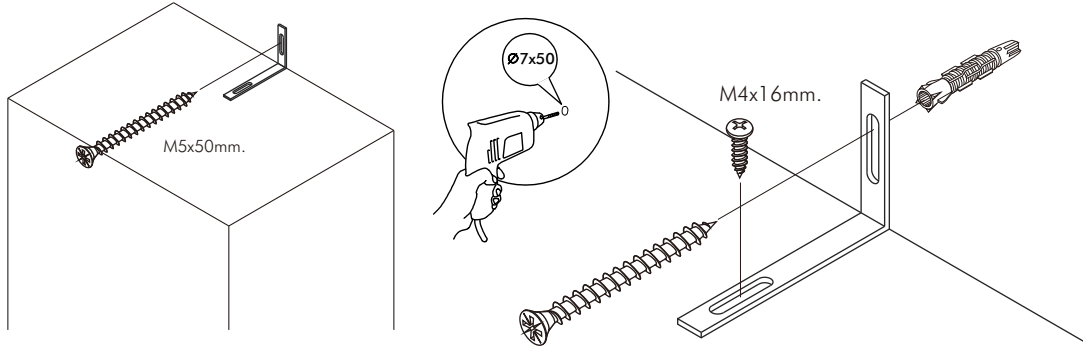

มาตรฐาน การระบุสินค้าที่ต้องยึด Fitting กับสับ (Safety Fitting) ***หมายเหตุ เป็นชุดเด็ก ไม้ติดตั้ง Fitting กับสับทุกตัว***

ติดตั้งจากสับกับตู้สูง (ตั้งแต่ 2 m. ขึ้นไป)

■ หมวด ตู้บานเปิด / ตู้บานปิด + ช่องใส่

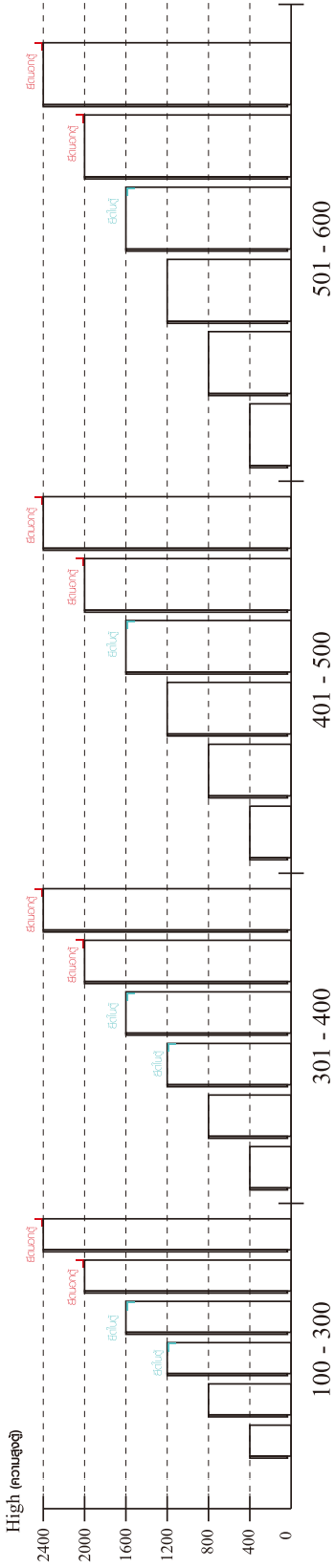

ความสูงตั้งแต่ 1200 ขึ้นไป สักไม่เกิน 300 ความสูงตั้งแต่ 1600 ขึ้นไป สักไม่เกิน 400 ความสูงตั้งแต่ 1600 ขึ้นไป สักไม่เกิน 500 ความสูงตั้งแต่ 1600 ขึ้นไป สักไม่เกิน 600

■ หมวด ตู้ลิ้นชัก / ตู้ลิ้นชัก + ช่องใส่ / ตู้ลิ้นชัก + บานเปิด / ตู้ลิ้นชัก + บานสไลด์

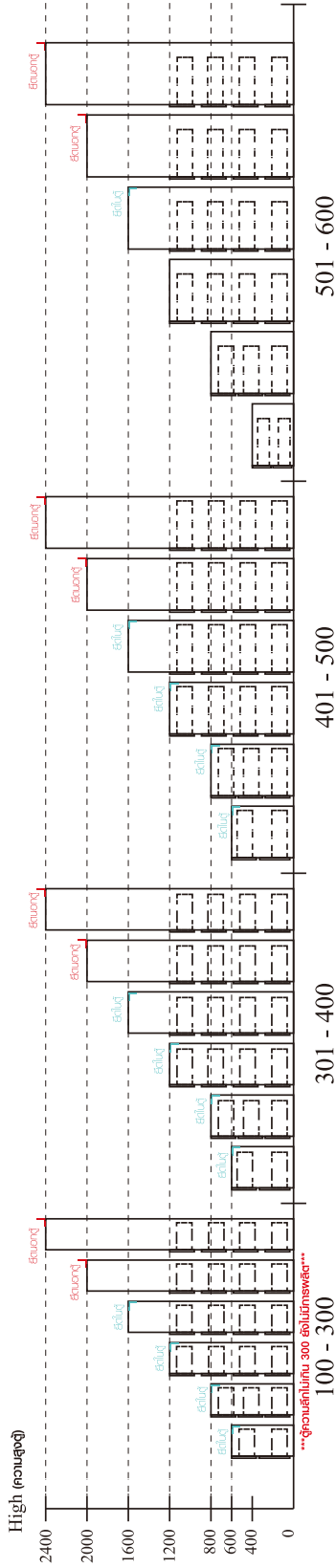

ความสูงตั้งแต่ 600 ขึ้นไป สักไม่เกิน 300 ความสูงตั้งแต่ 600 ขึ้นไป สักไม่เกิน 400 ความสูงตั้งแต่ 600 ขึ้นไป สักไม่เกิน 500 ความสูงตั้งแต่ 1600 ขึ้นไป สักไม่เกิน 600

■ หมวด ตู้บานสไลด์ / ตู้ใส่

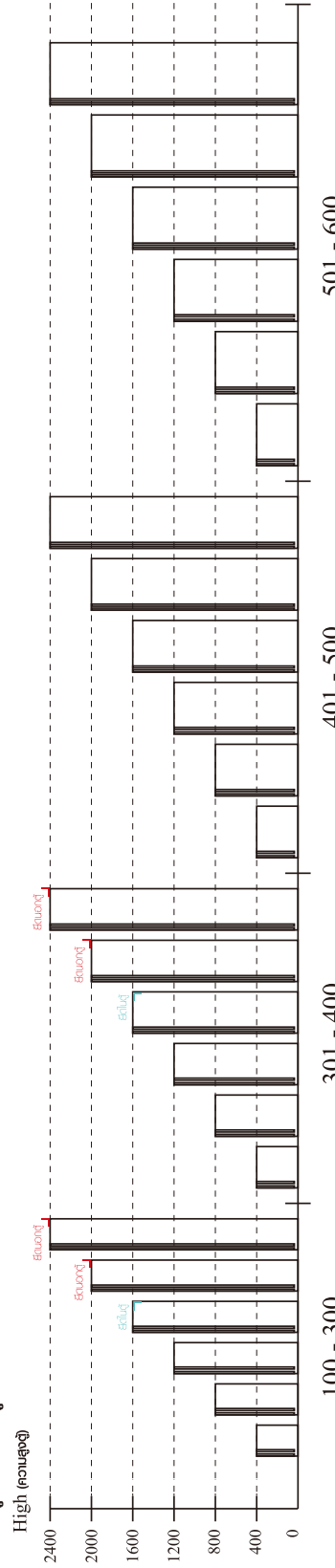

ความสูงตั้งแต่ 1600 ขึ้นไป สักไม่เกิน 300 ความสูงตั้งแต่ 1600 ขึ้นไป สักไม่เกิน 400

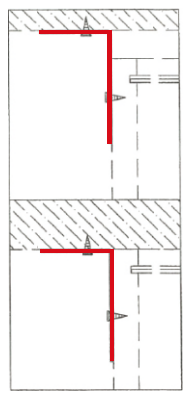

ติดตั้งบนผนัง ติดตั้งลอยหลบมือ

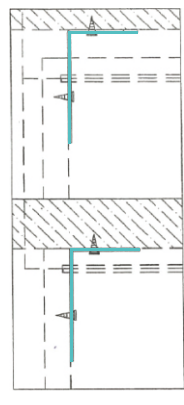

ติดตั้งบนผนัง ติดตั้งลอยหลบมือ

HARDWARE

-BODY SET

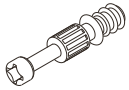

x 20



x 20

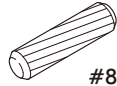

#8x35
x 22

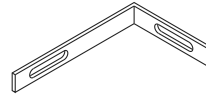

x 2

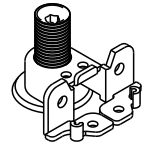

x 4

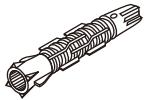

x 2

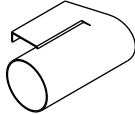

x 4

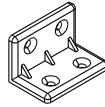

x 13

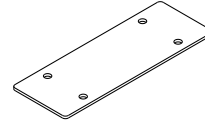

x 2



M4x25mm.

x 18



x 12

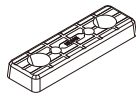

x 10



x 12



3x11 mm.

x 21



M4x13mm.

x 8



M4x16mm.

x 80

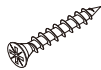

M3.5x20mm.

x 12

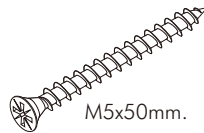

M5x50mm.

x 2



M4x16mm.

x 10

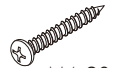

M4x20mm.

x 13



M4x30mm.

x 17

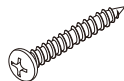

M4x30mm.

x 20

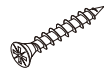

M3.5x25mm.

x 8



x 6



5x18 mm.

x 4

-DRAWER SET

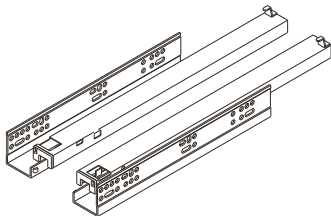

x 2



M3.5x13mm.

x 16

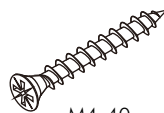

M4x40mm.

x 24

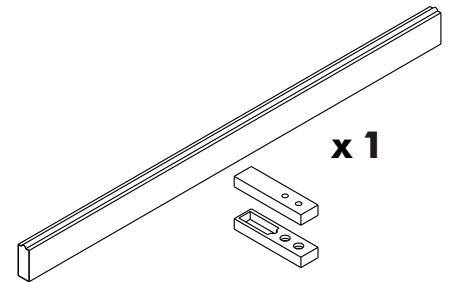

x 1

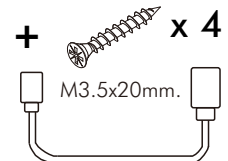

M3.5x20mm.

x 4



M6x30mm.

x 8

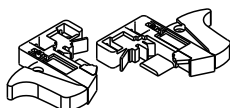

x 4

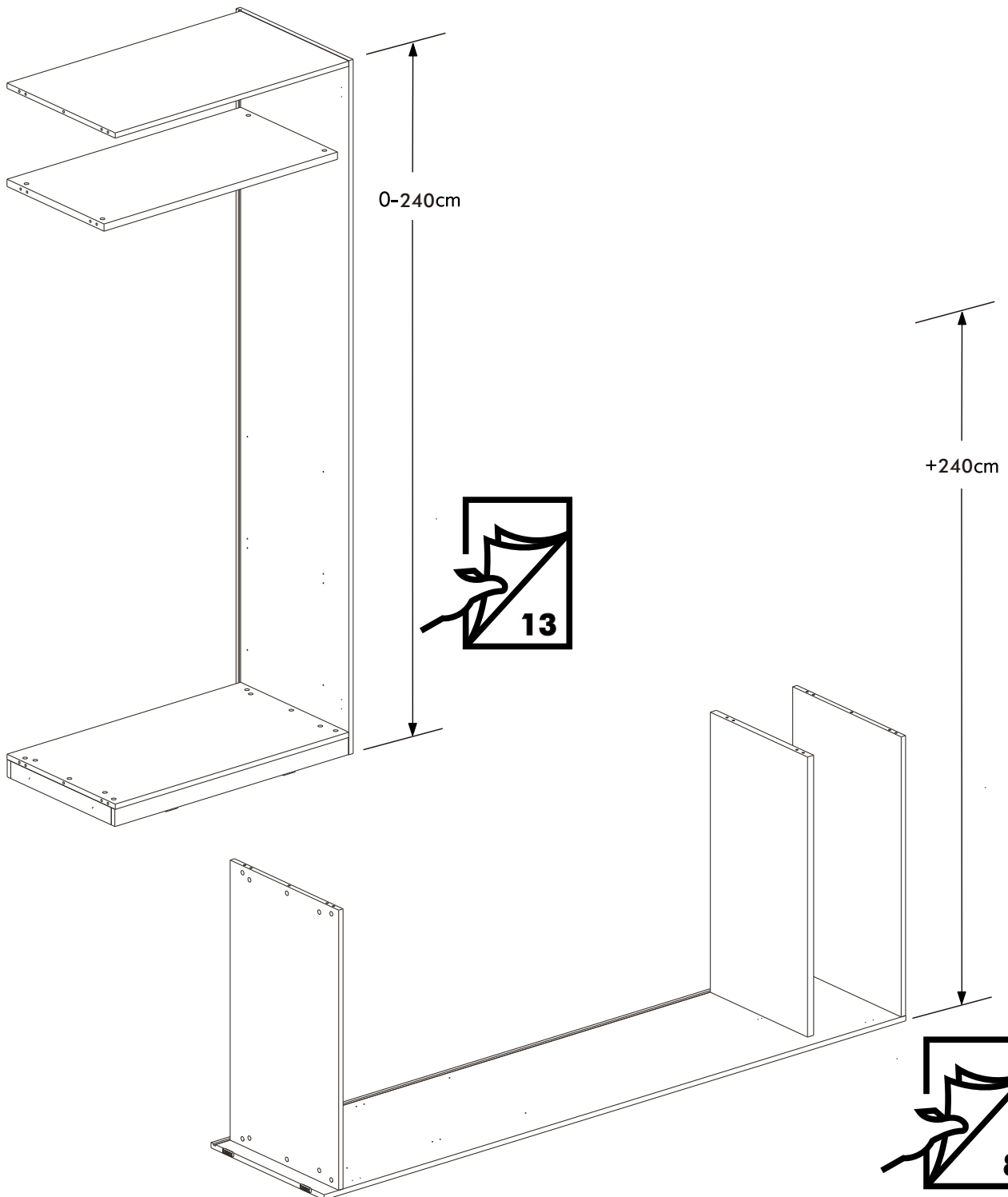
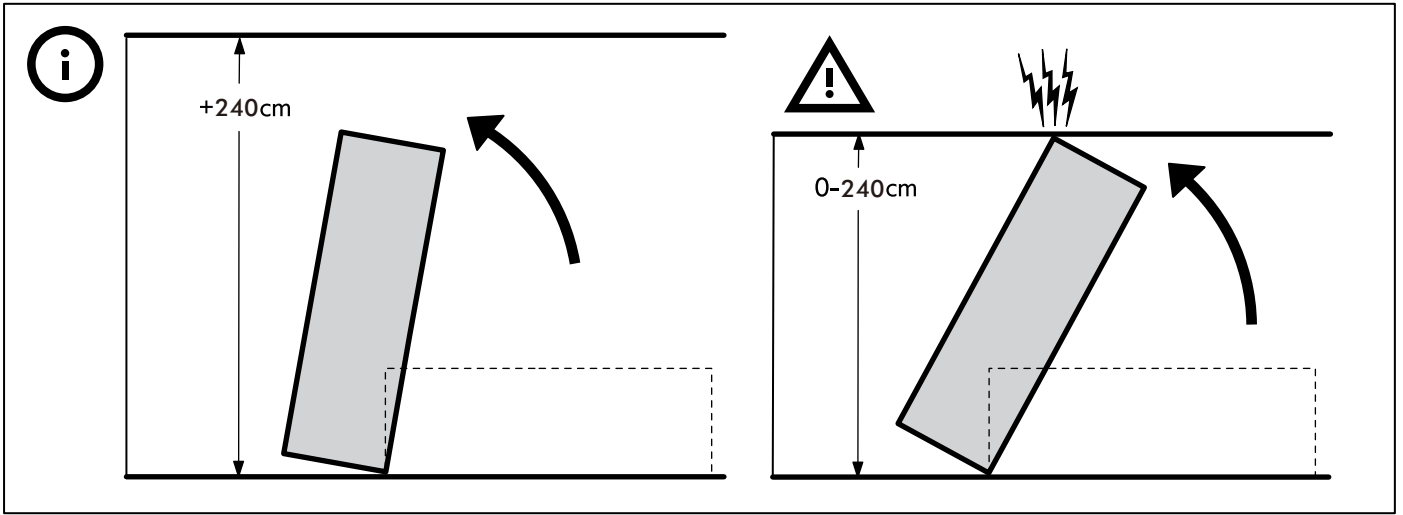

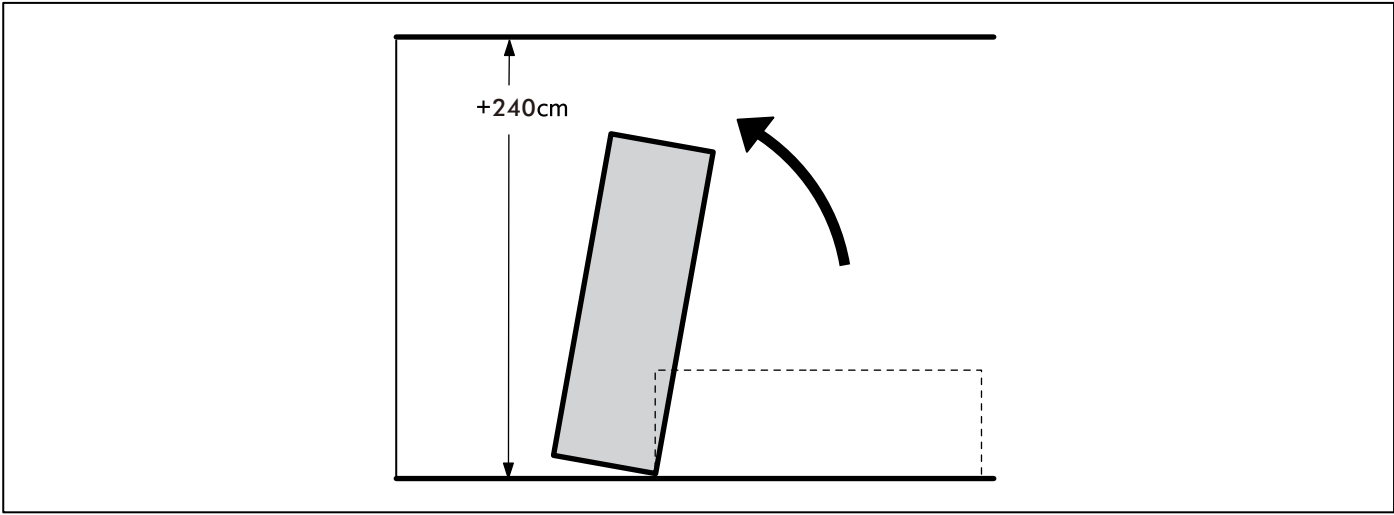

1.

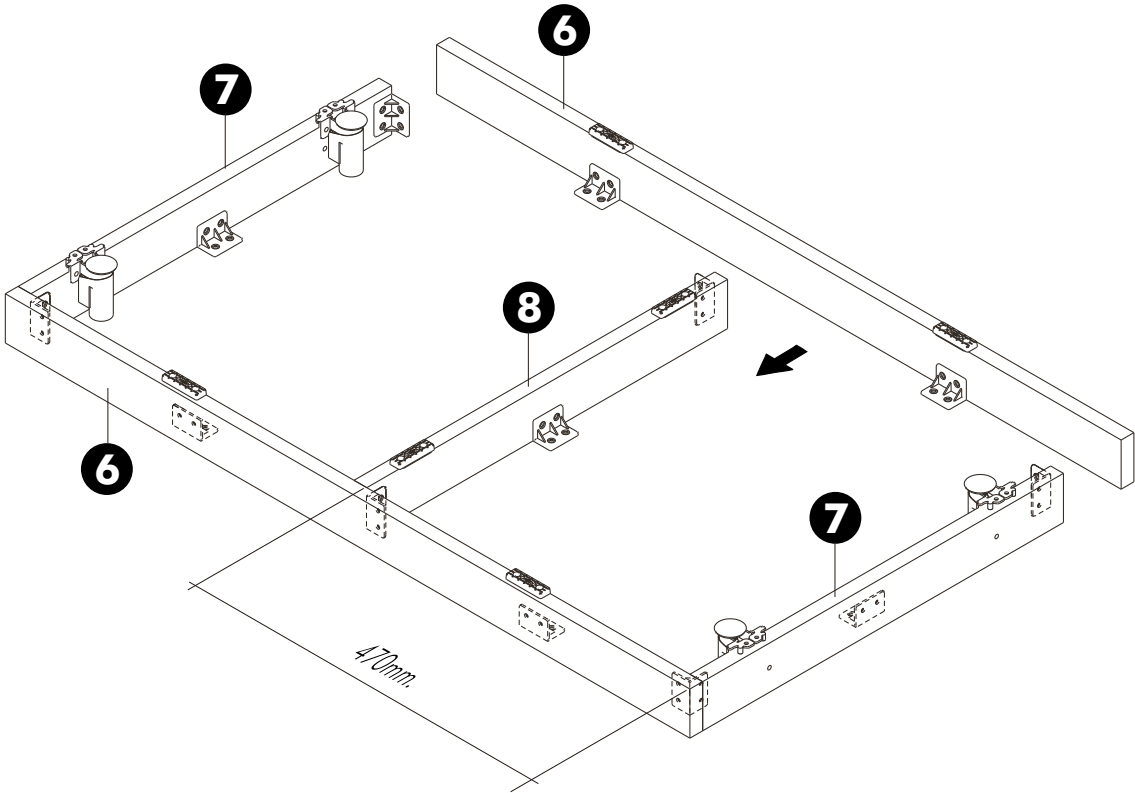

2.

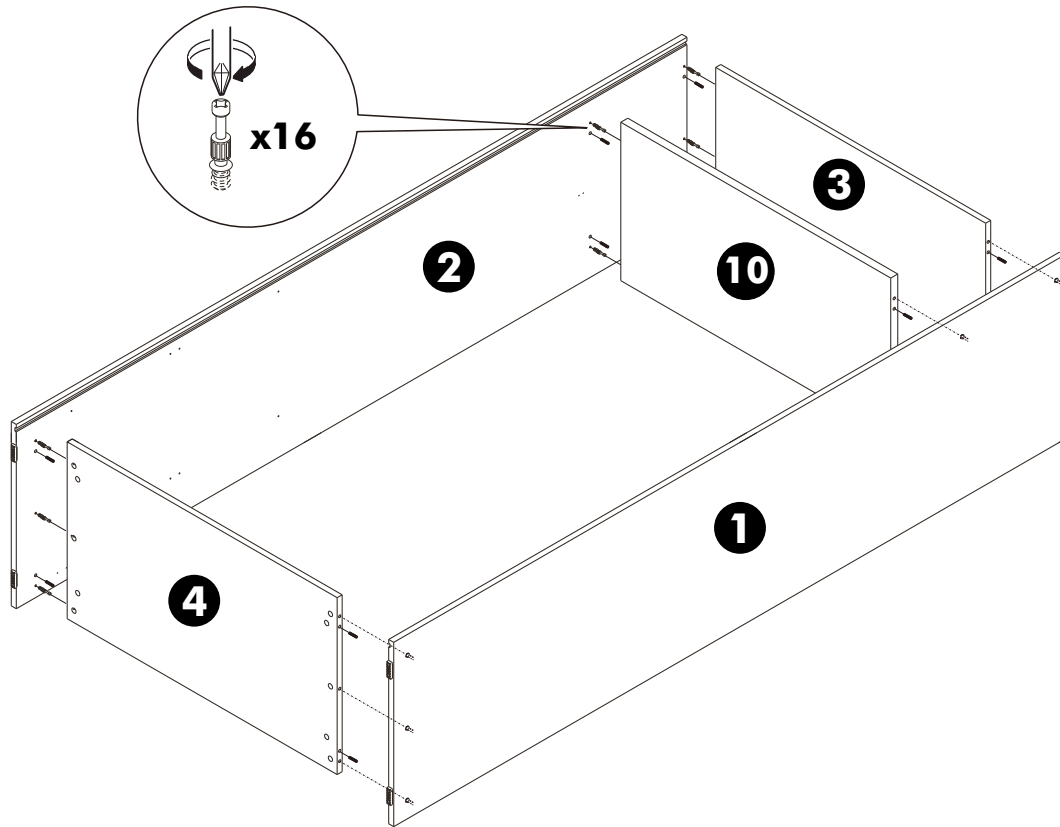

3.

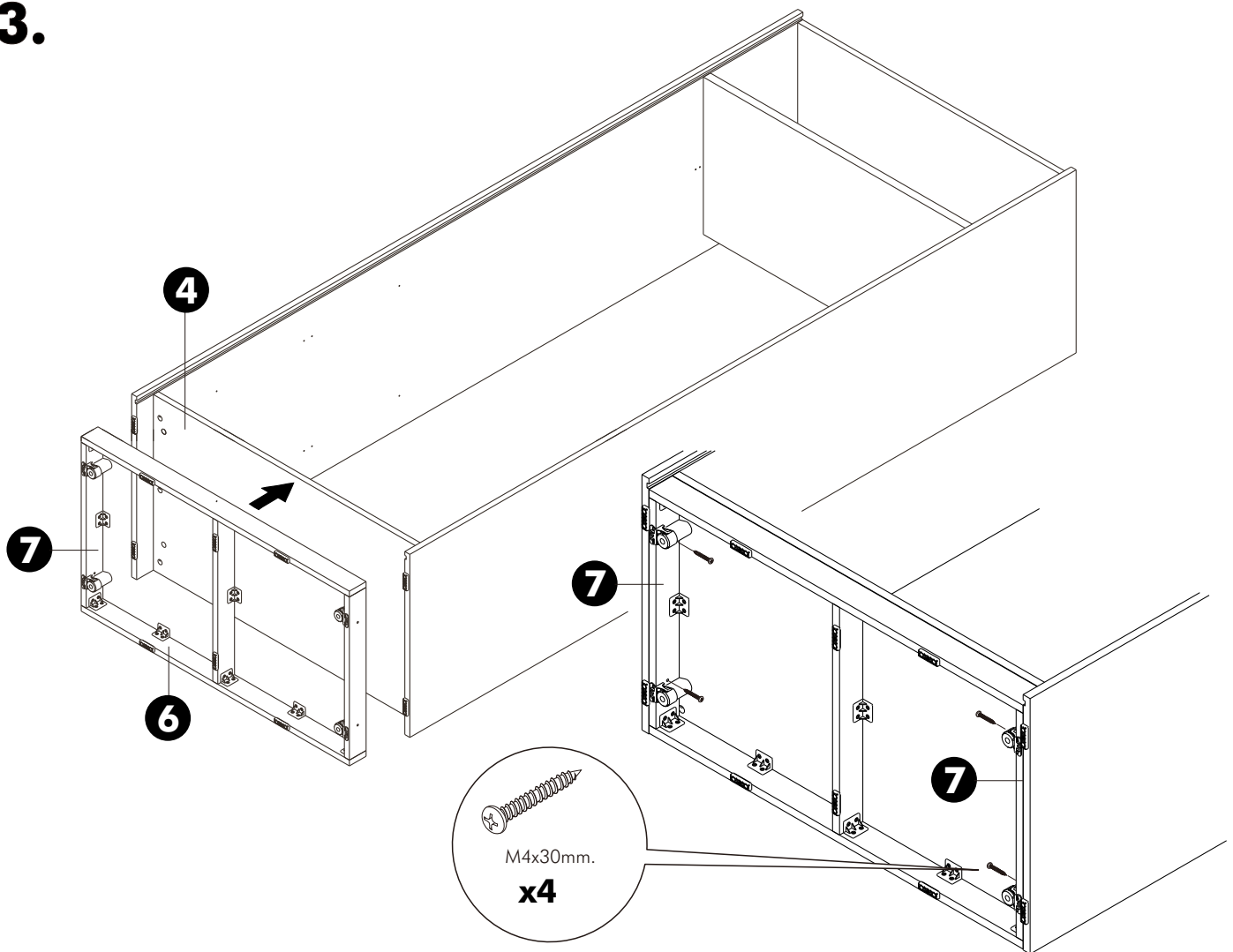

4.

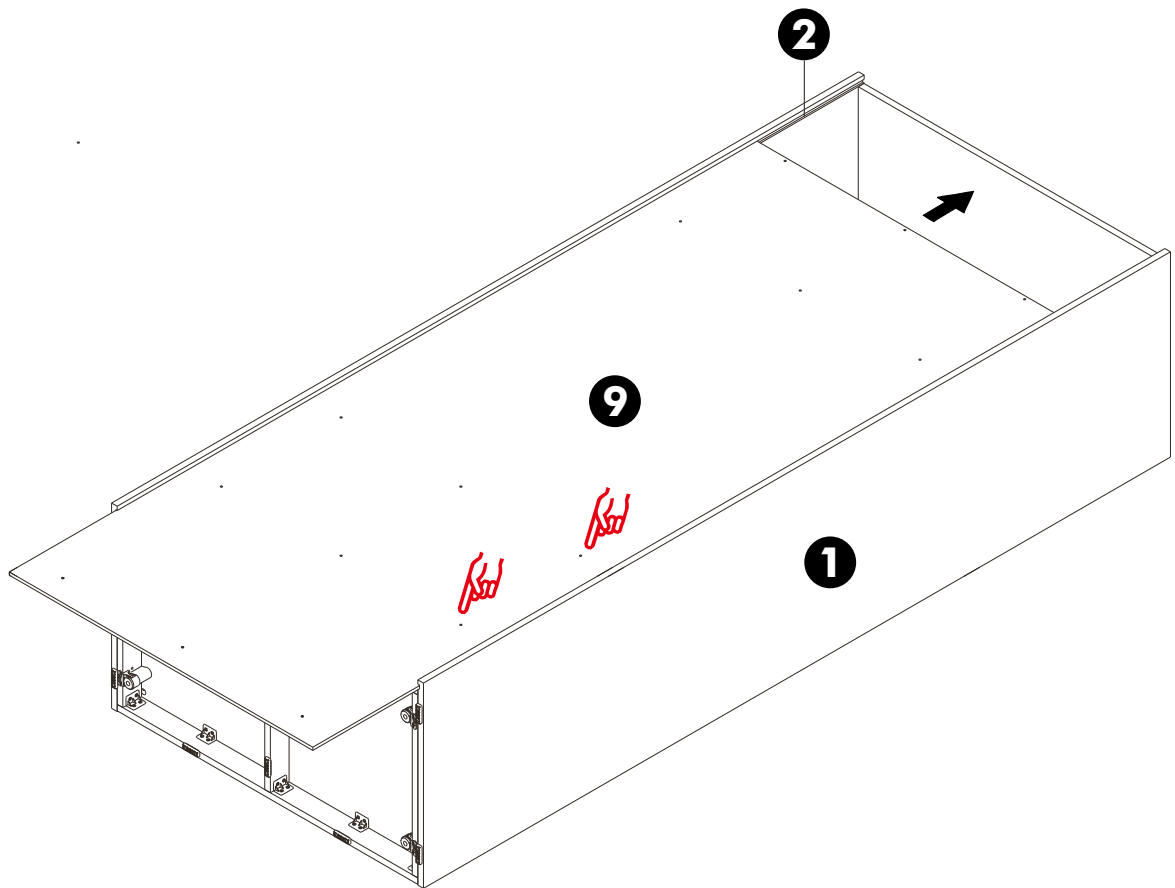

5.

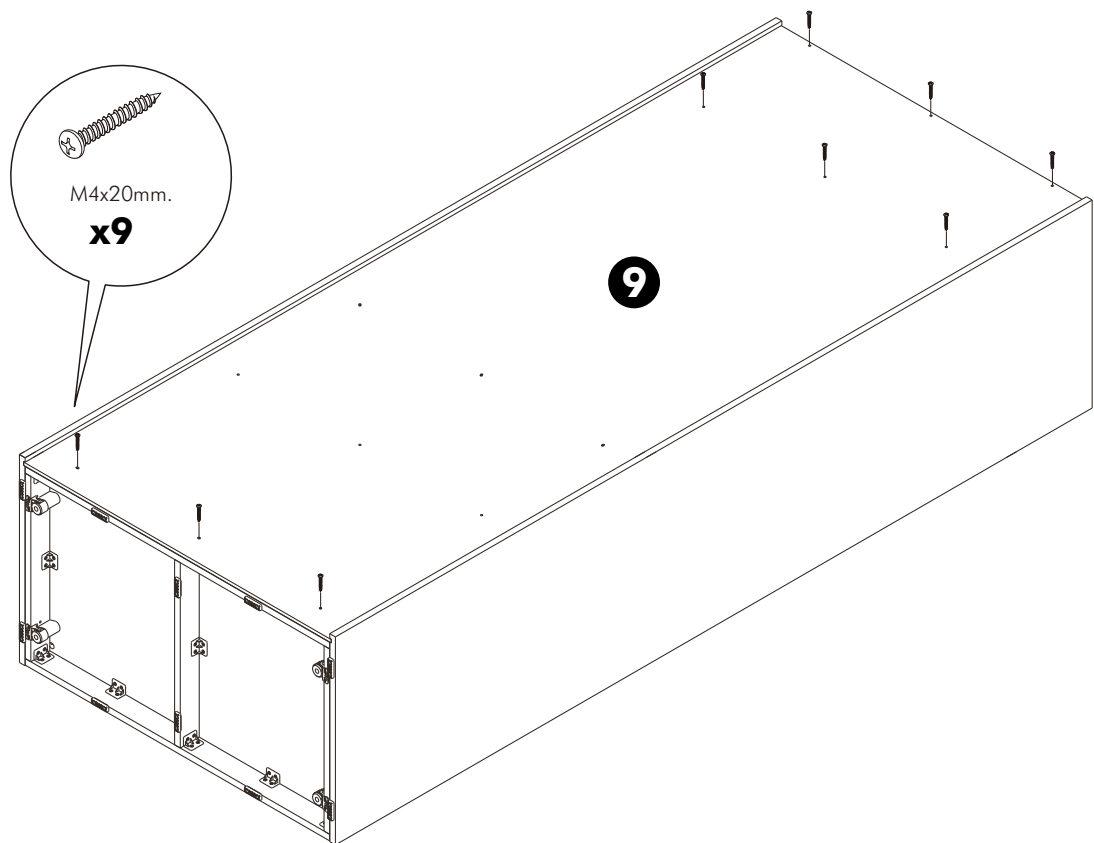

6.

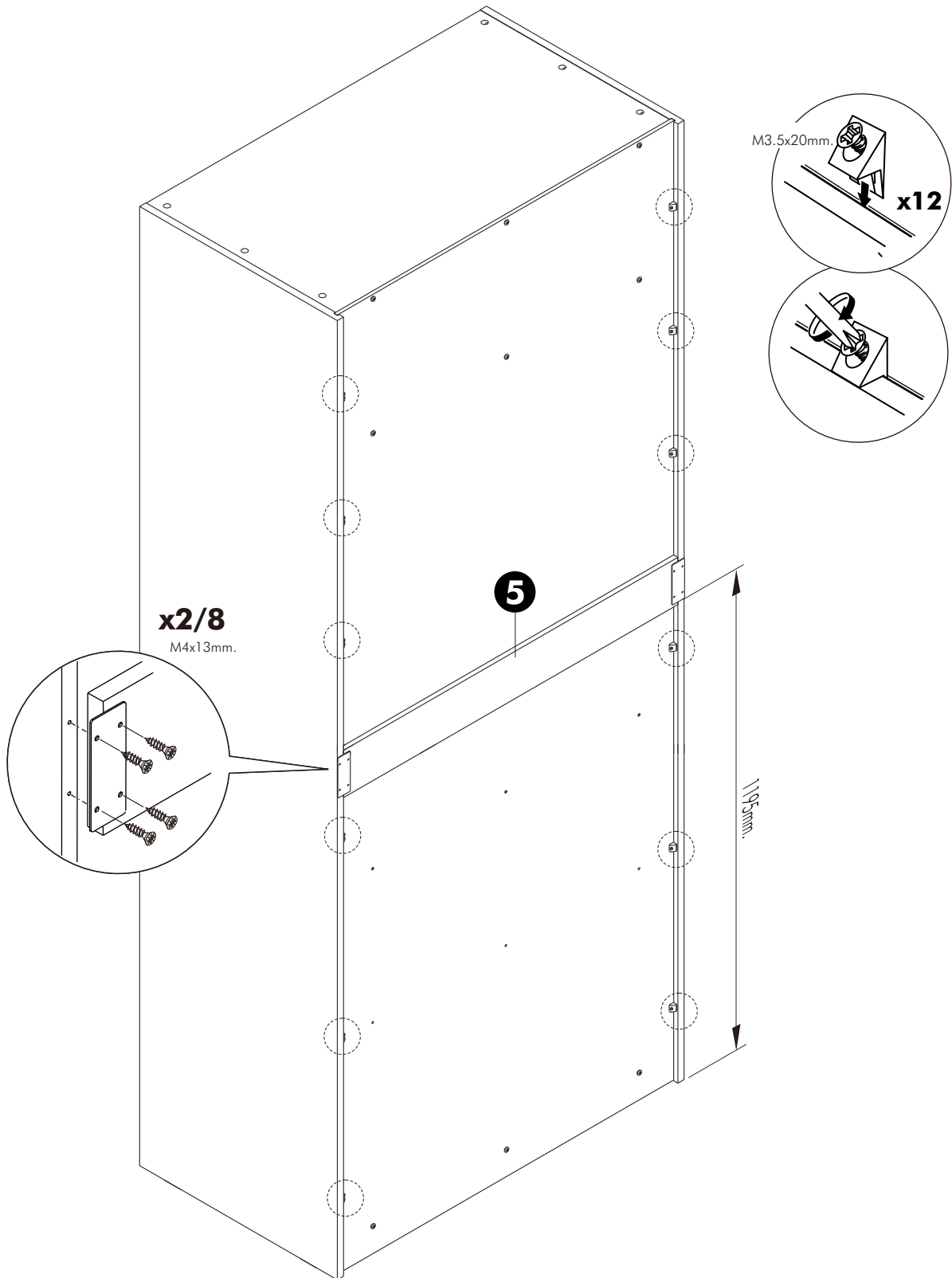

7.

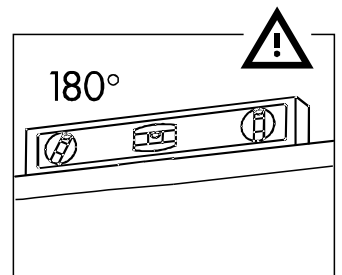
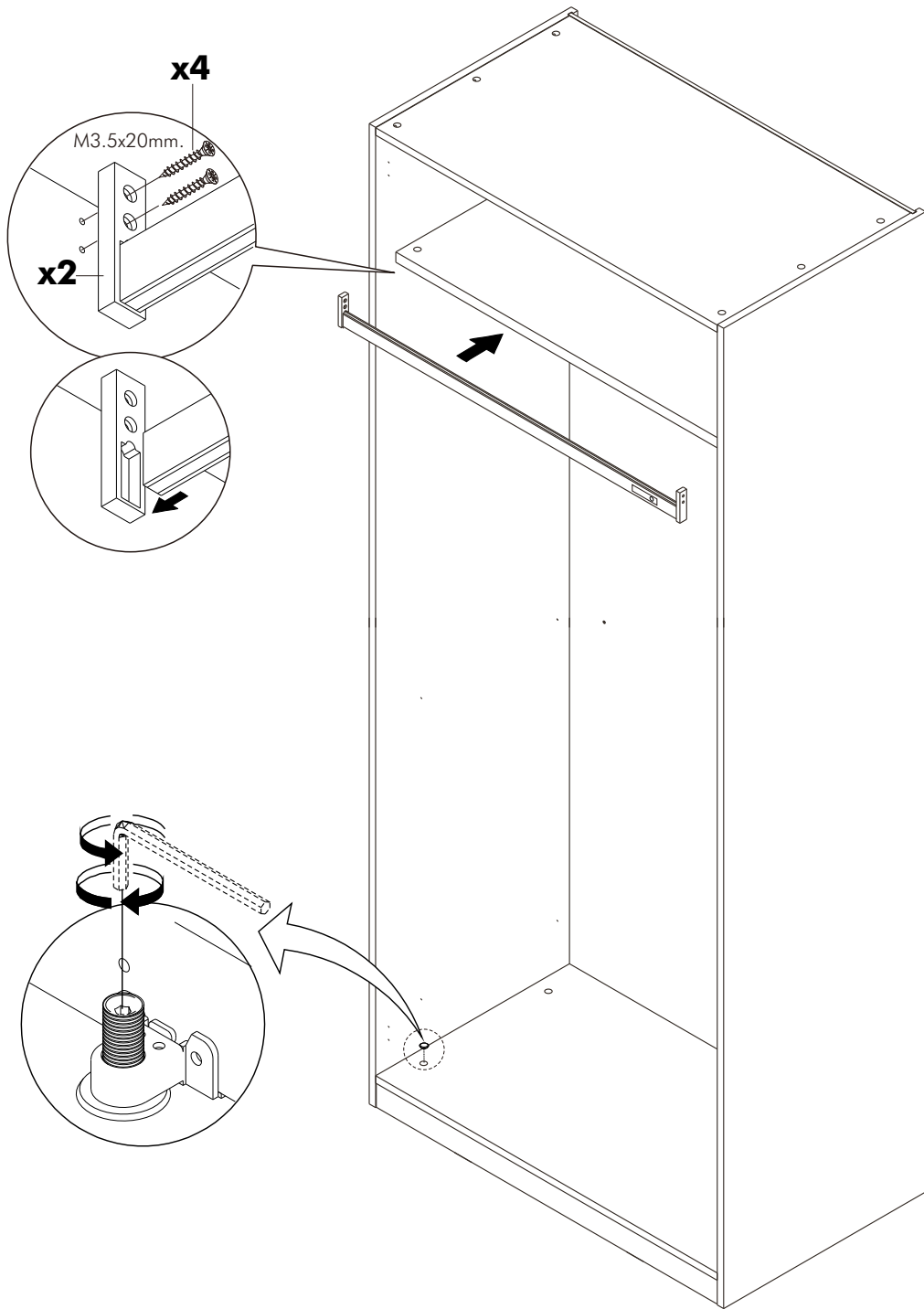

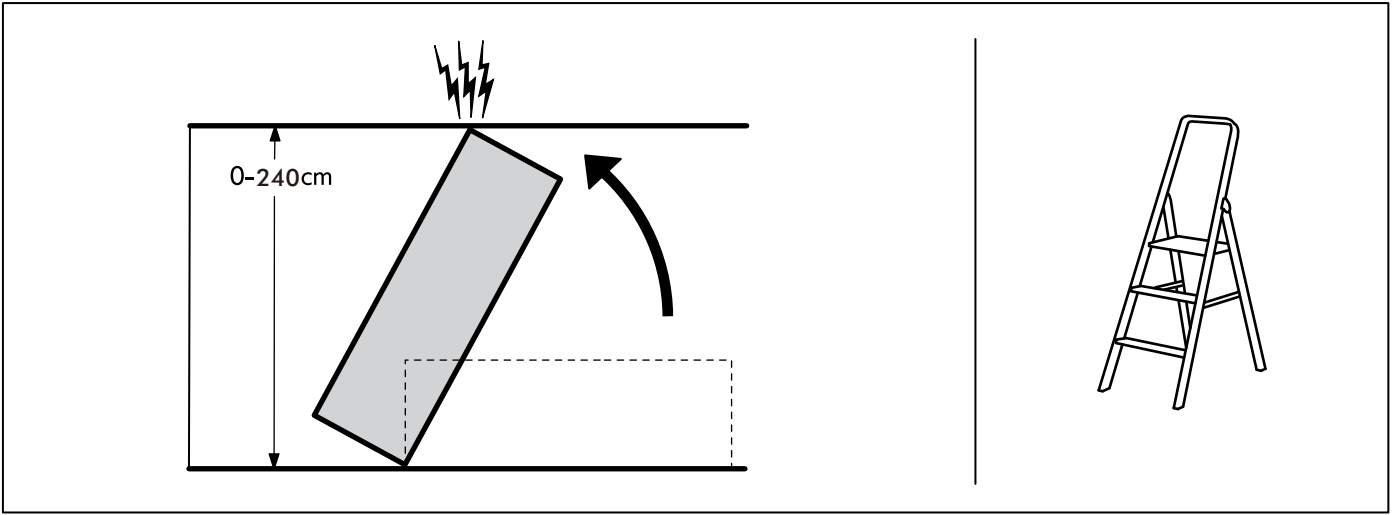

1.

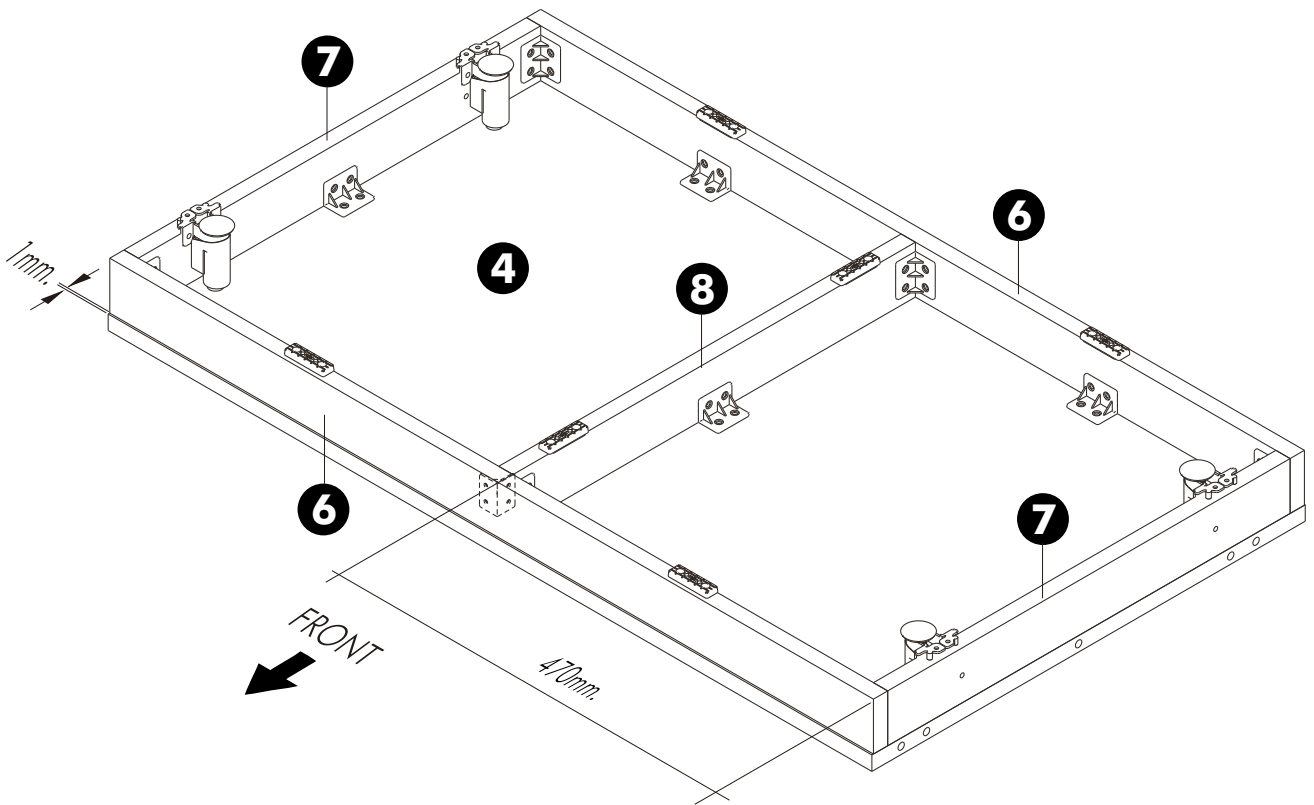

2.

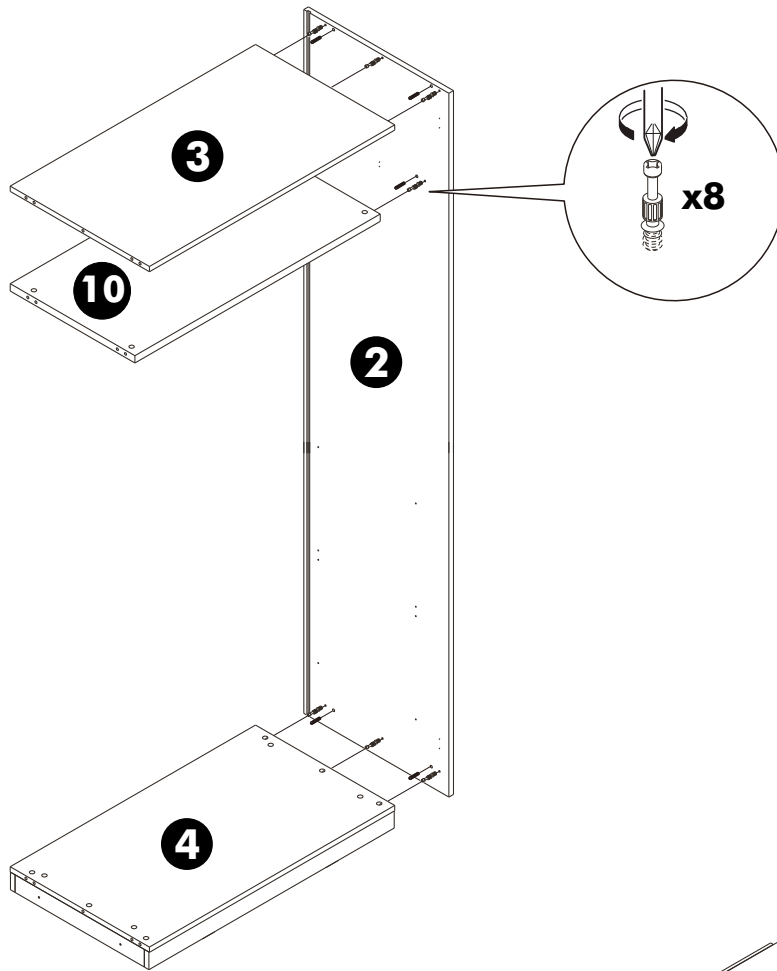

3.

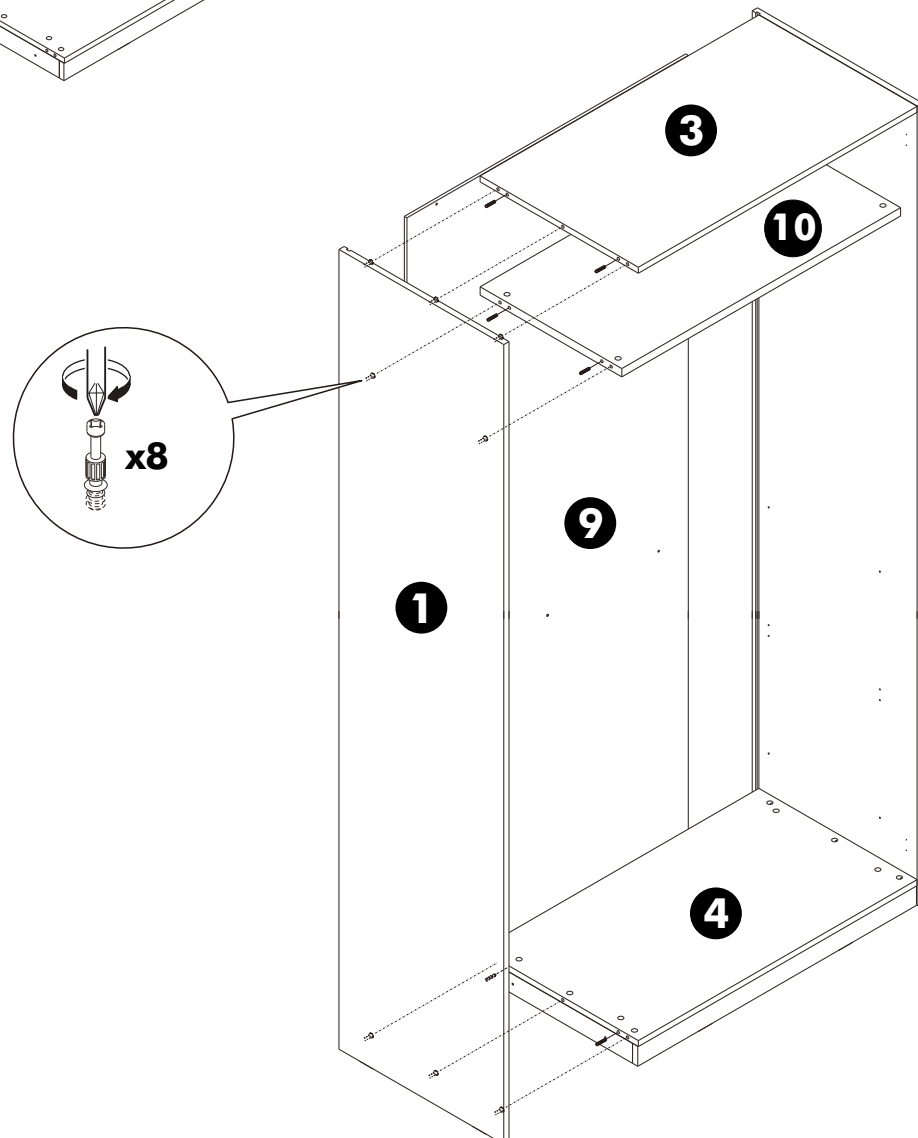

4.

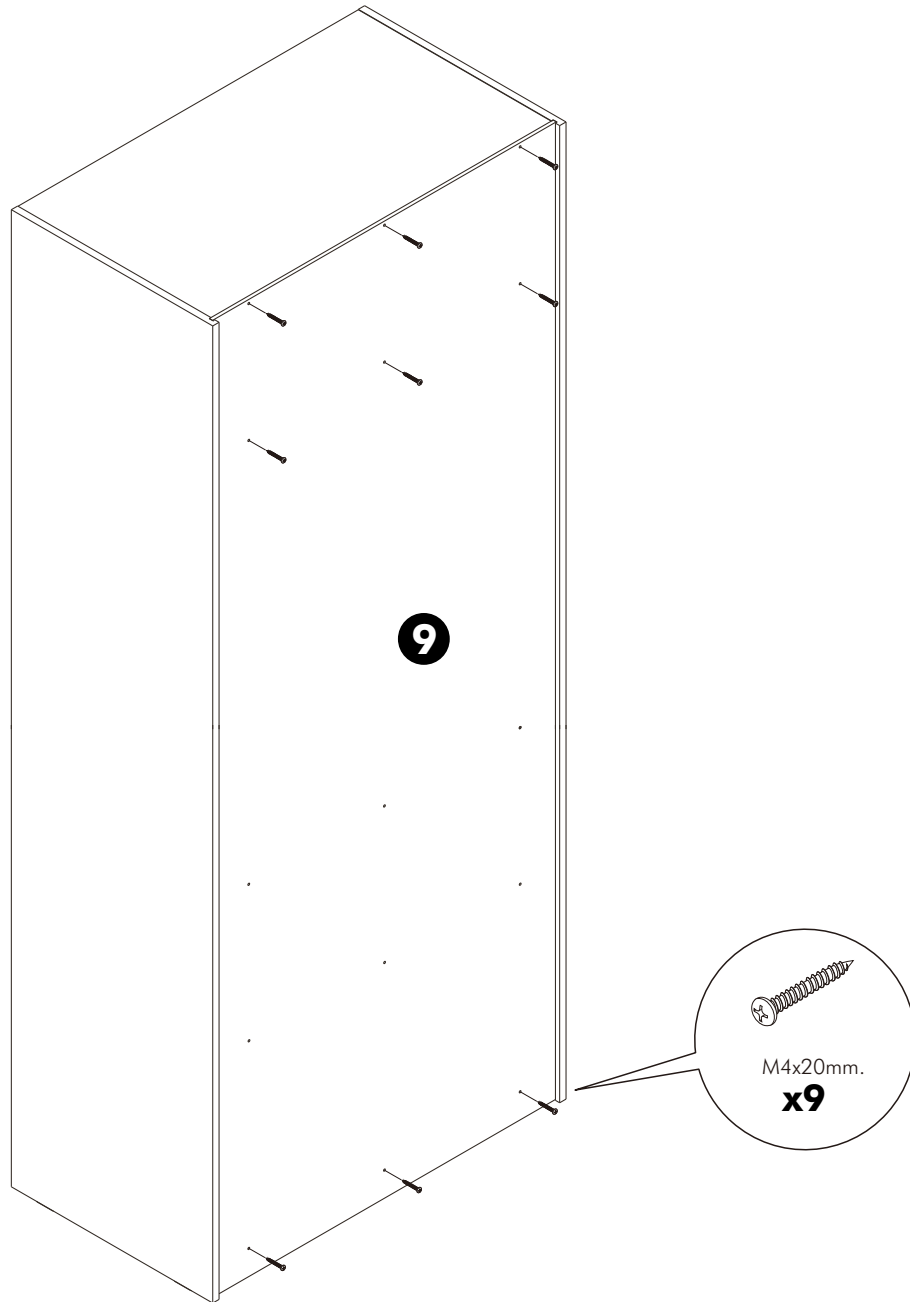

5.

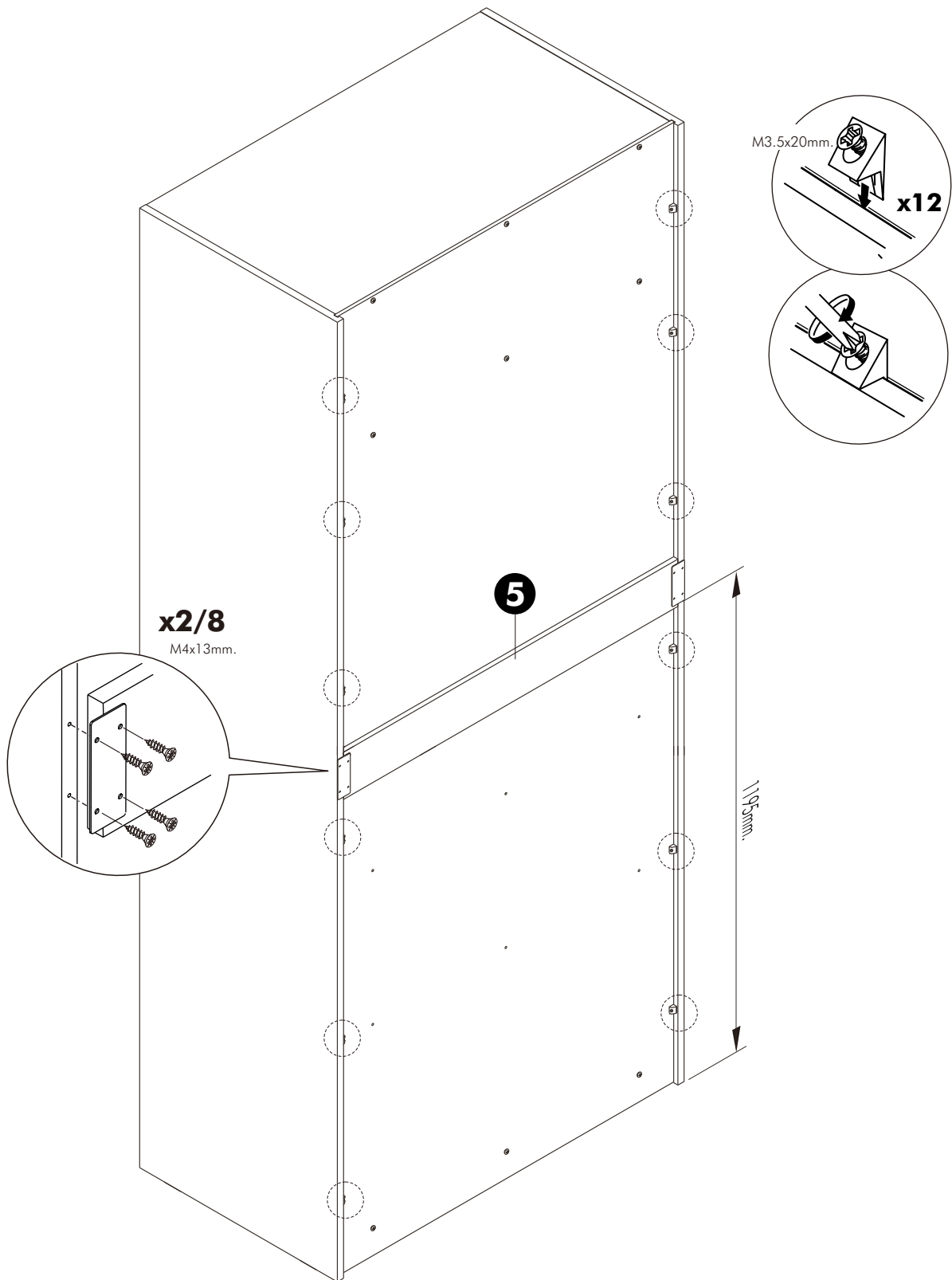

6.

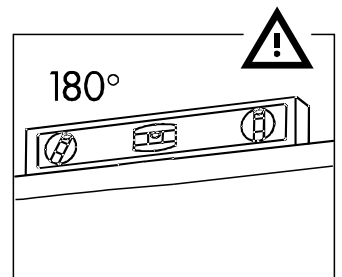
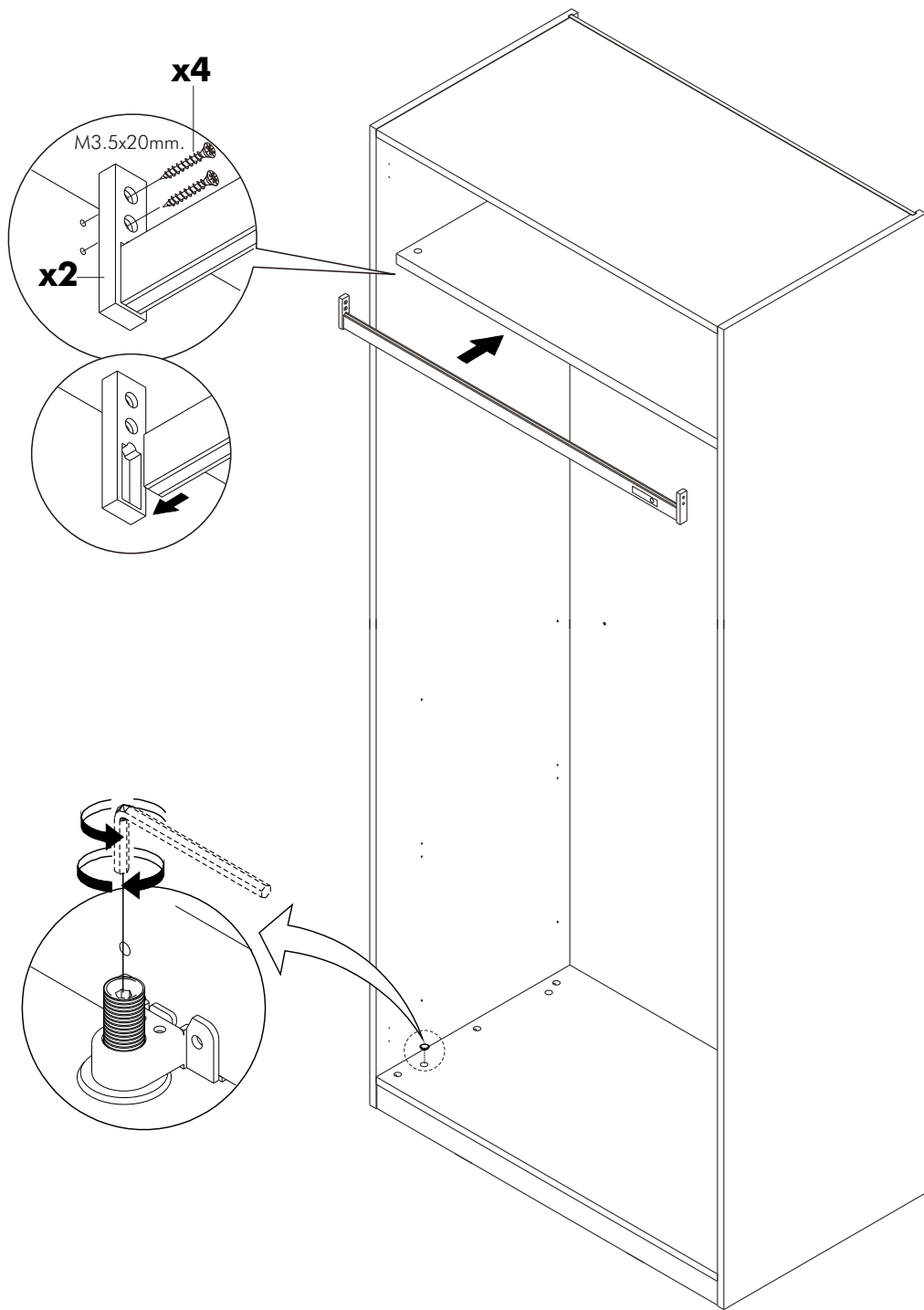

7.

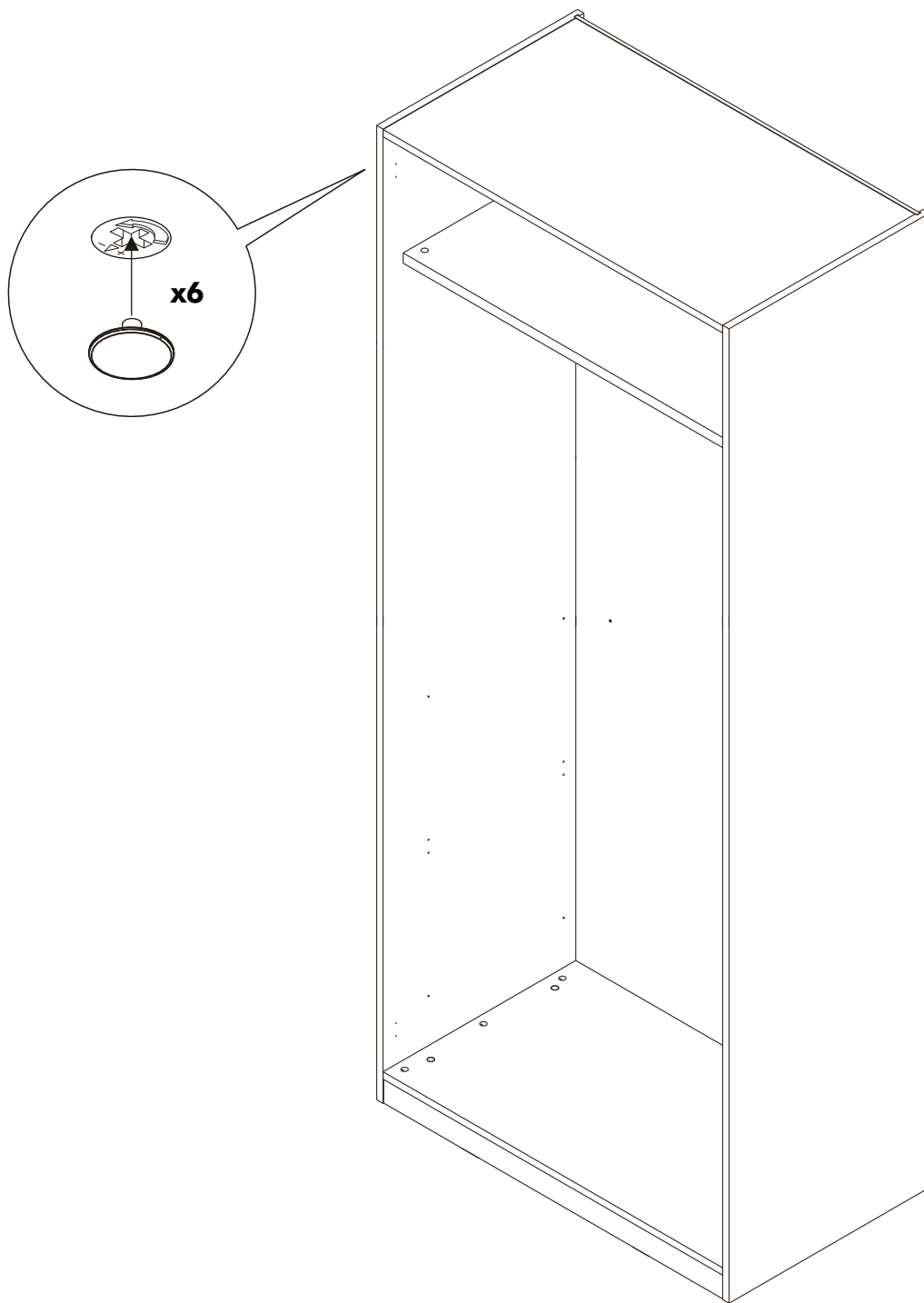

ASSEMBLY

-DRAWER SET

1.

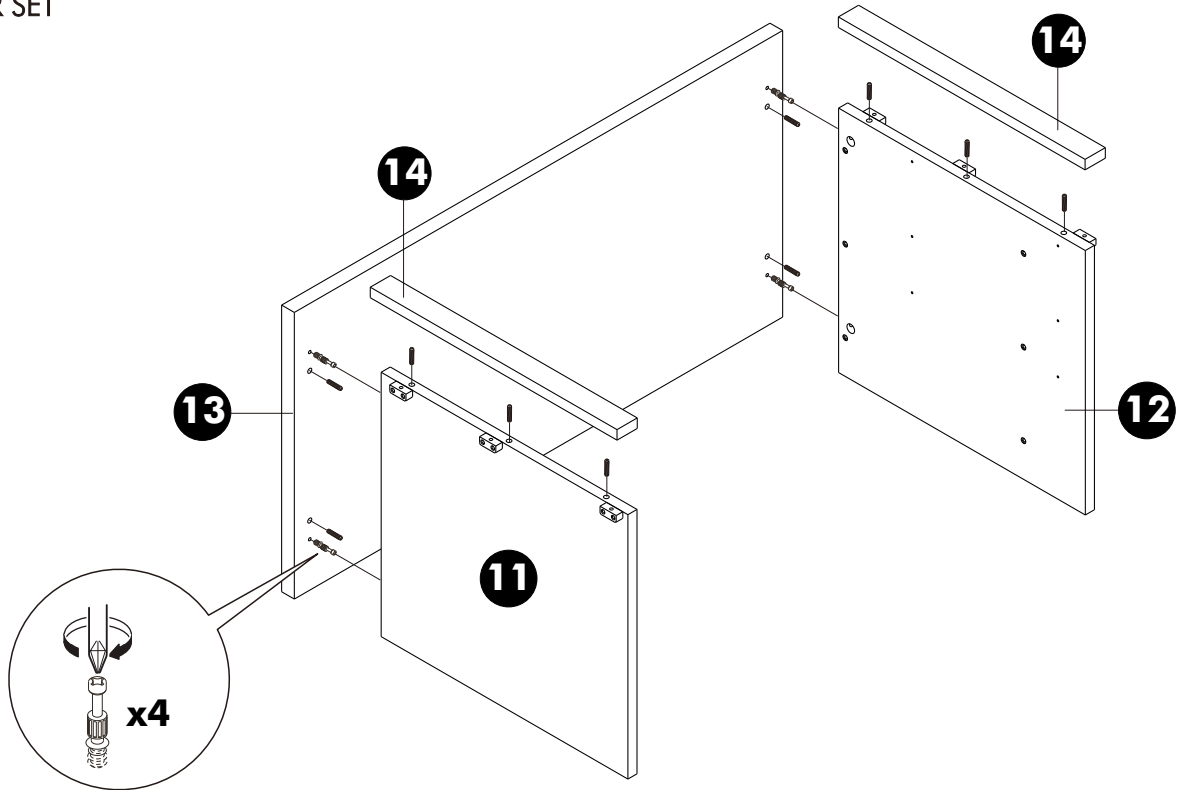

2.

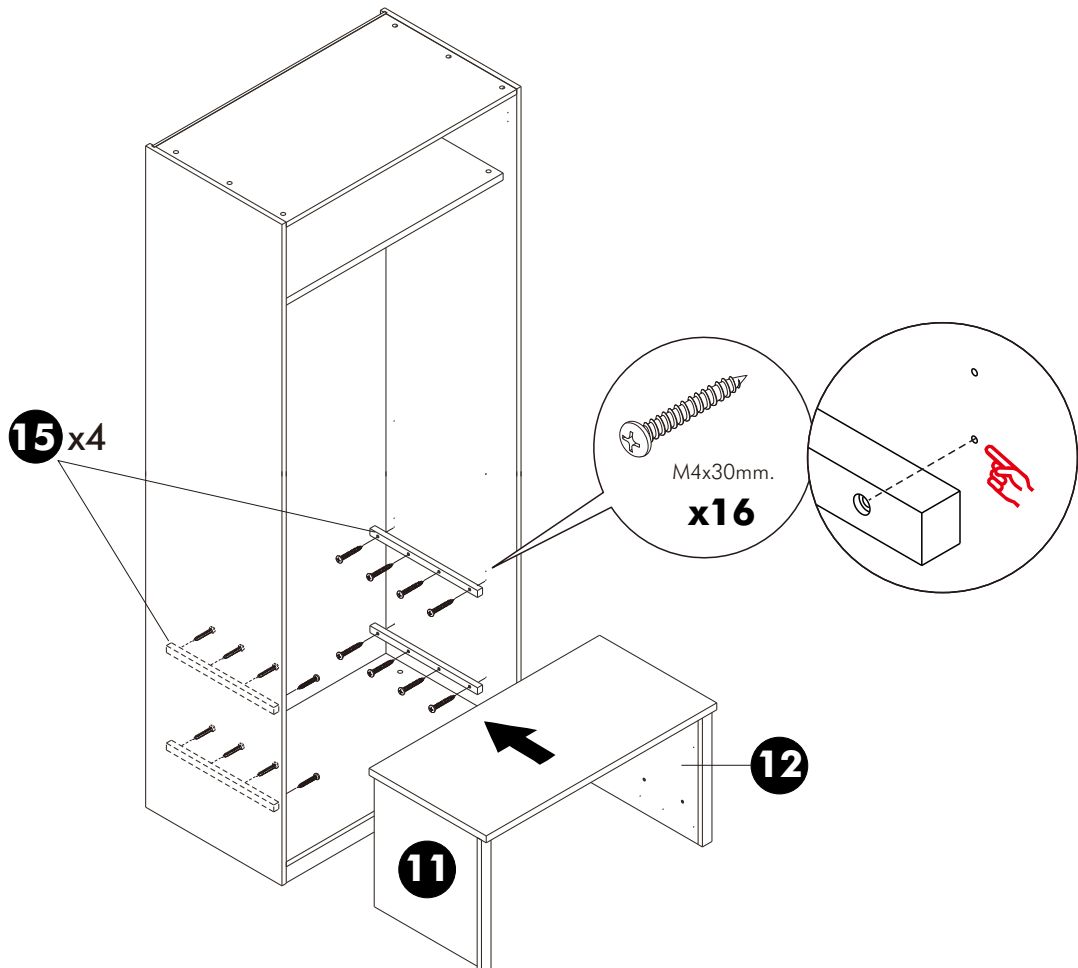

3.

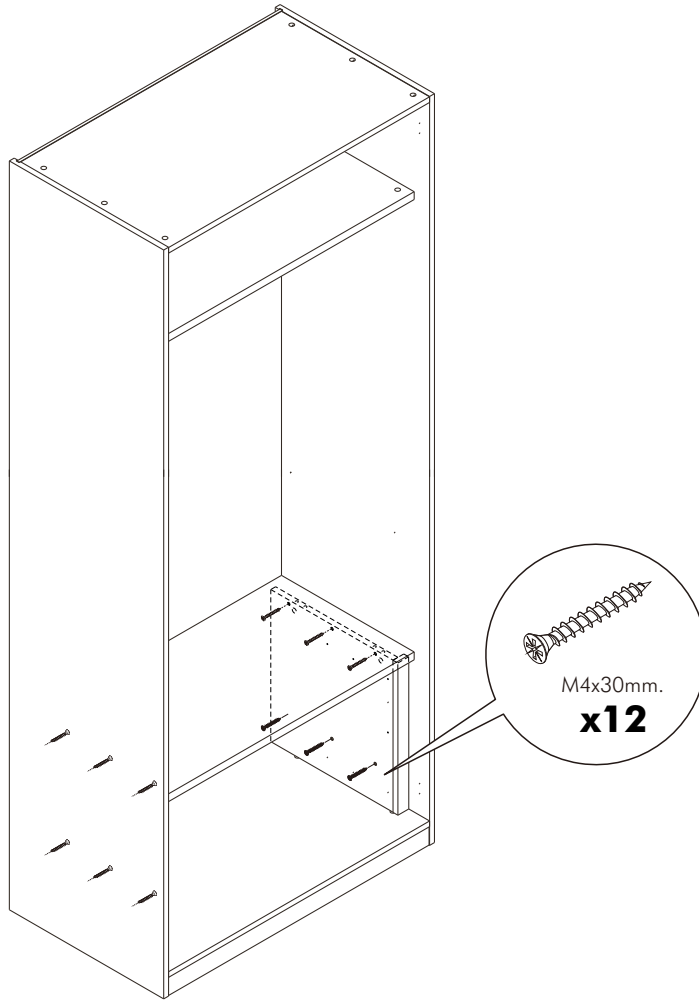

4.

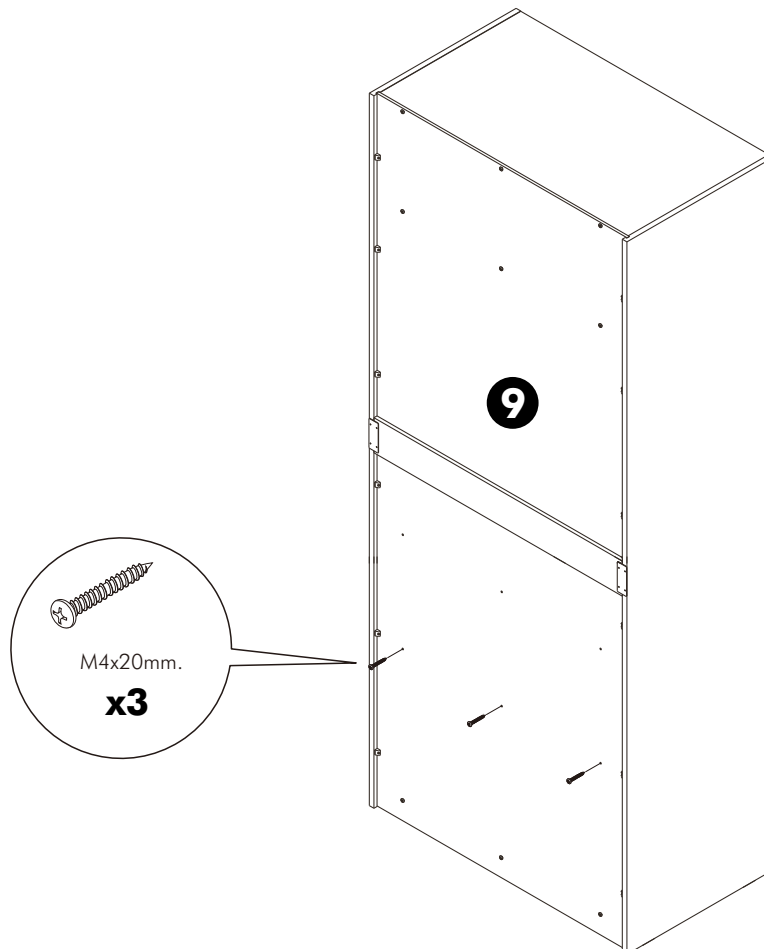

5.

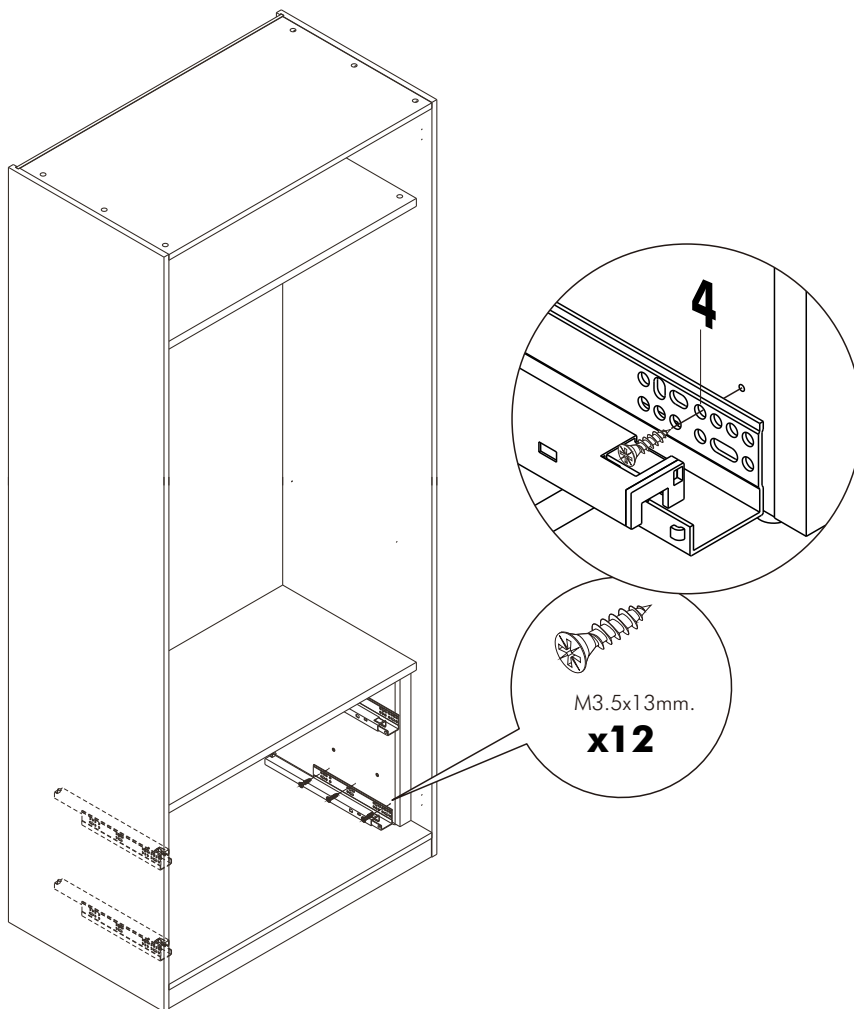

2.

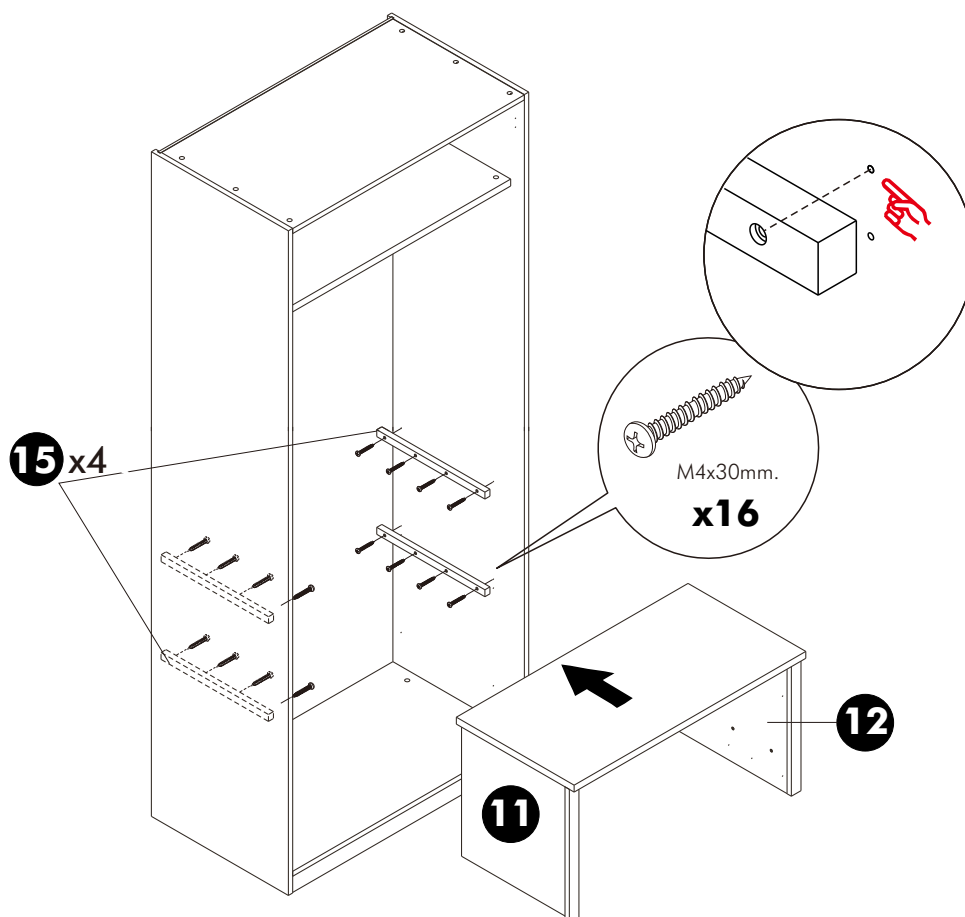
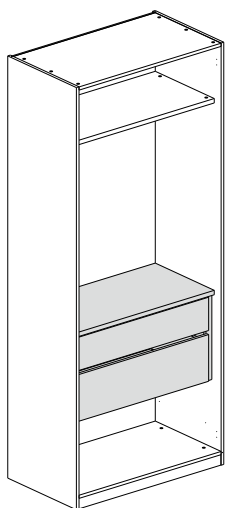

3.

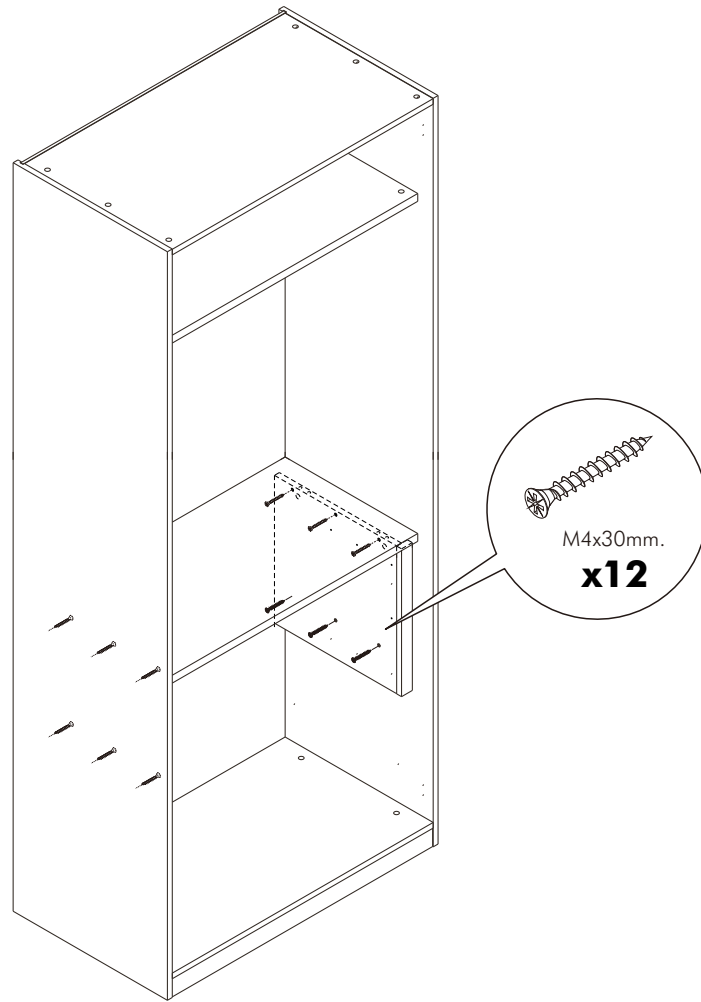

4.

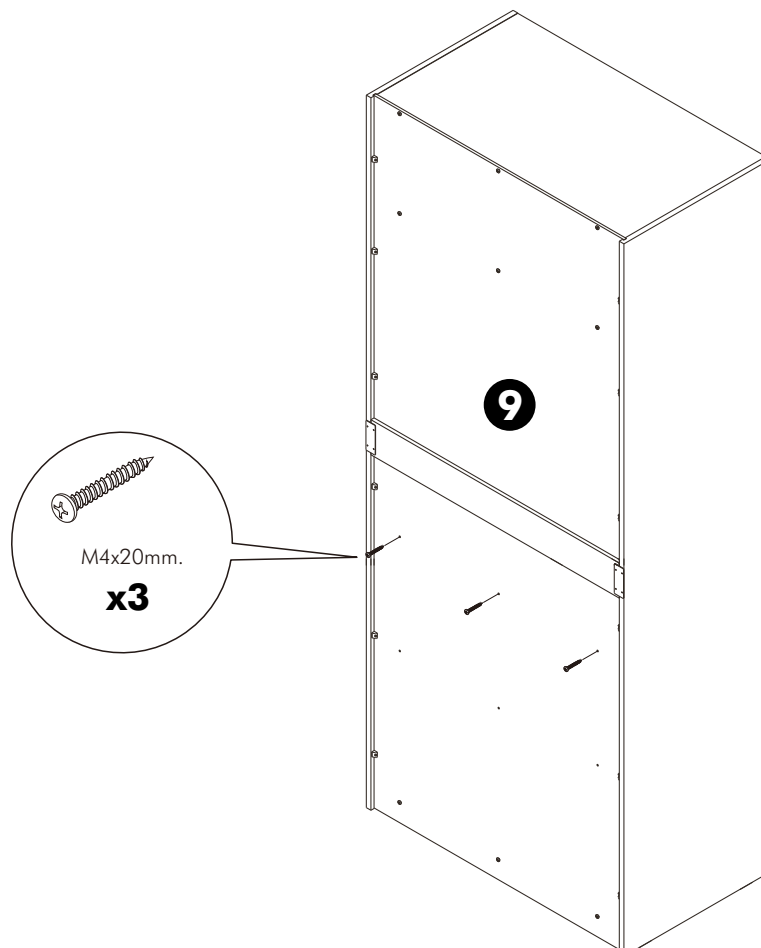

5.

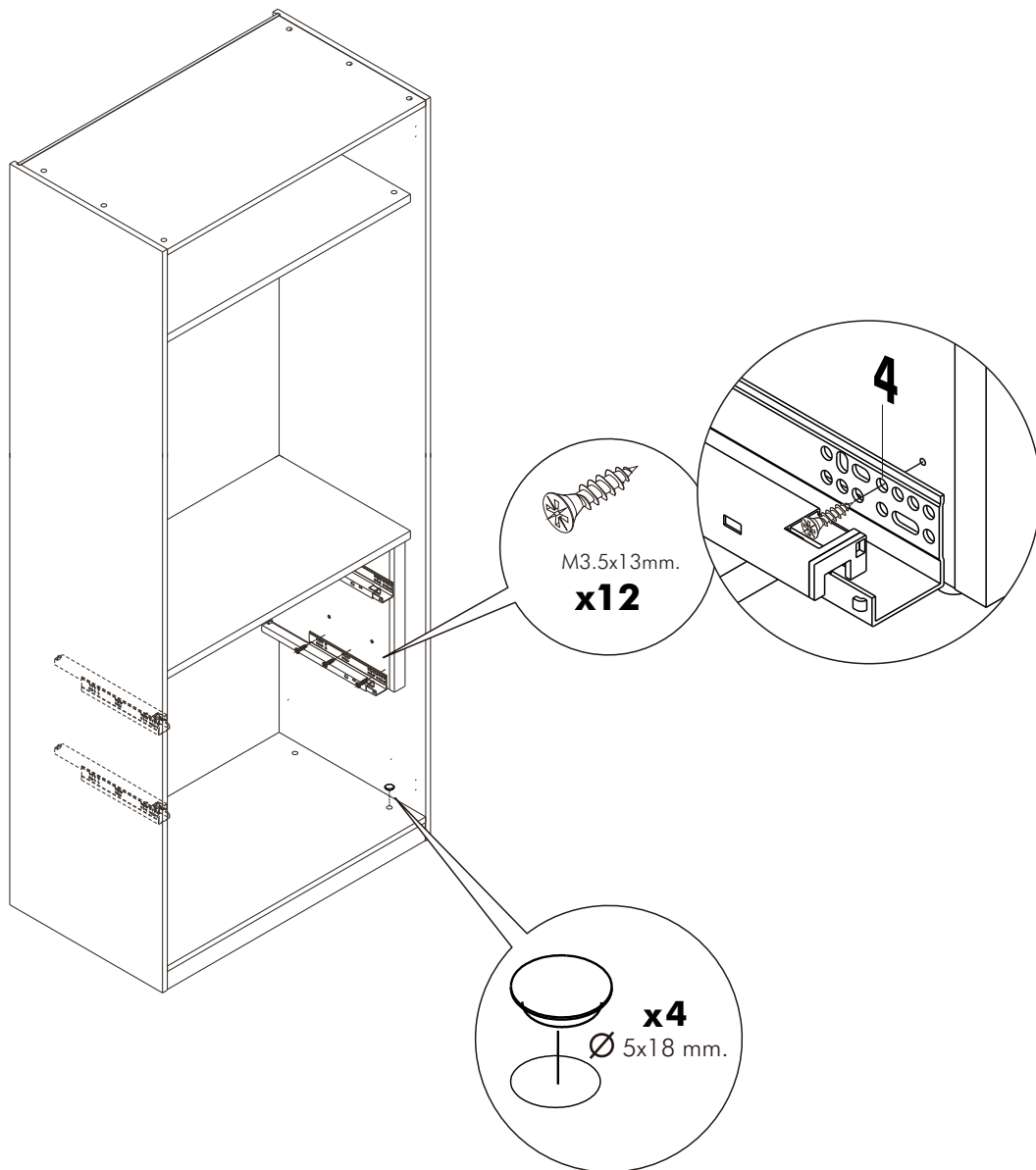

6.

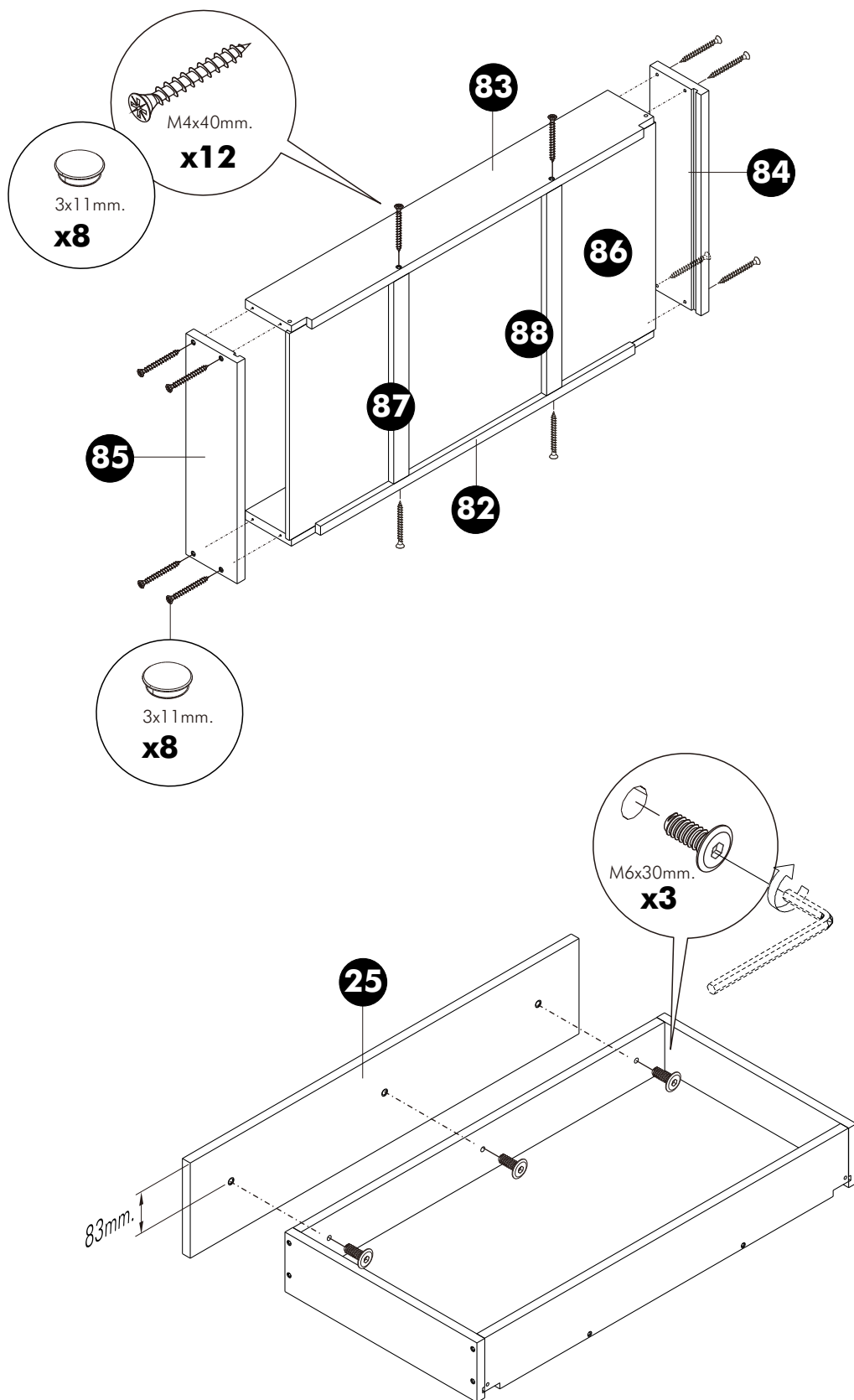

8.

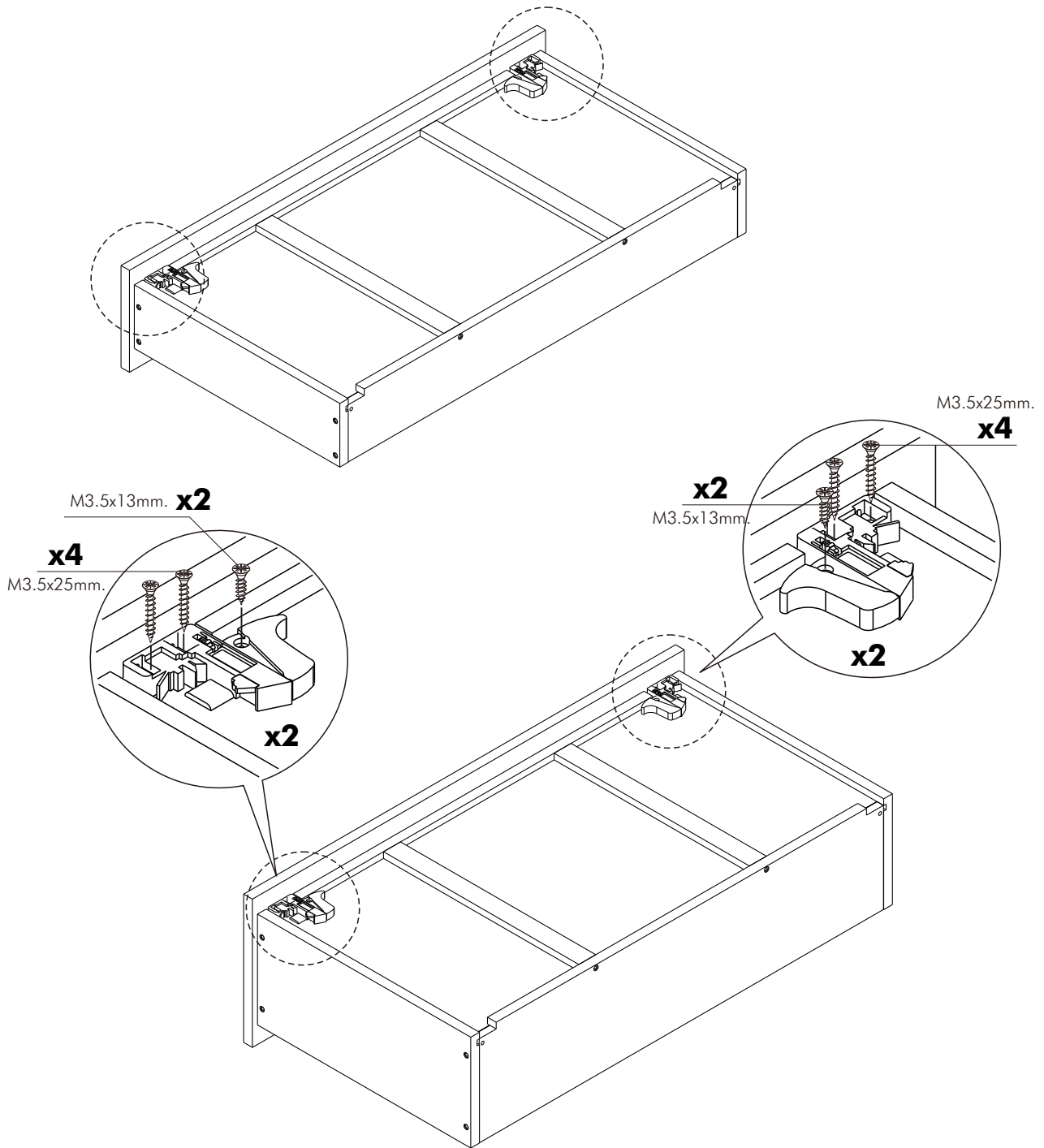

9.

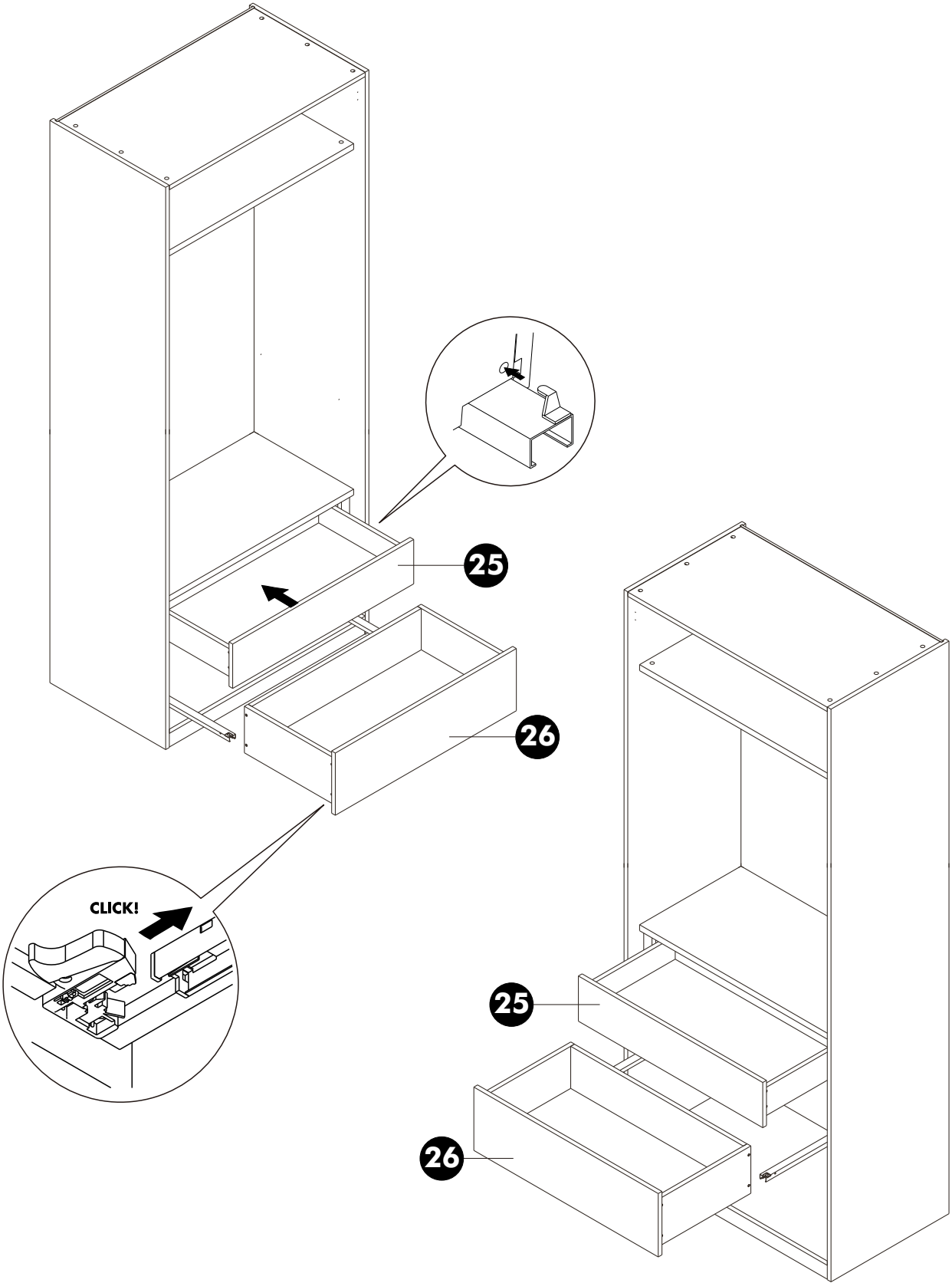



(สกรูสำหรับยึดแผ่นฟิลเลอร์อีก 1 ตัว
ให้ใช้สกรูที่ชุดฟิลเลอร์)

