

SERENE

Night table 50 cm.

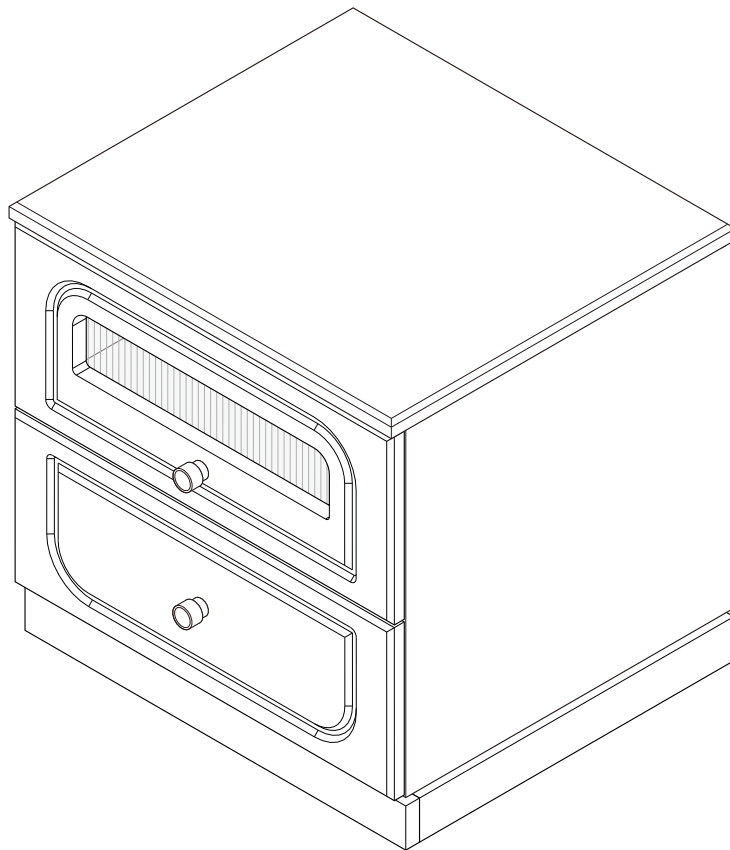

CONNECT SYSTEM

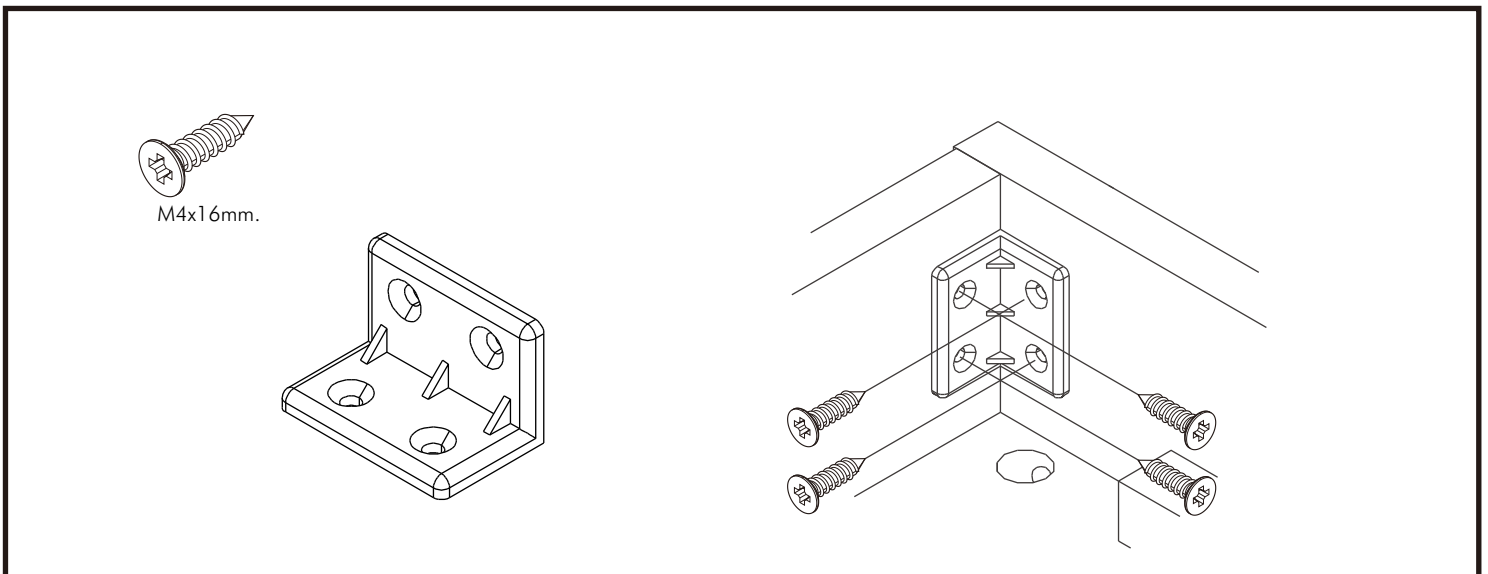
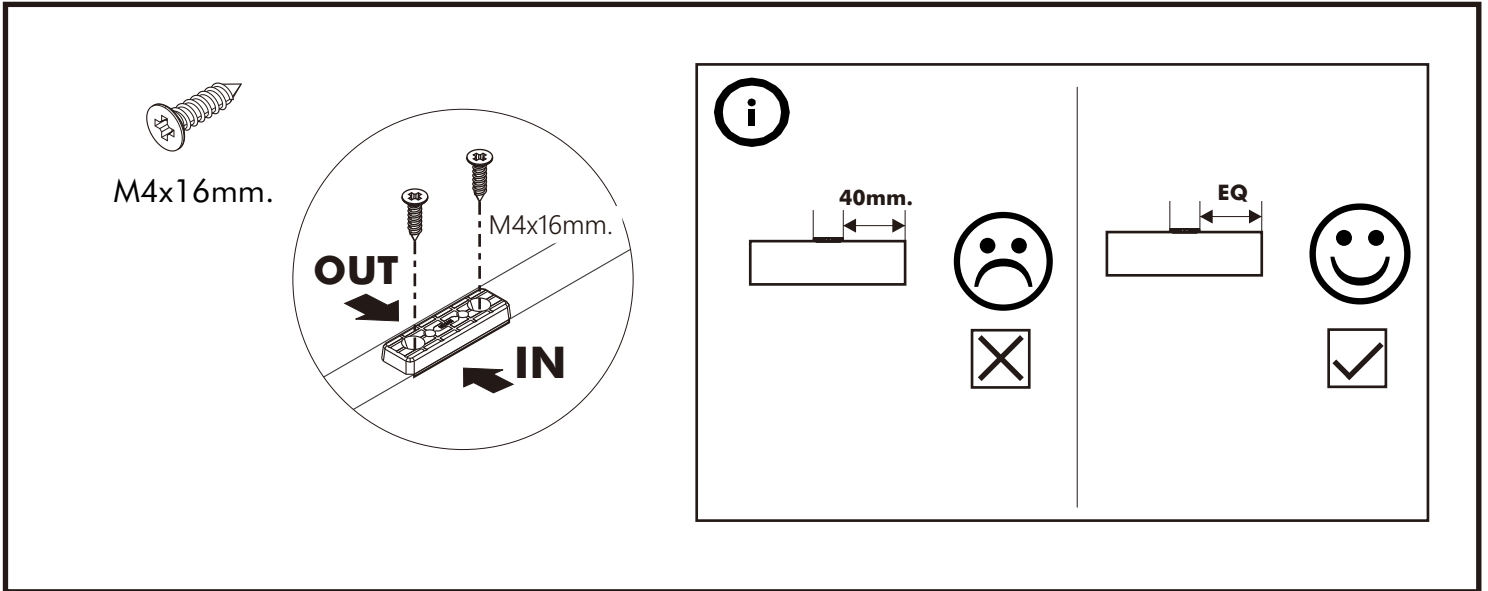
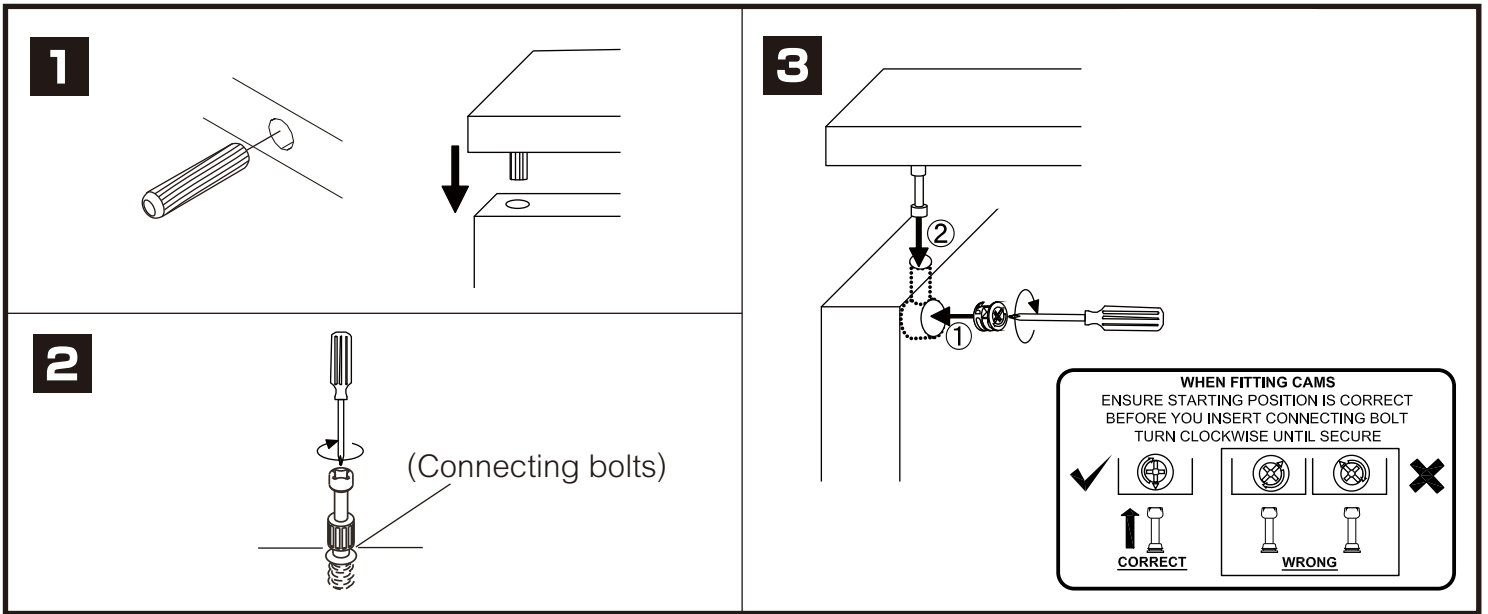

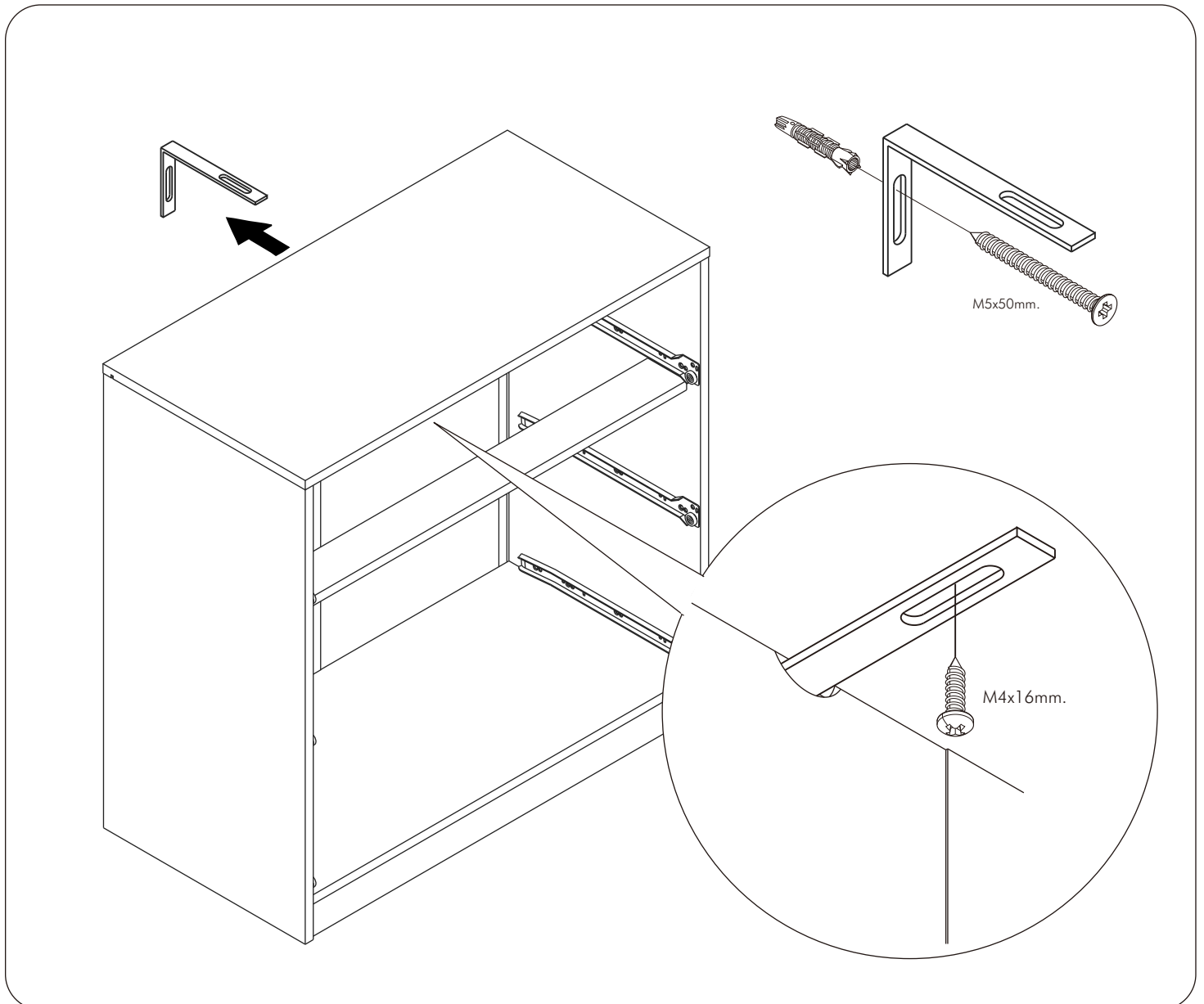
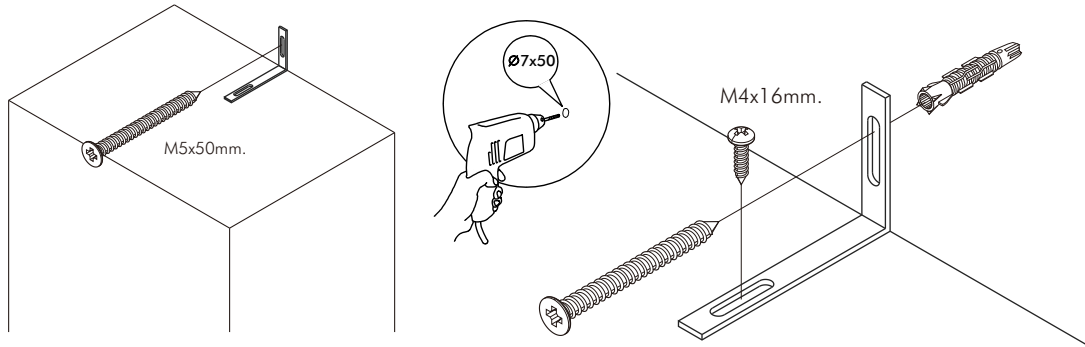
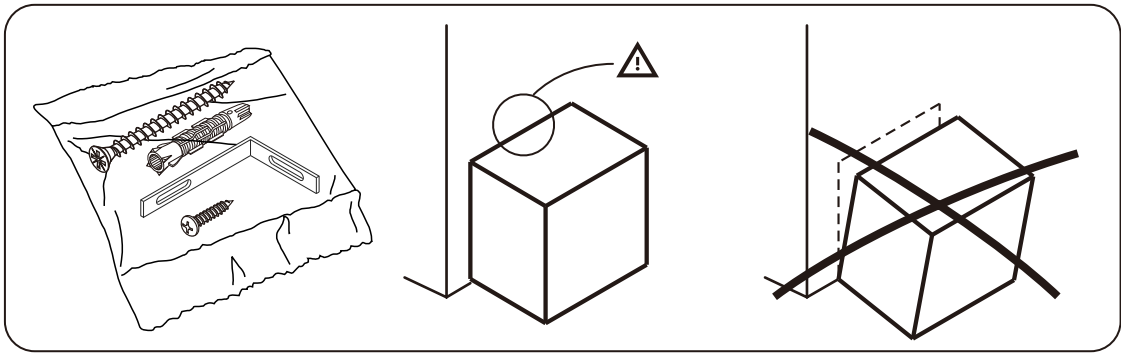

มาตรฐาน การระบุสินค้าที่ต้องยึด Fitting กันลื่น (Safety Fitting) ***หมายเหตุ สินค้าที่เป็นชุดเด็ก ให้ติดตั้ง Fitting กันลื่นทุกตัว***

■ หมวด ตู้บานเปิด / ตู้บานปิด + ช่องใส่

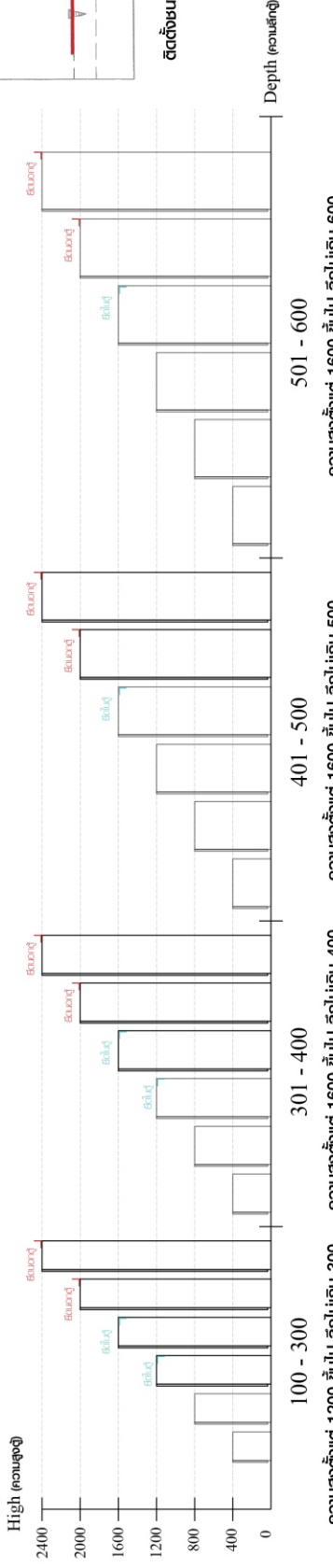

■ หมวด ตู้ลิ้นชัก / ตู้ลิ้นชัก + บานเปิด / ตู้ลิ้นชัก + บานสไลด์

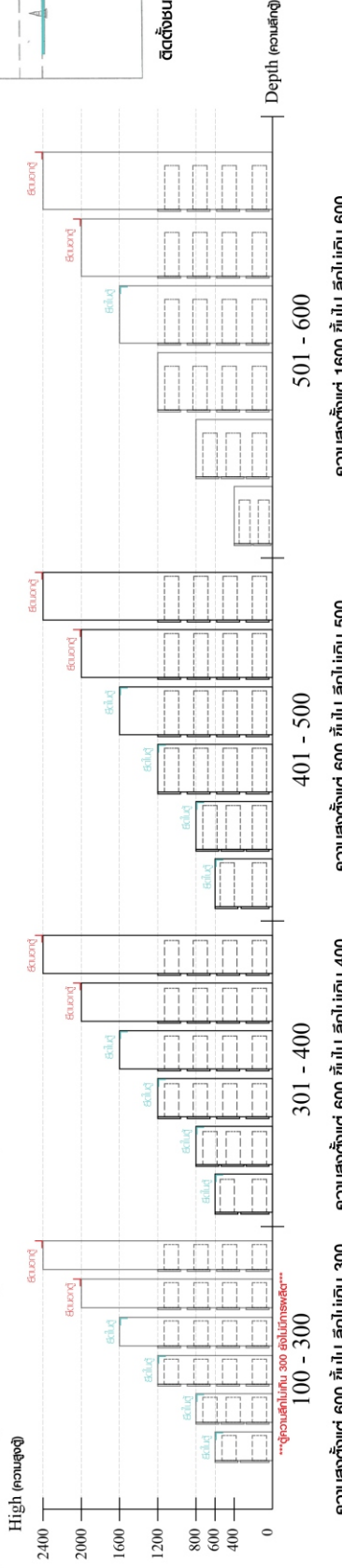

■ หมวด ตู้บานสไลด์ / ตู้ใส่

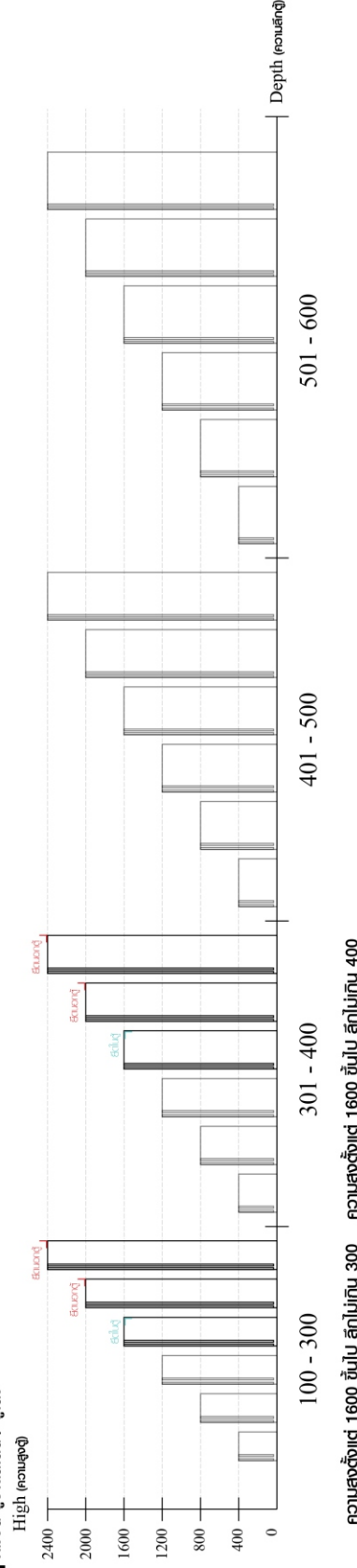

■ ติดตั้งฉากกันลื่นกับตู้สูง (ตั้งได้ 2 ม.ขึ้นไป)

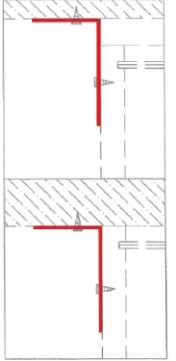

ติดตั้งบานเปิด

ติดตั้งบานปิด

■ ติดตั้งฉากกันลื่นกับตู้เตี้ย (น้อยกว่า 2 ม.)

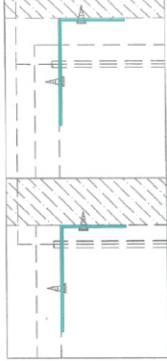

ติดตั้งบานเปิด

ติดตั้งบานปิด

HARDWARE

-BODY SET

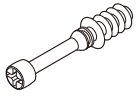

x 12



x 12

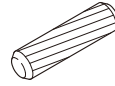

x 14

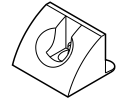

x 4

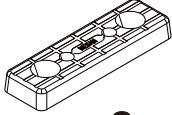

x 8

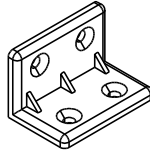

x 12



x 2

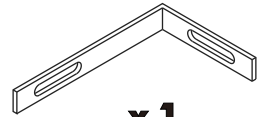

x 1

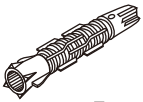

x 1



M3.5x20mm.

x 4



M4x16mm.

x 64



M5x50mm.

x 1



M4x16mm.

x 1



M4x30mm.

x 6

-DRAWER SET

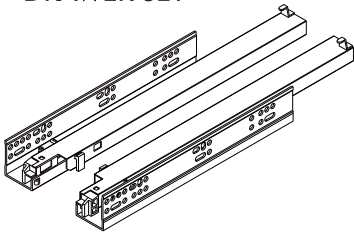

x 2 set



M3.5x13mm.

x 12

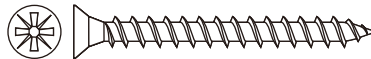

M4x40mm.

x 18

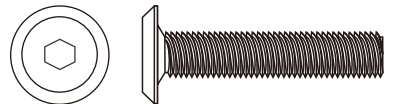

M6x30mm.

x 2

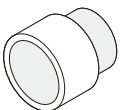

x 2

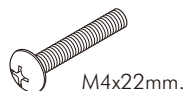

M4x22mm.

x 2

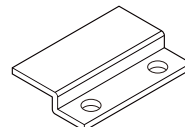

x 4

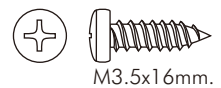

M3.5x16mm.

x 8



x 4



x 8

ASSEMBLY

-BODY SET

1.

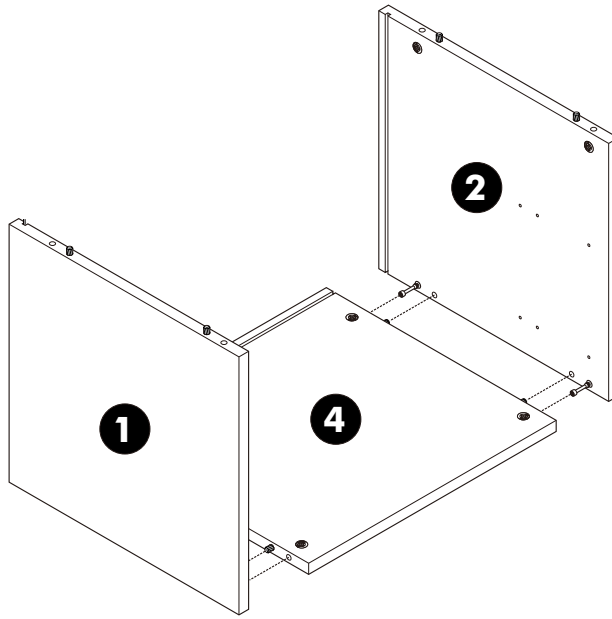

2.

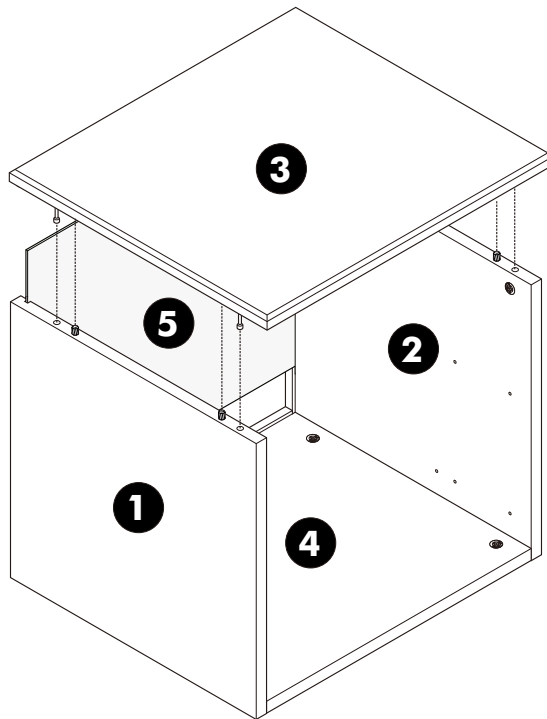

3.

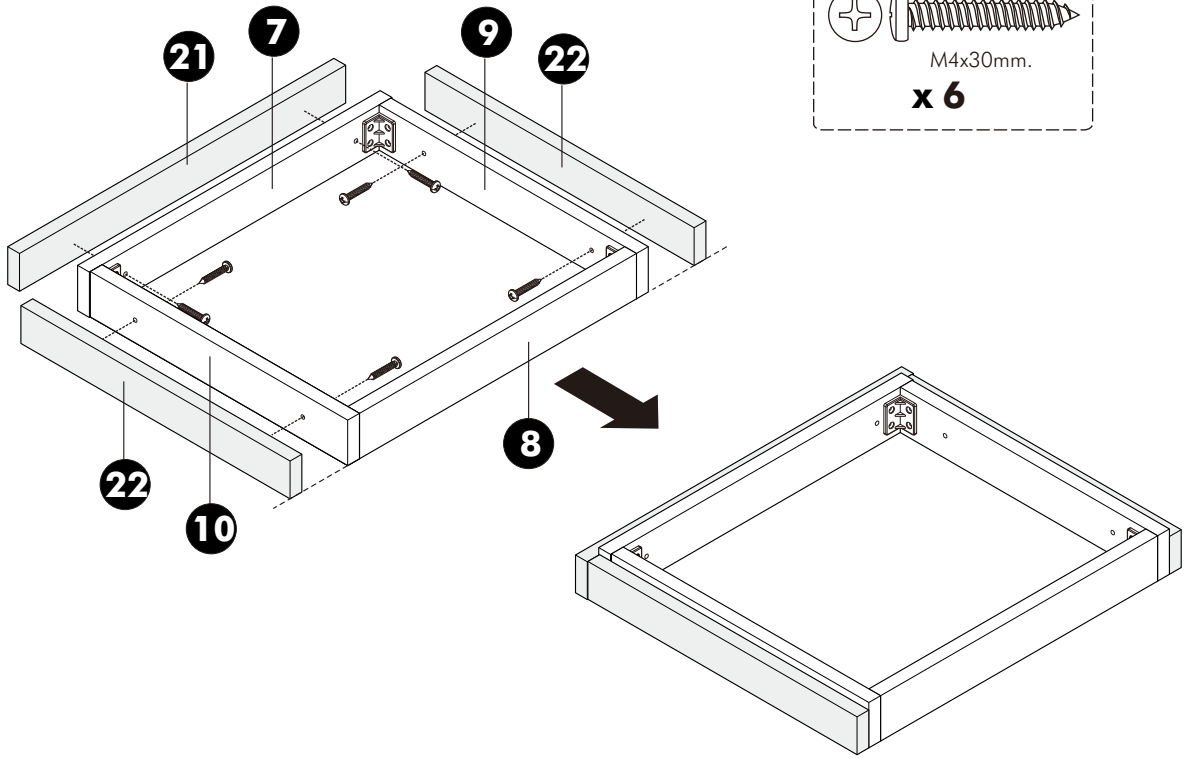

4.

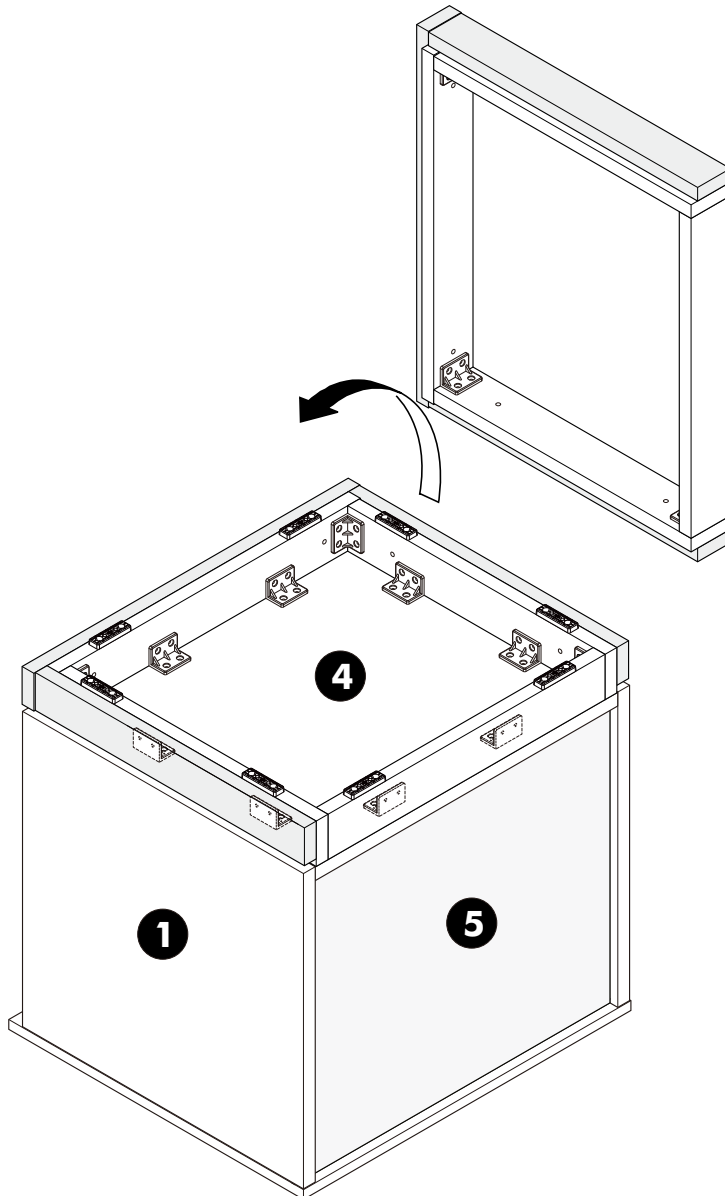

5.

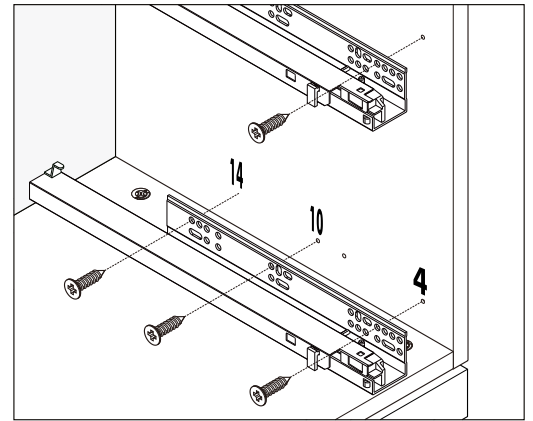
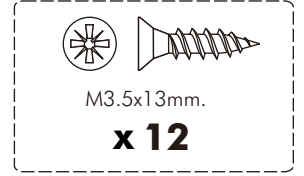
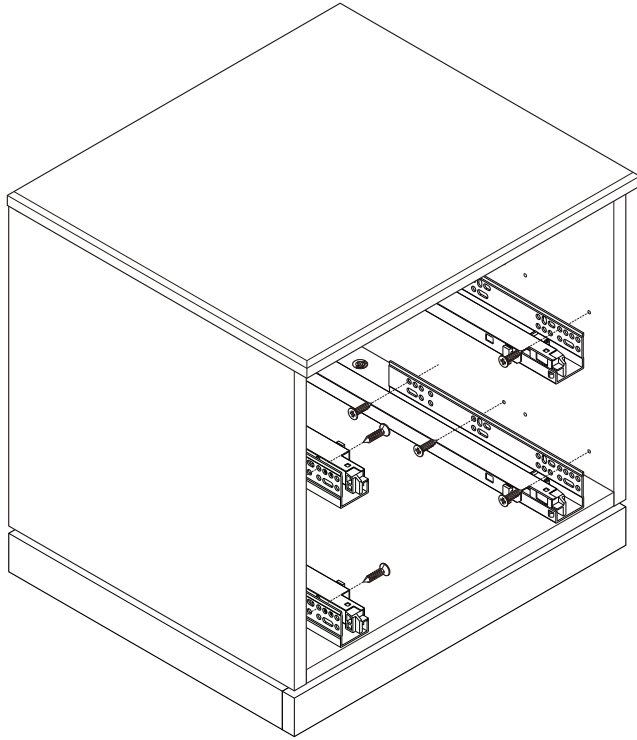

6.

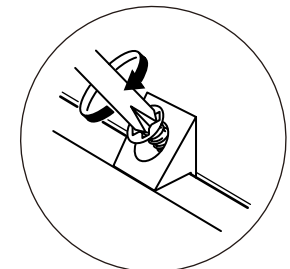
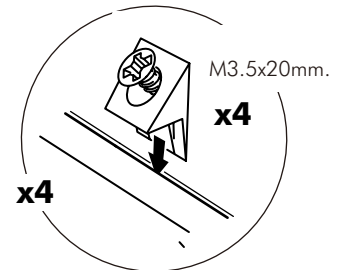
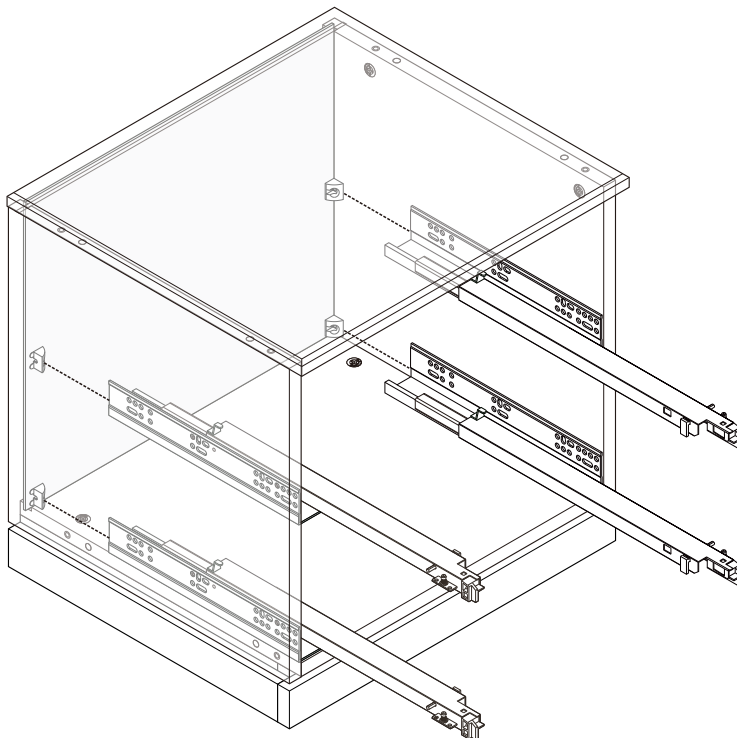

ASSEMBLY

-DRAWER SET

1.

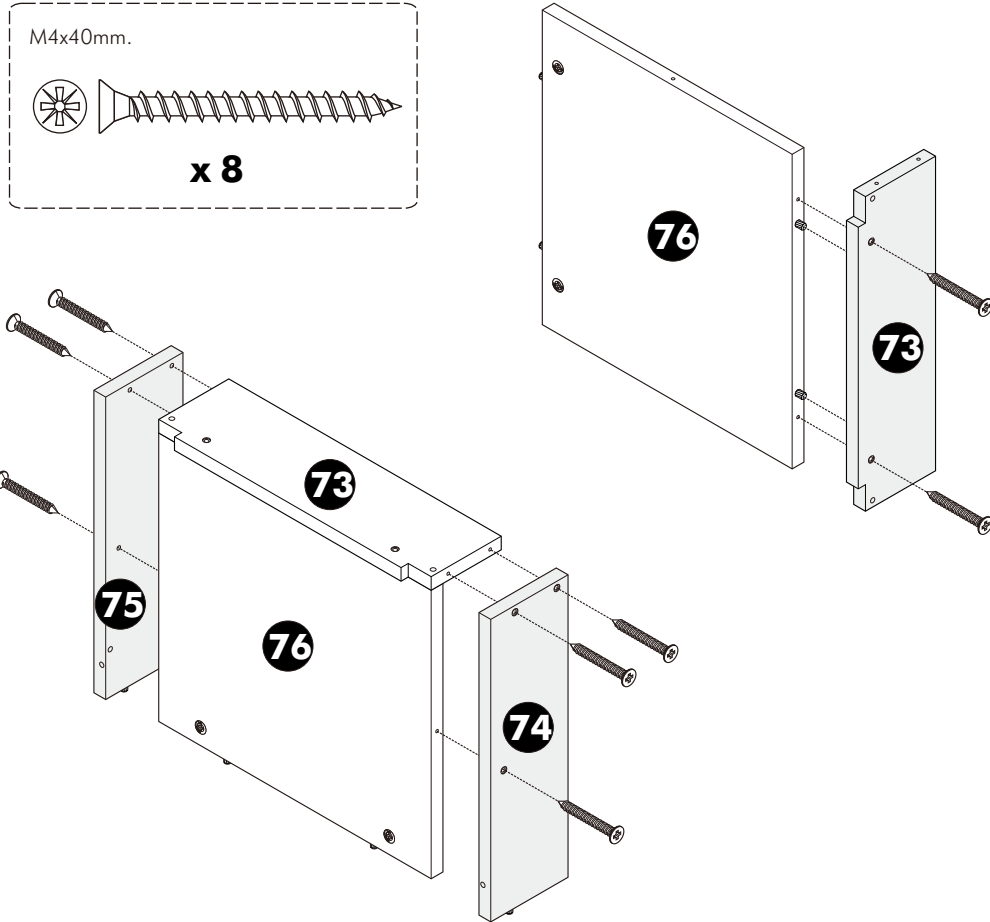

2.

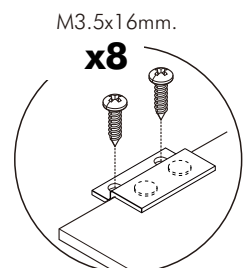
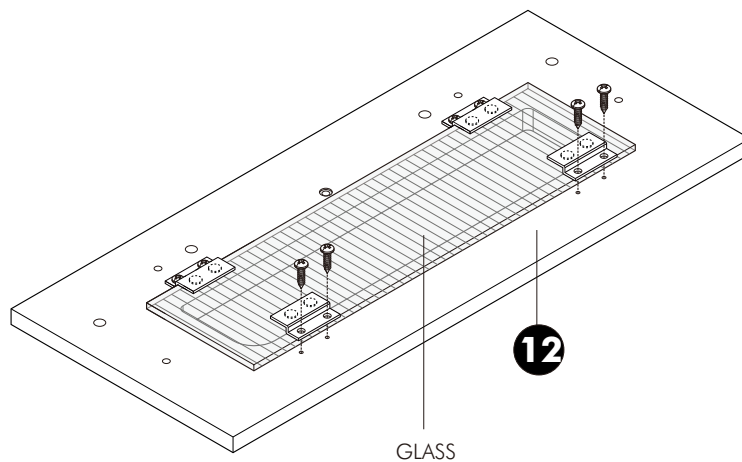
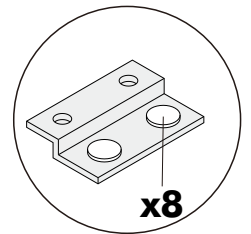
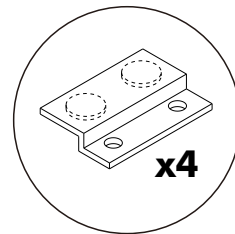
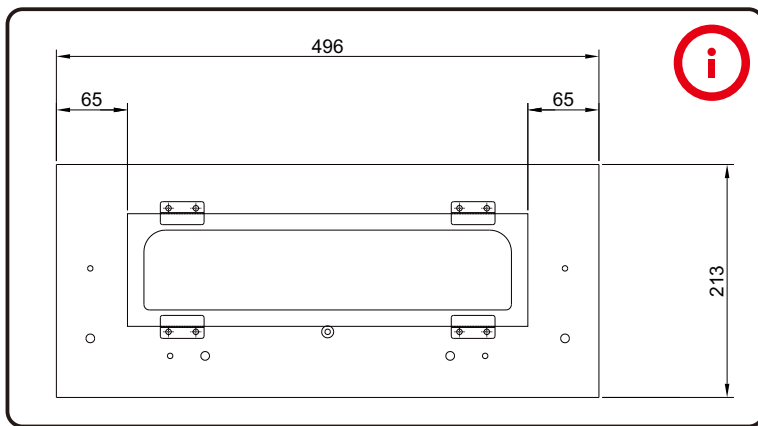

3.

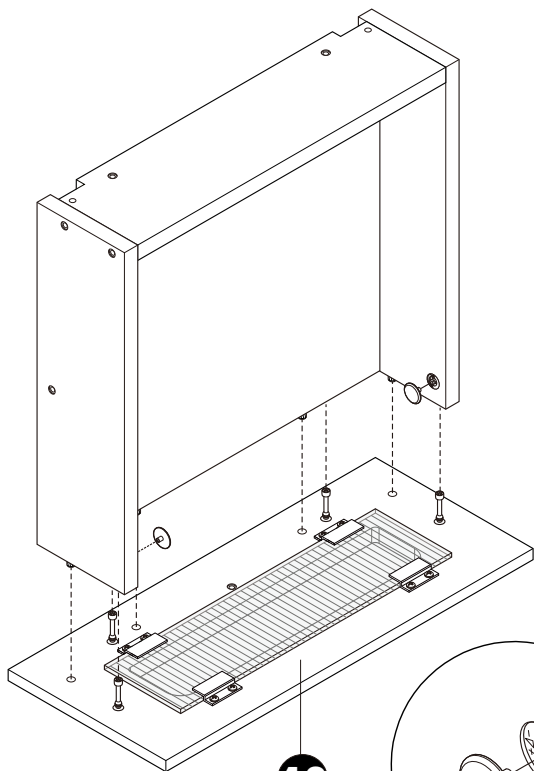

12

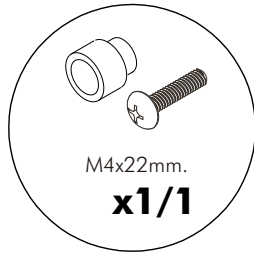

M4x22mm.
x1/1

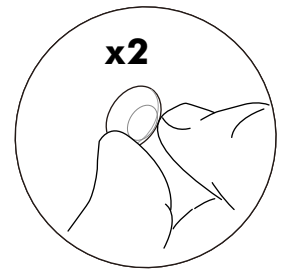

x2

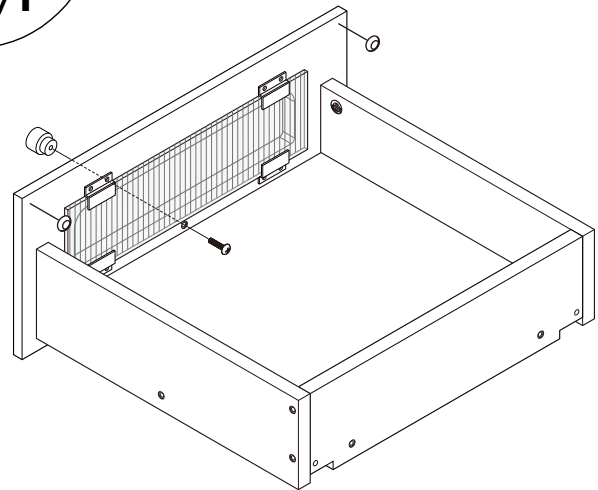

2.

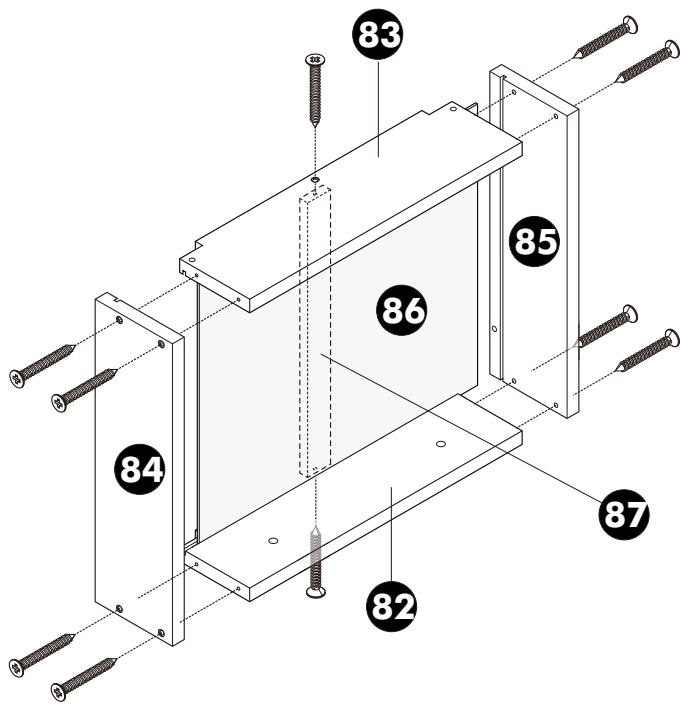

83

85

86

84

87

82

M4x40mm.

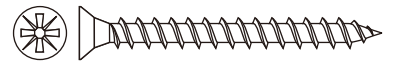

x 10

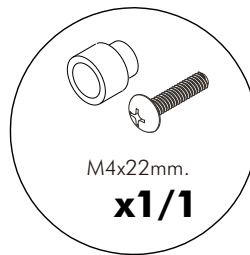

M4x22mm.
x1/1

M6x30mm.

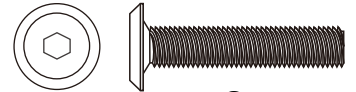

x 2

13

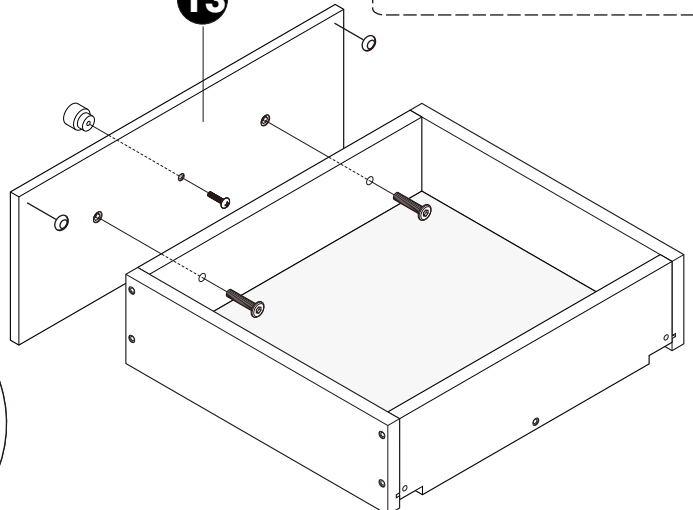

x2

5.

