

BRONX PLUS

Night Table 58 cm

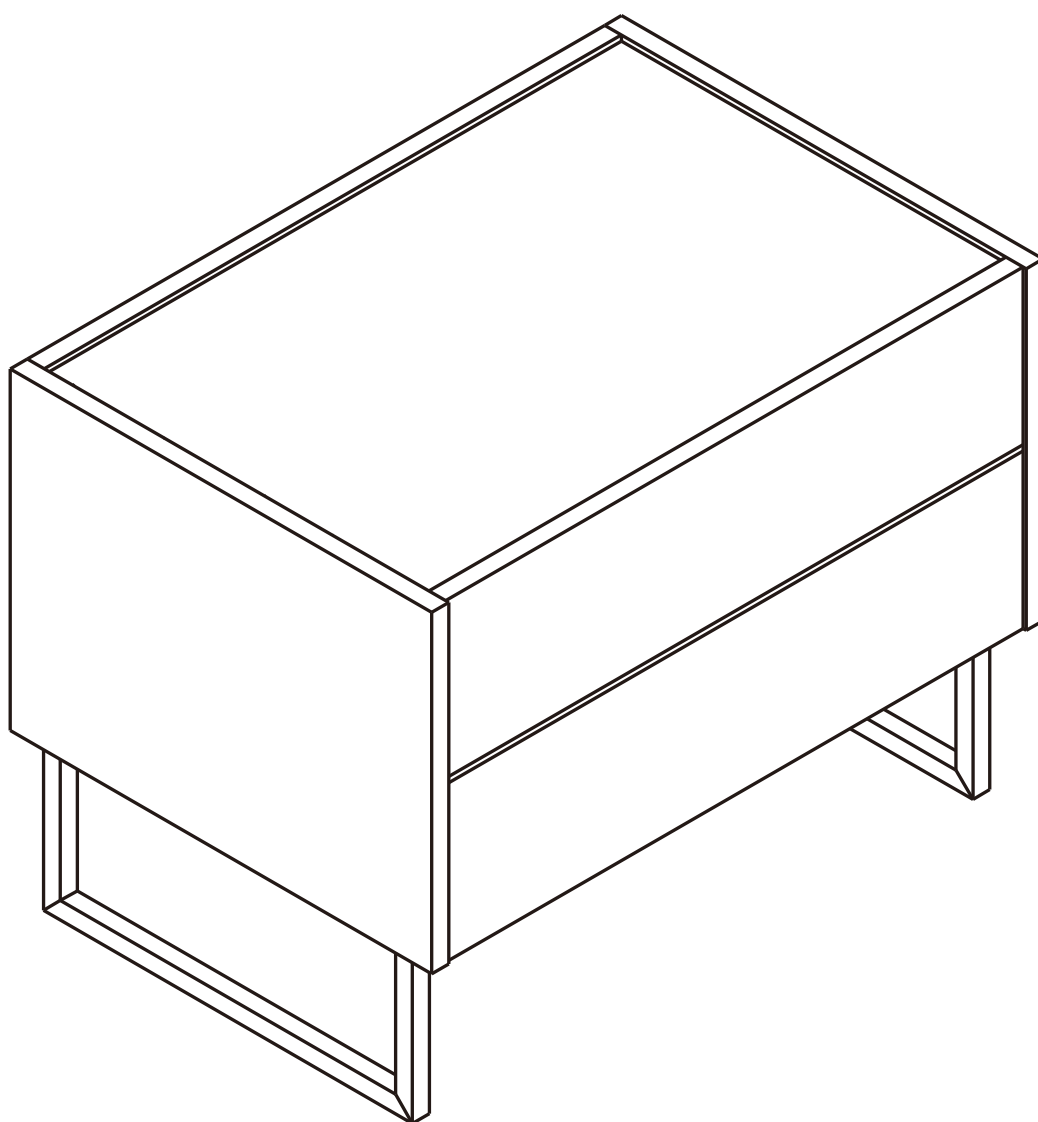

CONNECT SYSTEM

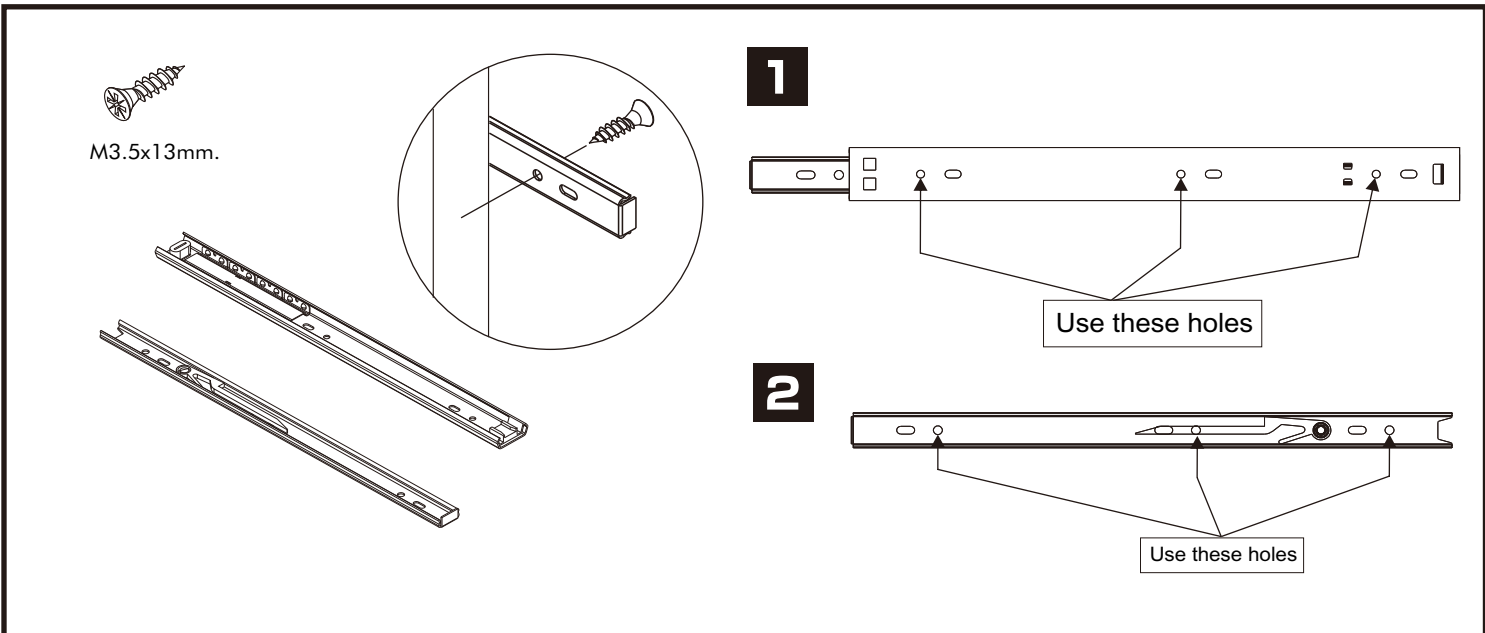
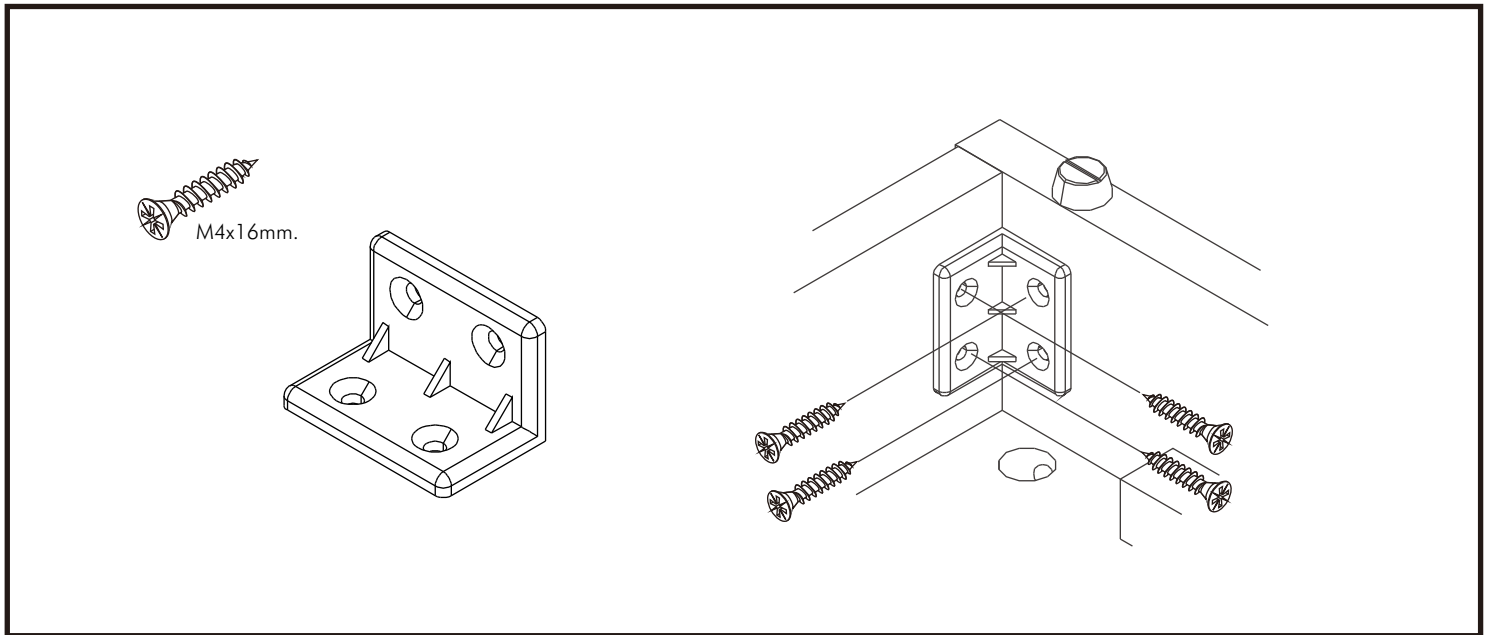
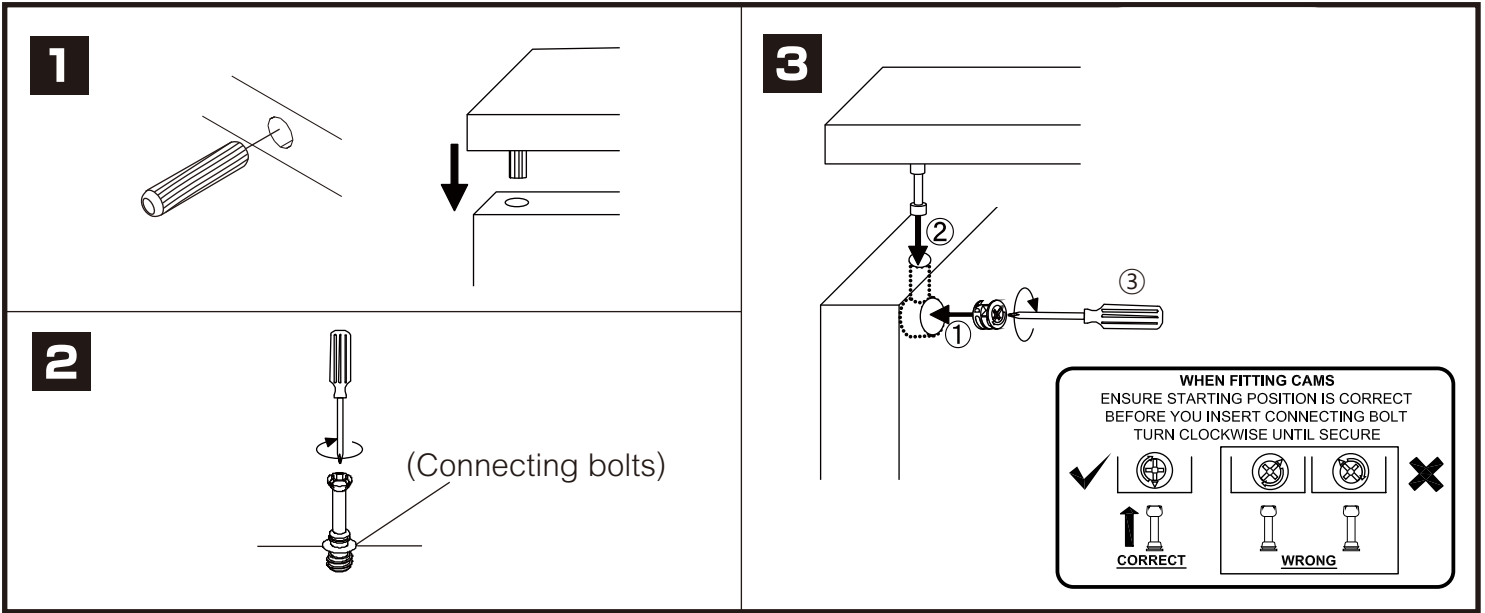

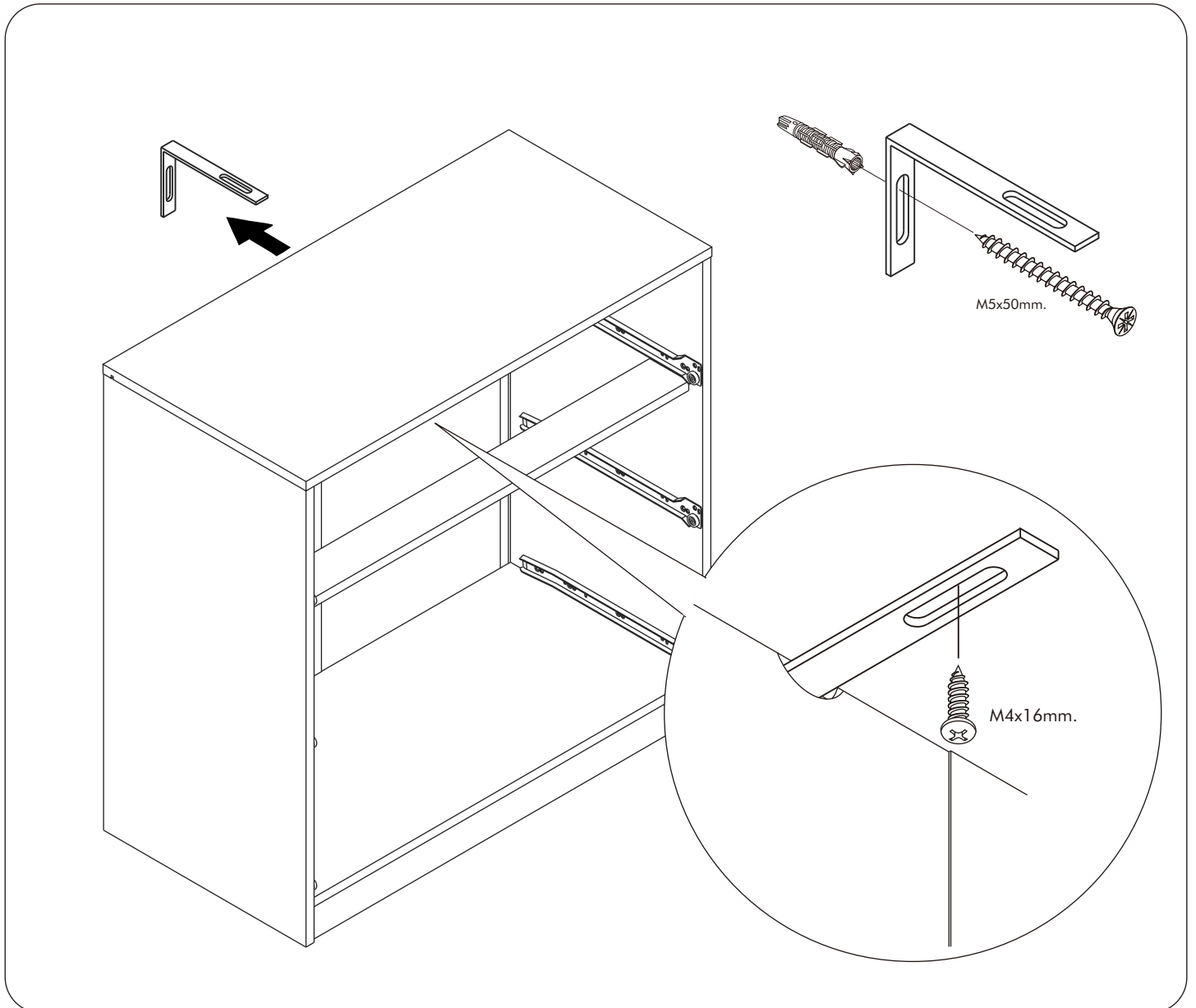
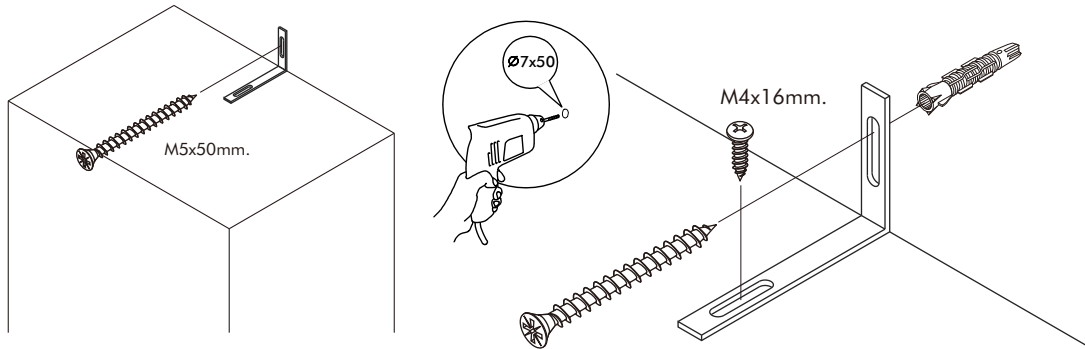
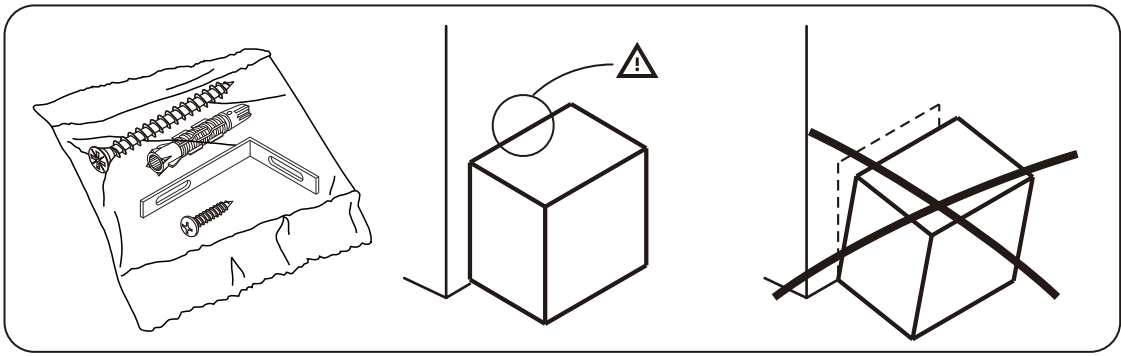

■ **The Standard for identifying which mounted safety fall protection fitting to use** **Note : That children's products must be installed with all anti-falling fittings.**

■ Mounted fall protection fittings

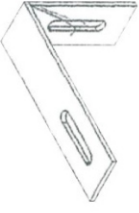

■ **Category : Cabinet with open doors**

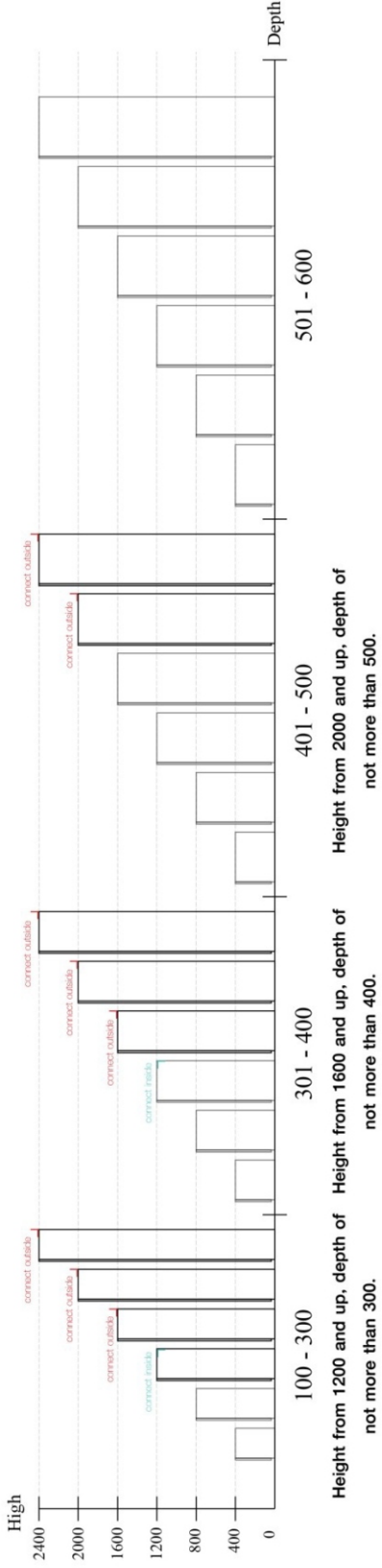

■ **Category : Chest of drawers**

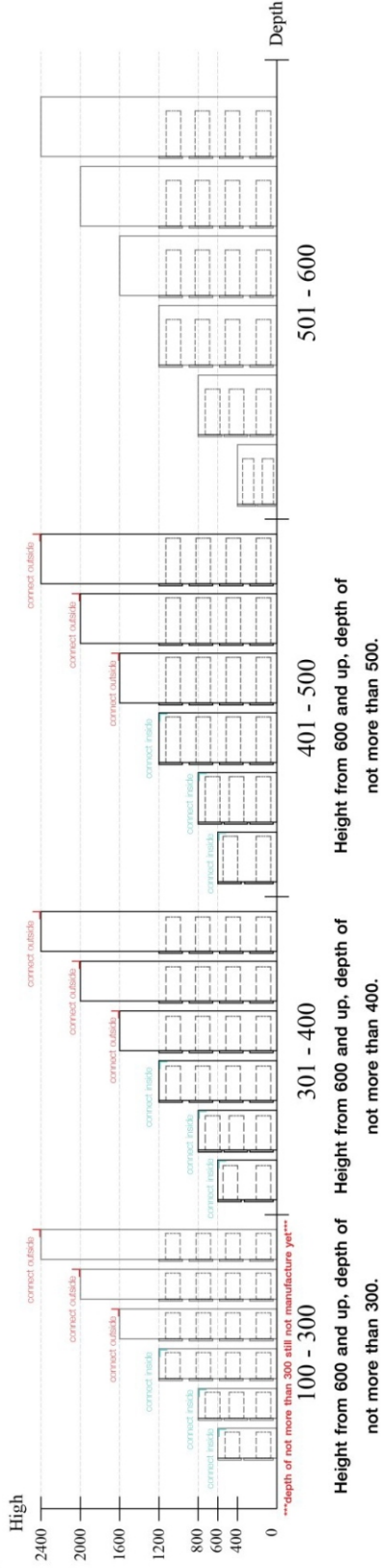

■ **Category : Sliding door cabinet / Open cabinet**

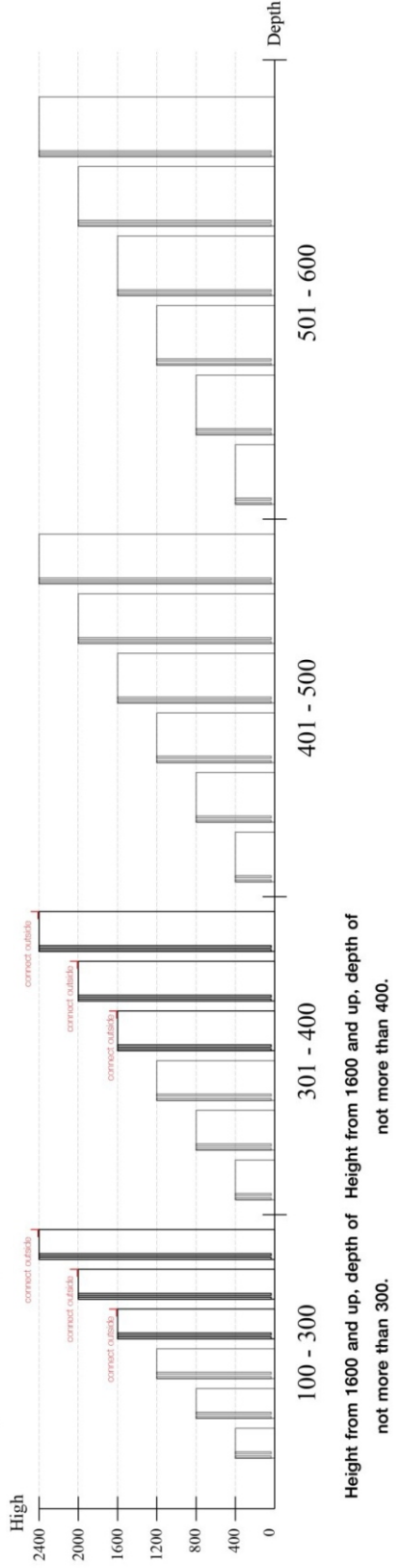

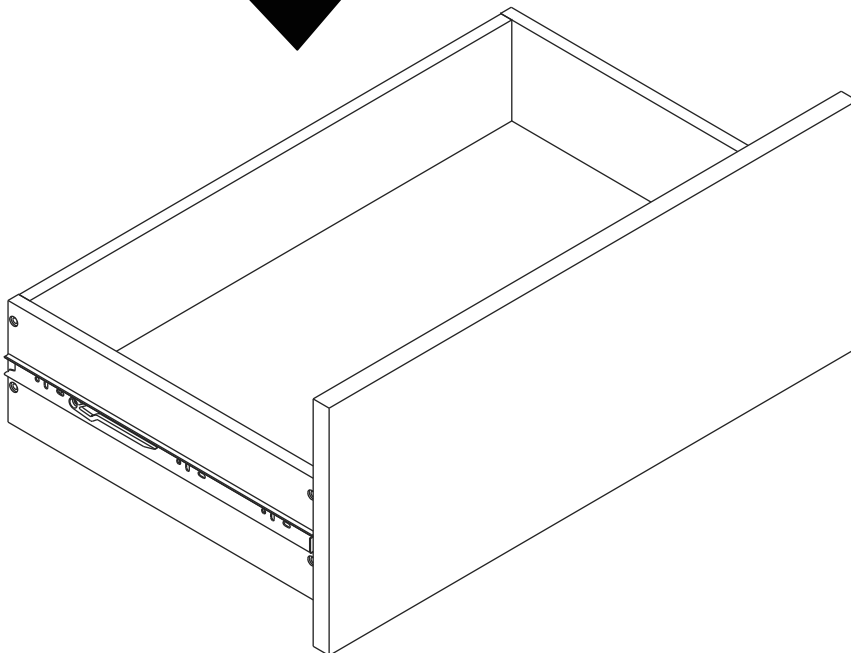
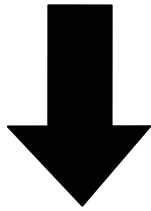
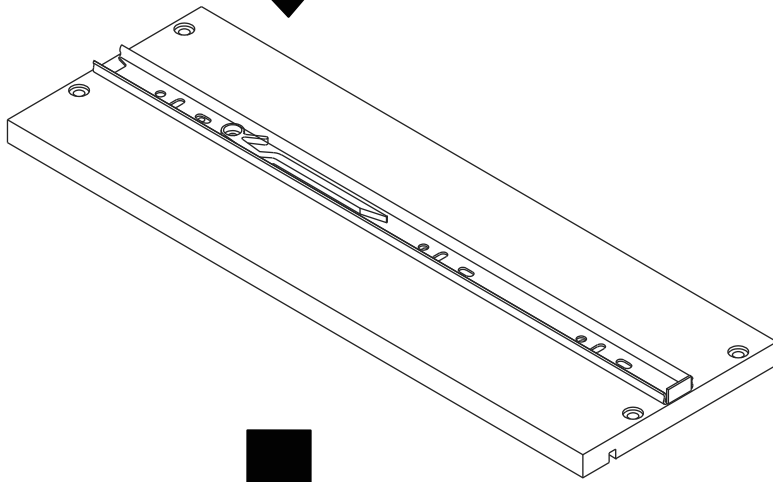
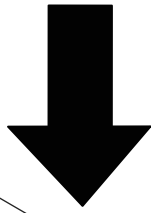
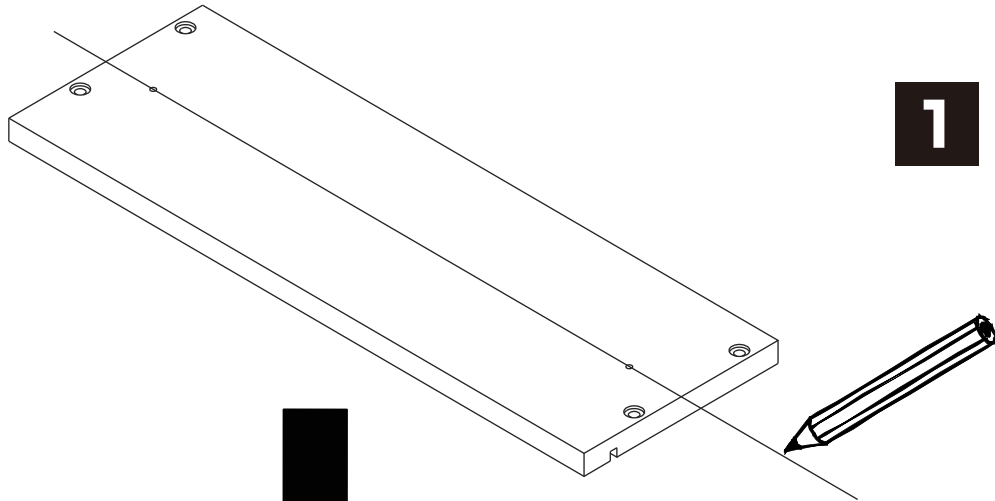

HARDWARE

-BODY SET

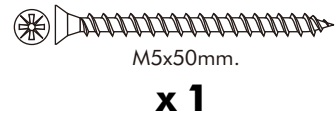
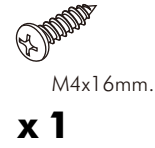
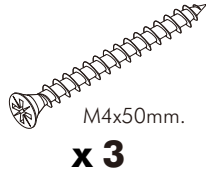
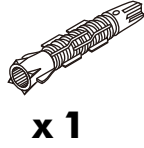
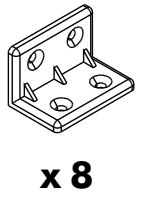
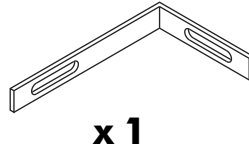
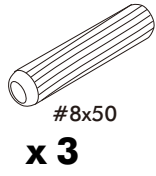
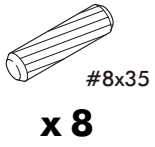

-DRAWER SET

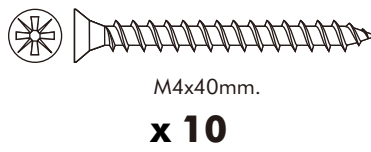
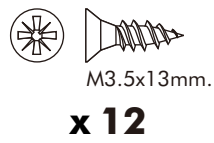
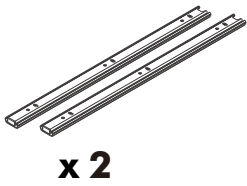

ASSEMBLY

-BODY SET

1.

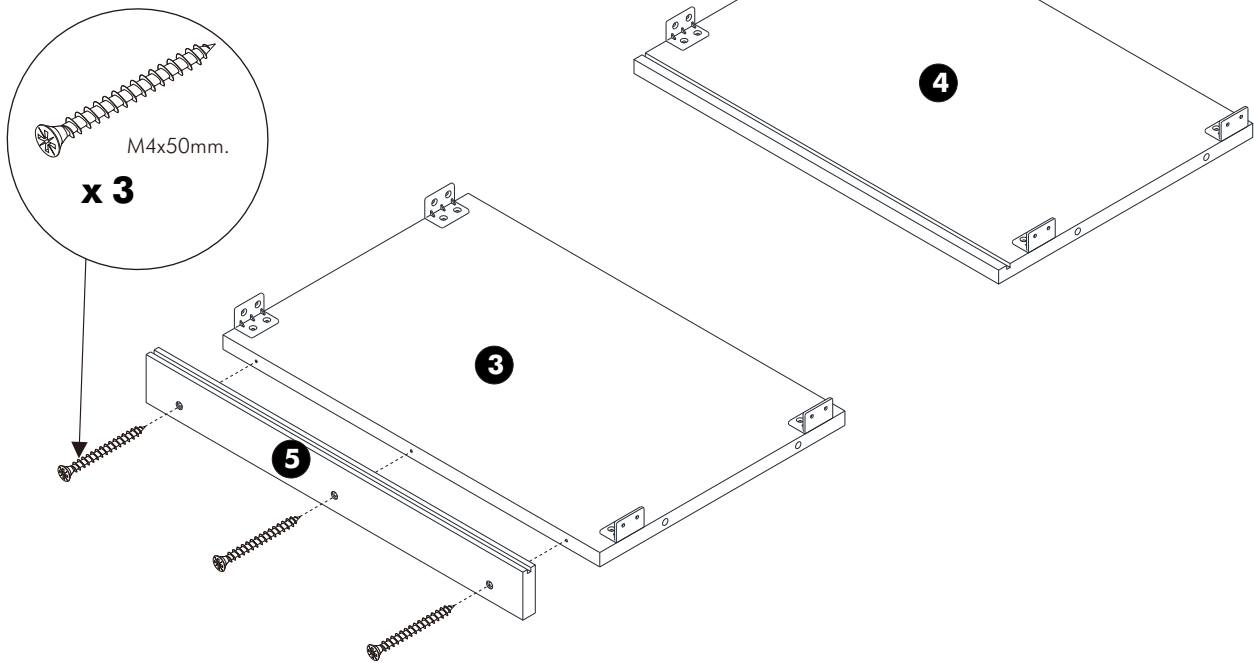

2.

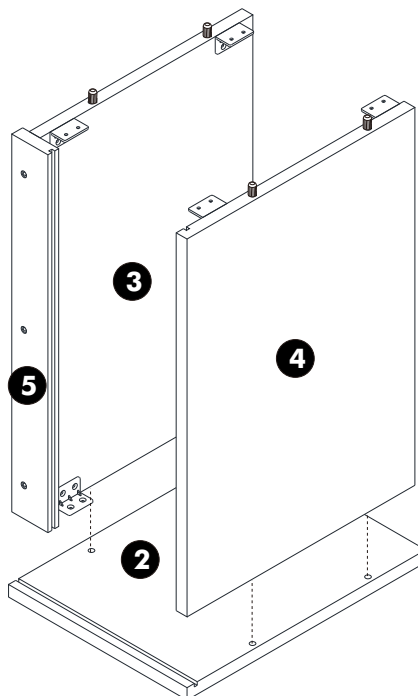

3.

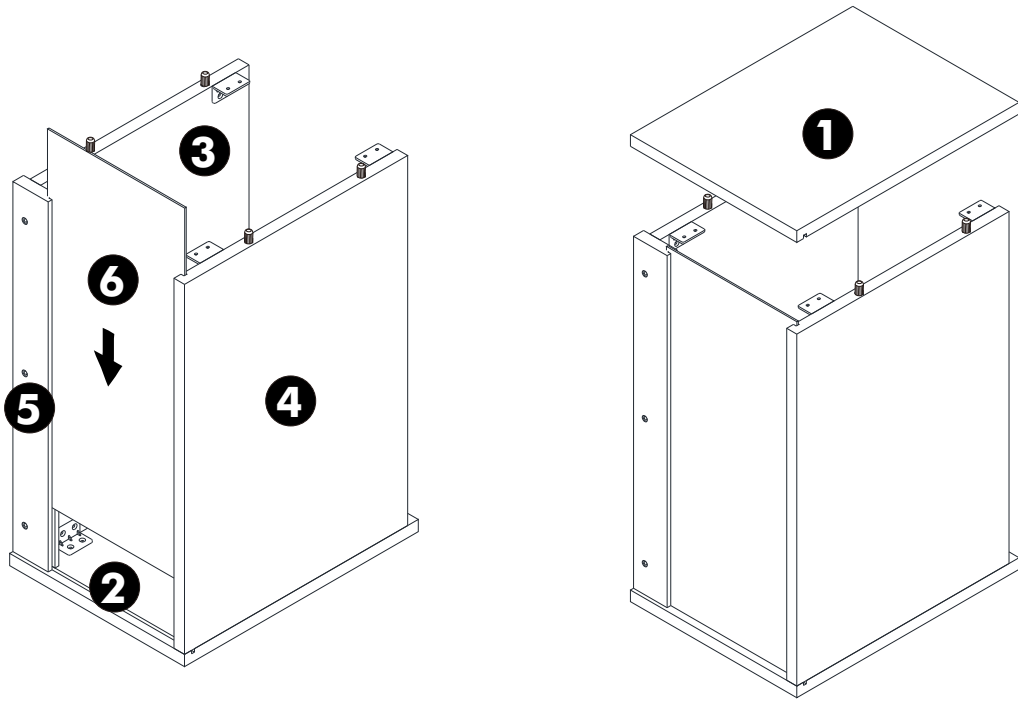

4.

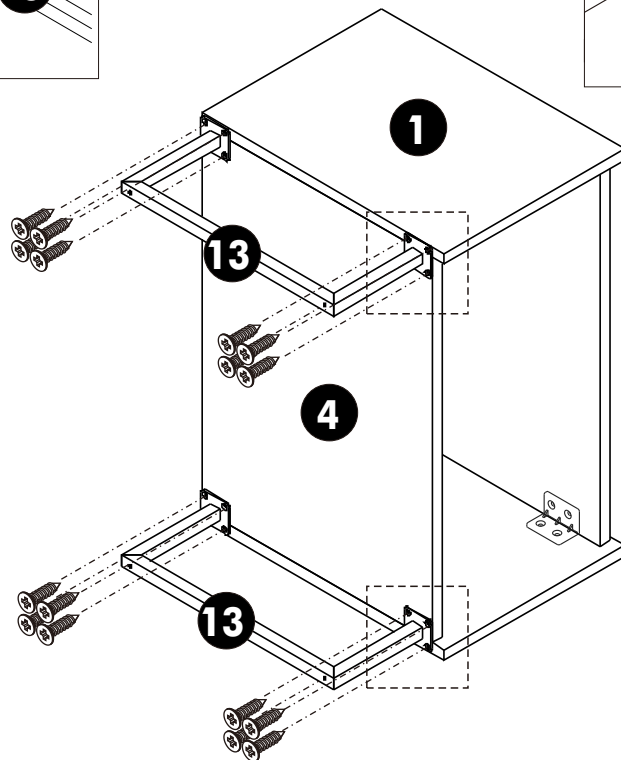
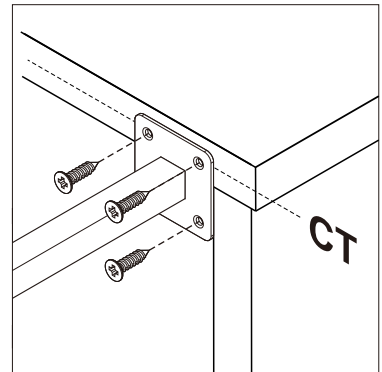
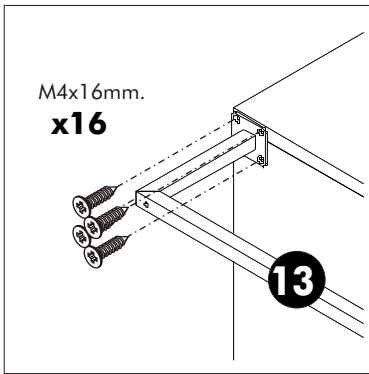

5.

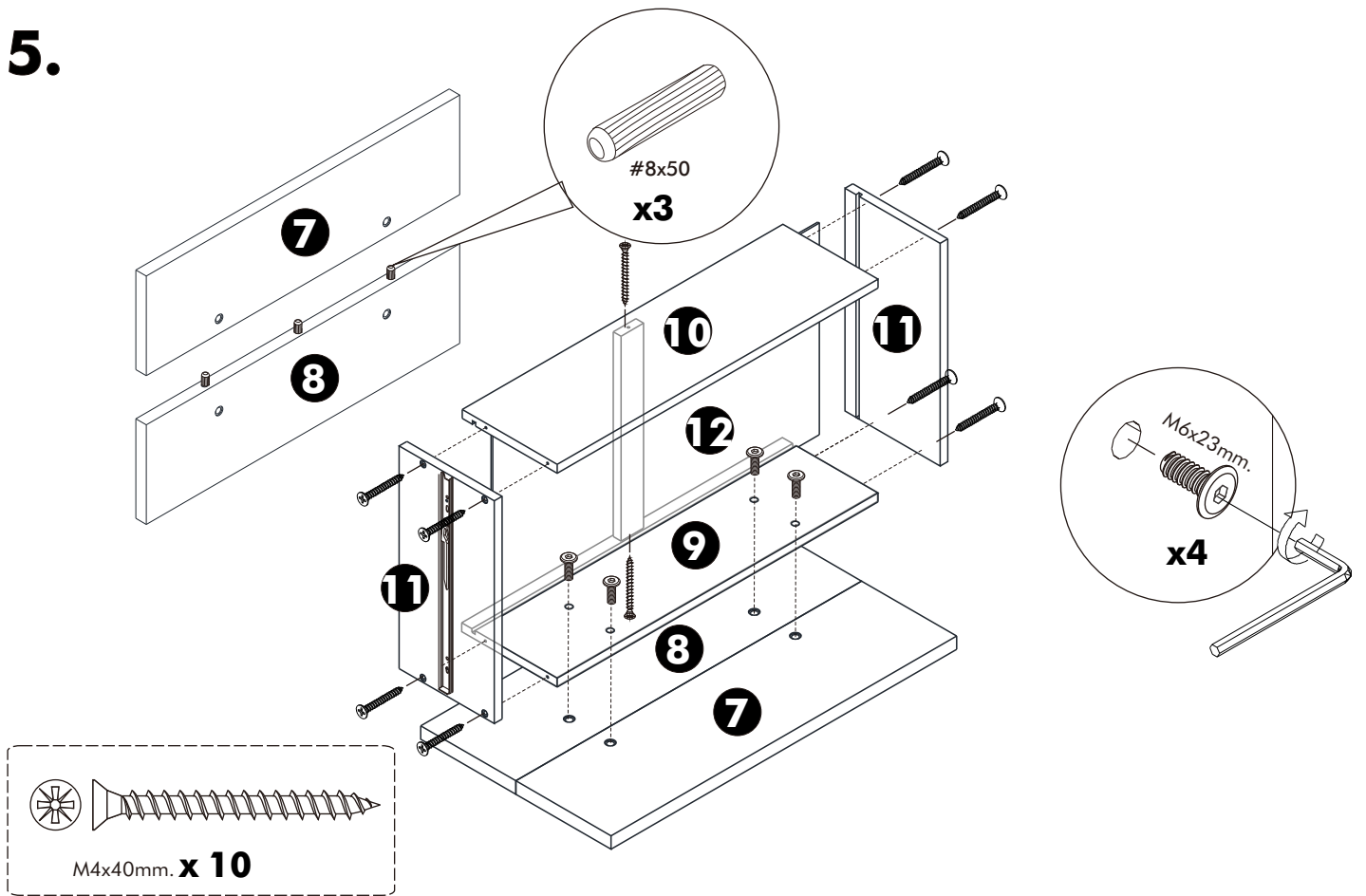

6.

