

# MAZZIMO-P

Dressing table

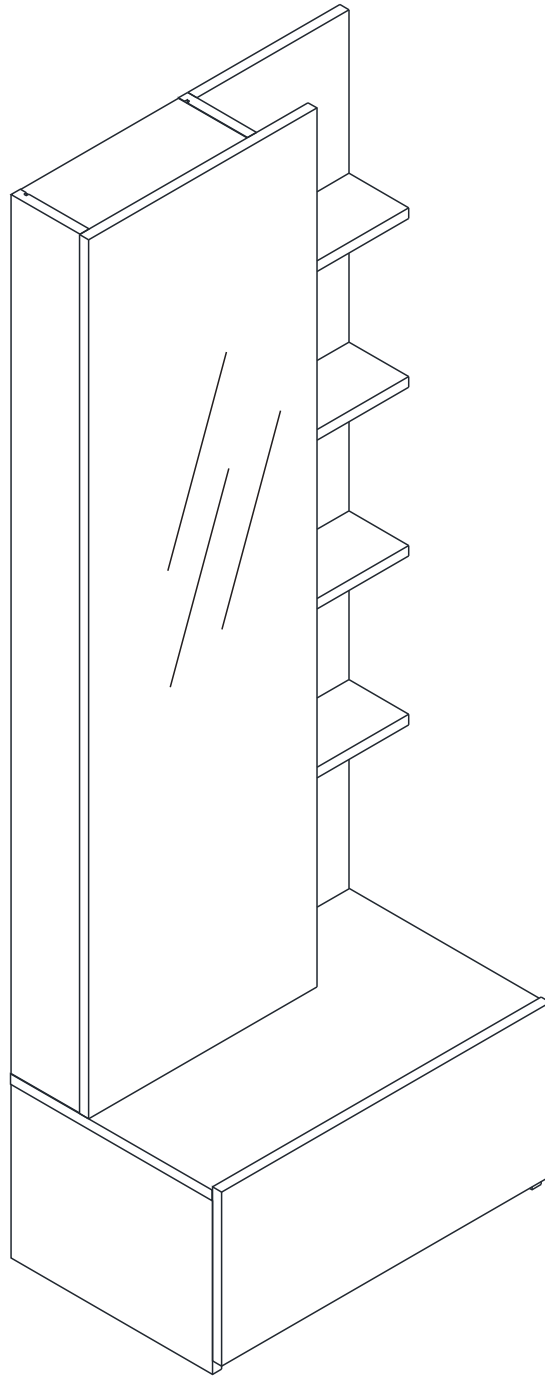

# CONNECT SYSTEM

**1**

**2**

(Connecting bolts)

**3**

**WHEN FITTING CAMS**  
 ENSURE STARTING POSITION IS CORRECT  
 BEFORE YOU INSERT CONNECTING BOLT  
 TURN CLOCKWISE UNTIL SECURE

✓

↑  
CORRECT

✗

WRONG

M4x16mm.

**OUT**      **IN**

**i**

40mm.

☹

✗

EQ

☺

✓

M3.5x13mm.

**1**

Use these holes

**2**

Use these holes



M4x16mm.

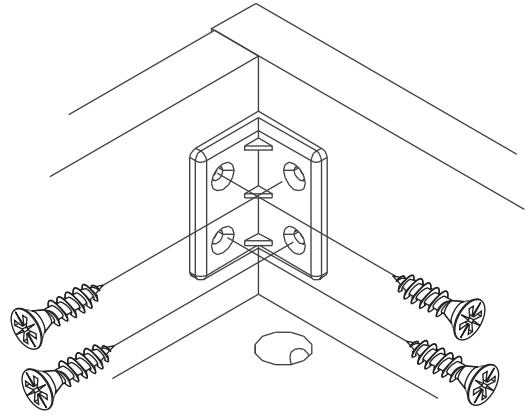
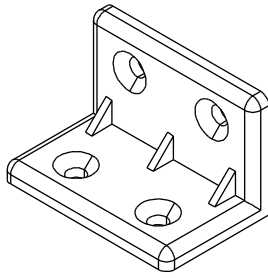

M3.5x20mm.

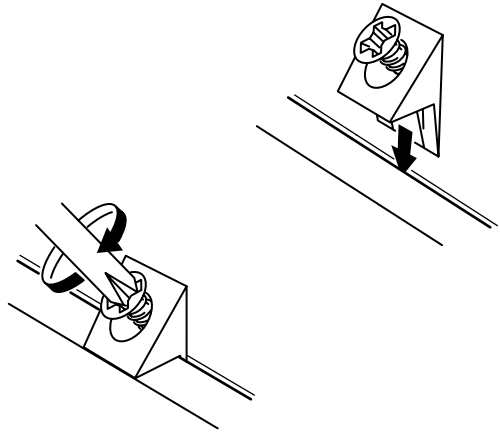
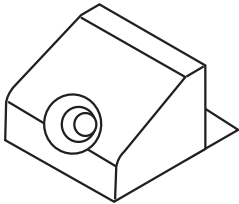

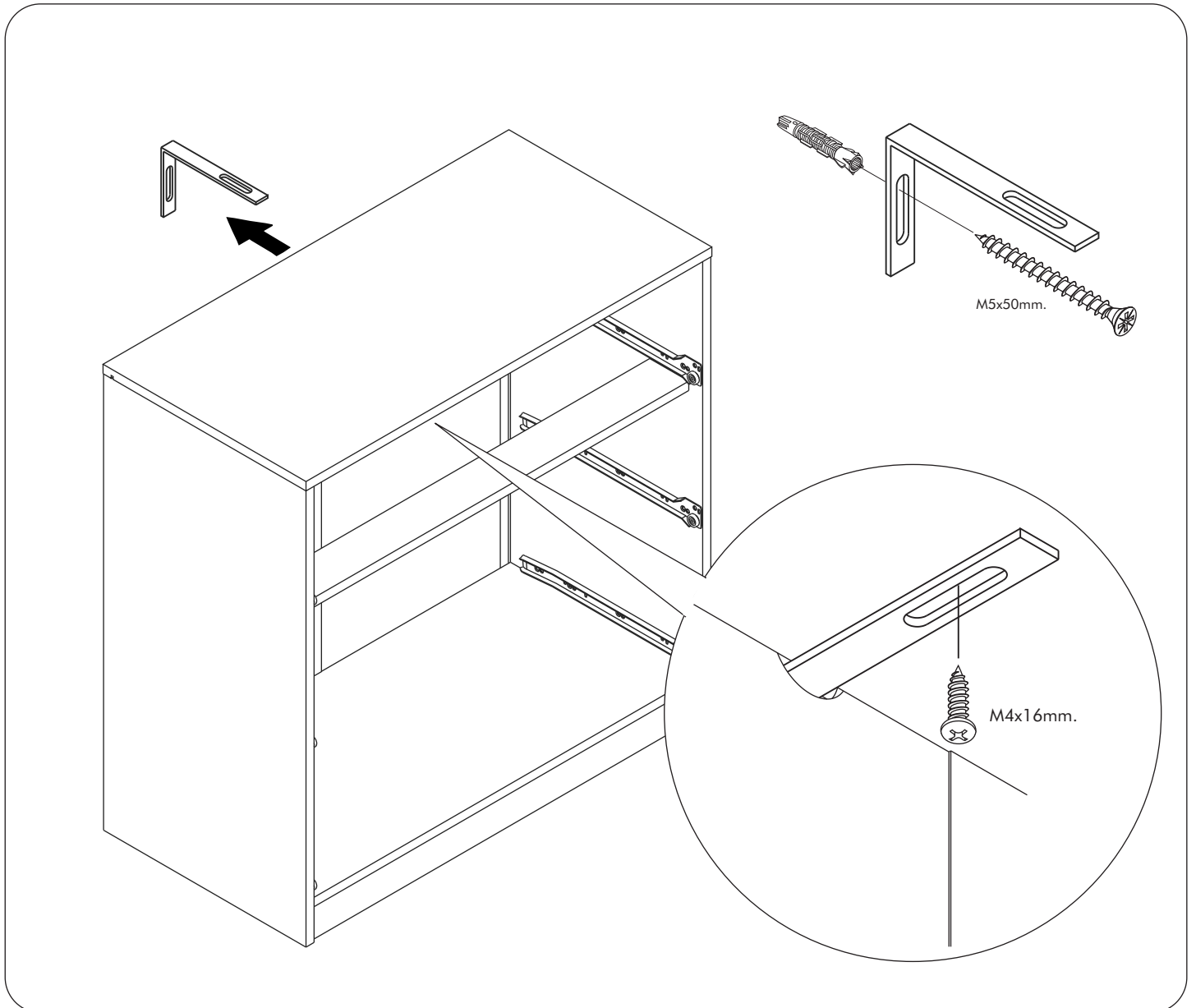
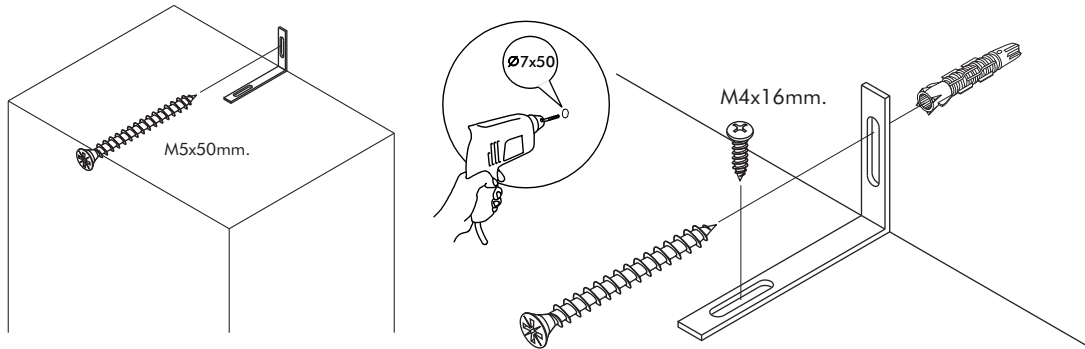
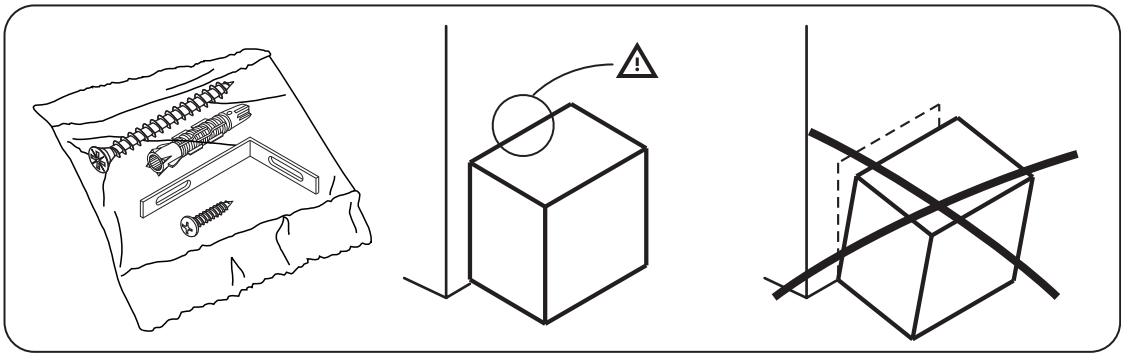

# HARDWARE

## -BODY SET



**x 32**

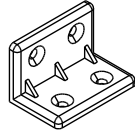

**x 25**



**x 8**

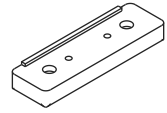

**x 8**

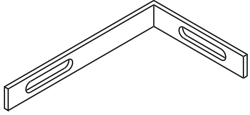

**x 1**



**x 8**



**x 116**

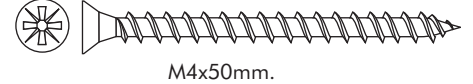

**x 23**

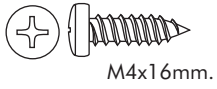

**x 4**

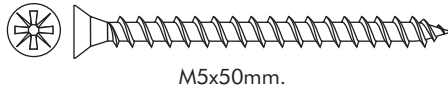

**x 1**

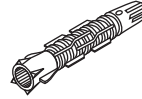

**x 1**

## -DRAWER SET

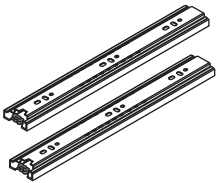

**x 1**

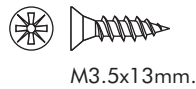

**x 12**

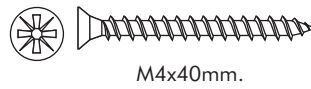

**x 10**



**x 4**

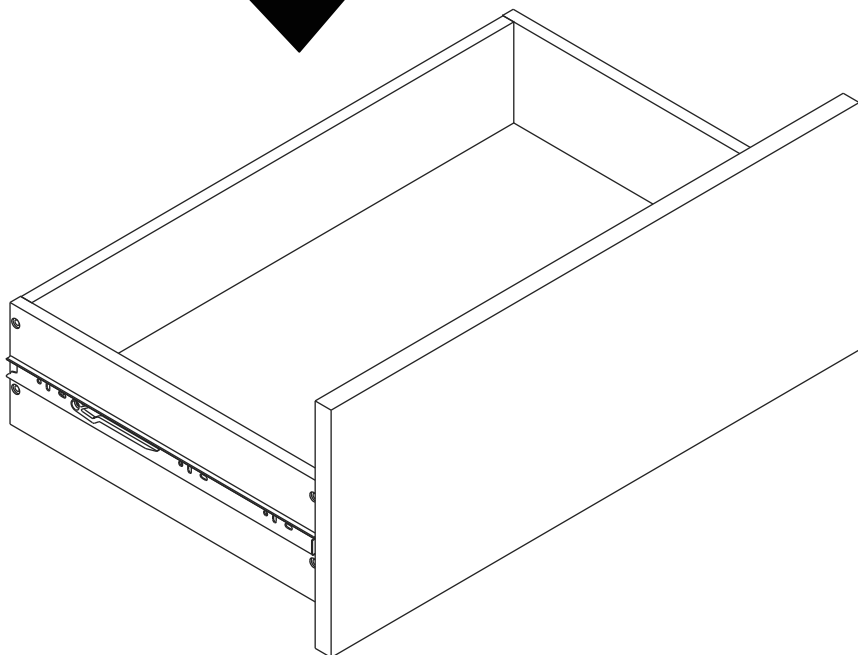
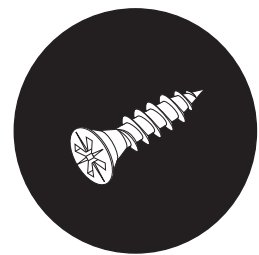
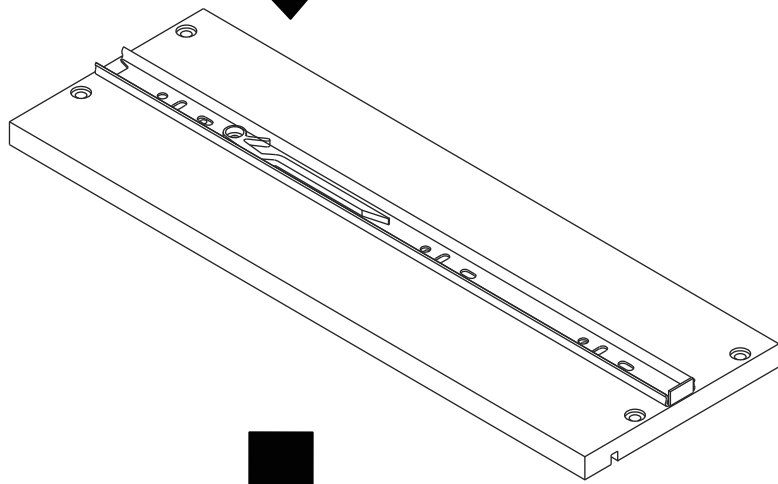
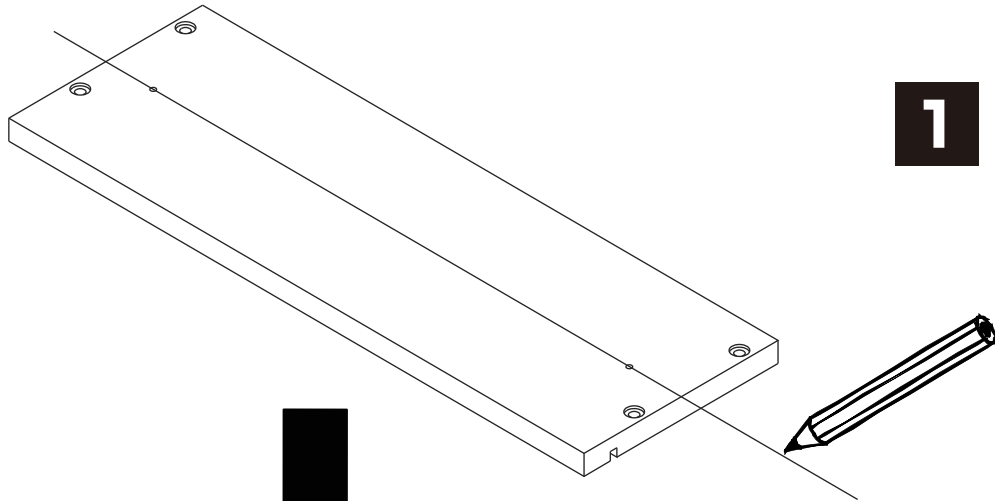

# ASSEMBLY

-BODY SET

1.

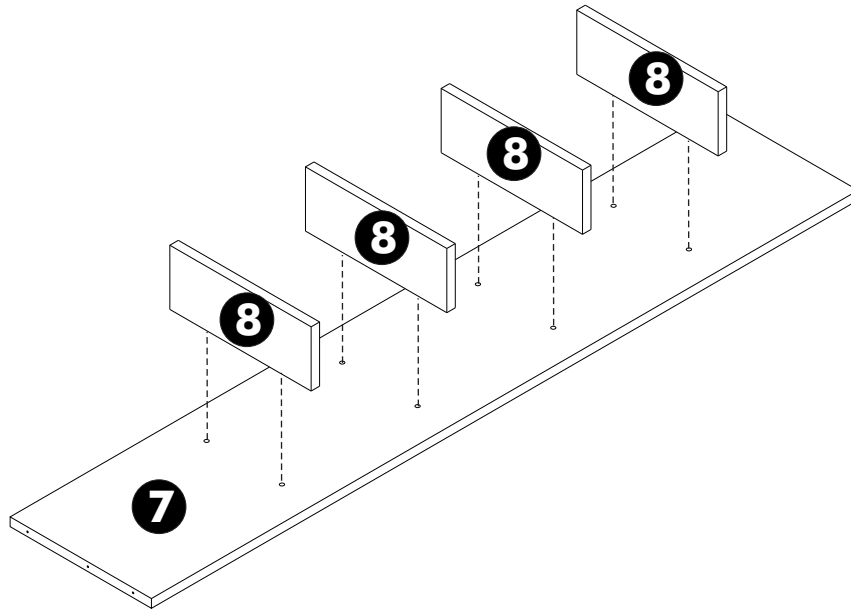

2.

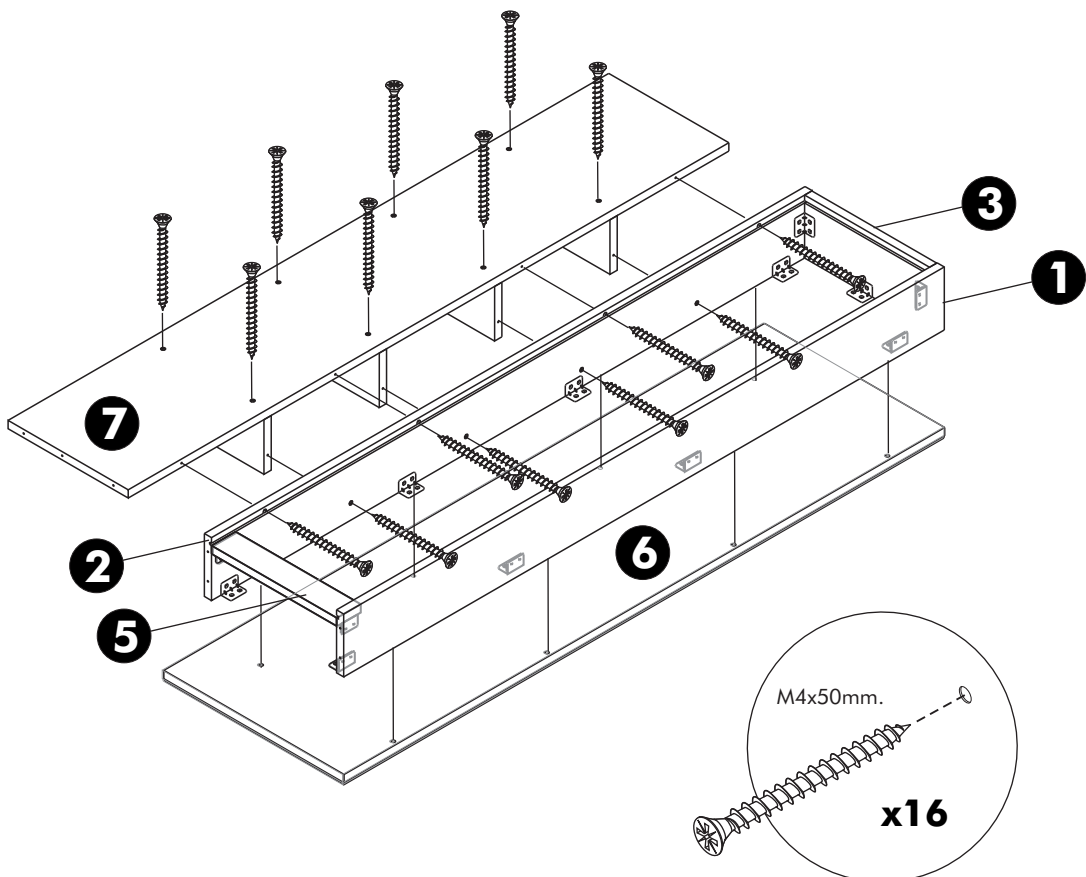

**3.**

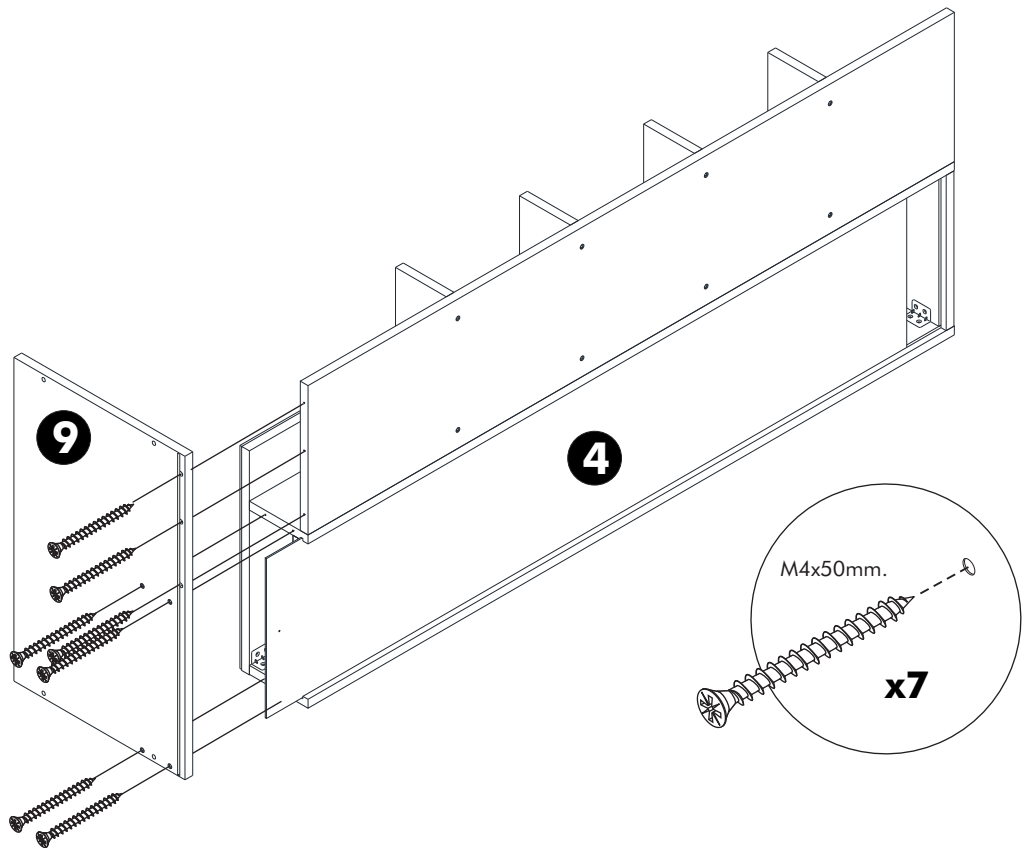

**4.**

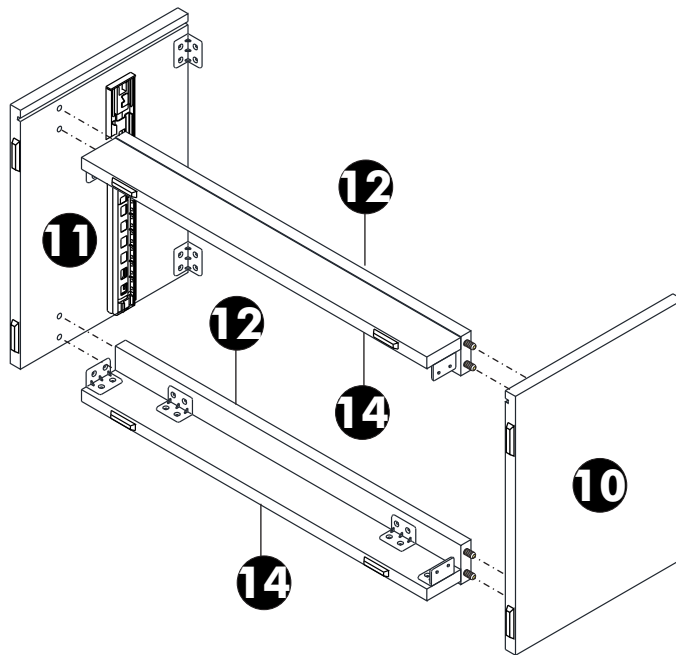

**5.**

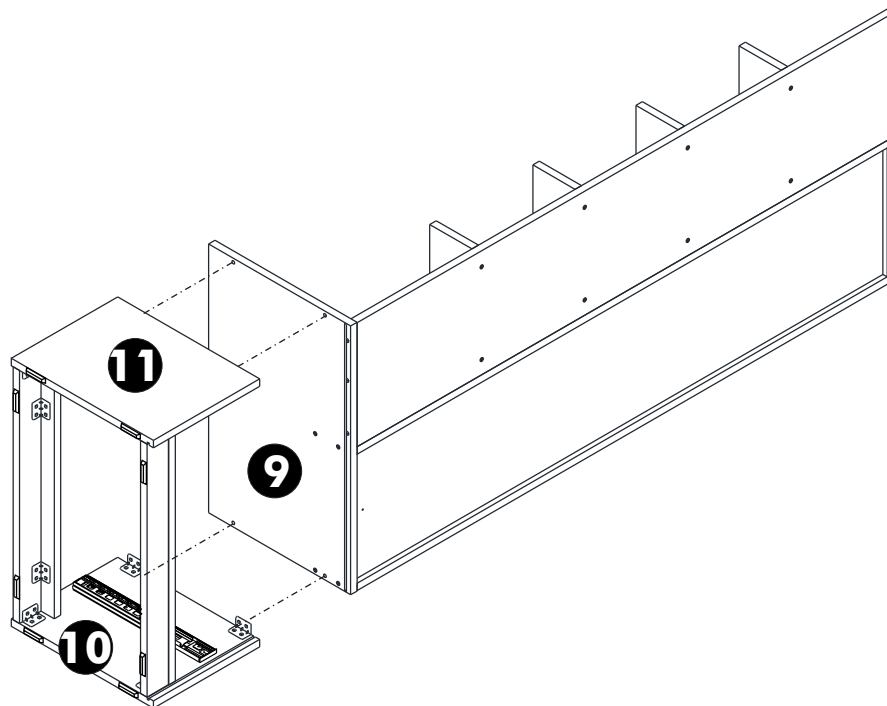

**6.**

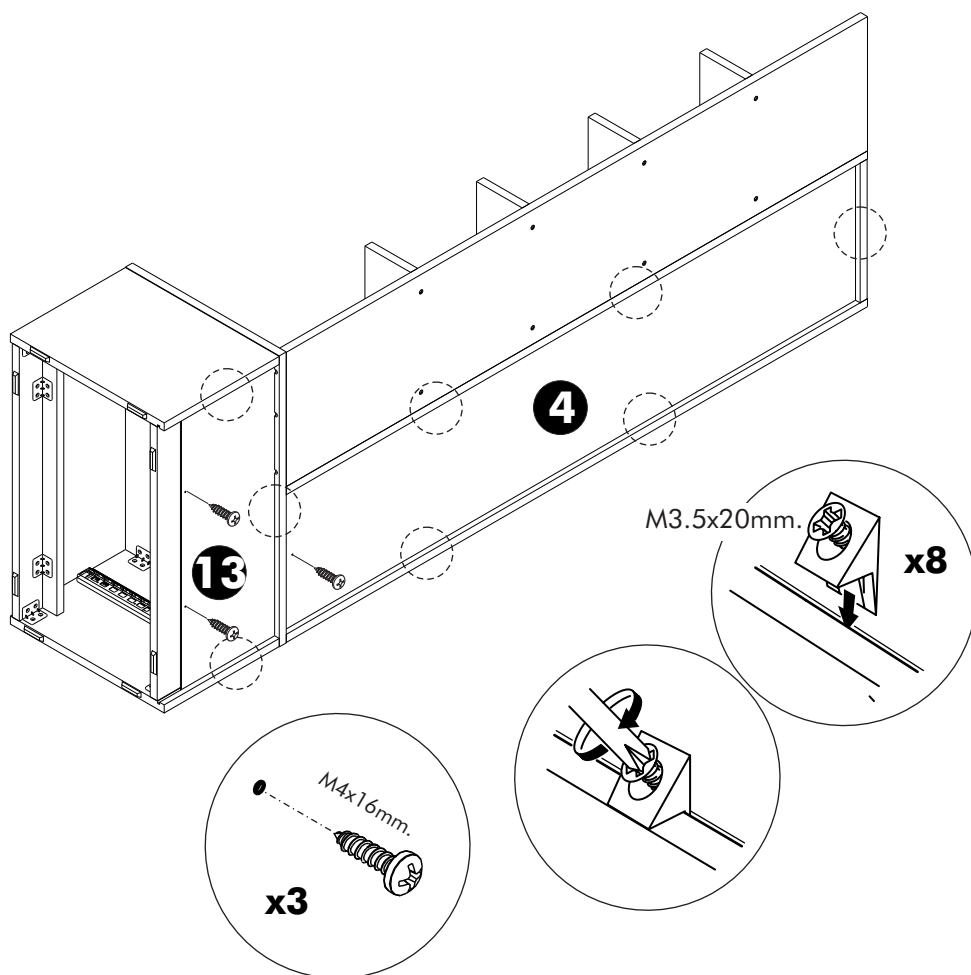

# 7. ASSEMBLY

-DRAWER SET

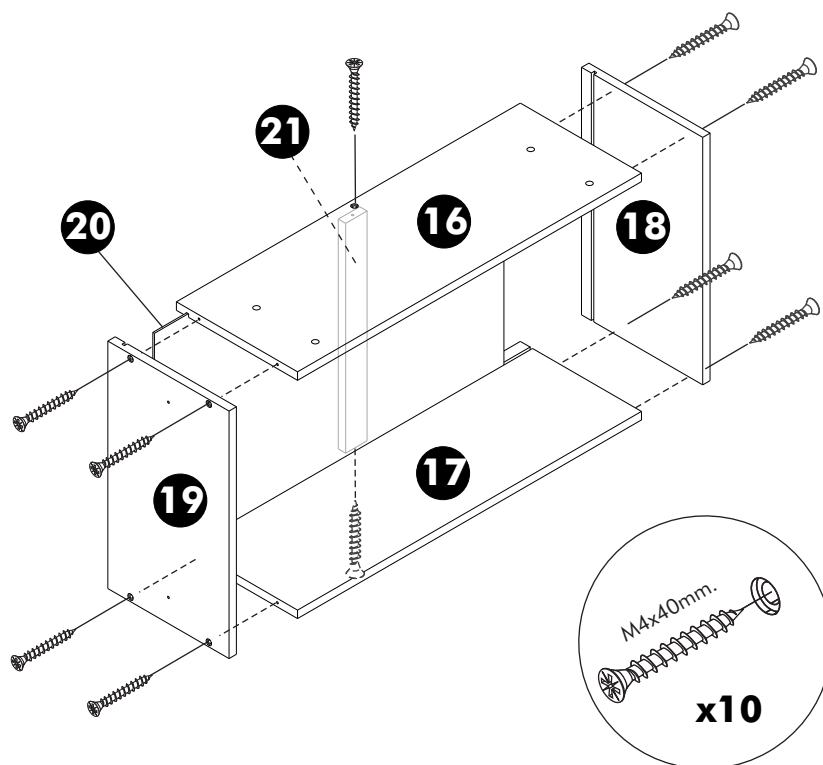

# 8.

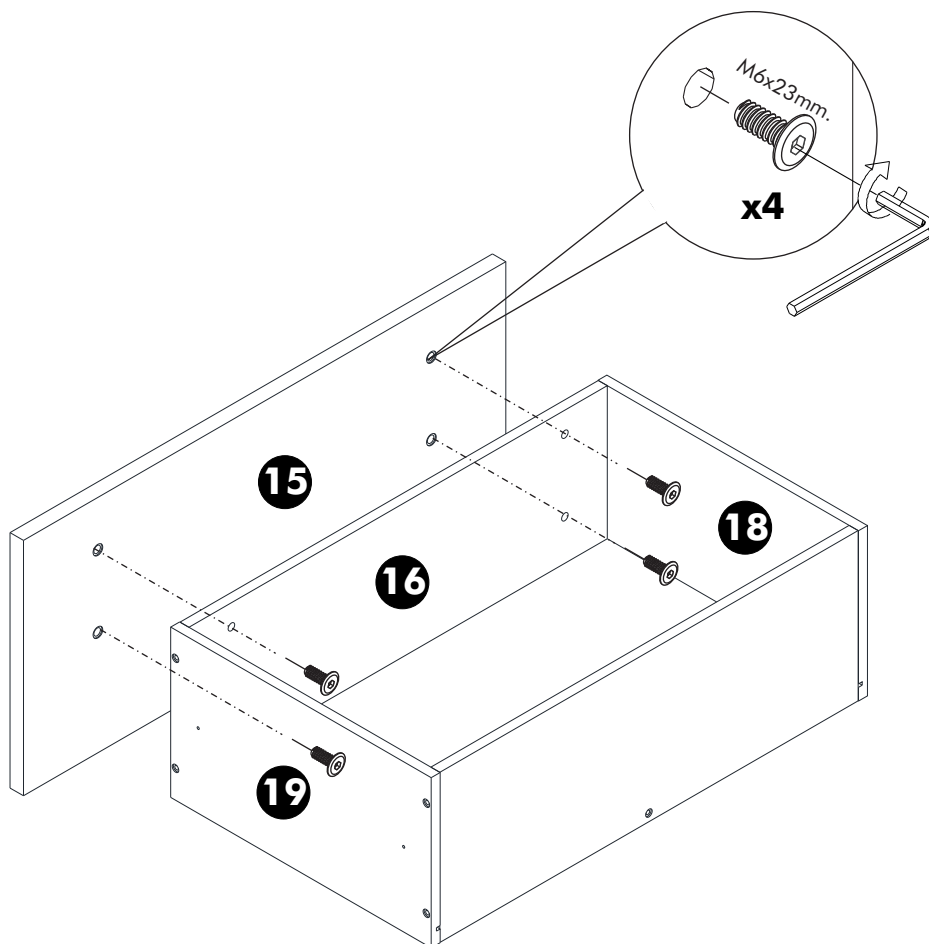

9.

