

# FLOVIN

**Working Table 140 cm.**

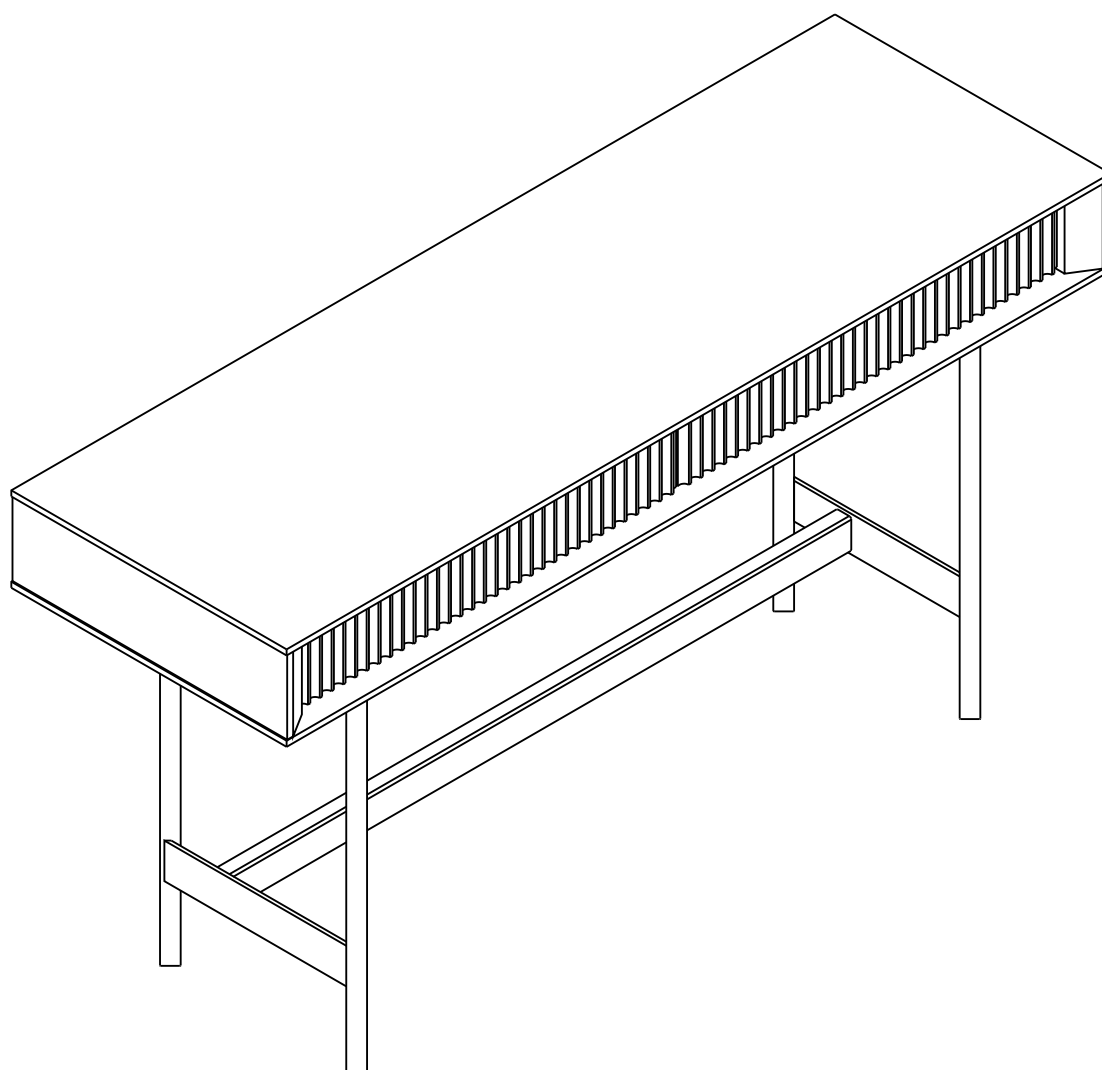

# CONNECT SYSTEM

**1**

**3**

**2**

(Connecting bolts)

**WHEN FITTING CAMS**  
ENSURE STARTING POSITION IS CORRECT  
BEFORE YOU INSERT CONNECTING BOLT  
TURN CLOCKWISE UNTIL SECURE

✓	✗	✗	✗
↑	↑	↑	↑
<b>CORRECT</b>	<b>WRONG</b>		<b>✗</b>

**i**

AFTER FINISHED ASSEMBLY.  
INCASE OF GAP BETWEEN DRAWERS ARE NOT ALIGN.  
PLEASE ADJUST AS BELOW.  
1. LOOSE SCREW A LITTLE BIT.  
2. THEN MOVE FRONT DRAWER TO ALIGNMENT POSITION.  
3. TIGHTEN SCREW.

# HARDWARE

## -BODY SET

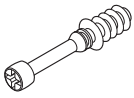

**x 12**



19mm.

**x 12**

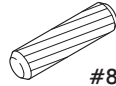

#8x35

**x 12**

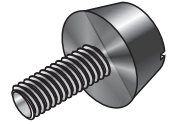

#M6

**x 4**

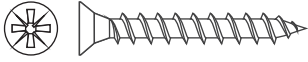

#M4x40

**x 23**

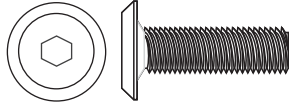

#M6x23

**x 4**



#M6

**x 4**

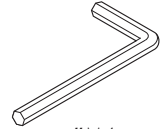

#M4

**x 1**



#30mm.

**x 4**



#M8

**x 4**



Ø7mm.

**x 4**



#M8

**x 4**

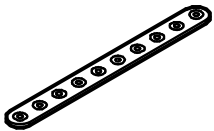

**x 1**

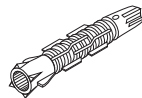

#UP-745

**x 1**



F+M4.5x60mm.

**x 1**



P+M4x16mm.

**x 1**

## -DRAWER SET

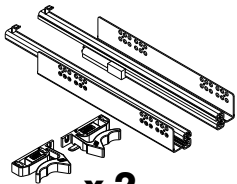

**x 2**



#M4x13

**x 12**



#M4x40

**x 4**

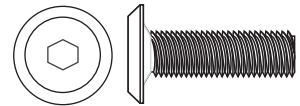

#M6x23

**x 6**

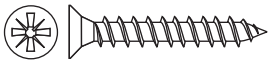

#M3.5x35

**x 8**

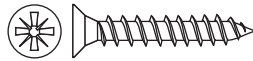

#M4x30

**x 16**

# ASSEMBLY

-BODY SET

**1.**

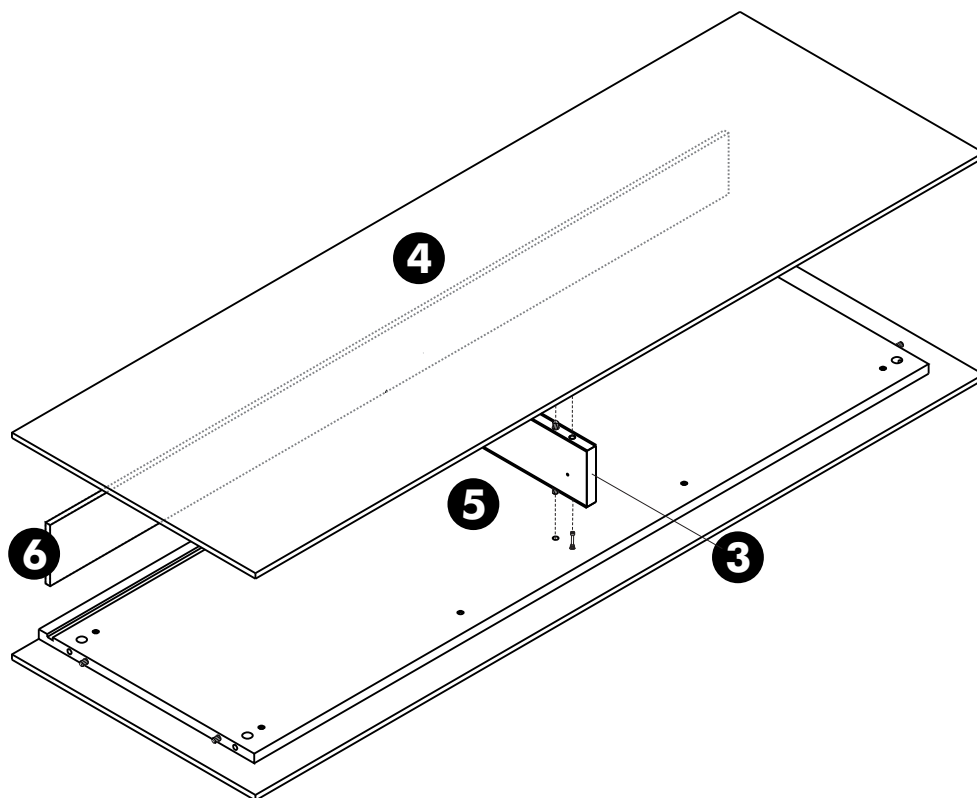

**2.**

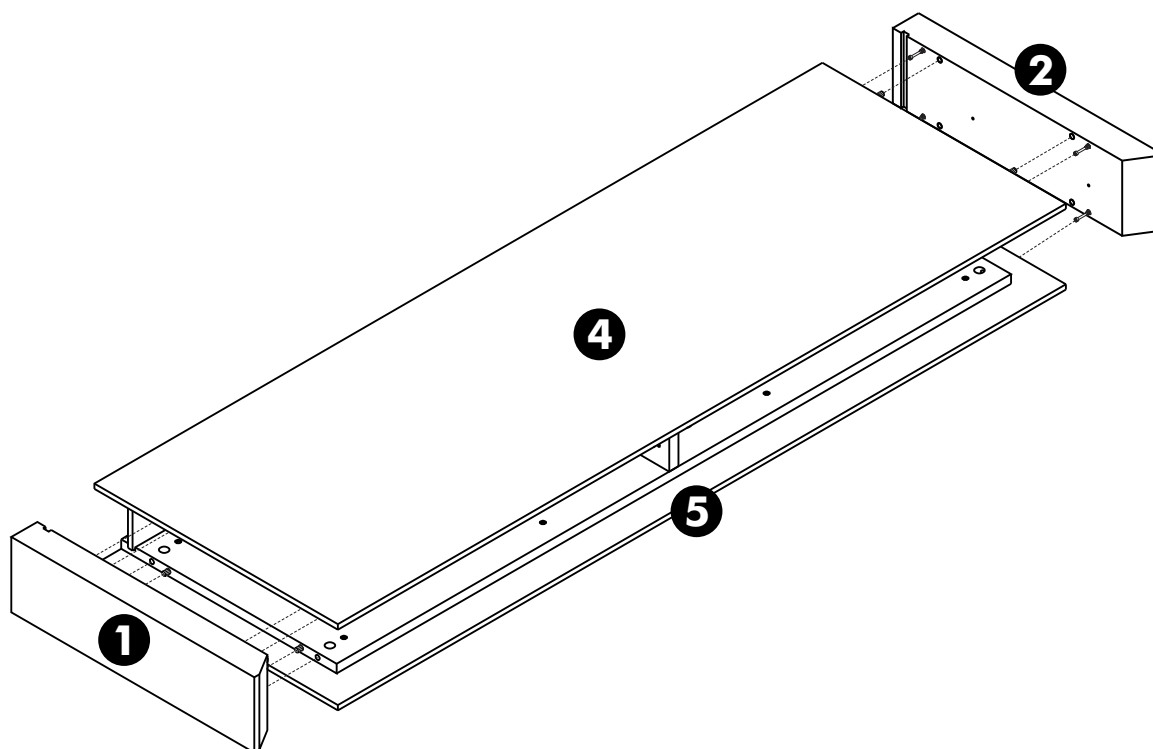

**3.**

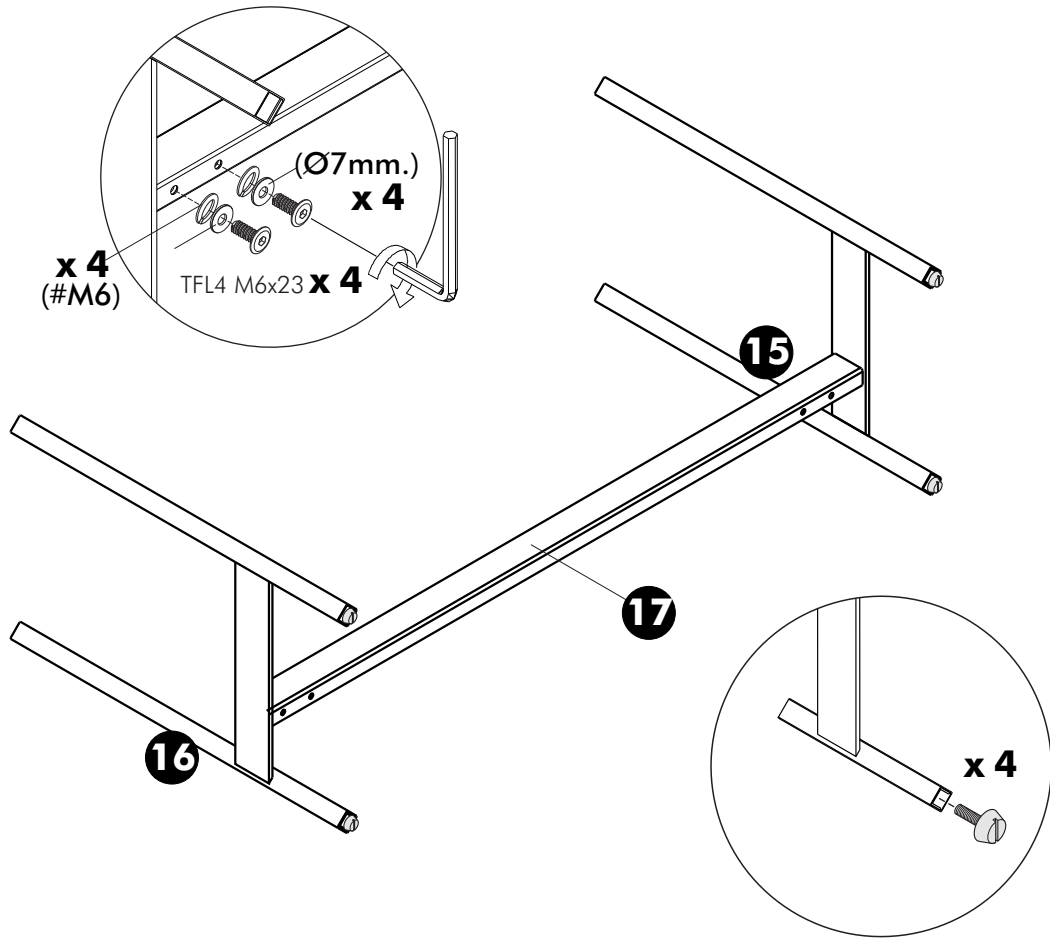

**4.**

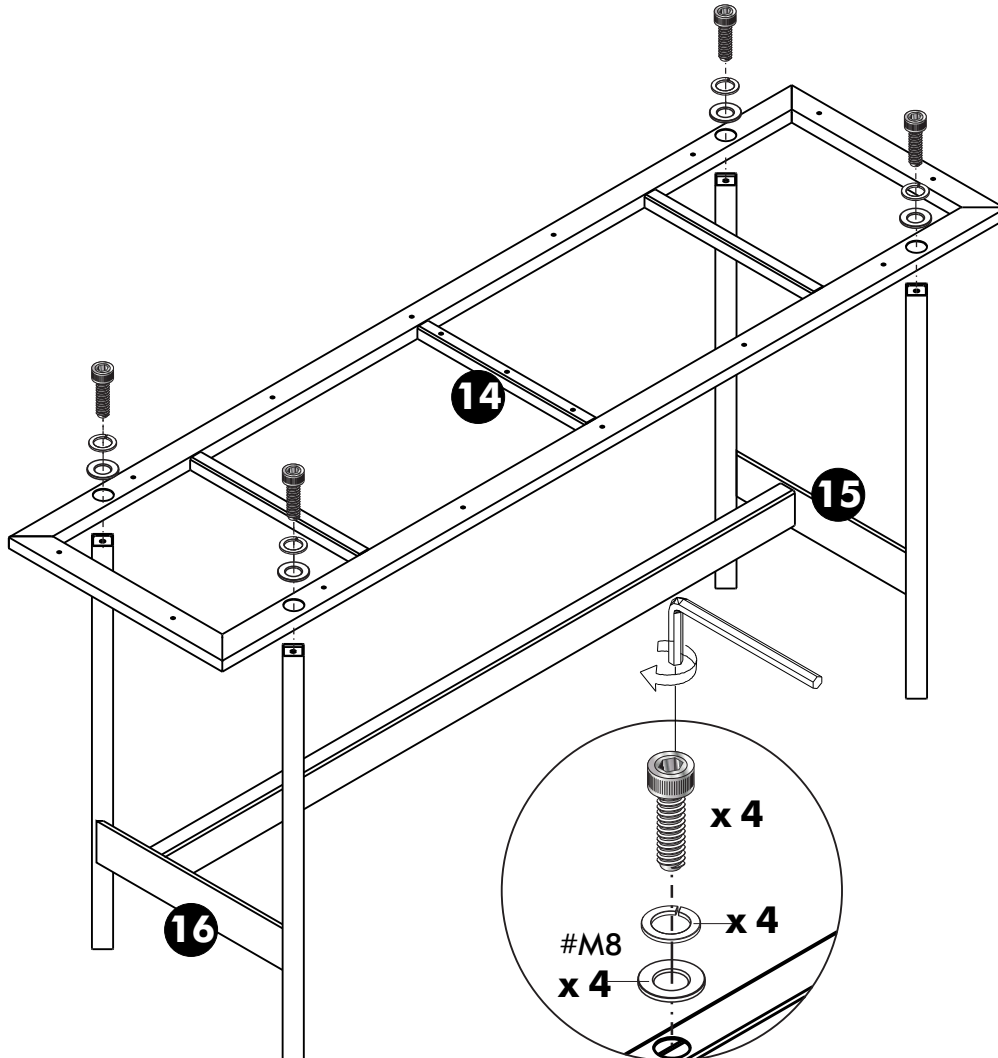

5.

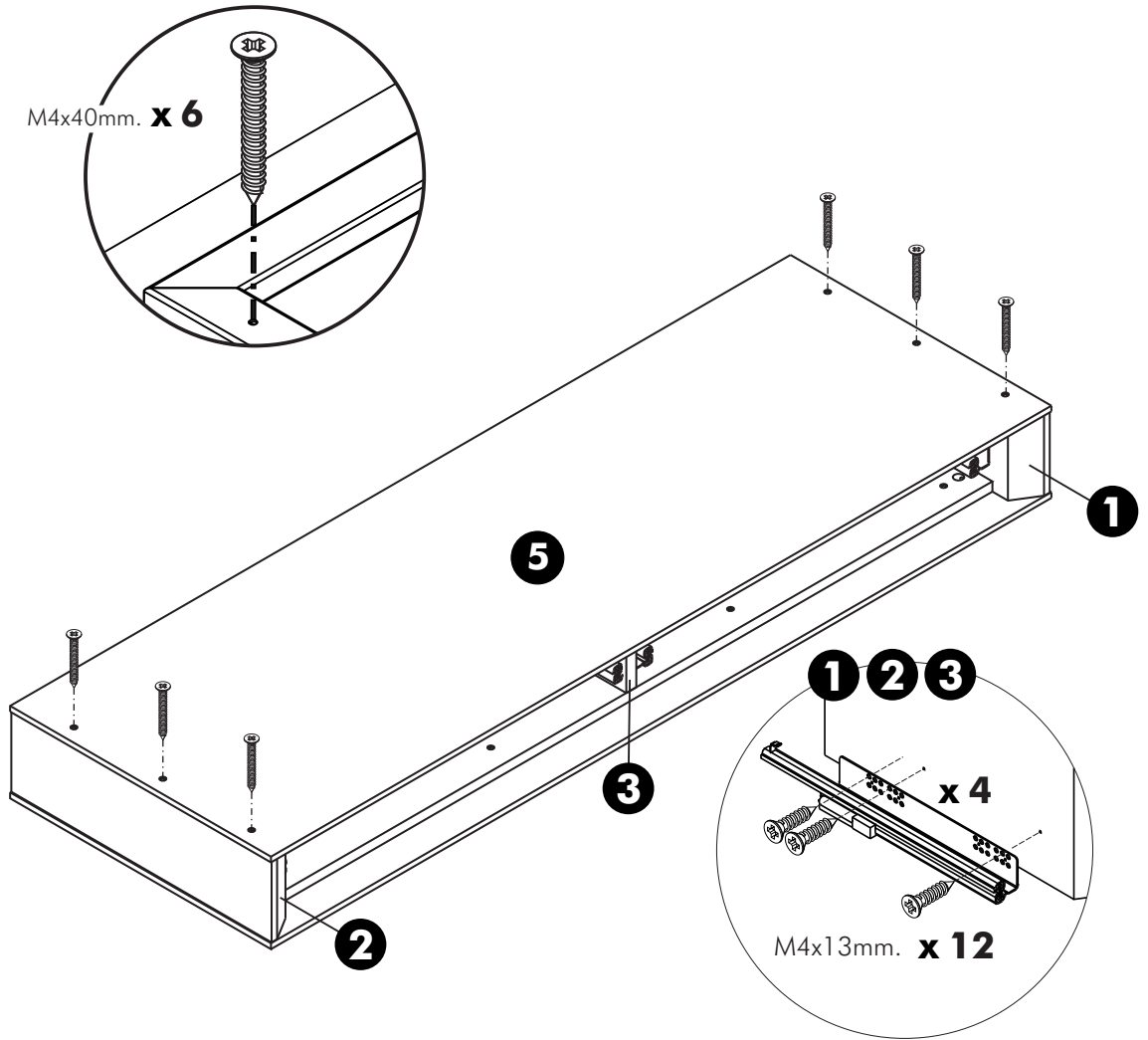

6.

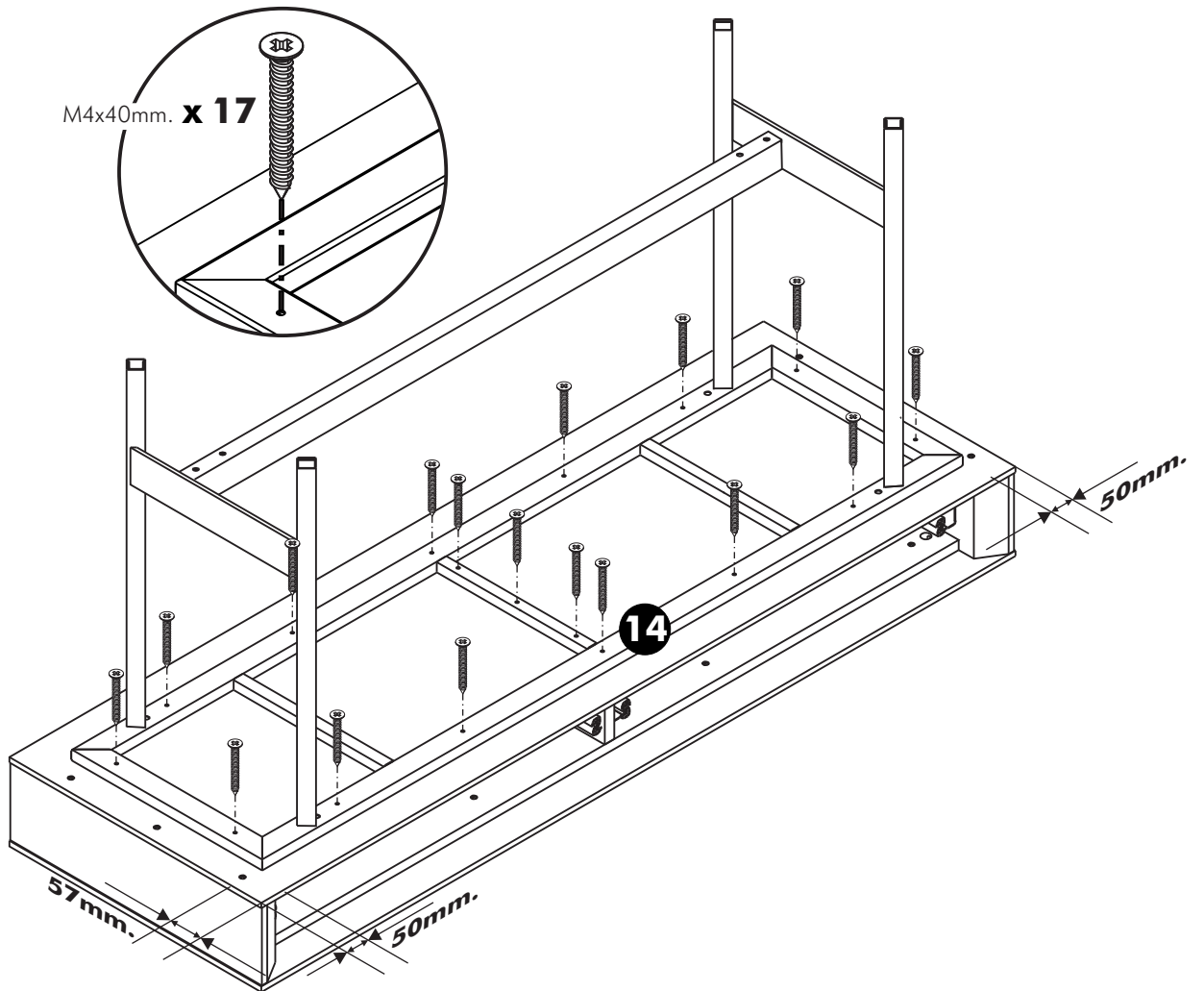

# ASSEMBLY

-DRAWER SET

**1.**

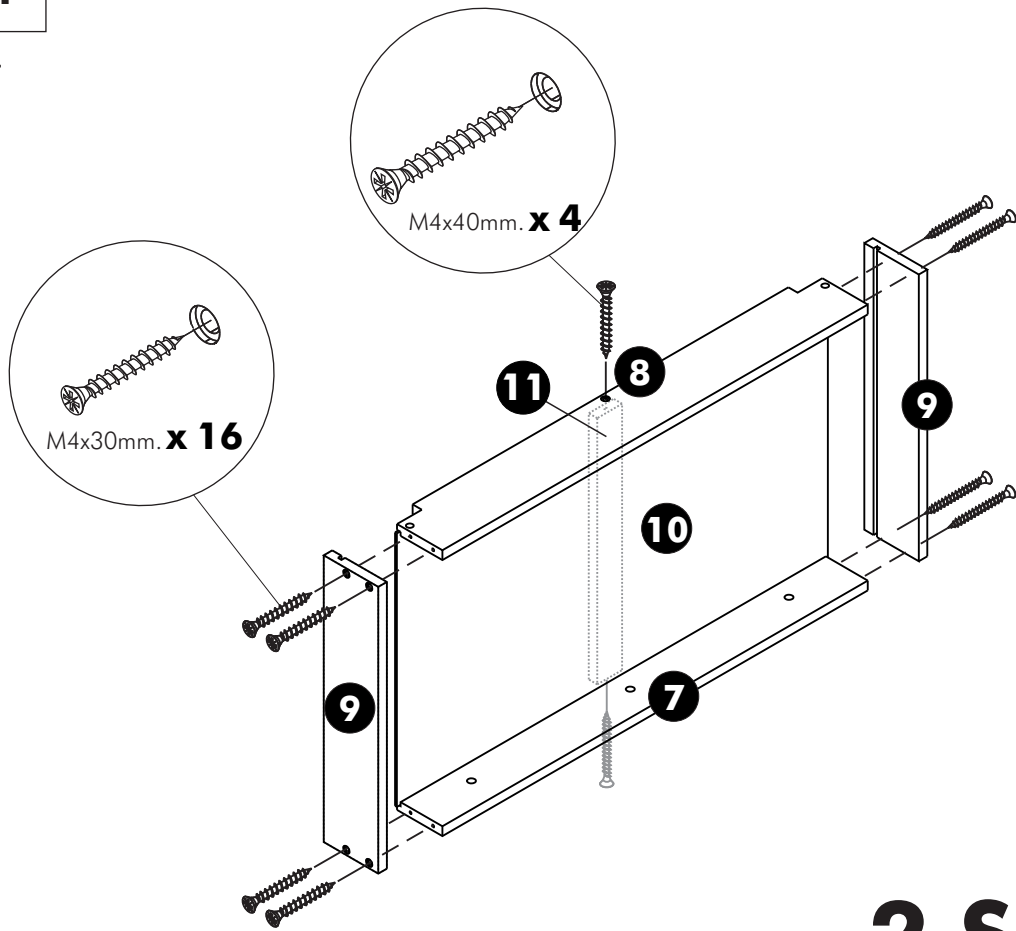

**2 Set**

**2.**

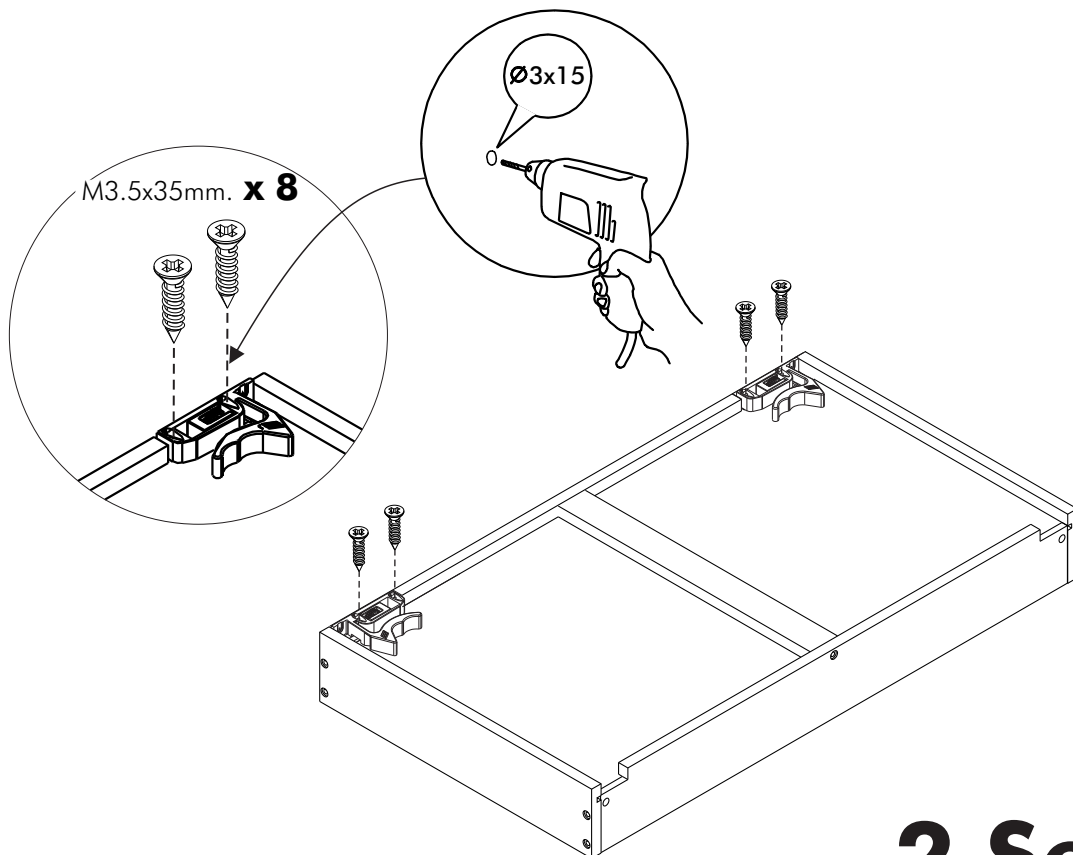

**2 Set**

**3.**

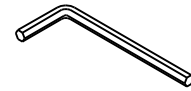
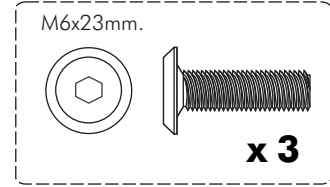
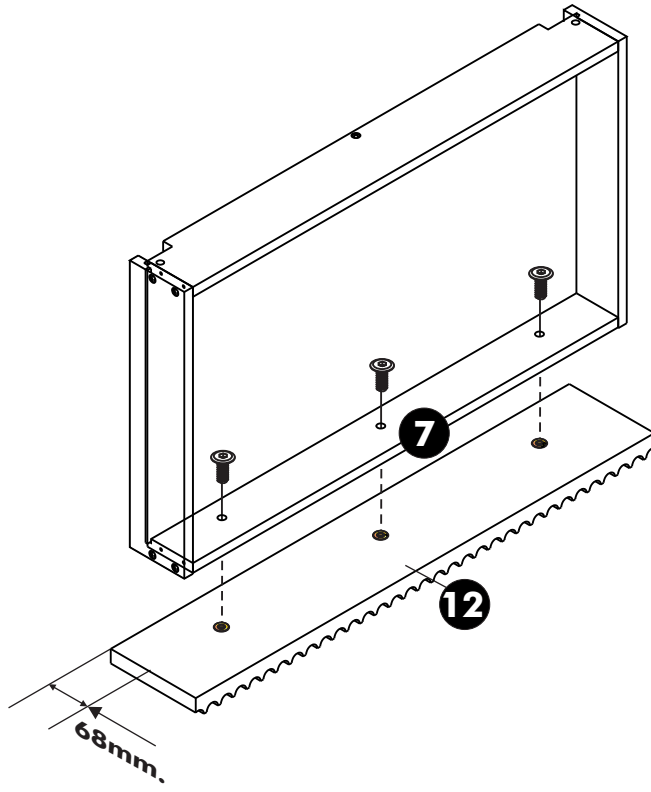

**4.**

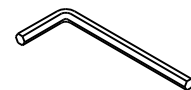
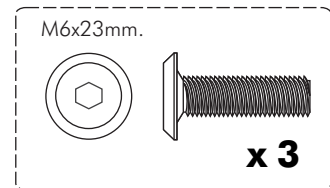
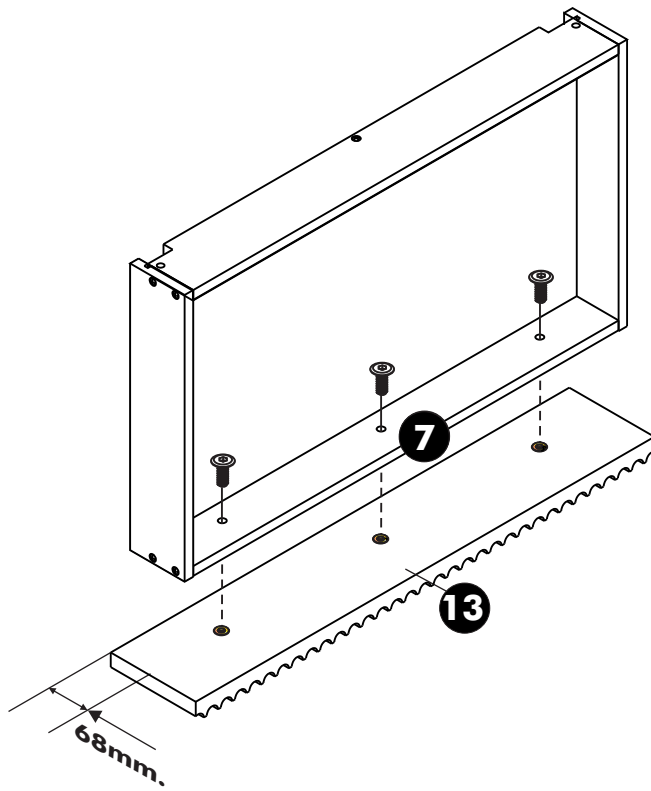

**5.**

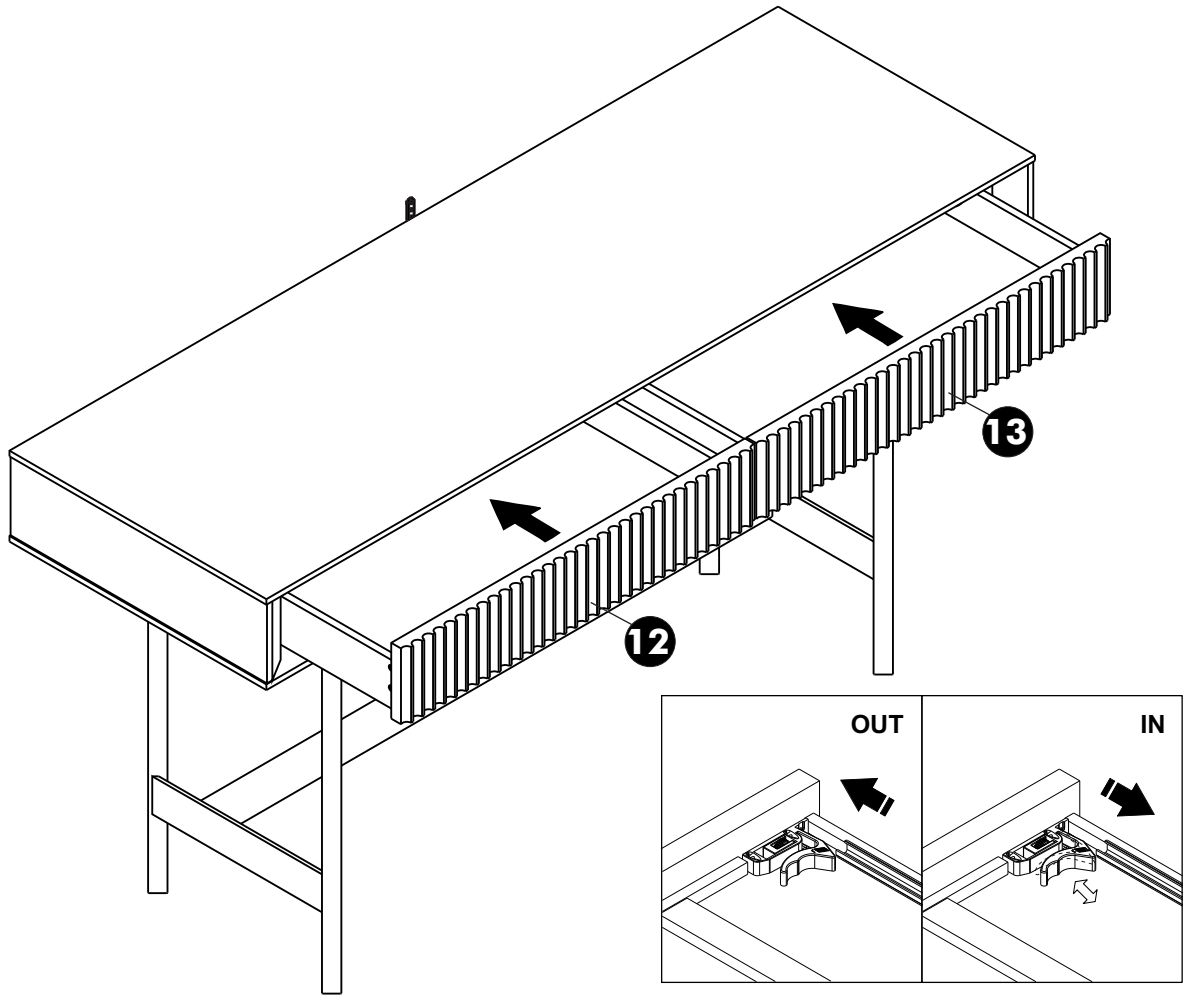

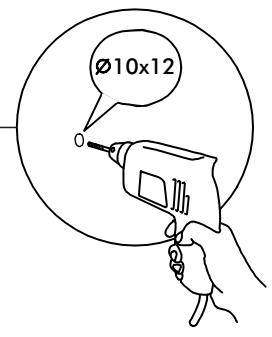
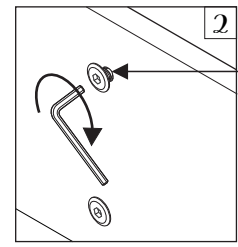
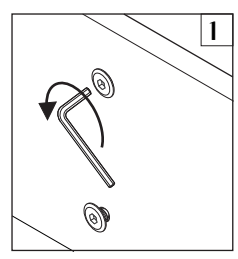
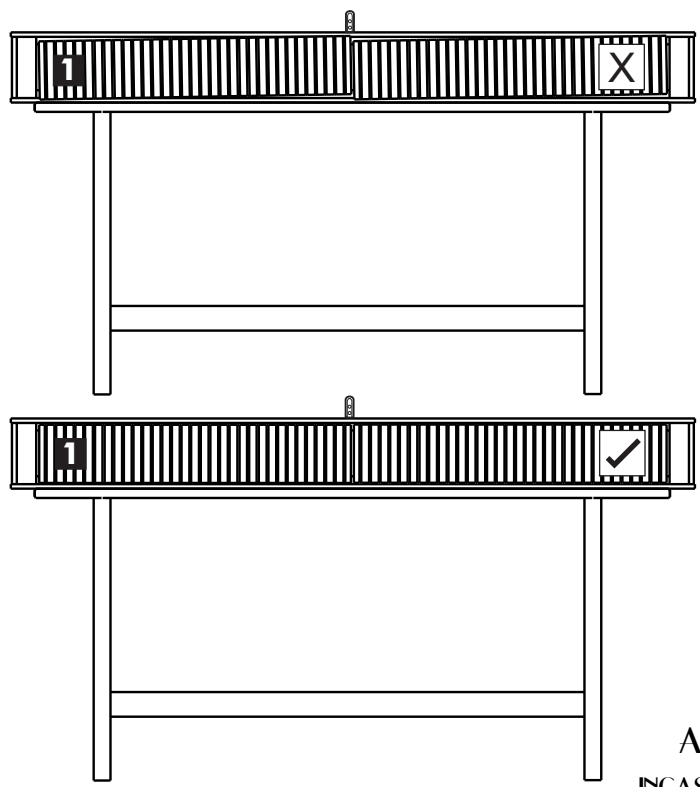

**AFTER FINISHED ASSEMBLY.**

- IN CASE OF GAP BETWEEN DRAWERS ARE NOT ALIGN.  
PLEASE ADJUST AS BELOW.
1. LOOSE SCREW A LITTLE BIT.
  2. THEN MOVE FRONT DRAWER TO ALIGNMENT POSITION.
  3. TIGHTEN SCREW

