

# KARLMAR

## Chest 4 drawers

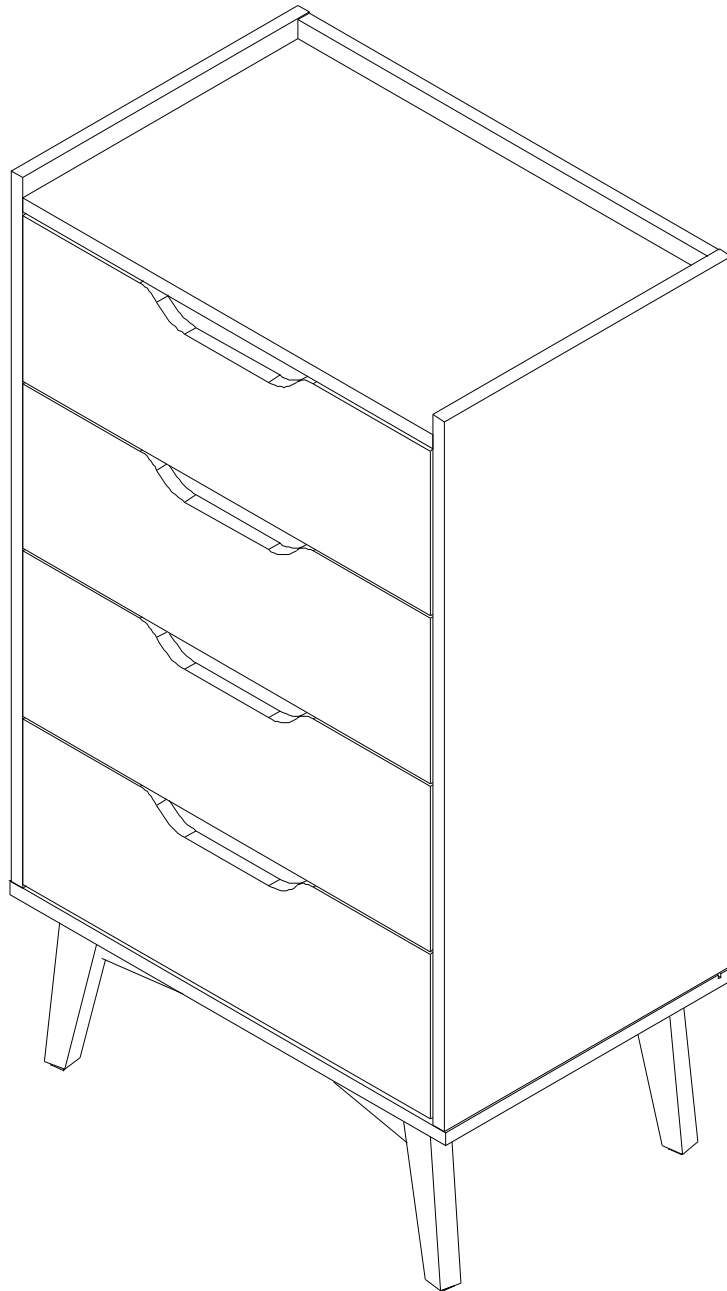

# CONNECT SYSTEM

**1**

**2**

(Connecting bolts)

**3**

**WHEN FITTING CAMS**  
ENSURE STARTING POSITION IS CORRECT  
BEFORE YOU INSERT CONNECTING BOLT  
TURN CLOCKWISE UNTIL SECURE

✓  
CORRECT

✗  
WRONG

5/10.5 mm.

M3.5x13mm.

**1**

5/10.5 mm.

M3.5x13mm.

**2**

M3.5x13mm.

M4.5x60mm.

M4x16mm.

⚠

M4.5x60mm.

Ø7x50

1

2

3

4

M4x16mm.

# HARDWARE

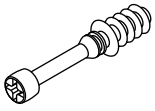

**X 8**



#16mm.

**X 8**

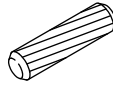

#8x35

**X 12**



#M4.5x60

**X 1**

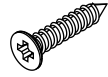

#M4x16

**X 4**



#M4x16

**X 21**

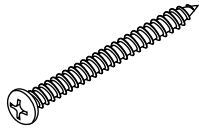

#M4x50

**X 4**

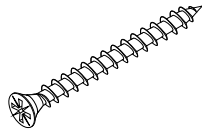

#M4x50

**X 7**

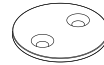

**X 2**

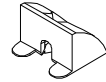

**X 6**

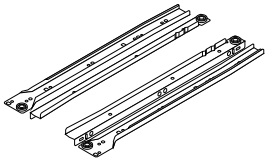

**X 4 Set**

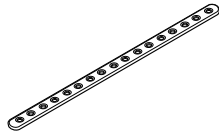

**X 1**

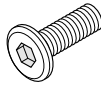

#TFL4 M6x23

**X 20**

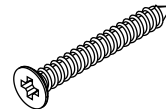

#M4x40

**X 40**

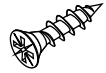

#M3.5x13

**X 32**

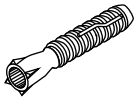

**X 1**

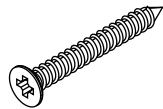

#M4x30

**X 20**



**X 1**

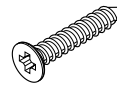

#M4x20

**X 6**



#M5x10.5

**X 24**

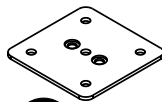

**16x4**

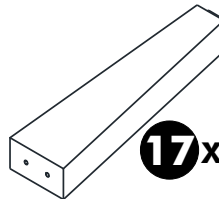

**17x4**

1.

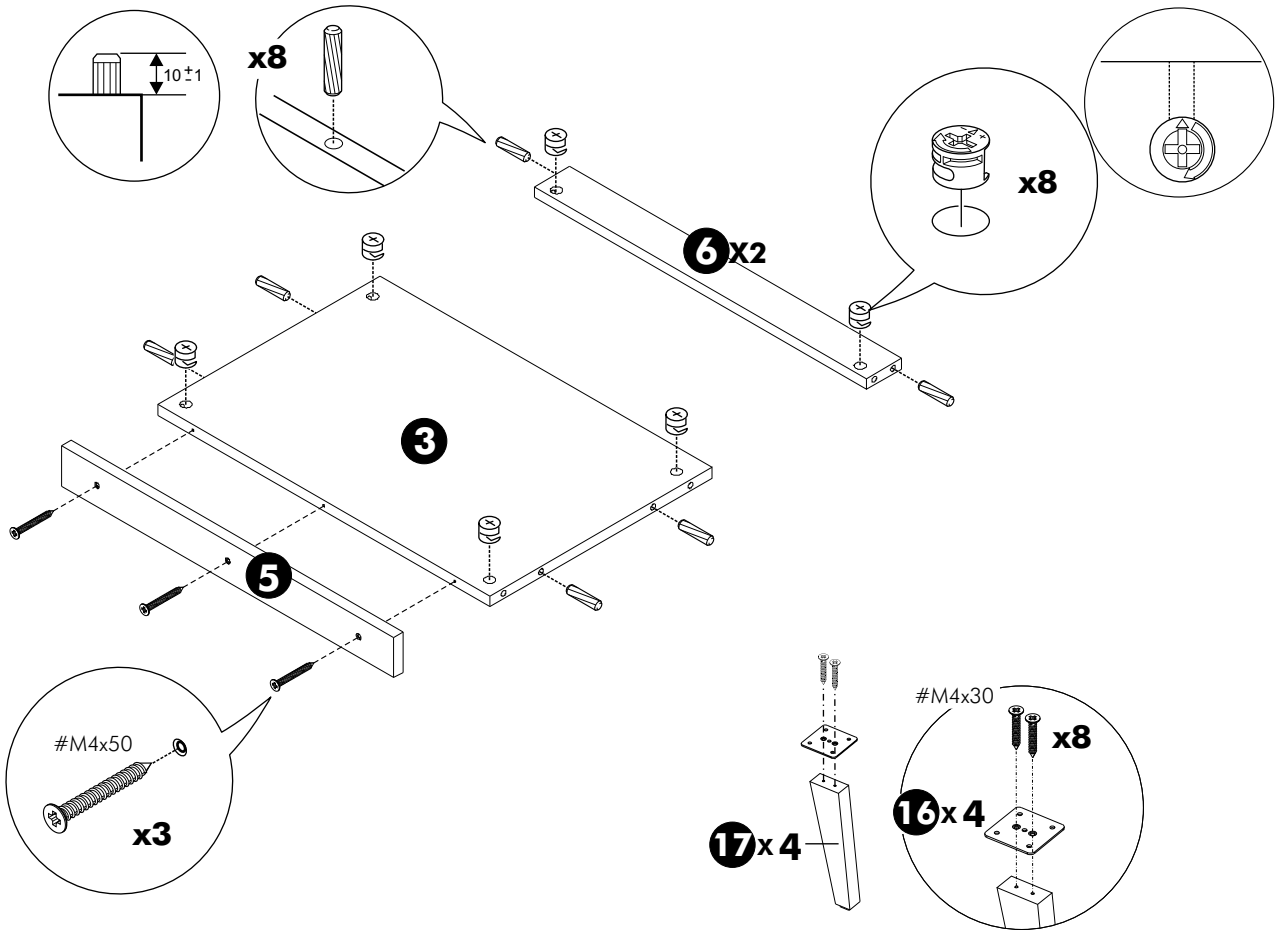

2.

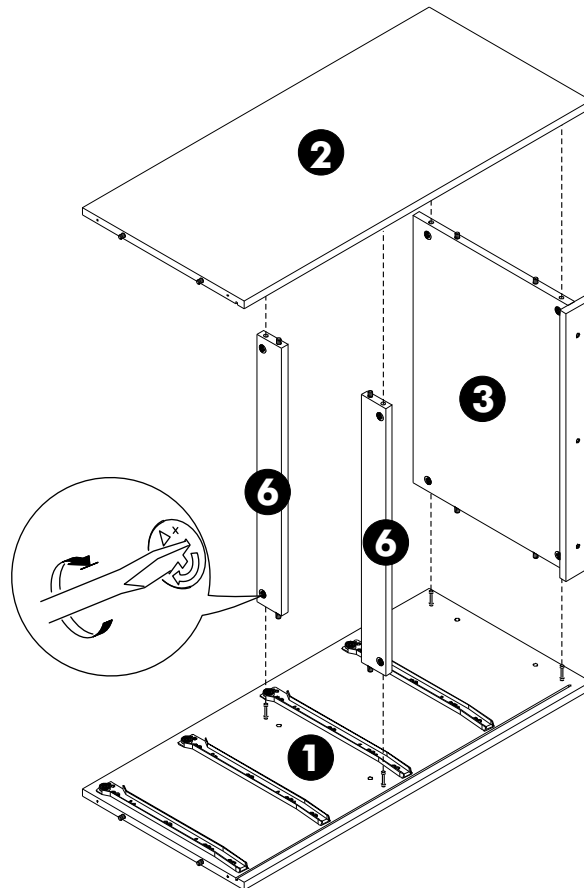

**3.**

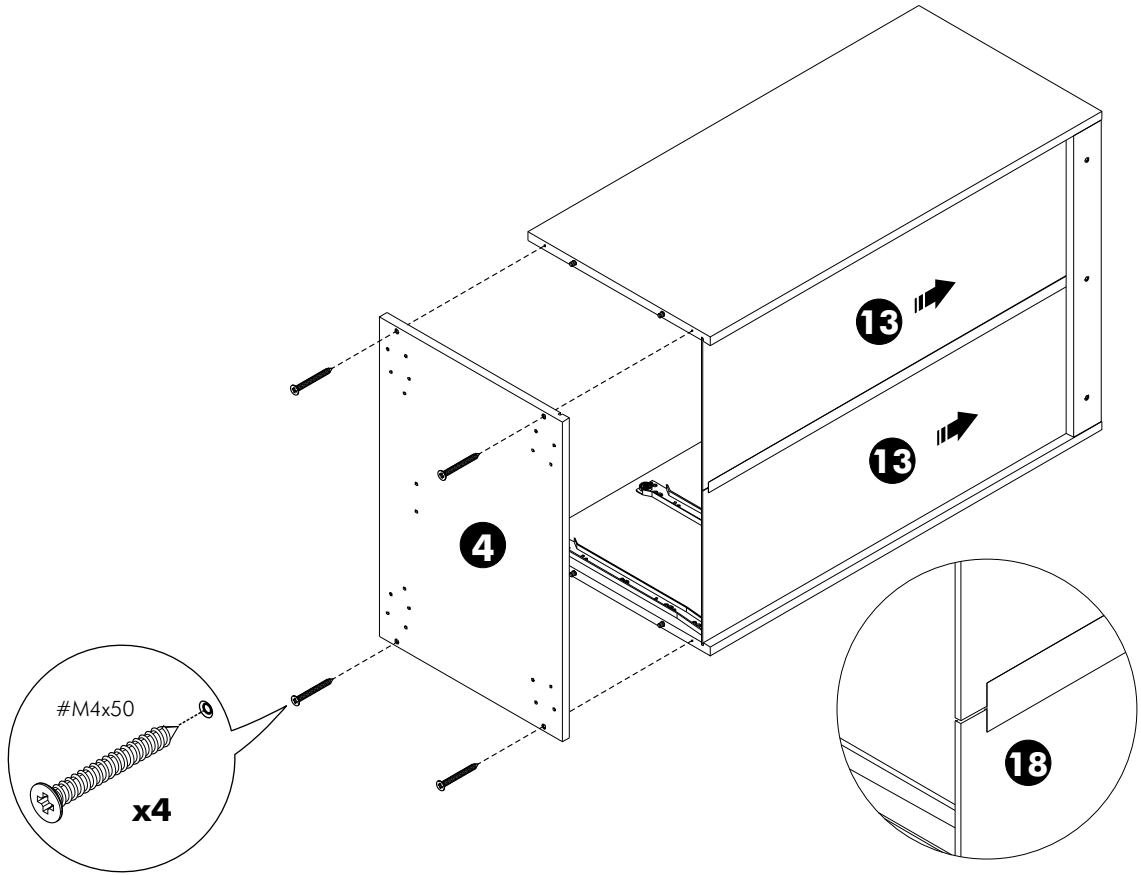

**4.**

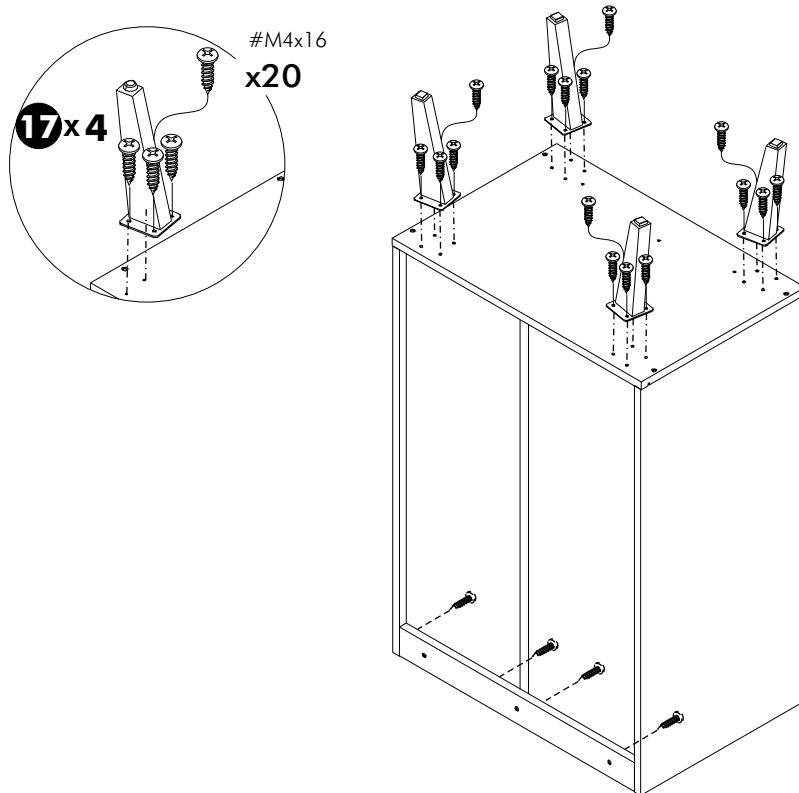

5.

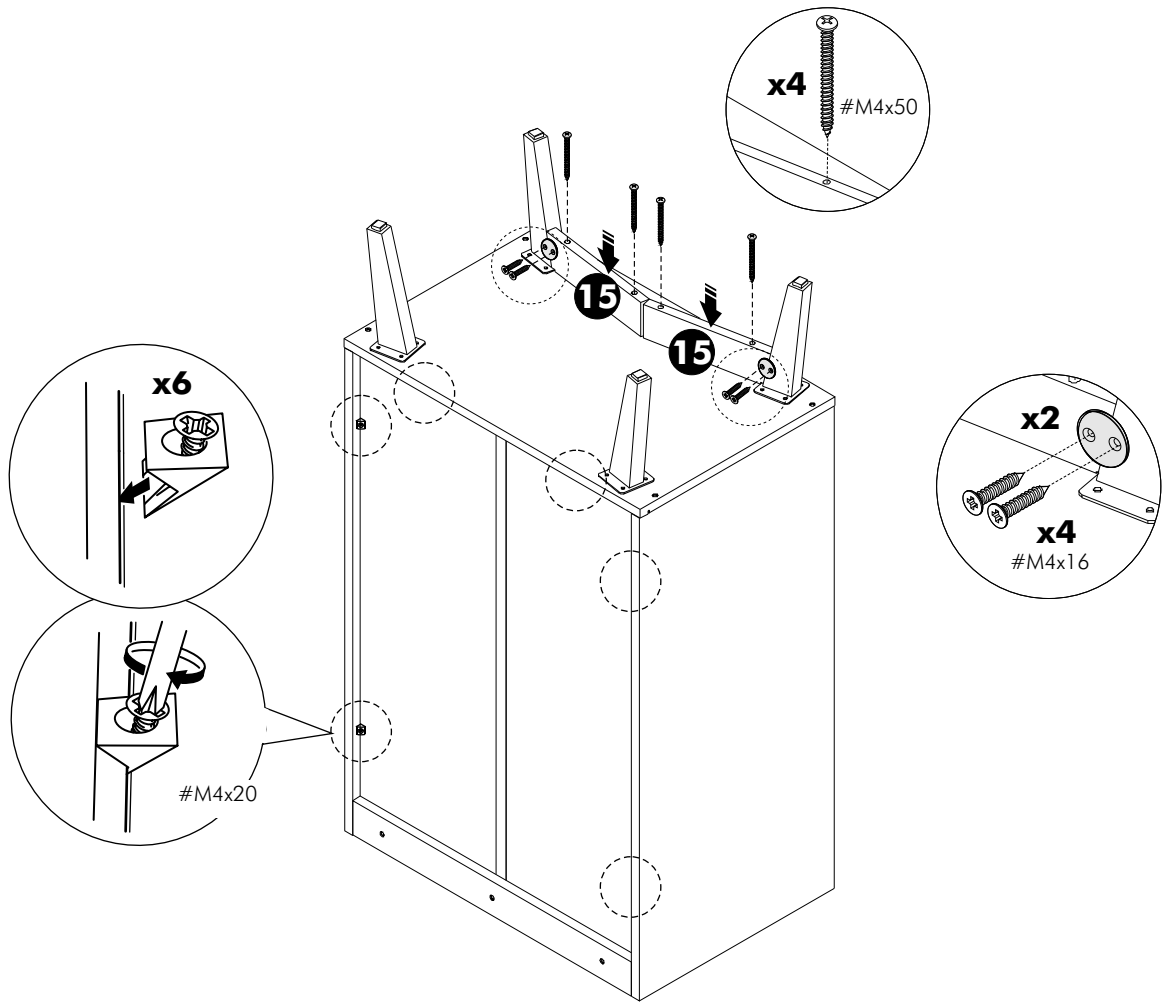

6.

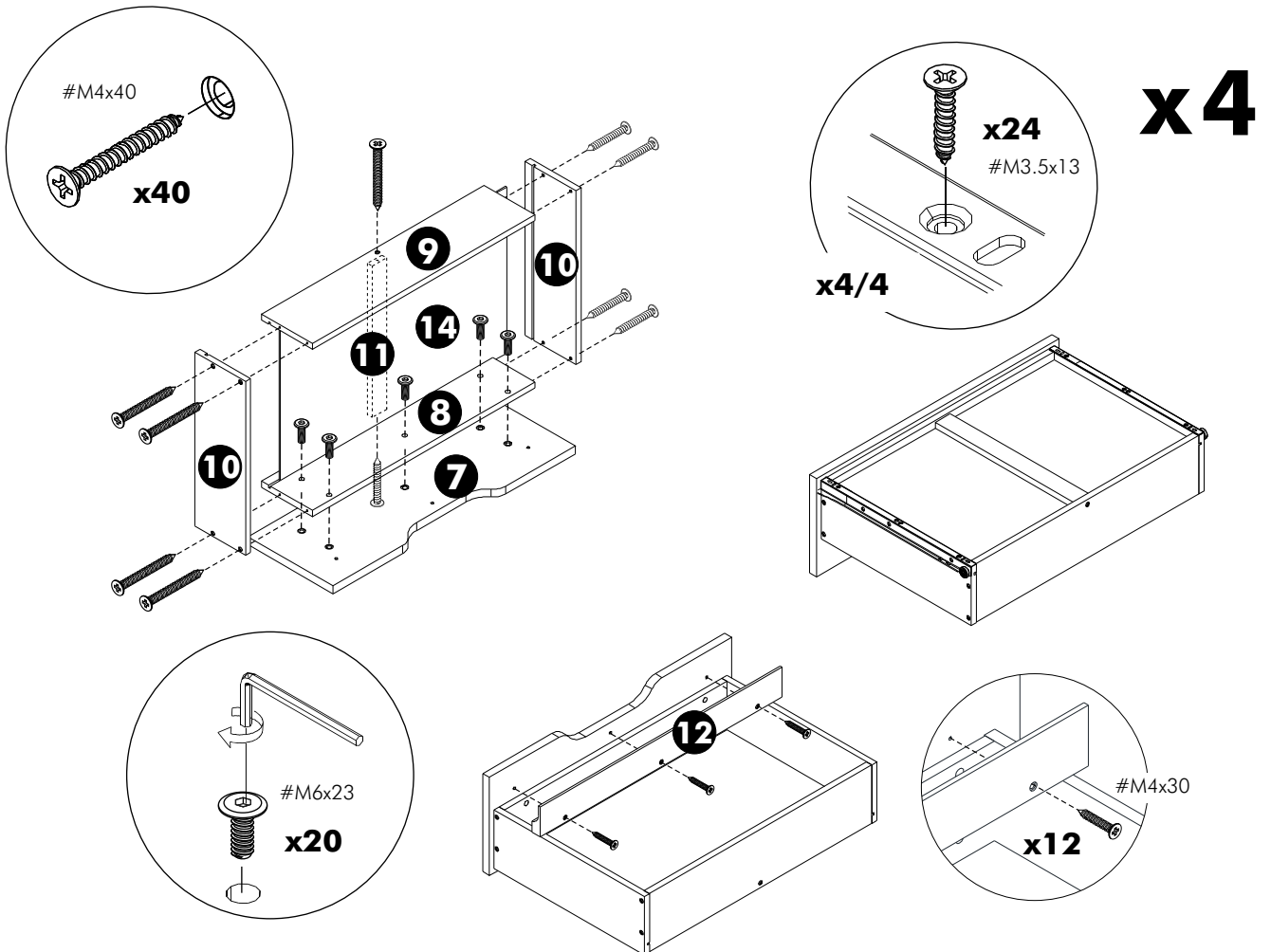

**7.**

