

ESSENCE

Dressing table

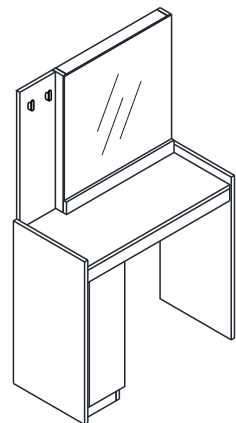
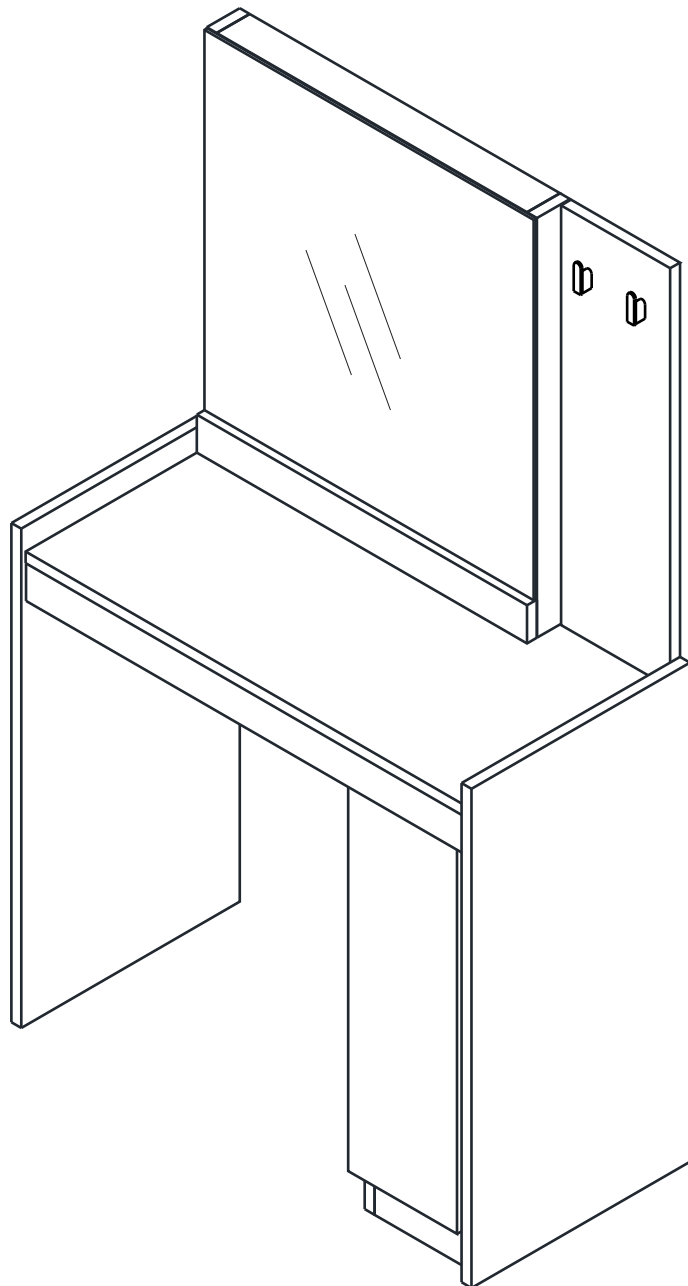

CONNECT SYSTEM

1

3

2

(Connecting bolts)

WHEN FITTING CAMS
 ENSURE STARTING POSITION IS CORRECT
 BEFORE YOU INSERT CONNECTING BOLT
 TURN CLOCKWISE UNTIL SECURE

✓				✗
	CORRECT	WRONG		

M4x16mm.

M4x16mm.

DOOR PANEL

CONNECT SYSTEM



M3.5x20mm.

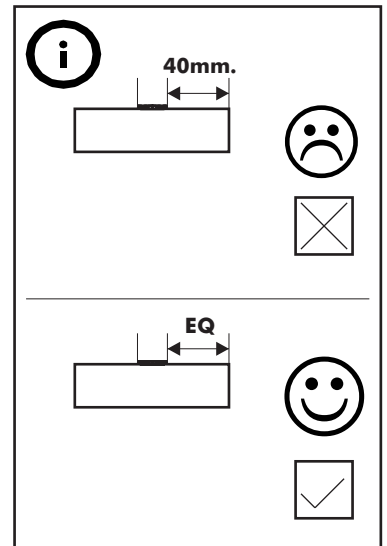
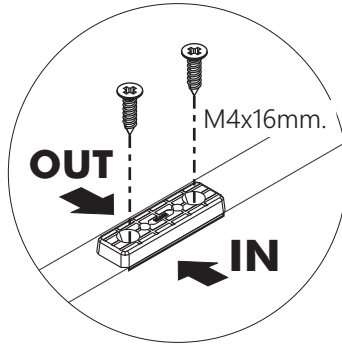
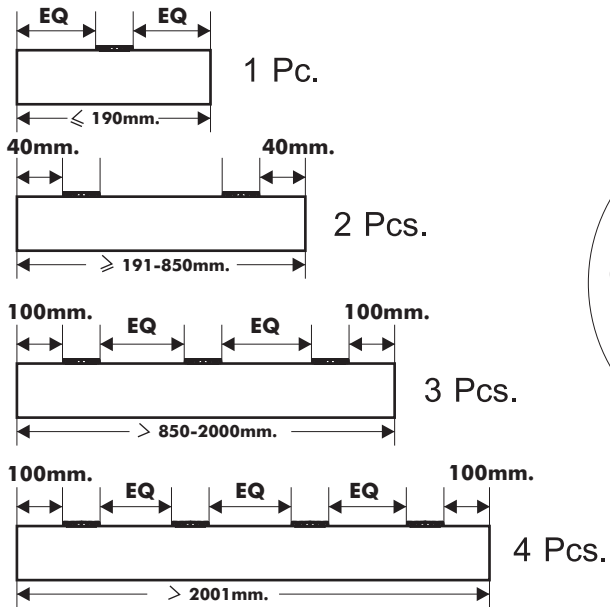
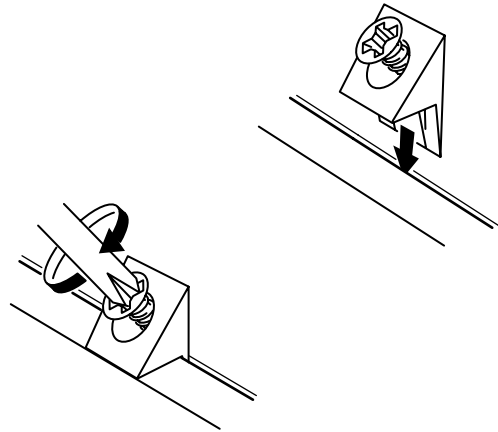
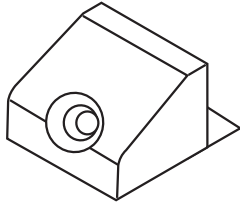

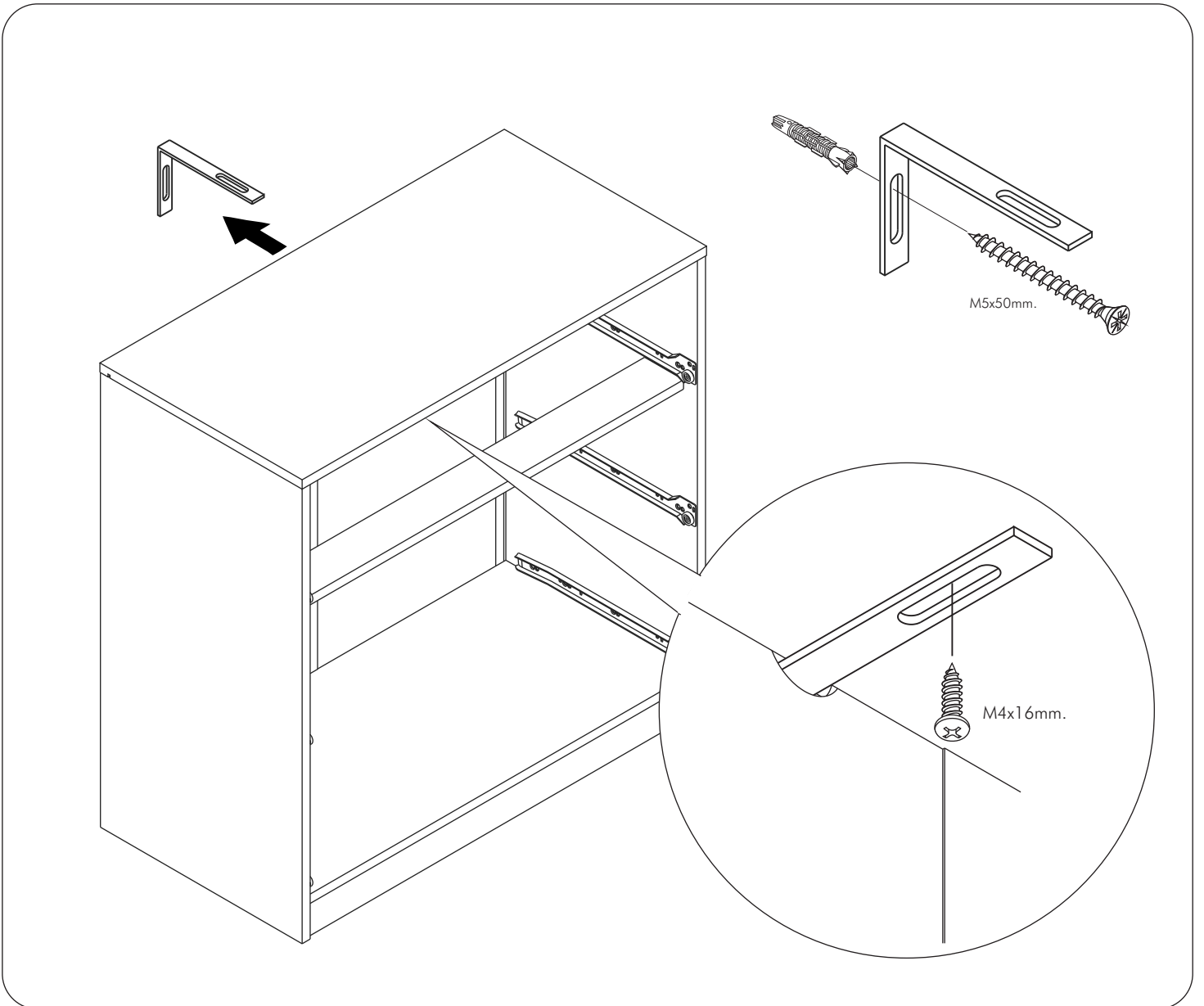
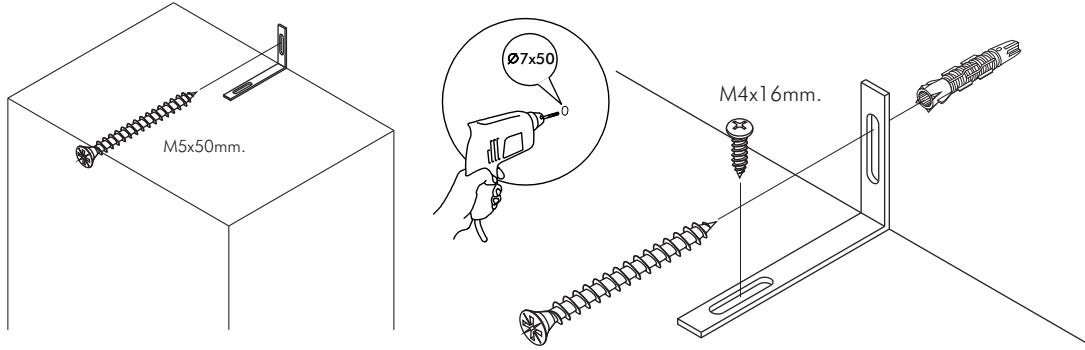
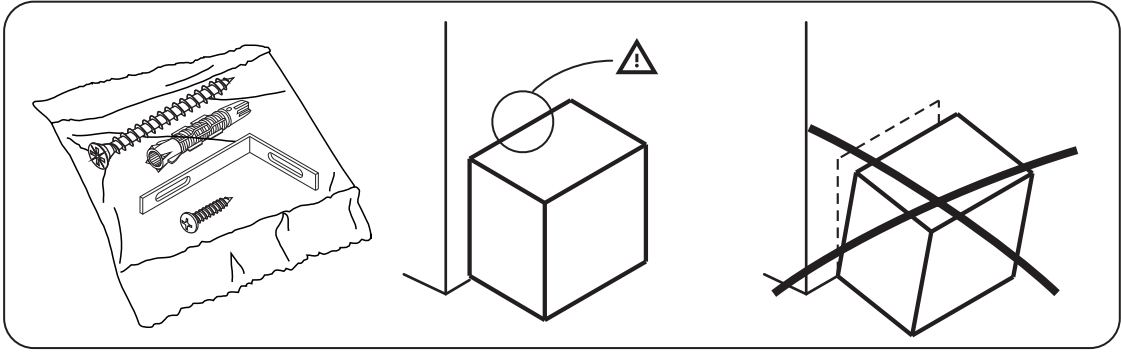

HARDWARE

-BODY SET

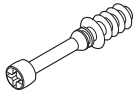

x 7



19mm.

x 7

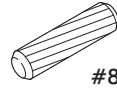

#8x35

x 14

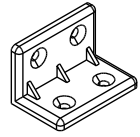

x 8

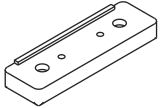

x 8

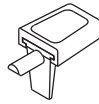

x 4

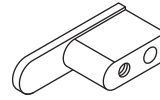

x 2

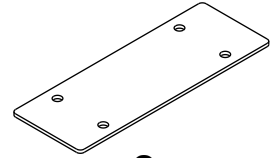

x 2

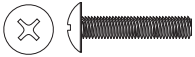

M4x25mm.

x 2

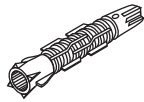

x 1



∅ 11mm.

x 2



M4x16mm.

x 56



x 4



M3.5x20mm.

x 4

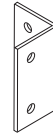

x 5

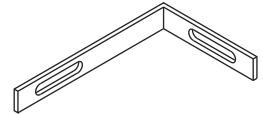

x 1



M4x30mm.

x 7



M4x16mm.

x 23



M5x50mm.

x 1



M4x50mm.

x 7

-DOOR SET

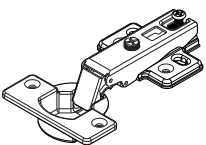

x 2



M4x16mm.

x 12



x 2

ASSEMBLY

-BODY SET

1.

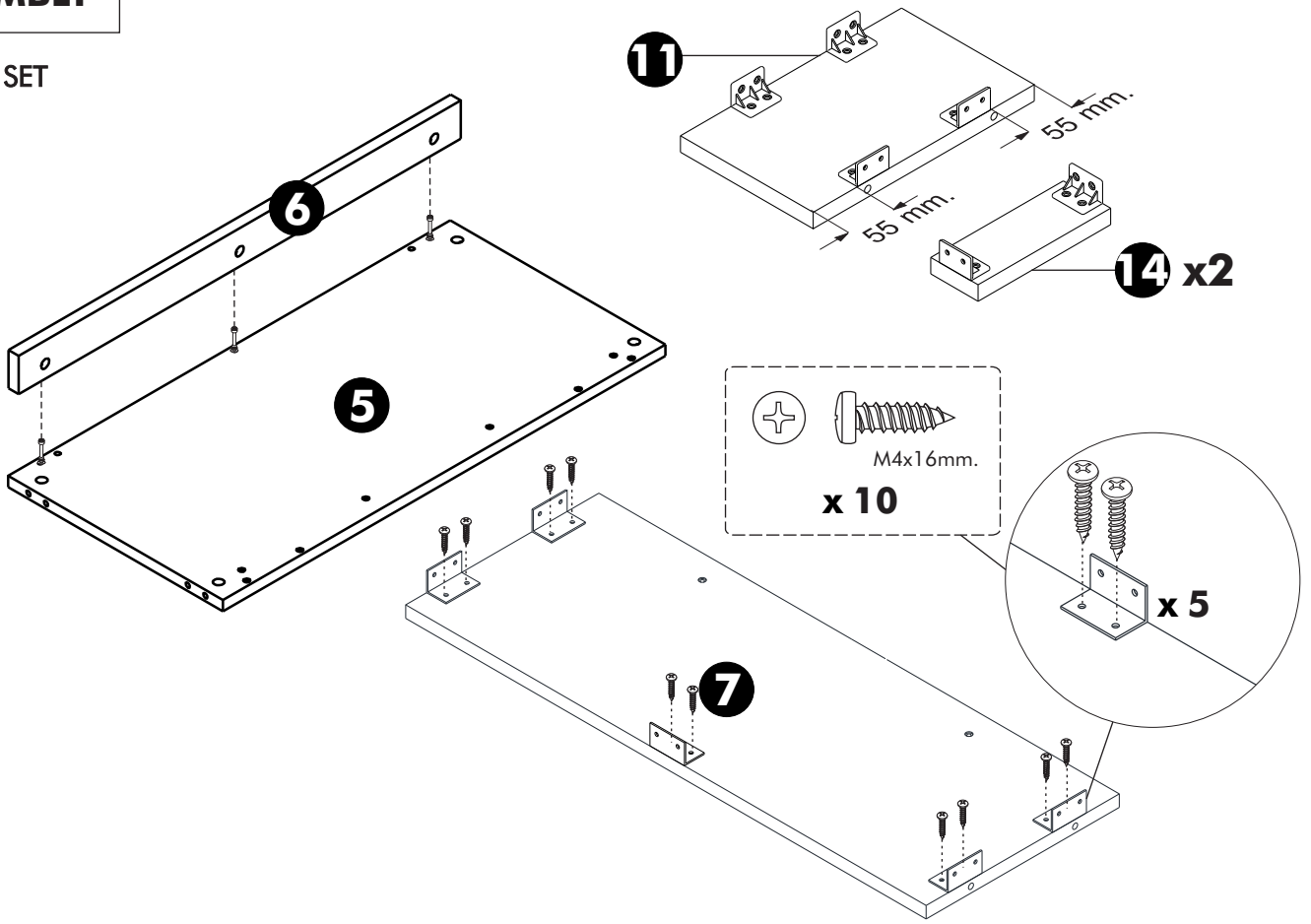

2.

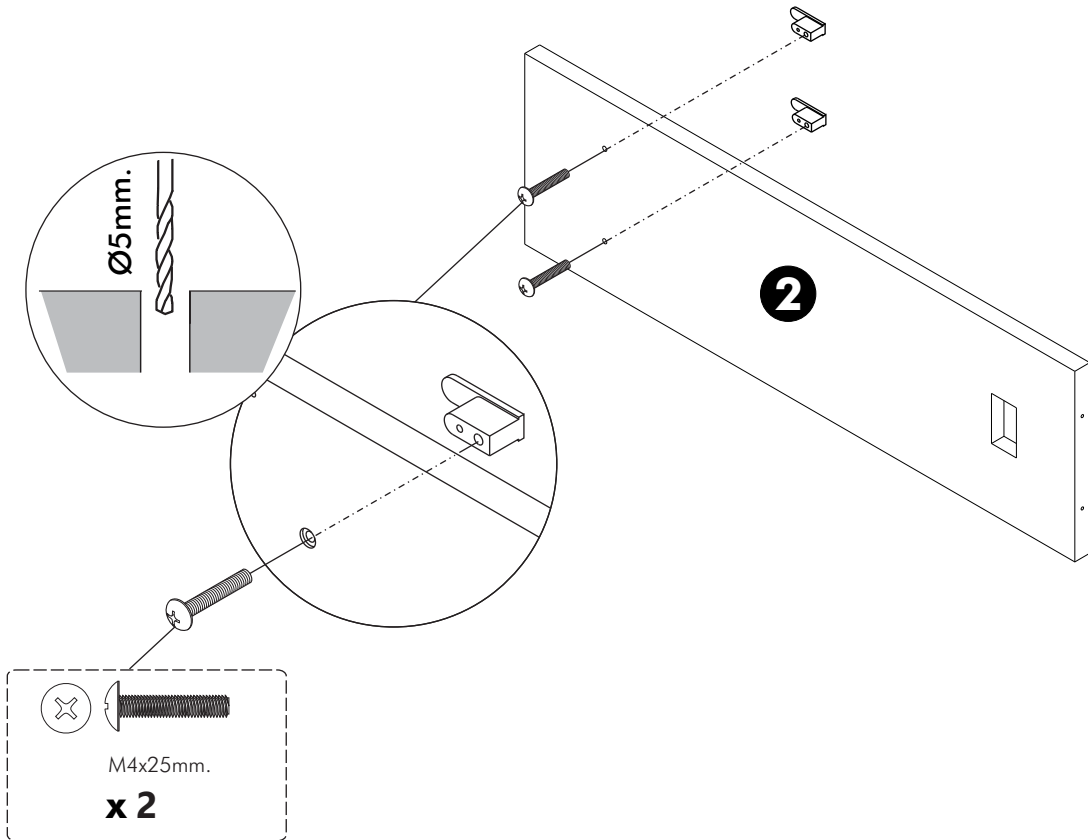

3.

(For Right)

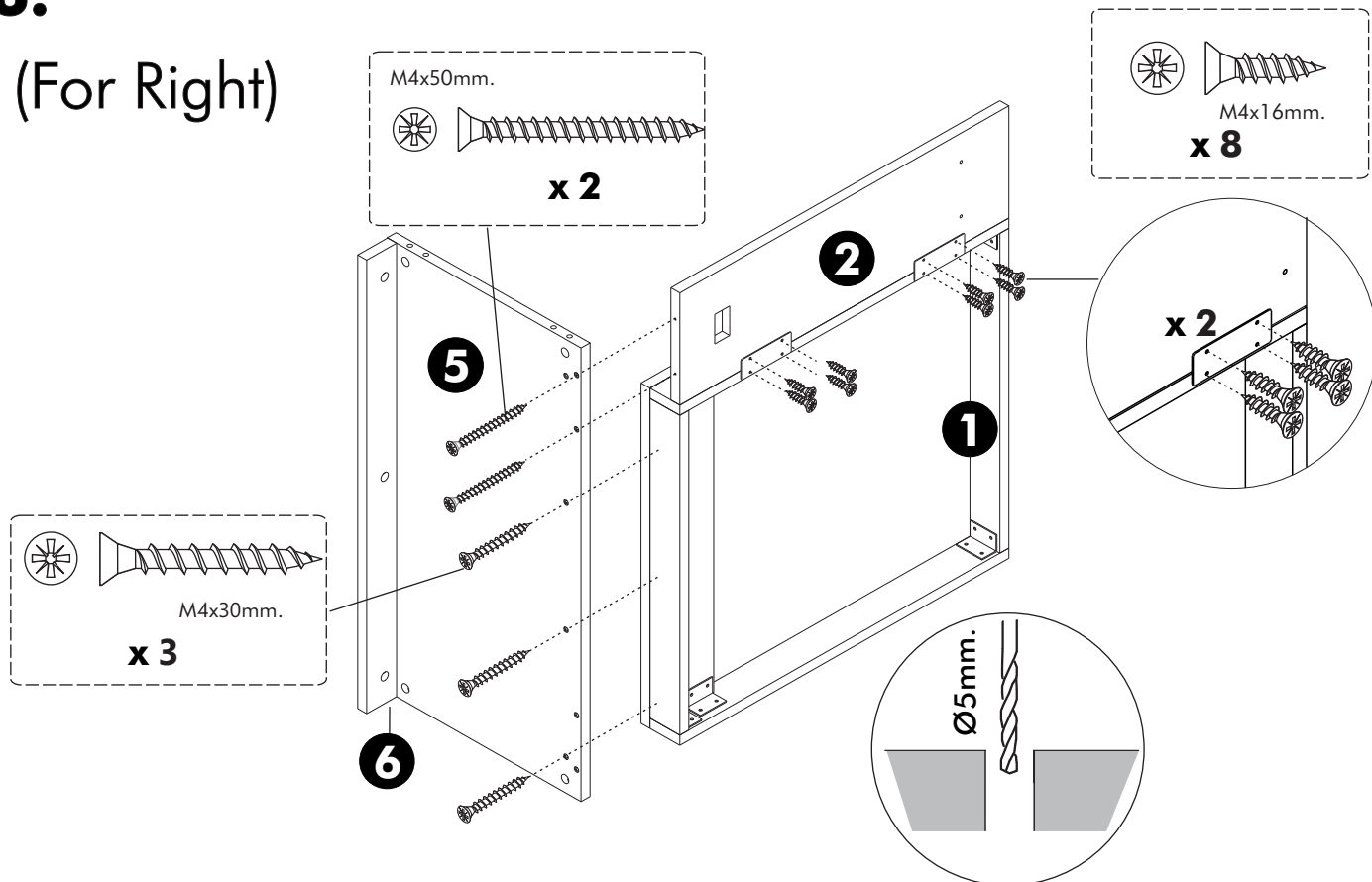

4.

(For Left)

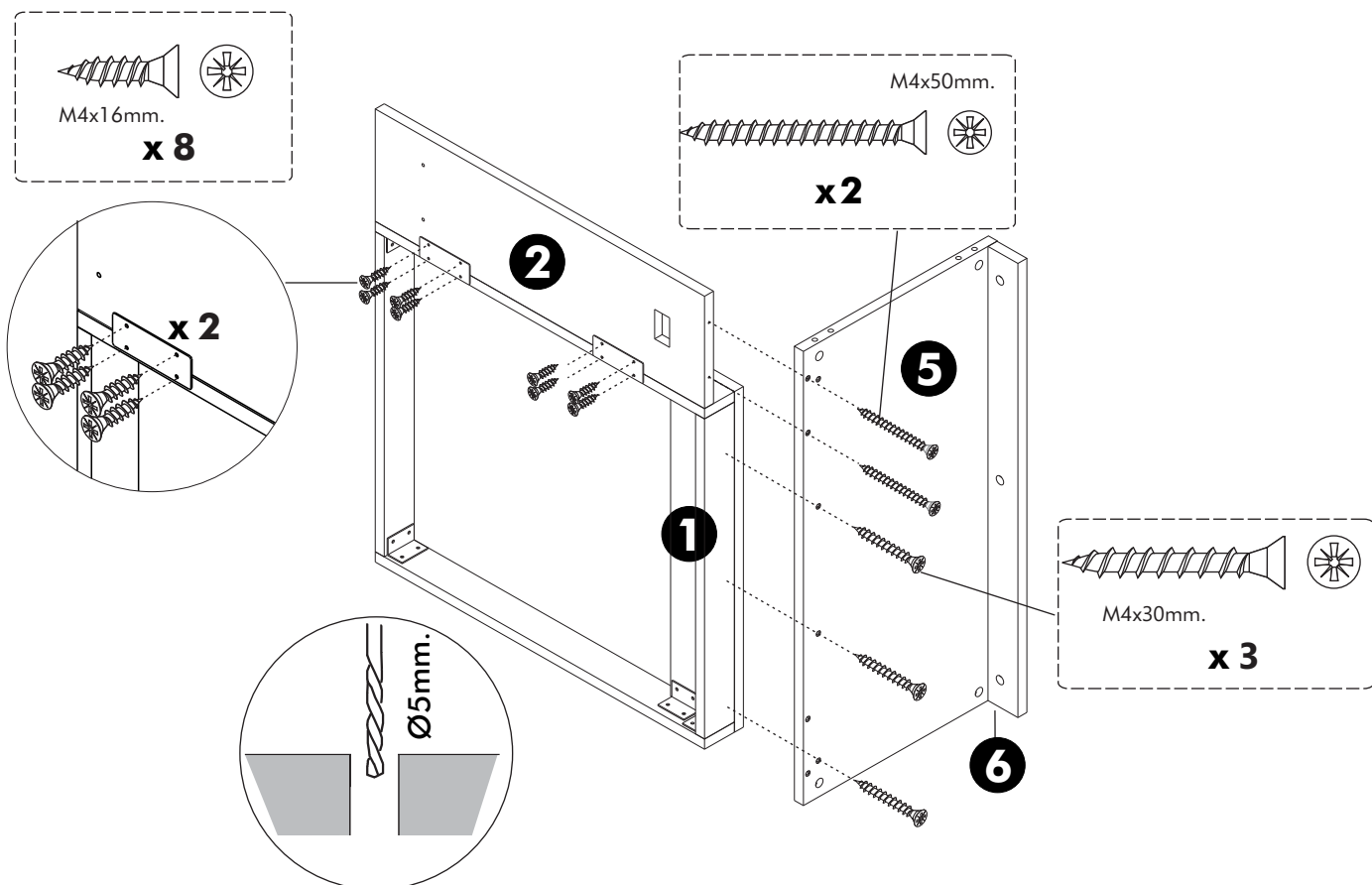

5. (For Right)

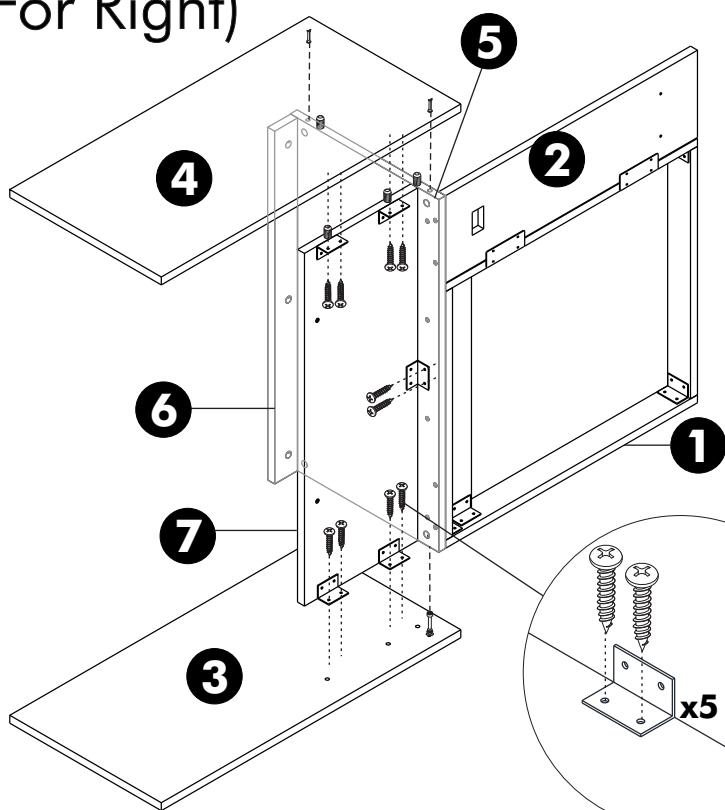

(For Left)

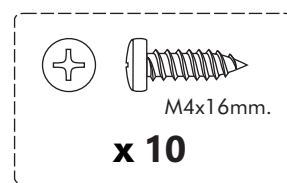
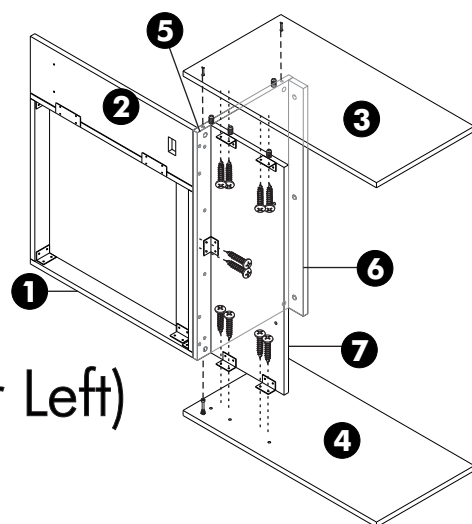

6.

ASSEMBLY

-DOOR SET

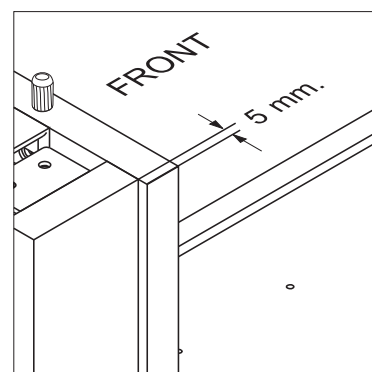
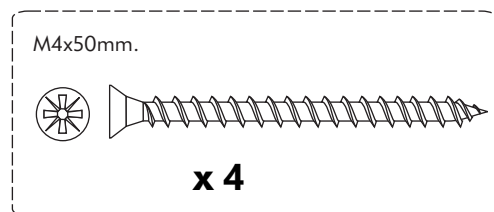
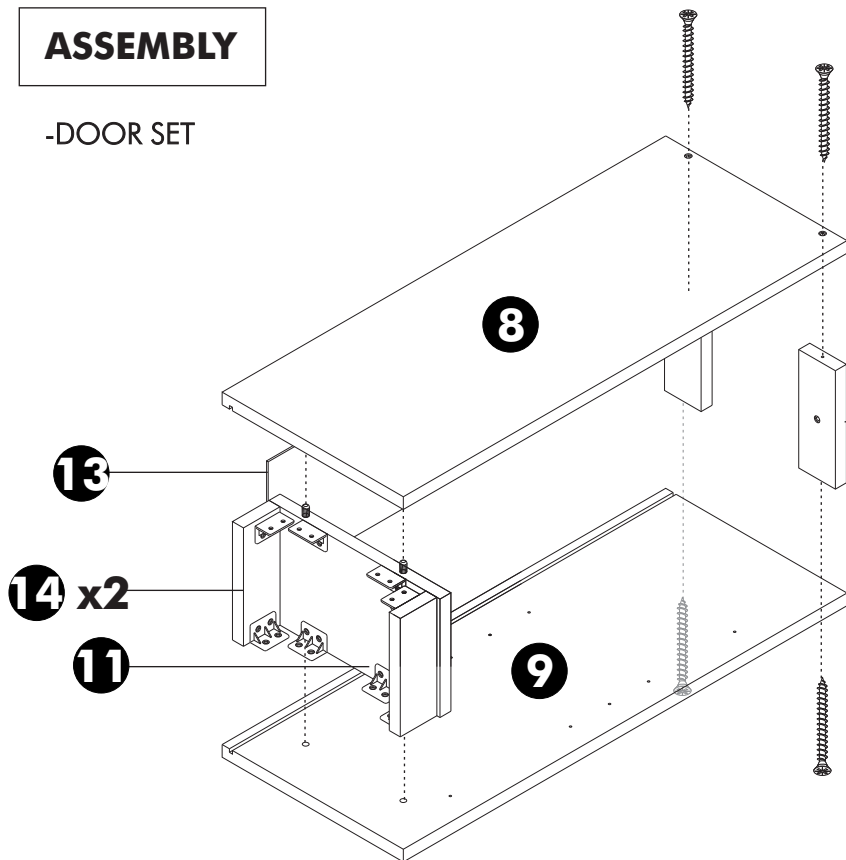

7.

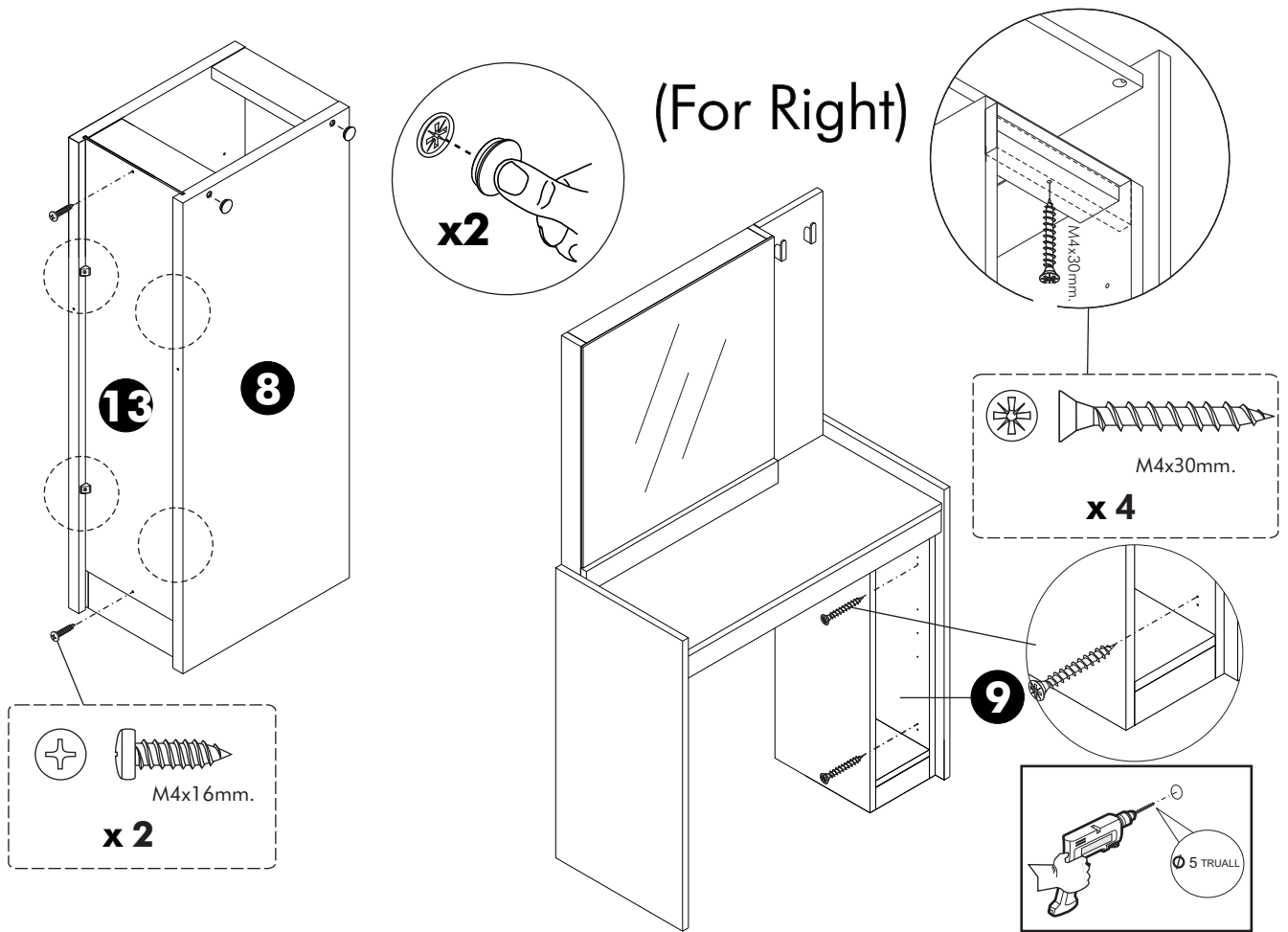

8.

(For Left)

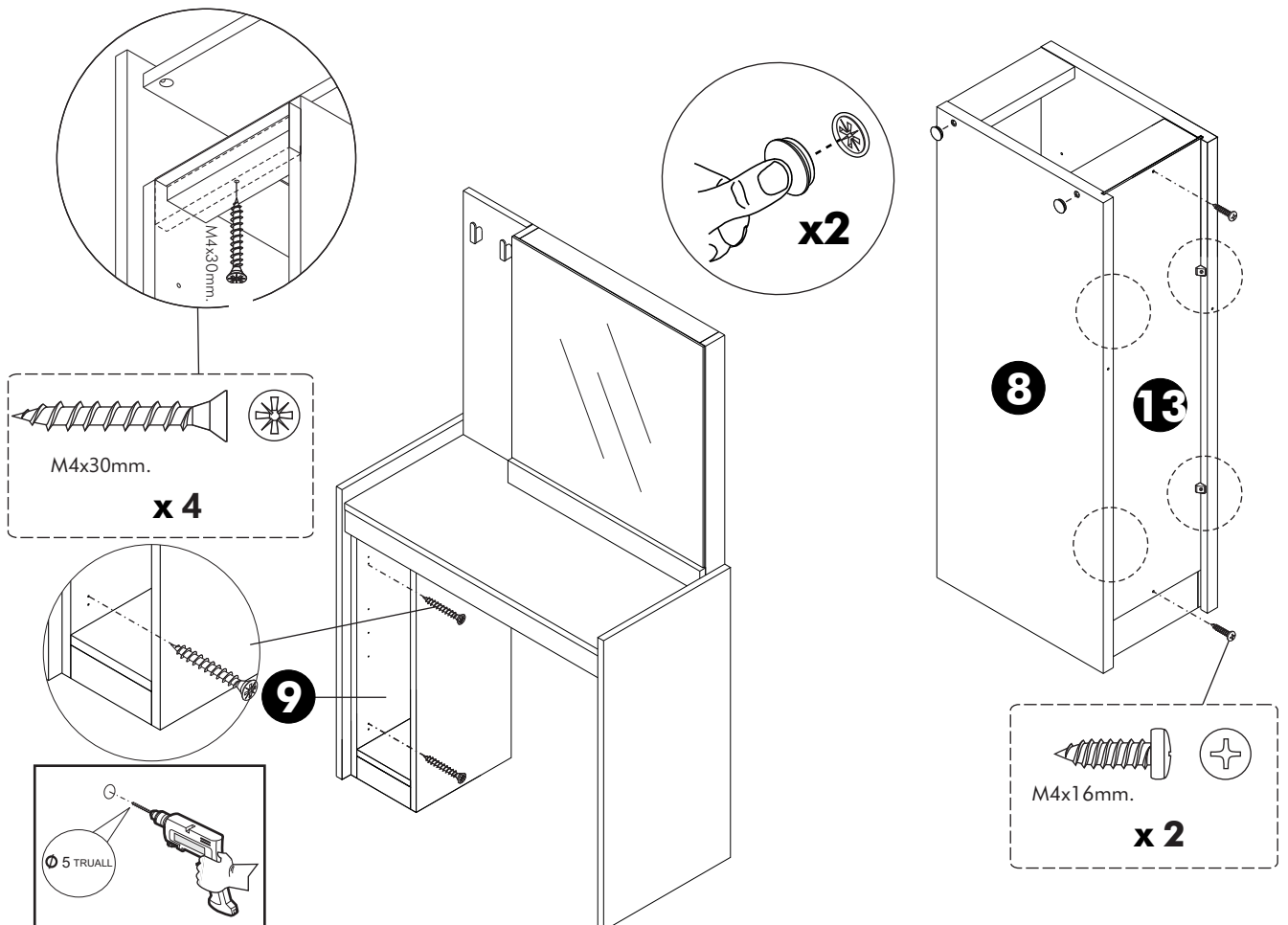

9.

(For Right)

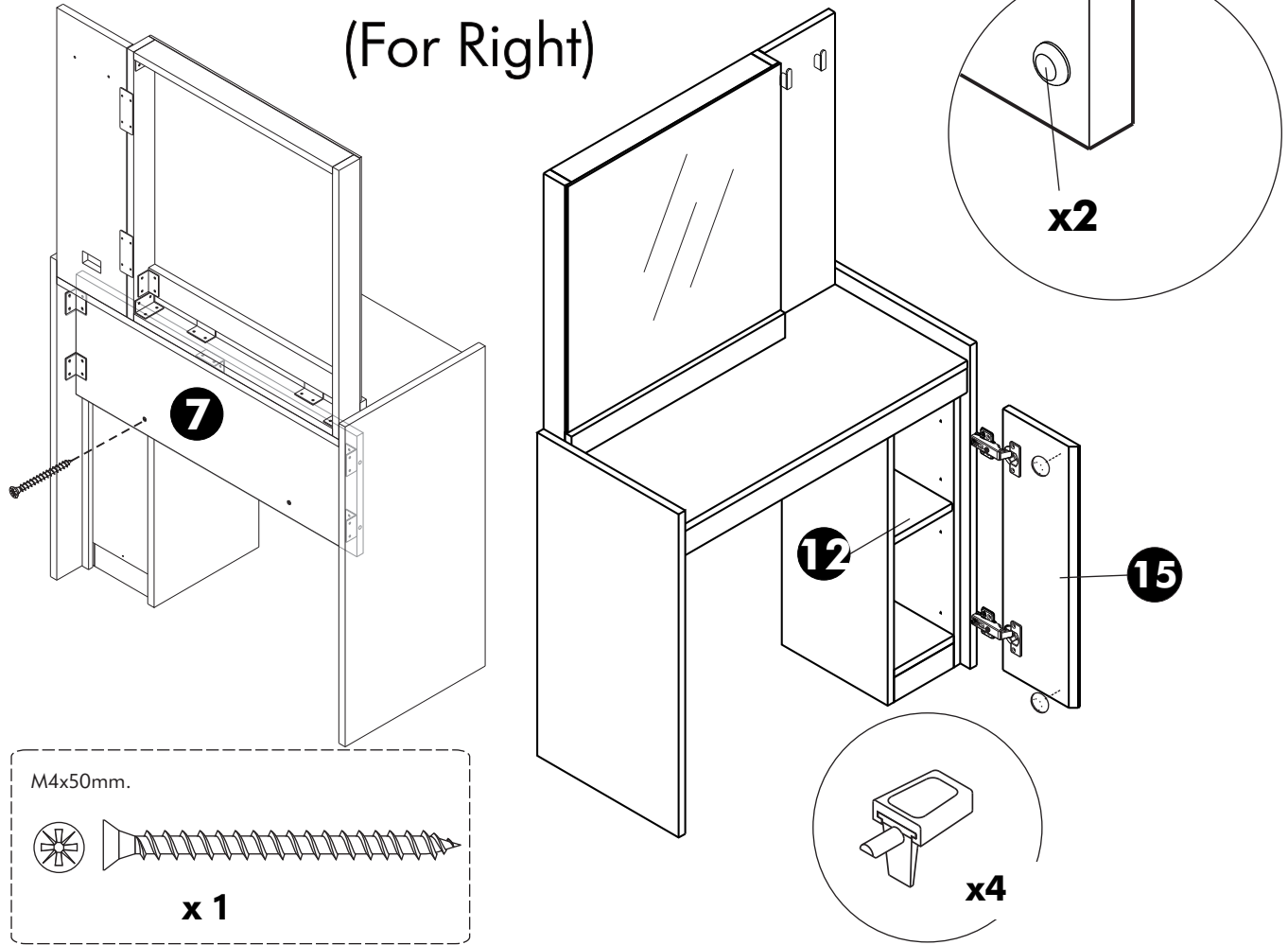

10.

M4x50mm.



x 1

(For Left)

